



Palm Beach County (County) makes no representation or warranties whatsoever on the attached / enclosed information reflected herein pertaining to easements, rights-of-way, setback lines, reservations, agreements, and other similar matters. The information provided herein should not be relied upon by the requesting party to confirm the existence / non-existence of facts contained herein.

LEGAL DESCRIPTION SECTIONAL BREAKDOWNS

W 1/2	E 1/2
N 1/2	
S 1/2	
NW 1/4	NE 1/4
SW 1/4	SE 1/4

NOTE: ALL ROAD EASEMENTS 60' OR AS NOTED

NOTE: LIMITED SECTION DATA

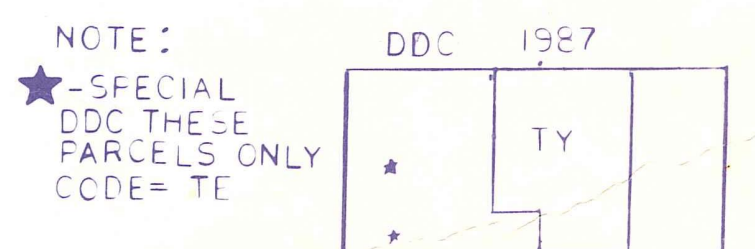

ALL OF SECTION IN COUNTY - 00

NOTE:
NOT TO BE REPRODUCED IN ANY FORM EXCEPT BY EXPRESS WRITTEN CONSENT FROM THE PALM BEACH COUNTY PROPERTY APPRAISER
Information shown herein is compiled from the best available sources and CANNOT be used for surveys or land transfers of any type.

M-3
PALM BEACH COUNTY
Misc.
PROPERTY APPRAISER

36	33	32	33	34	35	36	31
1	6	5	4	3	2	1	6
12	7	8	9	10	11	12	7
18	18	17	16	15	14	13	18
24	19	20	21	22	23	24	19
28	30	29	28	27	26	25	30
36	31	32	33	34	35	36	31
1	6	5	4	3	2	1	6

RGE	TWP	SEC	AERIAL
41	41	2	NO 58-6
SCALE	1" = 200'		
DRAWN BY	K.C. Adams 5-75		
UPDATED	6-10-72 S.B.		

PALM BEACH COUNTY ESTATES
SECTION 6



Also See Sec. 3-41-41
ORDINANCE 1994-103

