



**Palm Beach County (County) makes no representation or warranty whatsoever on the attached / enclosed information reflected herein pertaining to easements, rights-of-way, setback lines, reservations, agreements, and other similar matters. The information provided herein should not be relied upon by the requesting party to confirm the existence / non-existence of facts contained herein.**

- E 1/2 01 MAPLEWOOD PH ONE PB42 P63 (82)
- NW 02 LOXAHATCHEE CLUB AT MAPLEWOOD PL I OF PH II PB48 P131 (85)
- N 1/2 03 LOXAHATCHEE CLUB AT MAPLEWOOD (85) PB51 P39  
\*LOTS 1A TO 92A UNIFIED WITH ADJ. LOTS  
CODED: 30-42-41-11-02
- SE 04 LOXAHATCHEE CLUB AT MAPLEWOOD PL 3 OF PH II (86) PB51P193
- NE 05 LOXAHATCHEE CLUB AT MAPLEWOOD PL 4 OF PH II (86) PB52P55
- NE 06 COLONY AT MAPLEWOOD (87) PB54P97
- E 1/2 07 LOXAHATCHEE CLUB AT MAPLEWOOD PL 5 PH 2 (87) PB54P101
- NE 08 LOXAHATCHEE CLUB AT MAPLEWOOD PL 6 PH 2 (87) PB54P103
- NW 09 MAPLEWOOD DR & PINETREE TRAIL (88) PB58P27
- SW 10 LOXAHATCHEE CLUB AT MAPLEWOOD (88) PL 3 PH 2 (88) PB55P112
- NW 11 TONEY PENNA DR (88) PB58P30
- NW 12 LOXAHATCHEE CLUB AT MAPLEWOOD (88) PL 7 PH 2 PB58 P32
- SW 13 LOXAHATCHEE CLUB AT MAPLEWOOD (89) PL 3 PH 2 REPL LT 93 PB58 F178
- NE 14 LOXAHATCHEE CLUB AT MAPLEWOOD (89) PL 8 PH 2 REPL PB59 P141
- SW 15 HAMPTONS AT MAPLEWOOD (89) PB59P155
- NW 16 LOXAHATCHEE CLUB AT MAPLEWOOD (90) PL 9 PH 2 (90) PB63P103
- NE 17 LOXAHATCHEE CLUB AT MAPLEWOOD PL 10 PH 2 (90) PB64P108
- SW 18 STONEBRIAR AT MAPLEWOOD (90) PB64P122
- SW 19 LOXAHATCHEE CLUB AT MAPLEWOOD REPL LT 119 (90) PB65P34

**NOTE: ALL OF SECTION 11 JUPITER (30)**  
**NOTE: INDIAN CREEK PARKWAY REG. NO. R. 95-1194 ACCEPTING THIS ROAD FROM TOWN OF JUPITER AS A COUNTY ROADWAY. SEE ALSO R. 98-1852 D.: TO PBC AS TRAFFIC CONTROL JURISDICTION & MAINTENANCE FROM CENTRAL BLVD TO MILITARY TR (SECT. 11-14-13) TRP. 41-42.**

**NOTE:**  
 NOT TO BE REPRODUCED IN ANY FORM EXCEPT BY EXPRESS WRITTEN CONSENT FROM THE PALM BEACH COUNTY PROPERTY APPRAISER  
 Information shown hereon is compiled from the best available sources and CANNOT be used for surveys or land transfers of any type.

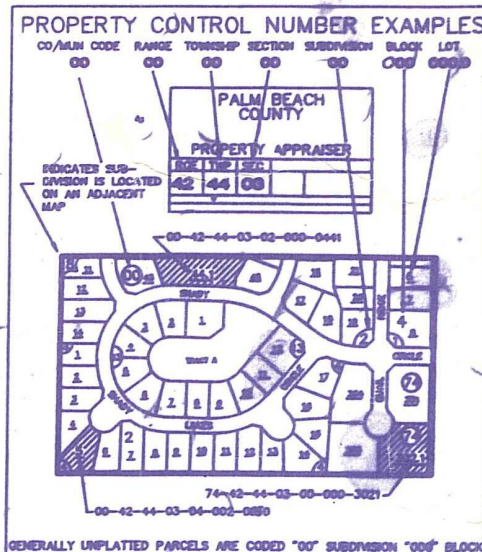

**PALM BEACH COUNTY**  
**N-7**  
 PROPERTY APPRAISER

36	31	32	33	34	35	36	31	RGE	TWP	SEC	AERIAL
1	6	9	4	3	2	1	8	42	41	11	NO64-13
12	7	8	9	10	11	12	7	SCALE	1" = 200'		
13	18	17	16	15	14	13	18	DRAWN BY	M. FISH 8-16-85		
24	19	20	21	22	23	24	19	UPDATED	3-3-92		
25	30	29	28	27	26	25	30				
26	31	32	33	34	35	36	31				
1	6	9	4	3	2	1	8				