

NOTE: FIND NOTHING here  
by ABSTRACT  
see PB 52 Pg 31-34

- SW#01 FOREST HILL VILLAGE PLAT 1 PB 25-29
- SW#02 FOREST HILL VILLAGE REF. OF PLATS 12, B, C, D, E, F, G, H, I, J, K, L, M, N, O, P, Q, R, S, T, U, V, W, X, Y, Z
- NW#03 MODEL LAND CO. SUB. OF W 1/2 OF SEC 11 PB 5-7
- SW#04 FOREST HILL PARK PB 27-33
- SW#05 NAZARENE PARK PB 27-164
- SW#06 FOREST HILL VILLAGE PLAT 1 PB 12-17
- SW#07 FOREST MANOR NO. 1 PB 28-17
- SW#08 NAZARENE PARK REF. PB 28-19
- SW#09 FOREST HILL VILLAGE PB 28-59
- PLAT SW#10 GARDEN CONDO APIS (CON) PB 31-34
- SW#11 FOREST HILL VILLAS GARDENS CONDO'S (CON)
- SE#12 ABBEY PARK PLAT NO. 1 (CON) PB 40-42
- SE#13 GARDEN HILLS UNIT ONE (CON) PB 43-45
- SE#14 GARDEN HILLS UNIT TWO (CON) PB 46-48
- SE#15 ABBEY PARK PLAT NO. 2 (CON) PB 49-51
- SE#16 ABBEY PARK GARDENS I CONDO (CON) PB 52-54
- SE#17 ABBEY PARK PLAT NO. 3 (CON) PB 55-57
- SE#18 GARDEN HILLS UNIT THREE (CON) PB 58-60
- NW#19 VICTORIA WOODS PLAT 1 (CON) PB 61-63
- NE#20 SUMMIT PINES UNIT ONE (CON) PB 64-66
- NE#21 SUMMIT PINES UNIT TWO (CON) PB 67-69
- NW#22 VICTORIA WOODS PLAT TWO (CON) PB 70-72
- NE#23 SUMMIT PINES UNIT THREE (CON) PB 73-75
- NE#24 SUMMIT PINES UNIT FOUR (CON) PB 76-78
- SE#25 ABBEY PARK PL 4 (CON) PB 79-81
- NW#26 VICTORIA WOODS PL 4 (CON) PB 82-84
- SE#28 POINTE CLUB COND (CON)
- SE#29 ABBEY PARK PL 5 (CON) PB 85-87
- SE#30 PINE GLEN AT ABBEY PARK PL 1 (CON) PB 88-90

NOTES:  
 - GARDEN HILLS I-II: WATER & SEWER FACILITIES B. 4298-129  
 - FOREST HILL BLVD: SEE NOTES SECT. 9-44-42.  
 - AGREEMENT B/W DEVELOPER & UTILITY FOR WATER & SEWAGE FACILITY IN N/4 OF SE 1/4 B. 3797-550

Do not find this 53' gap

ALL OF SECTION 11 IS CODED IN THE COUNTY (00)  
 NOTE: DOTTED NUMBERS INDICATE TRACTS IN MODEL LAND CO. SUB. OF W 1/2 SEC. 11 PB 5-7 PG 76...

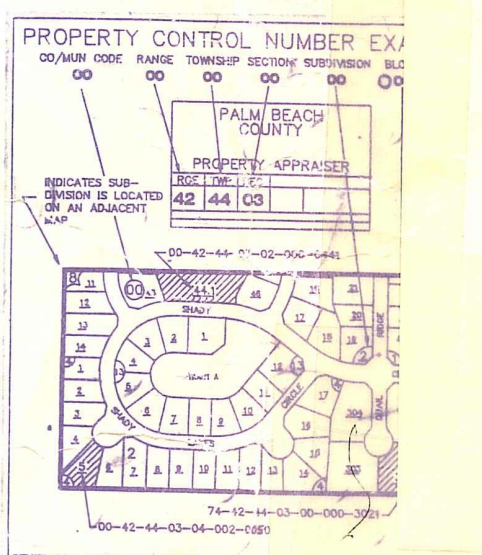

11-44-42  
 19-44-42

Palm Beach County (County) makes no representation or warranties whatsoever on the attached / enclosed information reflected herein pertaining to easements, rights-of-way, setback lines, reservations, agreements, and other similar matters. The information provided herein should not be relied upon by the requesting party to confirm the existence / non-existence of facts contained herein.

PALM BEACH COUNTY  
 GARY R. NIKOLITS  
 PROPERTY APPRAISER

36	31	32	33	34	35	36	31
1	0	8	4	3	2	1	8
12	7	8	9	10	11	12	7
13	18	17	16	15	14	13	18
24	19	20	21	22	23	24	19
25	30	29	28	27	26	25	30
36	31	32	33	34	35	36	31
42	44	11					
SCALE		1/200					
DRAWN BY		T. J. B. B.					
UPDATED		9-2-98					