

TOWN OF JUPITER
AREA NOT INCLUDED

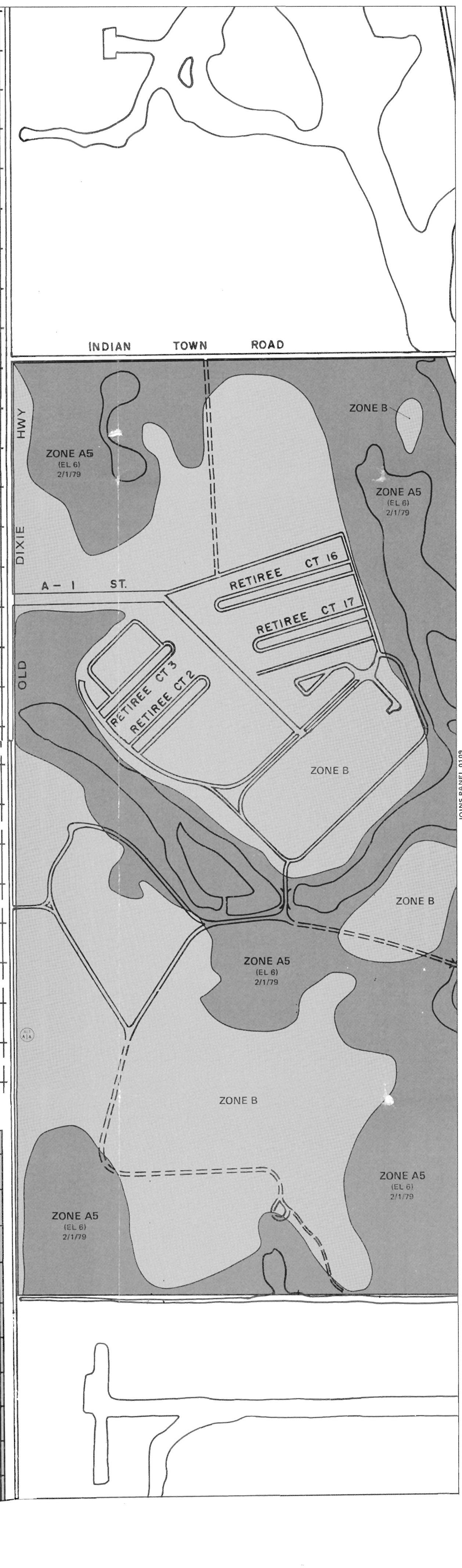

ELEVATION REFERENCE MARKS

REFERENCE MARK	ELEVATION (FT. NGVD)	DESCRIPTION OF LOCATION	PANEL NUMBER
RM19	8.75	Station is located on the centerline of Loxahatchee River Road approximately 440 feet south of its intersection with Via Rio. Established by Florida Geological Survey or U.S. Geological Survey.	0108
RM20	10.65	Station is located on the centerline of Indian Town Road approximately 750 feet east of its intersection with Center Street. Established by Florida Geological Survey or U.S. Geological Survey.	0108
RM62	16.45	Station is located approximately 5 miles southwest of Jupiter, Florida, on the northwest bank of the C-18 Canal. To reach: from the intersection of State Highway A1A and State Road 706 (0.5 mile south of Jupiter Post Office) go west 3.0 miles on 706 to borrow pit to the south side of the road, thence southwest on sand road 2.9 miles to the intersection of the C-18 Canal and ditch to station location. Station is located near the northwest corner Section 17, Township 41 South, Range 42 East, 310 feet northwest of the centerline of the C-18 Canal, 135 feet southeast of northeast-southwest ditch, 500 feet northeast of the intersection of Limestone Creek and ditch and bears north 59 degrees east, 48 feet from a blazed cypress tree, south 19 degrees east, 24 feet from a blazed cypress tree and north 59 degrees west, 56 feet from a blazed cypress tree. Established by Florida Geological Survey or U.S. Geological Survey.	0115

KEY TO MAP

500-Year Flood Boundary	-----	ZONE B
100-Year Flood Boundary	-----	ZONE A1 DATE
Zone Designations* With Date of Identification e.g., 12/2/74		ZONE A5 DATE
100-Year Flood Boundary	-----	ZONE B
500-Year Flood Boundary	-----	ZONE B
Base Flood Elevation Line With Elevation In Feet**	-----	51.3
Base Flood Elevation In Feet Where Uniform Within Zone**		(EL 987)
Elevation Reference Mark		RM7x
Zone D Boundary	-----	*M1.5
River Mile		*M1.5

**Referenced to the National Geodetic Vertical Datum of 1929

***EXPLANATION OF ZONE DESIGNATIONS**

ZONE	EXPLANATION
A	Areas of 100-year flood; base flood elevations and flood hazard factors not determined.
A0	Areas of 100-year shallow flooding where depths are between one (1) and three (3) feet; average depths of inundation are shown, but no flood hazard factors are determined.
AH	Areas of 100-year shallow flooding where depths are between one (1) and three (3) feet; base flood elevations are shown, but no flood hazard factors are determined.
A1-A30	Areas of 100-year flood; base flood elevations and flood hazard factors determined.
A99	Areas of 100-year flood to be protected by flood protection system under construction; base flood elevations and flood hazard factors not determined.
B	Areas between limits of the 100-year flood and 500-year flood or certain areas subject to 100-year flooding with average depths less than one (1) foot or where the contributing drainage area is less than one square mile; or areas protected by levees from the base flood. (Medium shading)
C	Areas of minimal flooding. (No shading)
D	Areas of undetermined, but possible, flood hazards.
V	Areas of 100-year coastal flood with velocity (wave action); base flood elevations and flood hazard factors not determined.
V1-V30	Areas of 100-year coastal flood with velocity (wave action); base flood elevations and flood hazard factors determined.

NOTES TO USER

Certain areas not in the special flood hazard areas (zones A and V) may be protected by flood control structures.

This map is for flood insurance purposes only; it does not necessarily show all areas subject to flooding in the community or all planimetric features outside special flood hazard areas.

For adjoining map panels, see separately printed Index To Map Panels.

Coastal base flood elevations shown on this map include the effects of wave action.

INITIAL IDENTIFICATION:
JUNE 17, 1970

FLOOD HAZARD BOUNDARY MAP REVISIONS:

FLOOD INSURANCE RATE MAP EFFECTIVE:
FEBRUARY 1, 1979

FLOOD INSURANCE RATE MAP REVISIONS:
Map revised October 15, 1982 to change zone designations and base flood elevations reflecting wave action effects, and to change corporate limits and scale.

To determine if flood insurance is available in this community, contact your insurance agent, or call the National Flood Insurance Program, at (800) 638-6620.

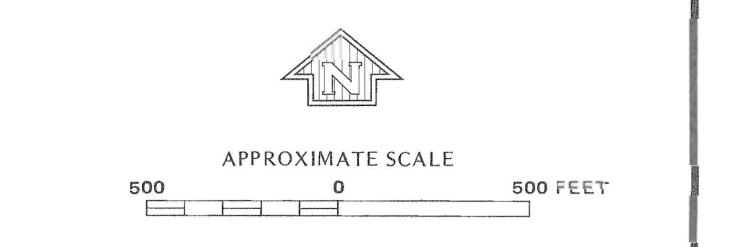

NATIONAL FLOOD INSURANCE PROGRAM

FIRM
FLOOD INSURANCE RATE MAP

PALM BEACH COUNTY, FLORIDA
(UNINCORPORATED AREAS)

PANEL 108 OF 245
(SEE MAP INDEX FOR PANELS NOT PRINTED)

COMMUNITY-PANEL NUMBER
120192 0108 B

MAP REVISED:
OCTOBER 15, 1982

Federal Emergency Management Agency