

ELEVATION REFERENCE MARKS

REFERENCE MARK	ELEVATION (FT. NGVD)	DESCRIPTION OF LOCATION
RM27	6.25	Station is located on the centerline of Prosperity Farms Road approximately 350 feet south from its intersection with South Wallen Drive. Established by Florida Geological Survey or U.S. Geological Survey.
RM28	9.25	Station is located on the centerline of Prosperity Farms Road approximately 2070 feet south from its intersection with State Route 703 (P.G.A. Boulevard). Established by Florida Geological Survey or U.S. Geological Survey.
RM29	15.49	Station is located on Old Elsie Highway in curb on northwest end of northbound bridge over Earman River. Established by Florida Geological Survey or U.S. Geological Survey.
RM30*	11.10	Station is located 240 feet east from the intersection of Prosperity Farms Road and Richard Road. Established by Florida Geological Survey or U.S. Geological Survey.
RM31*	14.73	Station is located on the centerline of North Lake Boulevard (State Route 809) at the east end of the bridge that crosses over the Earman Canal. Established by Florida Geological Survey or U.S. Geological Survey.
RM56	6.73	Station is located on Monet Road west of old Monet bridge site across HWY. To reach: from post office at Lake Park go north on State Route A1A U.S. to Prosperity Farms Road, thence north on Prosperity Farms Road 2.2 miles to Monet Road, thence approximately 0.1 mile east on Monet Road to old bridge site and station location. Station is on the north shoulder of Monet Road and 8 feet from the edge of the pavement. East 69 feet from a road barrier, north end. North 47 degrees west 67 feet from a Triangle Marked Andromeda Pine. Mark is a U.S. Army Corps of Engineers bronze traverse disk set in a 6 inch concrete post; flush with shoulder of the road, and stamped FC-982, 1952.

*LOCATED IN AREA NOT INCLUDED

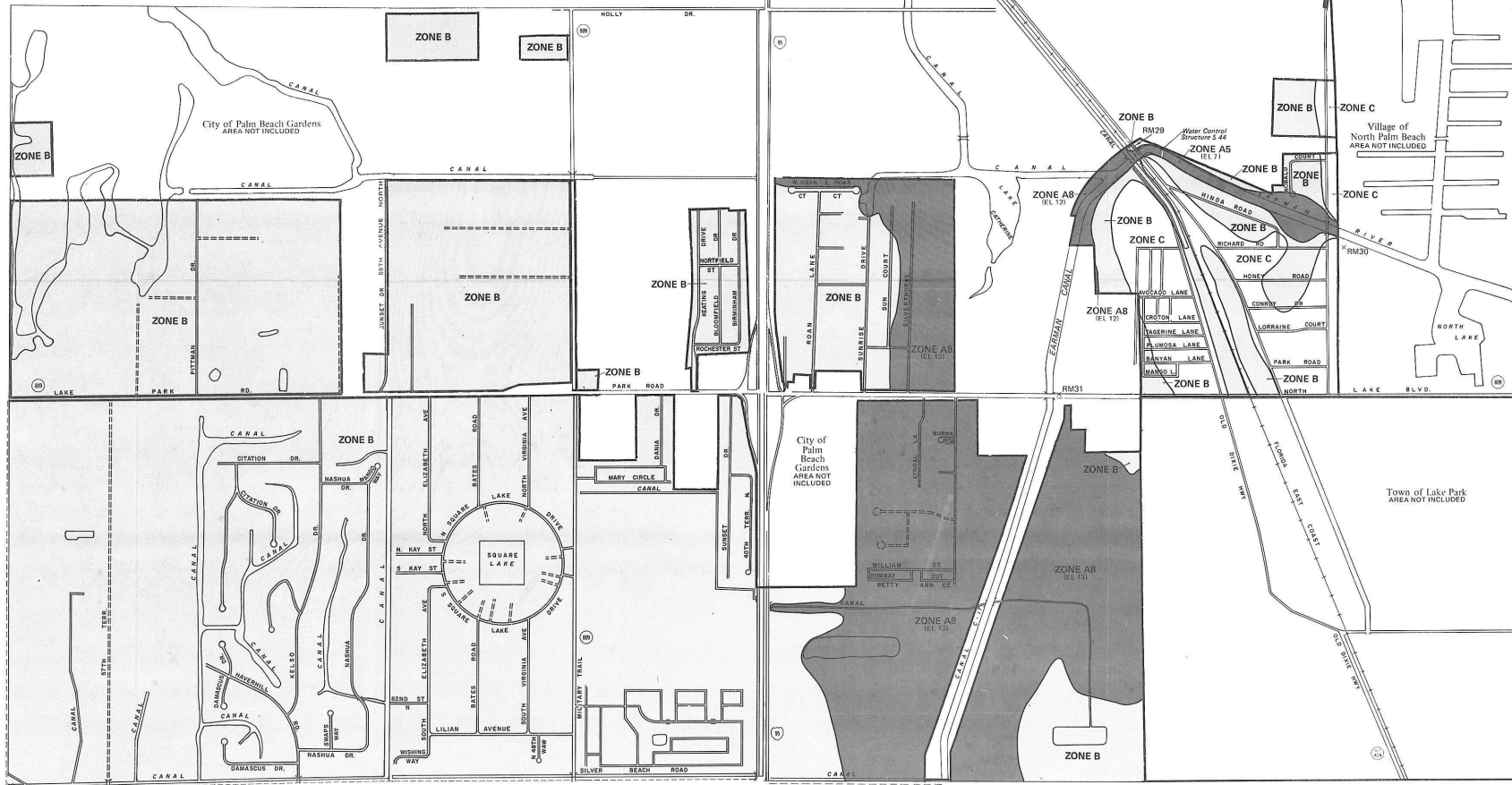

KEY TO MAP

500-Year Flood Boundary
 100-Year Flood Boundary
 Zone Designations* With Date of Identification
 e.s., 12/2/74
 100-Year Flood Boundary
 500-Year Flood Boundary

Base Flood Elevation Line With Elevation in Feet**

Base Flood Elevation in Feet Where Uniform Within Zone** (EL 987)

Elevation Reference Mark RM7x

River Mile • M1.5

**Referenced to the National Geodetic Vertical Datum of 1929

***EXPLANATION OF ZONE DESIGNATIONS**

ZONE	EXPLANATION
A	Area of 100-year flood; base flood elevations and flood hazard factors not determined.
A0	Area of 100-year shallow flooding where depths are between one (1) and three (3) feet average depths of inundation are shown, but no flood hazard factors are determined.
AH	Area of 100-year shallow flooding where depths are between one (1) and three (3) feet; base flood elevations are shown, but no flood hazard factors are determined.
A1-A30	Area of 100-year flood; base flood elevations and flood hazard factors determined.
A99	Area of 100-year flood to be protected by flood protection system under construction; base flood elevations and flood hazard factors not determined.
B	Area between limits of the 100-year flood and 500-year flood; or certain areas subject to 100-year flooding with average depths less than one (1) foot or where the contributing drainage area is less than one square mile or area protected by levees from the base flood. (Medium shading)
C	Area of minimal flooding. (No shading)
D	Area of undetermined, but possible, flood hazards.
V	Area of 100-year coastal flood with velocity (wave action); base flood elevations and flood hazard factors not determined.
V1-V30	Area of 100-year coastal flood with velocity (wave action); base flood elevations and flood hazard factors determined.

NOTES TO USER

Certain areas not in the special flood hazard areas (zones A and V) may be protected by flood control structures.

This map is for flood insurance purposes only; it does not necessarily show all areas subject to flooding in the community or all planimetric features outside special flood hazard areas.

For adjoining map panels, see separately printed Index To Map Panels.

INITIAL IDENTIFICATION
 JUNE 17, 1970

CONVERSION TO REGULAR PROGRAM
 FEBRUARY 1, 1979

Refer to the CONVERSION TO REGULAR PROGRAM date shown on this map to determine when actuarial rates apply to structures in the zones where elevations or depths have been established.

To determine if flood insurance is available in this community, contact your insurance agent, or call the National Flood Insurance Program, at (800) 638-6629, or (800) 425-8872.

APPROXIMATE SCALE
 0 100 200 FEET

NATIONAL FLOOD INSURANCE PROGRAM

FIRM FLOOD INSURANCE RATE MAP

PALM BEACH COUNTY, FLORIDA (UNINCORPORATED AREAS)

PANEL 130 OF 245
 (SEE MAP INDEX FOR PANELS NOT SHOWN)

COMMUNITY-PANEL NUMBER 12092-0130 A

EFFECTIVE DATE: FEBRUARY 1, 1979

U.S. DEPARTMENT OF HOUSING AND URBAN DEVELOPMENT FEDERAL INSURANCE ADMINISTRATION

Historic from Microfiche