

Section P - 50' Perimeter Compatibility Buffer

Planting for this buffer shall consist of:

- A minimum 2' ht. continuous opaque visual screen composed of planting alone or in combination with a fence/wall/berm.
- 1 Canopy tree per 25 linear feet.
- For each 100 linear feet of buffer length the following plants shall be provided:
- 25 medium shrubs (24' ht) spaced 30' oc minimum
- 50 small shrubs (18' ht) spaced 24' oc minimum
- 200 ground cover (6' ht) plants

P - 50' Perimeter Compatibility Buffer (North Boundary Pod F)

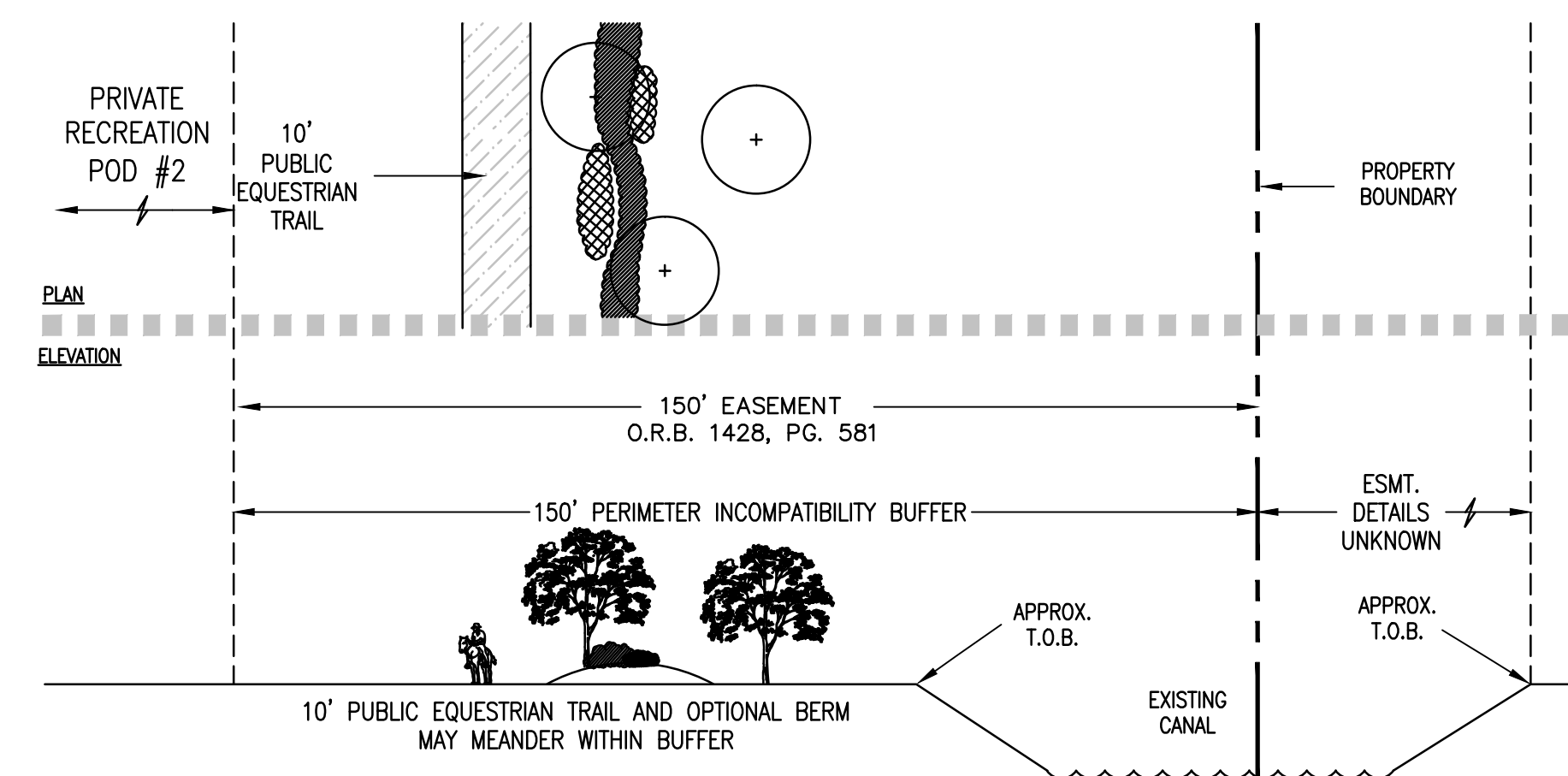

Section T - 150' Perimeter Incompatibility Buffer

Planting for this buffer shall consist of:

- A minimum 2' ht. continuous opaque visual screen composed of planting alone or in combination with a fence/wall/berm.
- 1 Canopy tree per 20 linear feet.
- For each 100 linear feet of buffer length the following plants shall be provided:
- 25 large shrubs (36' ht) spaced 48' oc minimum
- 25 medium shrubs (24' ht) spaced 30' oc minimum
- 50 small shrubs (18' ht) spaced 24' oc minimum
- 200 ground cover (6' ht) plants

T - 150' Perimeter Incompatibility Buffer

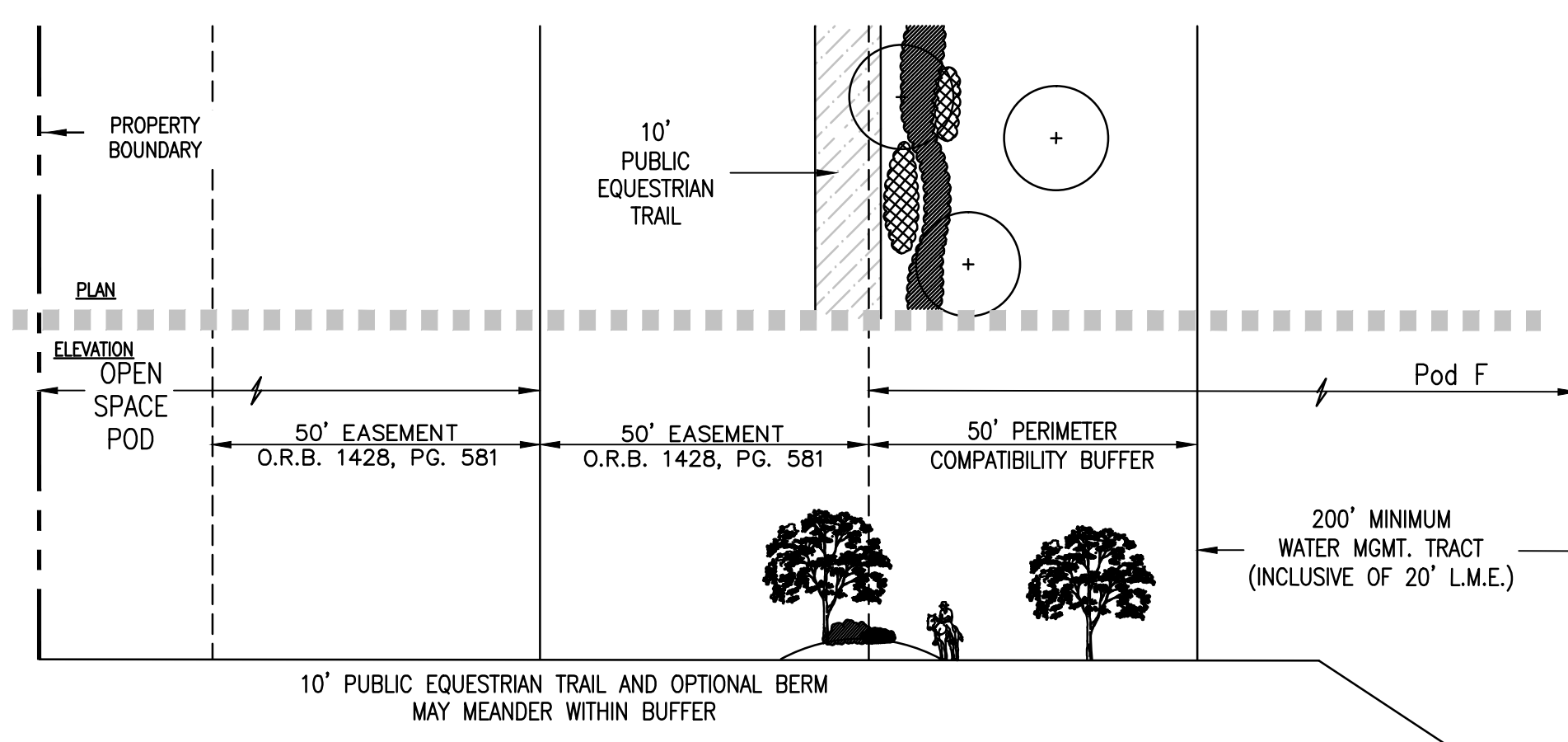

Section Q - 50' Perimeter Compatibility Buffer

Planting for this buffer shall consist of:

- A minimum 2' ht. continuous opaque visual screen composed of planting alone or in combination with a fence/wall/berm.
- 1 Canopy tree per 25 linear feet.
- For each 100 linear feet of buffer length the following plants shall be provided:
- 25 medium shrubs (24' ht) spaced 30' oc minimum
- 50 small shrubs (18' ht) spaced 24' oc minimum
- 200 ground cover (6' ht) plants

Q - 50' Perimeter Compatibility Buffer (West Boundary Pod F)

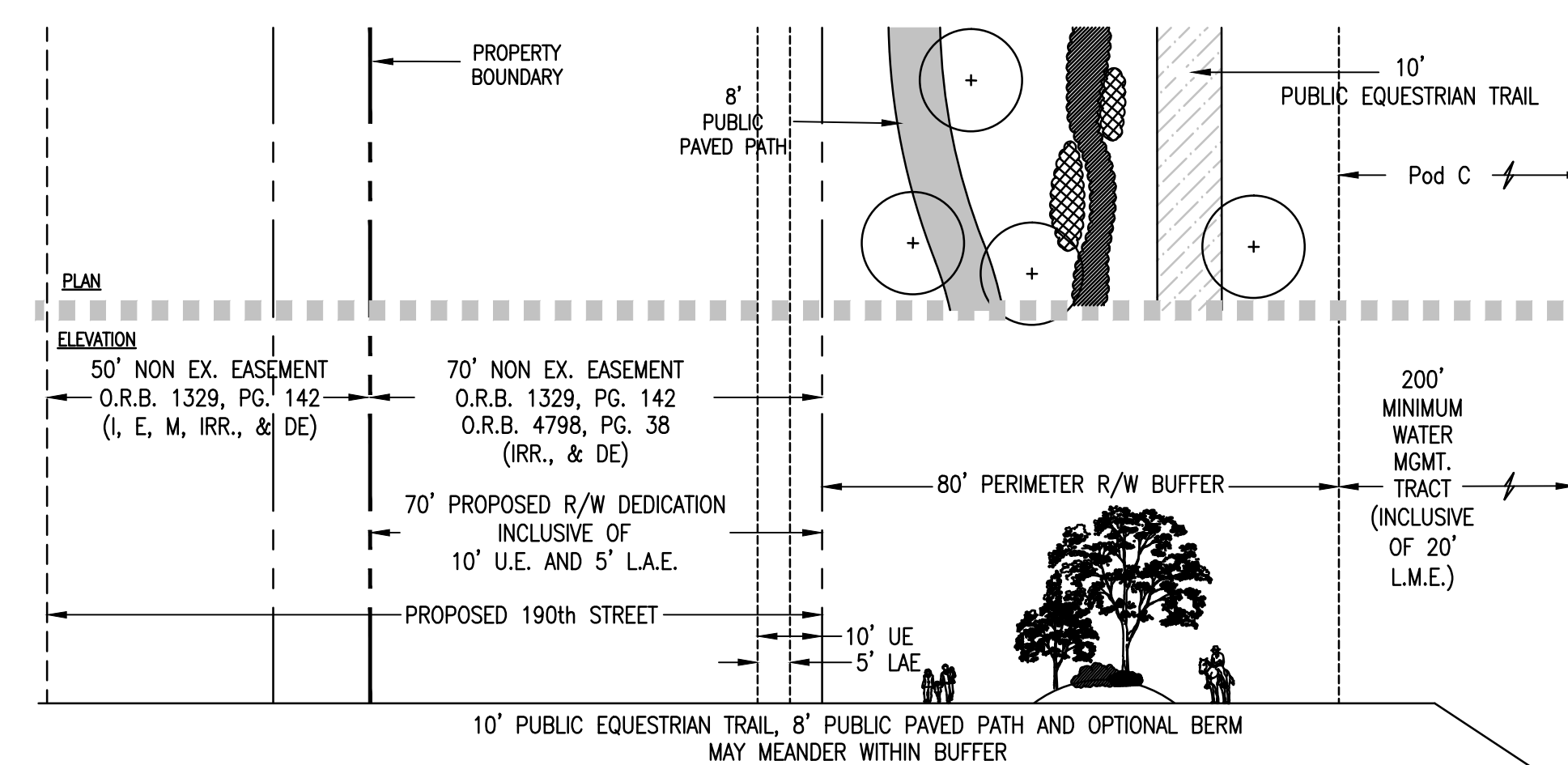

Section U - 80' Perimeter Right of Way Buffer

Planting for this buffer shall consist of:

- A minimum 2' ht. continuous opaque visual screen composed of planting alone or in combination with a fence/wall/berm.
- 1 Canopy tree per 25 linear feet.
- For each 100 linear feet of buffer length the following plants shall be provided:
- 25 large shrubs (36' ht) spaced 48' oc minimum
- 25 medium shrubs (24' ht) spaced 30' oc minimum
- 50 small shrubs (18' ht) spaced 24' oc minimum
- 200 ground cover (6' ht) plants

U - 80' Perimeter R/W Buffer - 190TH ST. N.

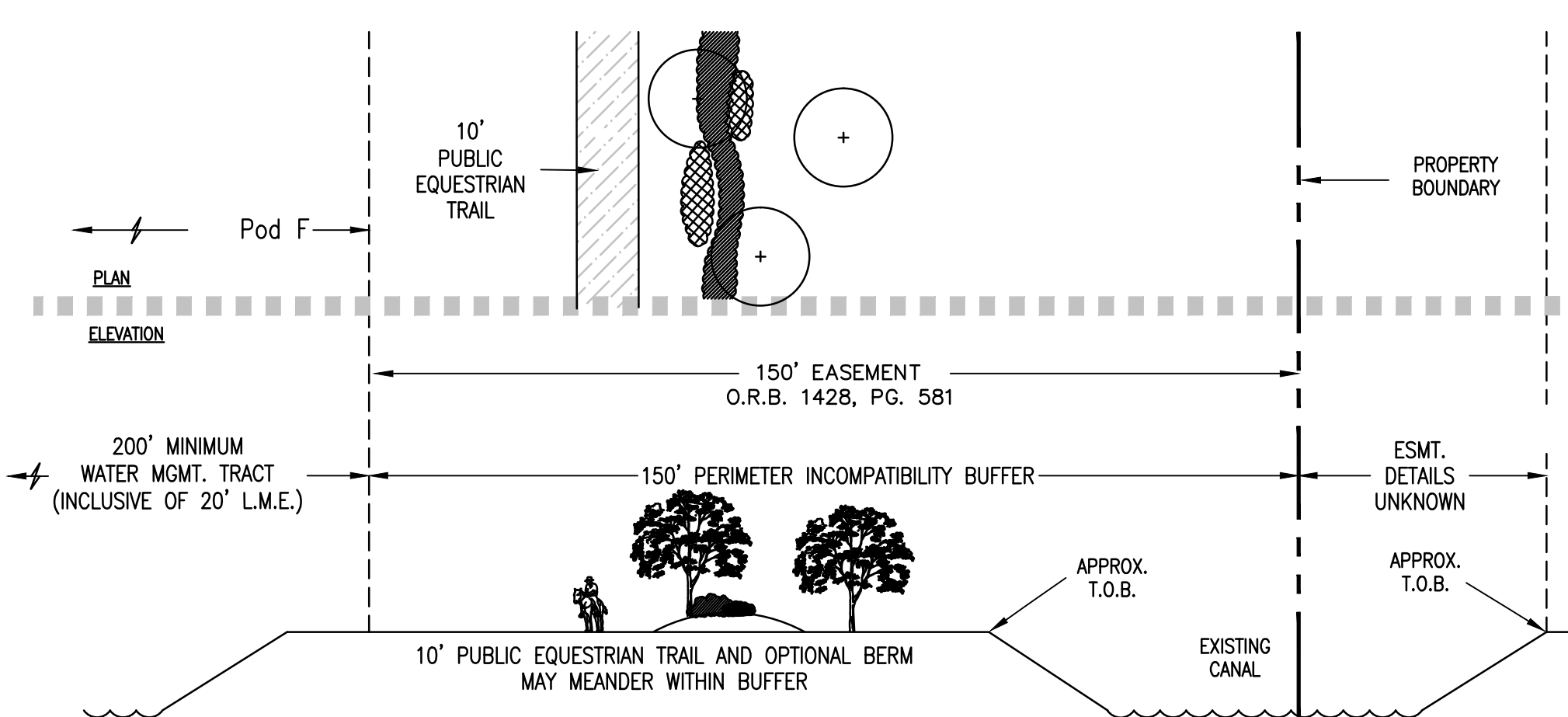

Section R - 150' Perimeter Incompatibility Buffer

Planting for this buffer shall consist of:

- A minimum 2' ht. continuous opaque visual screen composed of planting alone or in combination with a fence/wall/berm.
- 1 Canopy tree per 25 linear feet.
- For each 100 linear feet of buffer length the following plants shall be provided:
- 25 large shrubs (36' ht) spaced 48' oc minimum
- 25 medium shrubs (24' ht) spaced 30' oc minimum
- 50 small shrubs (18' ht) spaced 24' oc minimum
- 200 ground cover (6' ht) plants

R - 150' Perimeter Incompatibility Buffer

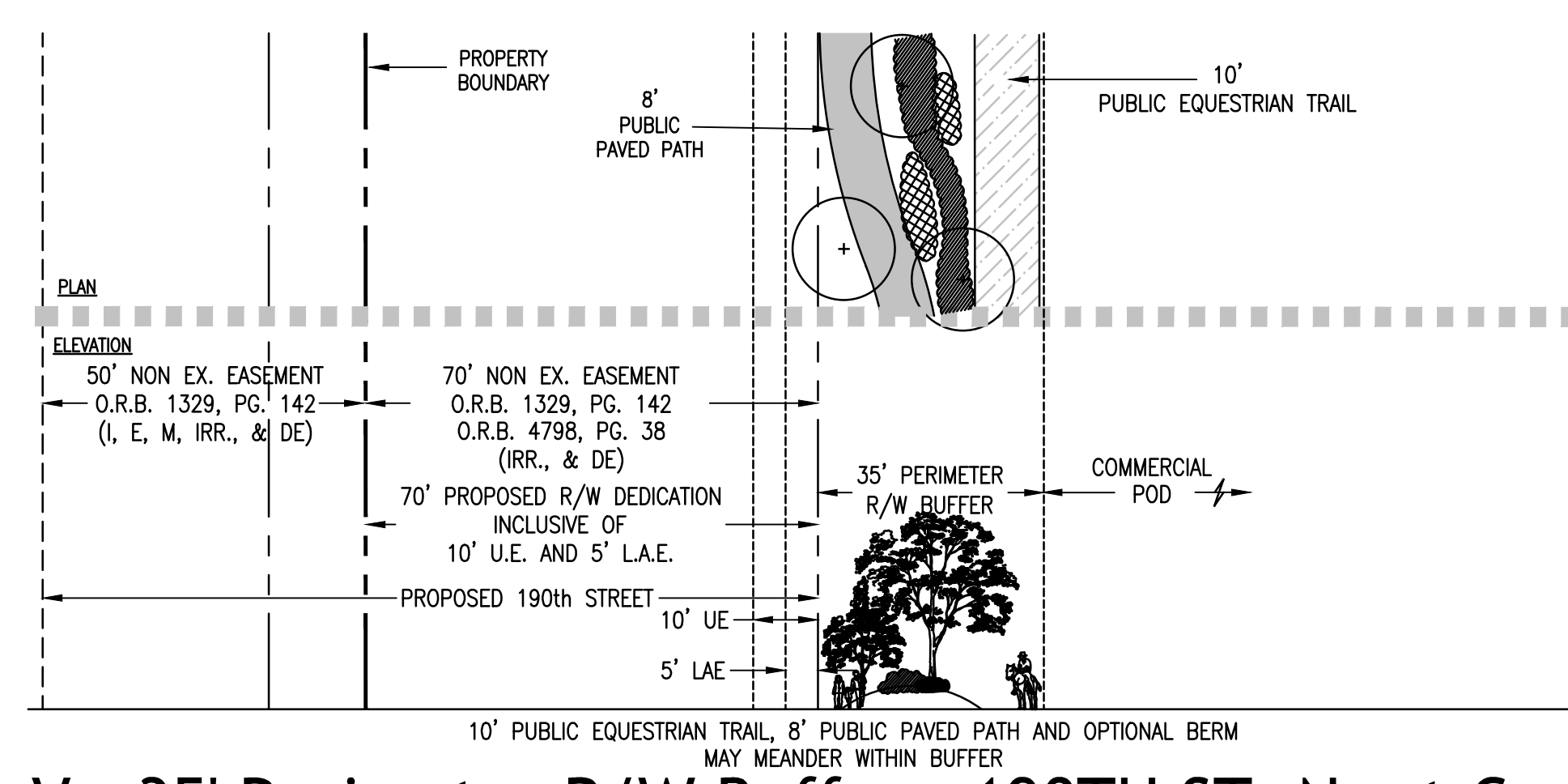

Section V - 80' Perimeter Right of Way Buffer

Planting for this buffer shall consist of:

- A minimum 2' ht. continuous opaque visual screen composed of planting alone or in combination with a fence/wall/berm.
- 1 Canopy tree per 25 linear feet.
- For each 100 linear feet of buffer length the following plants shall be provided:
- 25 large shrubs (36' ht) spaced 48' oc minimum
- 25 medium shrubs (24' ht) spaced 30' oc minimum
- 50 small shrubs (18' ht) spaced 24' oc minimum
- 200 ground cover (6' ht) plants

V - 35' Perimeter R/W Buffer - 190TH ST. N. at Commercial Pod

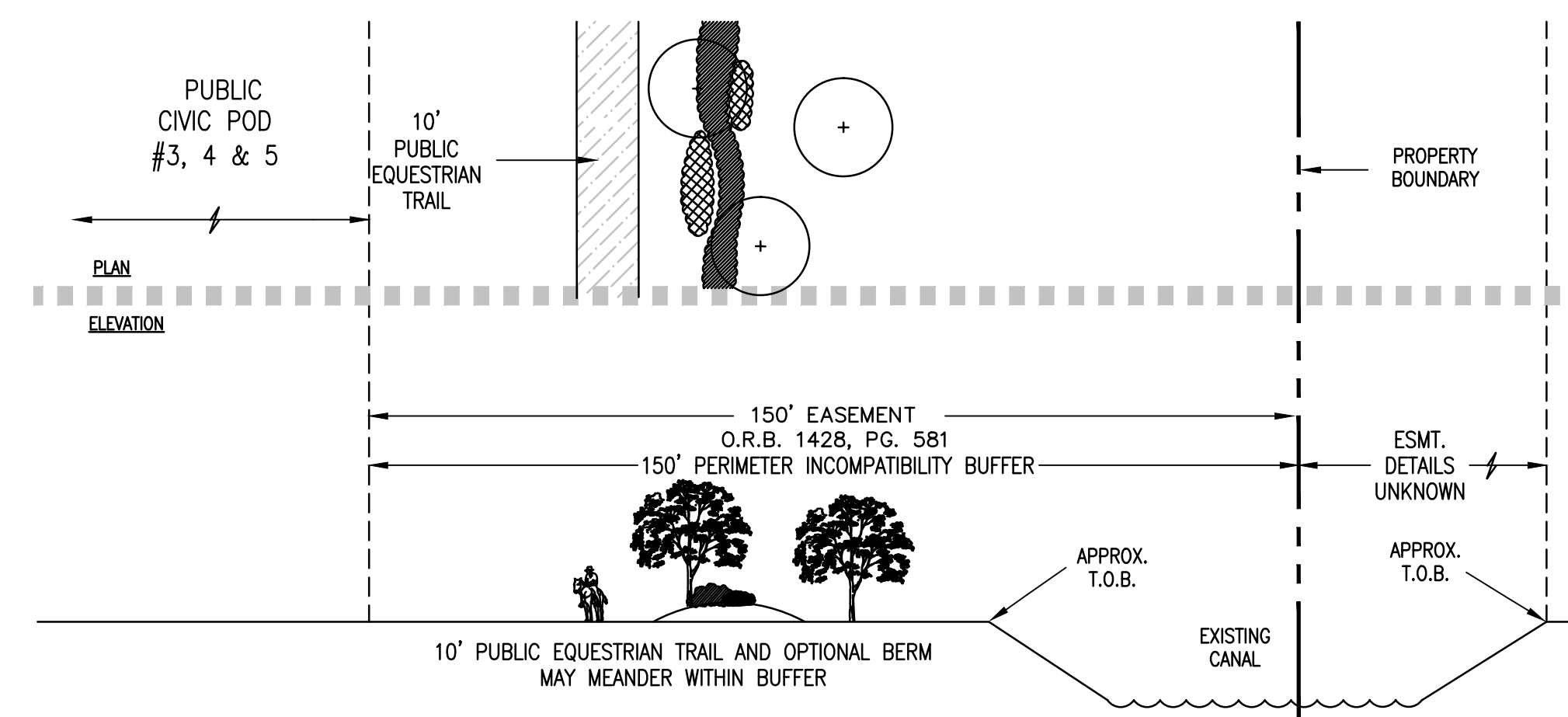

Section S - 150' Perimeter Incompatibility Buffer

Planting for this buffer shall consist of:

- A minimum 2' ht. continuous opaque visual screen composed of planting alone or in combination with a fence/wall/berm.
- 1 Canopy tree per 20 linear feet.
- For each 100 linear feet of buffer length the following plants shall be provided:
- 25 large shrubs (36' ht) spaced 48' oc minimum
- 25 medium shrubs (24' ht) spaced 30' oc minimum
- 50 small shrubs (18' ht) spaced 24' oc minimum
- 200 ground cover (6' ht) plants

S - 150' Perimeter Incompatibility Buffer

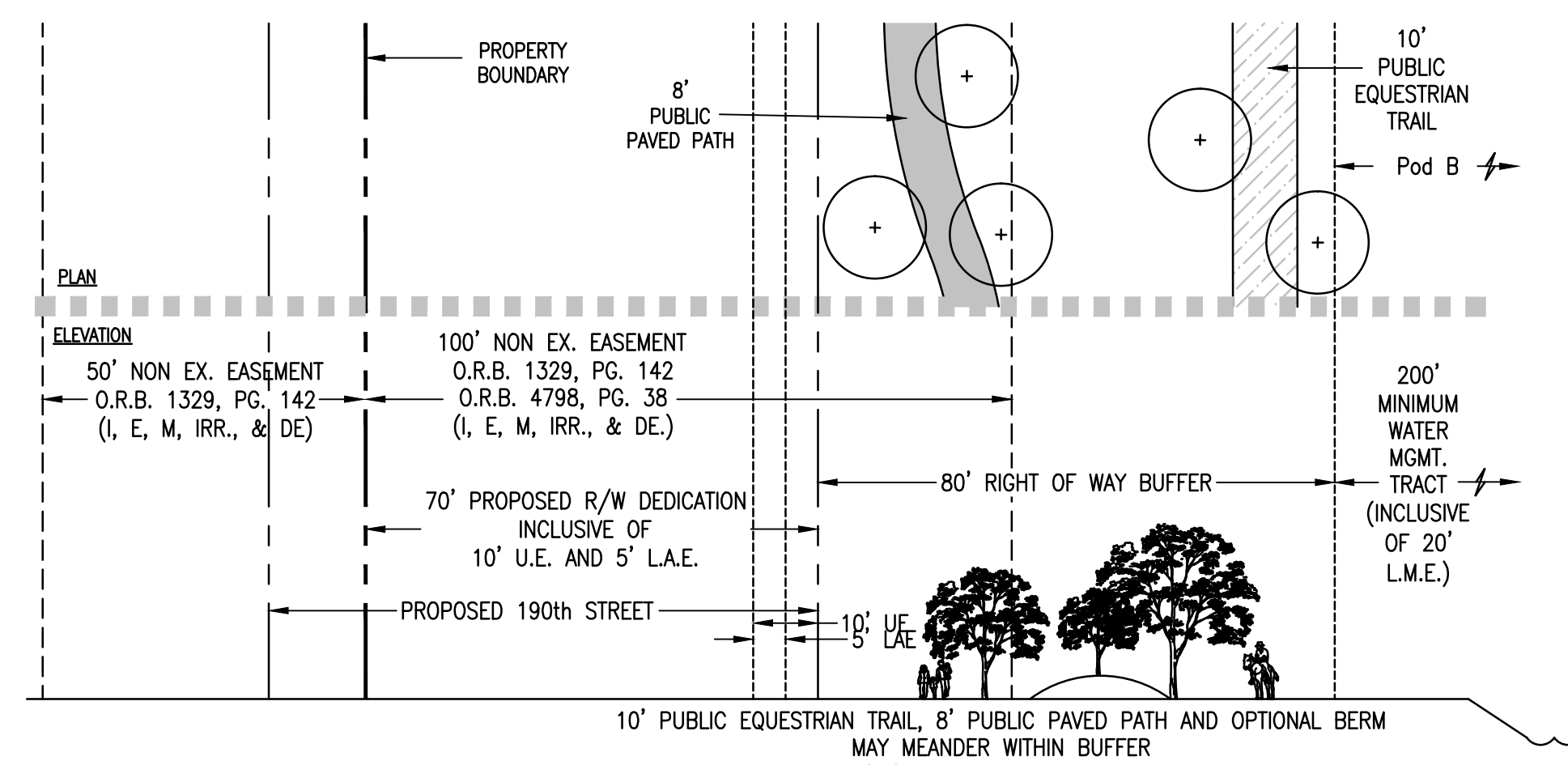

Section W - 80' Perimeter Right of Way Buffer

Planting for this buffer shall consist of:

- A minimum 2' ht. continuous opaque visual screen composed of planting alone or in combination with a fence/wall/berm.
- 1 Canopy tree per 25 linear feet.
- For each 100 linear feet of buffer length the following plants shall be provided:
- 25 large shrubs (36' ht) spaced 48' oc minimum
- 25 medium shrubs (24' ht) spaced 30' oc minimum
- 50 small shrubs (18' ht) spaced 24' oc minimum
- 200 ground cover (6' ht) plants

W - 80' Perimeter R/W Buffer - 190TH ST. N. at Pod B

PALM BEACH WEST ASSOCIATES I, LLLP
 1600 SAWGRASS CORPORATE PKWY SUITE 400
 SUNRISE, FLORIDA 33323
 954-753-1730

Consultants:
CIVIL ENGINEER
 GLH Engineering, LLC
 1600 Sawgrass Corporate Pkwy Suite 400
 Sunrise, FL 33323
 954-753-1730
SURVEYOR
 Sand and Hills Survey, Inc.
 8461 Lake Worth Road, Suite 410
 Lake Worth, FL 33467
 (561) 209-6048
TRAFFIC ENGINEER
 Simmons and White
 2581 Metrocentre Blvd, Suite 3
 West Palm Beach, FL 33407
 (561) 478-7848
PLANNERS
 Urban Design Kilday Studios
 610 Clematis Street, Suite CU02
 West Palm Beach, FL 33401
 (561) 366-1100

Project:
INDIAN TRAILS GROVE - PUD

Palm Beach County, Florida
Sheet title:
PRELIMINARY Regulating Plan

Date:
2015-07-15

Revisions:
 2015-09-28 Resubmittal

Amendments:

Zoning Stamps:

Sheet number:
PRP-5