

WEST BOYNTON 13

PALM BEACH COUNTY FLA.

THE DOLLAR LAND AND HOME CO. OWNER AND DEVELOPER

BEING A SUBDIVISION OF THE S.E. 1/4 OF THE NW 1/4

AND THE E. 1/4 OF THE SW 1/4 OF THE NW 1/4 OF SEC 19 TWP 45 S. R. 43 E.

SCALE 1"=100'

JUNE 1926

THE RIDDLE
ENG'G COMPANY

15-13

5319
20
RS
R-74-80
19740129

13 December
1926
The Riddle
Eng'g Co.

WEST BOYNTON - PLAT 2 - SHEET 1

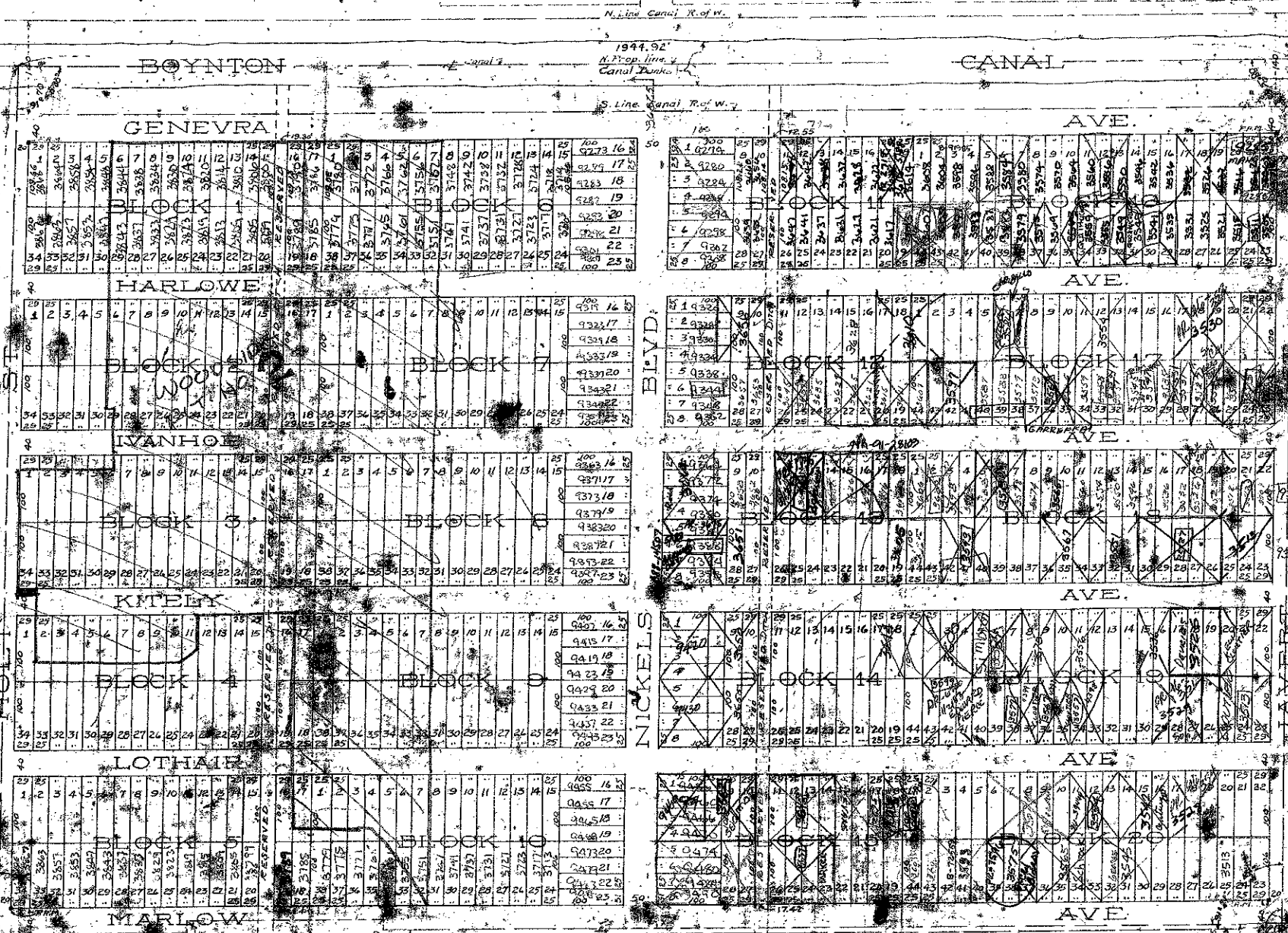

STATE OF FLORIDA } S.S.
 COUNTY OF PALM BEACH }
 I HEREBY CERTIFY that the attached plat
 is a true and correct representation of a survey made under
 my direction and that it is accurate to the best of my
 knowledge and belief.

Wm. H. Baker
 Notary Public
 Fla. State Cert. # 216

Subscribed and sworn to before me at West Palm Beach,
 Florida this 13th day of June, A.D. 1926.

James R. Patterson
 Notary Public

My commission expires
 January 13, 1927

Approved: Dec 13 1926
J. H. Boyd
 County Engineer

NOTE:
 SEE AVONDALE PINES U.I.R.

WEST BOYNTON - PLAT 2 - SHEET 1