

Caloosa 1st Addition

(a rural subdivision)

Lying in sections 20, 21,
28, 29, Township 41 So.,
Range 41 East, Palm
Beach County, Florida.

CALOOSA 1ST ADDITION

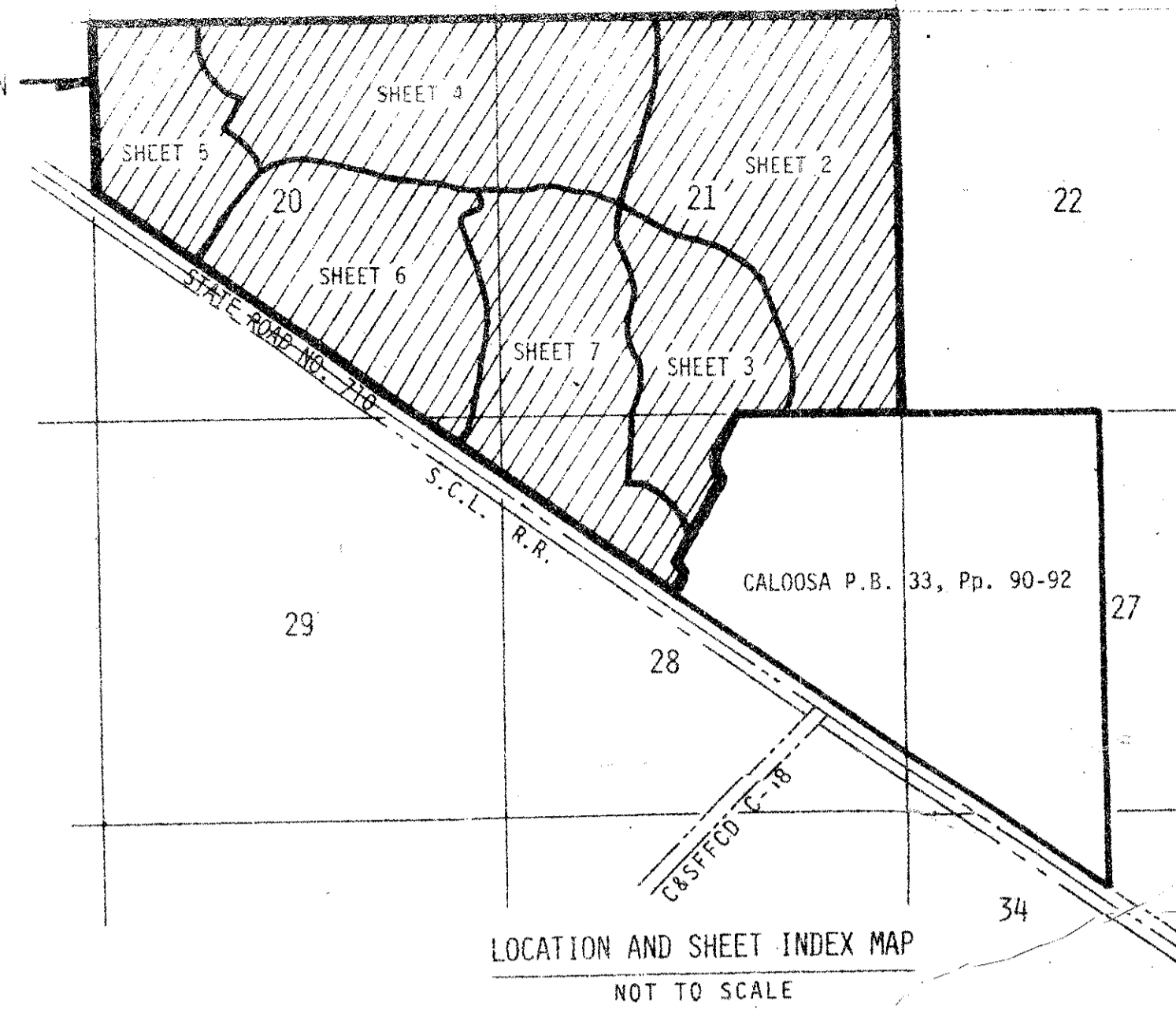

56

STATE OF FLORIDA
COUNTY OF PALM BEACH
This Plat was filed for
Record at 10:10 A.M.
this 9th day of March
AD., 1978 and duly re-
corded in Plat Book 34
on Pages 56 and 62.
JOHN B. DUNKLE, Clerk
Circuit Court,
BY: *[Signature]*

DEDICATION:

KNOW ALL MEN BY THESE PRESENTS THAT FOX TRAIL, INC., A FLORIDA CORPORATION, HOLDER OF THE LAND SHOWN HEREON, BEING ALL OF SECTION 21, AND A PORTION OF SECTIONS 20, 28 AND 29, OF TOWNSHIP 41 SOUTH, RANGE 41 EAST, PALM BEACH COUNTY, FLORIDA, SHOWN HEREON AS CALOOSA 1ST ADDITION, A RURAL SUBDIVISION, AND BEING MORE PARTICULARLY DESCRIBED AS FOLLOWS:

BEGINNING AT THE SOUTHEAST CORNER OF SAID SECTION 21; THENCE, NORTH 01°23'59" EAST, ALONG THE EAST LINE OF SAID SECTION 21, A DISTANCE OF 5317.10 FEET TO THE NORTHEAST CORNER OF SAID SECTION 21; THENCE, NORTH 88°28'22" WEST, ALONG THE NORTH LINE OF SAID SECTION 21, A DISTANCE OF 5348.54 FEET TO THE NORTHWEST CORNER OF SAID SECTION 21; THENCE, NORTH 88°17'31" WEST, ALONG THE NORTH LINE OF SAID SECTION 20, A DISTANCE OF 5375.46 FEET TO THE NORTHWEST CORNER OF SAID SECTION 20; THENCE, SOUTH 02°25'24" EAST, ALONG THE WEST LINE OF SAID SECTION 20, A DISTANCE OF 2892.21 FEET TO THE NORTHERLY RIGHT OF WAY LINE OF STATE ROAD NO. 710 (A 200 FOOT ROAD RIGHT OF WAY); THENCE, SOUTH 53°17'12" EAST, ALONG SAID NORTHERLY RIGHT OF WAY LINE, A DISTANCE OF 4505.88 FEET TO THE SOUTH LINE OF SAID SECTION 20; THENCE, CONTINUE SOUTH 53°17'12" EAST, ALONG SAID NORTHERLY RIGHT OF WAY LINE, A DISTANCE OF 1851.12 FEET TO THE EAST LINE OF SAID SECTION 29; THENCE, CONTINUE SOUTH 53°17'12" EAST, ALONG SAID NORTHERLY RIGHT OF WAY LINE, A DISTANCE OF 2365.29 FEET TO THE MOST WESTERLY CORNER OF LOT 20 AS SHOWN ON PLAT OF CALOOSA, AS RECORDED IN PLAT BOOK 33, PAGES 90 THROUGH 92, INCLUSIVE, PUBLIC RECORDS, PALM BEACH COUNTY, FLORIDA; THENCE, ALONG THE FOLLOWING COURSES COMPRISING THE WESTERLY AND NORTHERLY BOUNDARY OF SAID PLAT OF CALOOSA:

NORTH 36°42'48" EAST, A DISTANCE OF 630.00 FEET; THENCE, NORTH 53°17'12" WEST, A DISTANCE OF 164.84 FEET; THENCE, NORTH 45°10'57" EAST, A DISTANCE OF 638.27 FEET TO A POINT ON A CURVE CONCAVE TO THE NORTHEAST, HAVING A RADIUS OF 400.00 FEET, AND WHOSE RADIUS POINT BEARS NORTH 85°27'21" EAST; THENCE, NORTHERLY, ALONG THE ARC OF SAID CURVE, THROUGH A CENTRAL ANGLE OF 31°55'27", A DISTANCE OF 222.87 FEET TO THE POINT OF TANGENCY; THENCE, NORTH 27°22'48" EAST, A DISTANCE OF 1049.94 FEET TO THE POINT OF CURVATURE OF A CURVE TO THE LEFT, HAVING A RADIUS OF 510.91 FEET; THENCE, NORTHERLY, ALONG THE ARC OF SAID CURVE, THROUGH A CENTRAL ANGLE OF 28°25'22", A DISTANCE OF 253.45 FEET TO THE END OF SAID CURVE AND THE SOUTH LINE OF SAID SECTION 21; THENCE, NORTH 88°57'26" EAST, ALONG THE SOUTH LINE OF SAID SECTION 21, A DISTANCE OF 2195.00 FEET TO THE SOUTHEAST CORNER OF SAID SECTION 21 AND THE POINT OF BEGINNING.

CONTAINING: 1346.71 ACRES, MORE OR LESS.

FOX TRAIL, INC., A FLORIDA CORPORATION, HAS CAUSED THE SAME TO BE SURVEYED AND PLATTED AS SHOWN HEREON AND DOES HEREBY DEDICATE UNTO NORTHERN PALM BEACH COUNTY WATER CONTROL DISTRICT A PERPETUAL EASEMENT IN AND TO ALL DRAINAGE EASEMENTS SHOWN HEREON TOGETHER WITH THE EXCLUSIVE RIGHT TO TAKE, USE, SELL, DISPOSE OF AND ENJOY ANY TIMBER, EARTH, SPOIL, STONE, ROCK OR GRAVEL LYING IN OR UPON SAID DRAINAGE EASEMENTS AND DOES HEREBY DEDICATE UNTO NORTHERN PALM BEACH COUNTY WATER CONTROL DISTRICT A PERPETUAL NON-EXCLUSIVE EASEMENT IN AND TO ALL INGRESS AND EGRESS EASEMENTS AS SHOWN HEREON FOR THE PURPOSE OF MAINTENANCE.

FOX TRAIL, INC.

ATTEST: *[Signature]*
SECRETARY, WILMA A. ELMORE

BY: *[Signature]*
PRESIDENT, GEORGE T. ELMORE

NORTHERN PALM BEACH COUNTY WATER CONTROL DISTRICT HEREBY ACCEPTS THE GRANT HEREIN CONTAINED OF DRAINAGE EASEMENTS AND AGREES TO MAINTAIN SAME AS PART OF WATER CONTROL SYSTEM AND HEREBY ACCEPTS THE GRANT HEREIN CONTAINED OF INGRESS AND EGRESS EASEMENTS AND AGREES TO MAINTAIN SAME.

NORTHERN PALM BEACH COUNTY
WATER CONTROL DISTRICT

BY: *[Signature]*
CHAIRMAN

ACKNOWLEDGEMENT:

STATE OF FLORIDA
COUNTY OF PALM BEACH

FOX TRAIL, INC.

BEFORE ME PERSONALLY APPEARED GEORGE T. ELMORE AND WILMA A. ELMORE, TO ME WELL KNOWN, AND KNOWN TO ME TO BE THE INDIVIDUALS DESCRIBED IN AND WHO EXECUTED THE FOREGOING INSTRUMENT AS GEORGE T. ELMORE, PRESIDENT AND WILMA A. ELMORE, SECRETARY OF THE ABOVE NAMED, FOX TRAIL, INC., A FLORIDA CORPORATION, AND SEVERALLY ACKNOWLEDGED TO AND BEFORE ME THAT THEY EXECUTED SUCH INSTRUMENT AS SUCH PRESIDENT AND SECRETARY, RESPECTIVELY, OF SAID CORPORATION, AND THAT THE SEAL AFFIXED TO THE FOREGOING INSTRUMENT IS THE CORPORATE SEAL OF SAID CORPORATION AND THAT IT WAS AFFIXED TO SAID INSTRUMENT BY DUE AND REGULAR CORPORATE AUTHORITY, AND THAT SAID INSTRUMENT IS THE FREE ACT AND DEED OF SAID CORPORATION.

WITNESS MY HAND AND OFFICIAL SEAL THIS, 15th DAY OF NOVEMBER, A.D., 1977.

[Signature]

NOTARY PUBLIC

MY COMMISSION EXPIRES 3/15/80

MORTGAGEE'S CONSENT:

STATE OF FLORIDA
COUNTY OF PALM BEACH

THOMAS M. METTLER, AS TRUSTEE, HEREBY CERTIFIES THAT HE IS THE HOLDER OF A MORTGAGE UPON THE PROPERTY DESCRIBED HEREON AND DOES HEREBY JOIN IN AND CONSENT TO THE DEDICATION OF THE LAND DESCRIBED IN SAID DEDICATION BY THE OWNER THEREOF AND AGREES THAT THE MORTGAGE, WHICH IS RECORDED IN OFFICIAL RECORD BOOK ON PAGE(S) OF THE PUBLIC RECORDS OF PALM BEACH COUNTY, FLORIDA, SHALL BE SUBORDINATED TO THE DEDICATION SHOWN HEREON.

IN WITNESS WHEREOF, I, THOMAS M. METTLER, AS TRUSTEE, DO HEREBY SET MY HAND AND SEAL THIS 15 DAY OF November, 1977.

[Signature]
WITNESS

[Signature]
THOMAS M. METTLER, AS TRUSTEE

[Signature]
WITNESS

ACKNOWLEDGMENT:

STATE OF FLORIDA
COUNTY OF PALM BEACH

BEFORE ME PERSONALLY APPEARED THOMAS M. METTLER, AS TRUSTEE, TO ME WELL KNOWN AND KNOWN TO ME TO BE THE PERSON DESCRIBED IN AND WHO EXECUTED THE FOREGOING INSTRUMENT, AND ACKNOWLEDGED BEFORE ME THAT HE EXECUTED SAID INSTRUMENT FOR THE PURPOSES EXPRESSED THEREIN.

WITNESS MY HAND AND OFFICIAL SEAL THIS 15 DAY OF November, 1977.

NOTARY PUBLIC: *[Signature]*
MY COMMISSION EXPIRES 1-29-80

TITLE CERTIFICATION:

STATE OF FLORIDA
COUNTY OF PALM BEACH

I, ROBERT C. SCOTT, A DULY LICENSED ATTORNEY, IN THE STATE OF FLORIDA, DO HEREBY CERTIFY THAT I HAVE EXAMINED THE TITLE TO THE HEREON DESCRIBED PROPERTY; THAT I FIND THE TITLE TO THE PROPERTY IS VESTED TO FOX TRAIL, INC., A FLORIDA CORPORATION; THAT THE CURRENT TAXES HAVE BEEN PAID; AND THAT I FIND THE PROPERTY IS ENCUMBERED BY THE MORTGAGES SHOWN HEREON AND THAT ALL MORTGAGES ARE SHOWN AND ARE TRUE AND CORRECT.

DATE February 22, 1978 BY: *[Signature]*
ROBERT C. SCOTT, ATTORNEY

SURVEYORS CERTIFICATE

THIS IS TO CERTIFY THAT THE PLAT SHOWN HEREON IS A TRUE AND CORRECT REPRESENTATION OF A SURVEY MADE UNDER MY RESPONSIBLE DIRECTION AND SUPERVISION AND THAT SAID SURVEY IS ACCURATE TO THE BEST OF MY KNOWLEDGE AND BELIEF AND THAT (P.R.M.'S) PERMANENT REFERENCE MONUMENTS HAVE BEEN PLACED AS REQUIRED BY LAW AND FURTHER THAT THE SURVEY DATA COMPLIES WITH ALL REQUIREMENTS OF CHAPTER 177 FLORIDA STATUTES, AS AMENDED, AND ORDINANCES OF PALM BEACH COUNTY, FLORIDA.

[Signature]
WILLIAM R. VAN CAMPEN
REGISTERED SURVEYOR NO. 2424
STATE OF FLORIDA

**APPROVAL - PALM BEACH COUNTY, FLORIDA
BOARD OF COUNTY COMMISSIONERS**

THIS PLAT IS HEREBY APPROVED FOR RECORD, THIS 7 DAY OF March, A.D., 1978.
BY: *[Signature]* (SEAL)
CHAIRMAN, BOARD OF COUNTY COMMISSIONERS

COUNTY ENGINEER

THIS PLAT IS HEREBY APPROVED FOR RECORD, THIS 7 DAY OF March, A.D., 1978.
BY: *[Signature]* (SEAL)
HERBERT F. CARLIER

ATTEST: JOHN B. DUNKLE, CLERK
BOARD OF COUNTY COMMISSIONERS

BY: *[Signature]*
DEPUTY CLERK

SPECIAL NOTES:

- INDICATES A PERMANENT REFERENCE MONUMENT (P.R.M.) FLORIDA CERTIFICATE NO. 2424.
- ALL LOTS SHOWN HEREON CONTAIN MORE THAN 217,800 SQUARE FEET OR 5,000/ACRES.
- THE BEARINGS AS SHOWN HEREON ARE BASED ON THE BEARING OF NORTH 53°17'12" WEST AS SHOWN ALONG THE RIGHT OF WAY LINES OF STATE ROAD NO. 710 AS PER MAPS ON FILE IN ROAD BOOK 2, PAGES 149 THROUGH 154, INCLUSIVE, PUBLIC RECORDS, PALM BEACH COUNTY, FLORIDA.

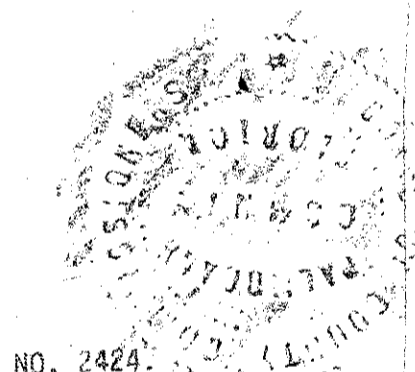

204214 / 28429 / 41 / 41
02/9-300

THIS INSTRUMENT WAS PREPARED BY ROBERT J. WHIDDEN OF BENCH MARK LAND SURVEYING AND MAPPING, INC., 2300 PALM BEACH LAKES BOULEVARD, SUITE 109, WEST PALM BEACH, FLORIDA, PHONE 689-2111.



CALOOSA

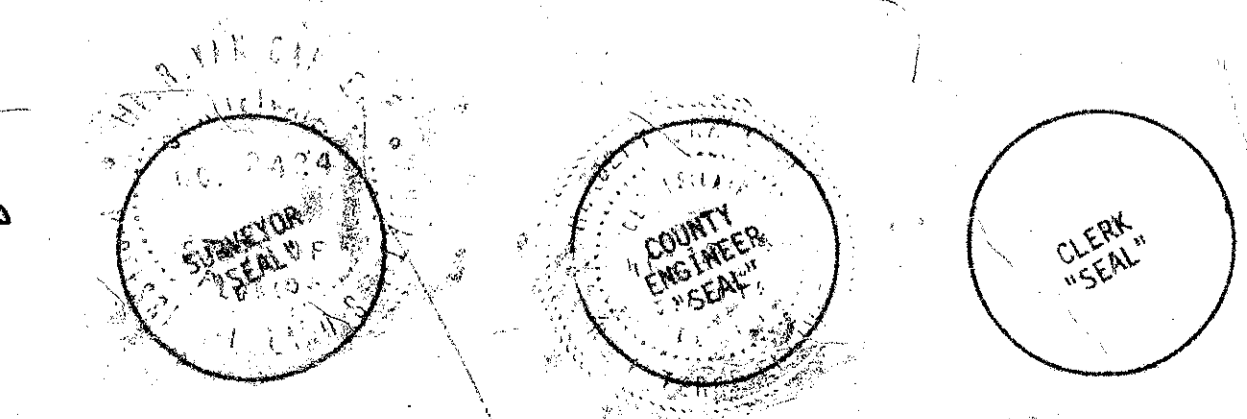

BENCH MARK land surveying and mapping, inc.					
CONRAD W. SCHAEFER CONSULTING ENGINEERS, INC. PALM BEACH COUNTY, FLORIDA					
34					
RECORD PLAT					
56					
DESIGNED	DRAWN	CHECKED	FILE NO.	SHEET	OF
	W.S.K.		77	1	7
DATE	SCALE	APPROVED	FILE NO.	SHEET	OF
	1" = 200'			1	7