

SIERRA DEL MAR

190

A PORTION OF SECTION 21, TOWNSHIP 47 SOUTH, RANGE 42 EAST, PALM BEACH COUNTY, FLORIDA, BEING A REPLAT OF A PORTION OF TRACT N° 6 OF BOCA DEL MAR, PLAT N° 5 AS RECORDED IN PLAT BOOK 30, PAGES 127-128 OF THE PALM BEACH COUNTY PUBLIC RECORDS
WALTER A. CORNNELL, INC. CONSULTING ENGINEERS & LAND SURVEYORS BOCA RATON, FLORIDA

JANUARY 1978 SHEET 1 OF 2

COUNTY OF PALM BEACH
STATE OF FLORIDA
This Plat was filed for record at 9:16 A.M.
this 8th day of June
1978 and duly recorded in Plat Book
No. 34 on page 190+191
JOHN B. DUNKLE, Clerk Circuit Court
By Lyle J. ...

DEDICATION

KNOW ALL MEN BY THESE PRESENTS that Housing Adventures, Inc., a Florida Corporation, owner of the land described hereon: A portion of Tract G of BOCA DEL MAR N° 5, in Section 21, Township 47 South, Range 42 East, shown on the plat as recorded in Plat Book 30, Pages 127-128 of the Public Record of Palm Beach County, Florida, said portion of Tract G being more particularly described as follows: BEGINNING at the South East corner of said Tract G, thence run N 00° 32' 15" W, an assumed bearing, a distance of 390.00 feet to a point of curve, being concave to the South West, having a central angle of 92° 19' 09" and a radius of 150.00 feet; thence run North West along the arc of said curve, an arc distance of 241.69 feet to the end of said curve; thence run S 87° 08' 36" W, a distance of 925.00 feet to a point; thence run S 02° 51' 24" E a distance of 513.99 feet to a point; thence run N 80° 30' 00" E, a distance of 392.58 feet to a point of curve concave to the south, having a central angle of 31° 00' 00" and a radius of 1472.39 feet; thence run easterly along the arc of said curve, thru an angle of 26° 26' 45", an arc distance of 679.61 feet to a point being the POINT OF BEGINNING of this parcel lying and being in Palm Beach County, Florida, containing 11.93 acres more or less, shown hereon as SIERRA DEL MAR.

- Has caused the same to be surveyed and platted as shown hereon and do hereby dedicate as follows:
1. Parcel C as Street Rights-of-way to SIERRA DEL MAR Property Owners Association, Inc. for street purposes and is the maintenance obligation of said association.
 2. The drainage easements and utility easements in perpetuity for the construction and maintenance of drainage facilities and utilities.
 3. The areas indicated as Limited Access Easement to the Board of County Commissioners of Palm Beach County, Florida, for the purposes of control and jurisdiction over access rights.
 4. Parcels A, B, L & M as Parking Tracts to SIERRA DEL MAR Property Owners Association, Inc. in perpetuity for the protection and Privacy of its members and is the maintenance obligation of said association.
 5. Parcels D, E & F as Pedestrian Ways to SIERRA DEL MAR Property Owners Association, Inc. in perpetuity for the Protection and Privacy of its members and is the maintenance obligation of said association.
 6. Parcels G, H, I, J & K as Landscape Areas to SIERRA DEL MAR Property Owners Association, Inc. in perpetuity for the Protection and Privacy of its members and is the maintenance obligation of said association.

IN WITNESS WHEREOF the above named corporation has caused these presents to be signed by its President and attested by its Secretary, and its corporate seal to be affixed hereto by and with the authority of its board of directors, this 1st day of May, 1978. HOUSING ADVENTURES, INC., a corporation of the State of Florida

Attest: Frank A. Gilman (Sec) By: Stanley Charles (Pres)

ACKNOWLEDGEMENT

STATE OF FLORIDA
COUNTY OF PALM BEACH

Before me personally appeared Stanley Charles and Kenneth M. Endelson, to me well known and known to me to be the individuals described in and who executed the foregoing instrument as President and Secretary of the above named HOUSING ADVENTURES, INC., a corporation and severally acknowledged to and before me that they executed such instrument as such officers of said Corporation, and that the seal affixed to the foregoing instrument is the corporate seal of said corporation and that it was affixed to said instrument by due and regular corporate authority, and that said instrument is the free act and deed of said corporation.

Witness my hand and official seal this 1st day of May, 1978.

Ruth Ann Thibodeau
Notary Public

MORTGAGEE'S CONSENT

STATE OF FLORIDA
COUNTY OF PALM BEACH

The undersigned hereby certifies that it is the holder of a mortgage upon the described property and does hereby join in and consent to the dedication of the lands described hereto by the Owner thereof and agrees that its mortgage which is recorded in official Record Book 2866 Pages 181 of the Public Records of Palm Beach County, Florida, shall be subordinated to the dedication shown hereon.

FINANCIAL FEDERAL SAVINGS & LOAN ASSOCIATION

In Witness Whereof, the said Corporation has caused these presents to be signed by its vice-president and attested by its ASST-Secretary and its corporate seal to be affixed hereon by and with the authority of its board of directors, this 24th day of May, 1978.

ATTEST: N. N. Mickwee
ASST. SECRETARY.

BY: Ways Smith
VICE-PRESIDENT.

ACKNOWLEDGEMENT

STATE OF FLORIDA
COUNTY OF PALM BEACH

BEFORE ME personally appeared WA. B. SMITH and N. N. MICKWEE to me well known and known to me to be the individuals described in and who executed the foregoing instrument, Vice President and ASST Secretary of the above named Financial Federal Savings & Loan Association and severally acknowledged to me and before me that they executed such instrument as such Vice President and ASST Secretary, respectively, of said corporation, and that the seal affixed to the foregoing instrument is the corporate seal of said corporation and it was affixed to said instrument by due and regular corporate authority and that said instrument is the free act and deed of said corporation.

Witness my hand and Official Seal, this 24th day of MAY, 1978.
My Commission expires September 20, 1980

Cynthia Lanaman
Notary Public

TITLE CERTIFICATE

STATE OF FLORIDA
COUNTY OF PALM BEACH

I, Robert B. Tanner, a duly licensed attorney in the State of Florida do hereby certify that I have examined the title to the hereon described property, that I found the property is vested to HOUSING ADVENTURES, INC.; that current taxes have been paid, and that the property is free of encumbrances this 25th day of MAY, 1978.

Robert B. Tanner
Attorney-at-Law, Licensed in Florida

APPROVAL - PALM BEACH, FLORIDA

BOARD OF COUNTY COMMISSIONERS

This Plat is hereby Approved for Record this 6 day of JUNE, 1978.

By: Peggy B. Evatt
Chairman, Peggy B. Evatt

COUNTY ENGINEER

This Plat is hereby Approved for Record this 6 day of JUNE, 1978.

By: H.F. Kahler
County Engineer H.F. Kahler P.E.

Attest: John B. Dunkle, Clerk
Board of County Commissioners
By: Marion B. Jennings
Deputy Clerk

SURVEYOR'S CERTIFICATE

This is to certify that the plat shown hereon is a true and correct representation of a survey made under my responsible direction and supervision and that said survey is accurate to the best of my knowledge and belief, and that (P.M.'s) Permanent Reference Monuments have been placed and (P.C.P.'s) Permanent Control Points shall be placed as required by Law and further that the survey data complies with all the requirements of Chapter 177, Florida Statutes, as amended and Ordinances of Palm Beach County, Florida.

Walter A. Cornell
Walter A. Cornell, P.E.
Registered Land Surveyor No 1757
State of Florida

LOCATION MAP

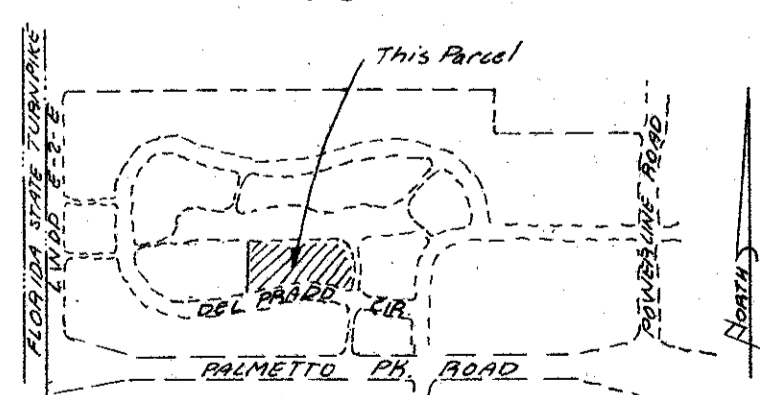

0205-363

This instrument was prepared by Kevin M. Cornell of Walter A. Cornell, Inc., 24 S.E. 4th Street, Boca Raton, Florida, 33432.

21/47/42

78
11.93 Ac.
6.54 Ac.
7.81 Ac.
5.81 Ac.
6.06 Ac.

34-190



Seals as to Housing Adventures, Inc. Seals as to Mortgagee

1 Apr 78
16 Mar 78
22 Feb 78