

# PLAT OF GARDENS PARK

IN SECTION 13, TOWNSHIP 42 SOUTH, RANGE 42 EAST,  
PALM BEACH COUNTY, FLORIDA.

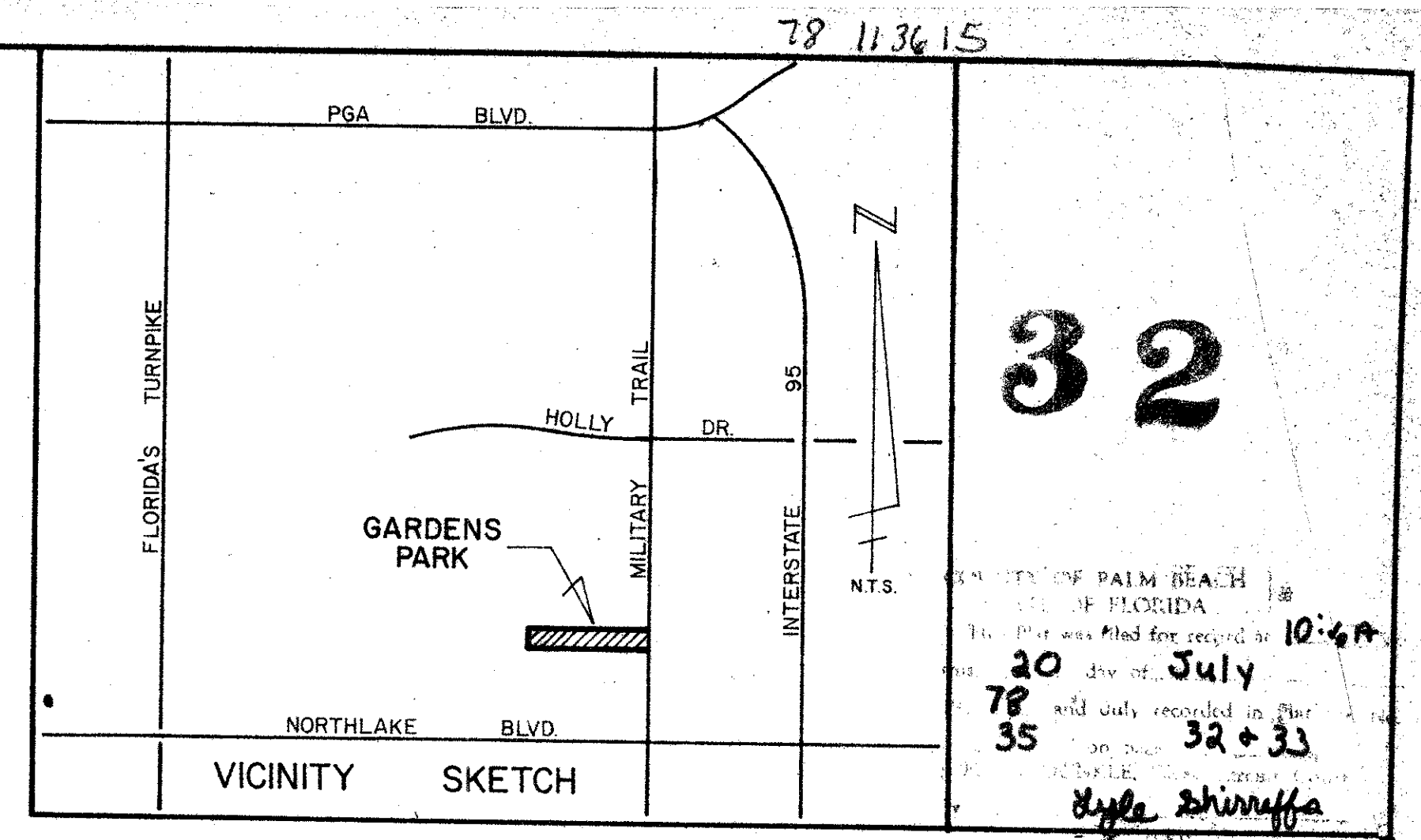

32

78 113615  
 COUNTY OF PALM BEACH  
 OF FLORIDA  
 This plat was filed for record on July 30, 1978, and duly recorded in Public Records on July 31, 1978, in Book 32-33.  
 Dyle Shuffa

**DEDICATION**

KNOW ALL MEN BY THESE PRESENTS that Brady Park, Inc., a Florida corporation, owner of land shown hereon, being in Section 13, Township 42 South, Range 42 East, Palm Beach County, Florida, shown hereon as Plat of Gardens Park, being more particularly described as follows:

The North half of the South half of the Northeast quarter of the Southwest quarter, less the East 67 feet for Right of Way, and the North half of the Southeast quarter of the Northwest quarter of the Southwest quarter of Section 13, Township 42 South, Range 42 East, Palm Beach County, Florida, containing 14.59 acres, more or less.

Have caused the same to be surveyed and platted as shown hereon and do hereby dedicate as follows:

**1. Streets:**

The streets as shown are hereby dedicated to the Board of County Commissioners of Palm Beach County, Florida, for perpetual use of the public for proper purposes.

**2. Easements:**

- a. Utility and Drainage Easements - The utility easements and drainage easements as shown are hereby dedicated in perpetuity for the construction and maintenance of utilities and drainage.
- b. Maintenance Easement - The maintenance easement as shown is dedicated to the Board of County Commissioners of Palm Beach County, Florida, for the purposes of access for maintenance purposes.
- c. Limited Access Easements - The limited access easements, as shown are dedicated to the Board of County Commissioners of Palm Beach County, Florida, for the purpose of control and jurisdiction over access rights.
- d. PARCEL "A" is hereby dedicated to the Gardens Park Home Owners Association and is the perpetual maintenance obligation of said association.

IN WITNESS WHEREOF, the above named corporation has caused these presents to be signed by its President and attested by its Secretary-Treasurer and its corporate seal to be affixed hereto by and with the authority of its Board of Directors, this 14 day of June, 1978.

BRADY PARK, INC., a corporation of the State of Florida  
 BY Lewis Daniello  
 Lewis Daniello, President

ATTEST:  
Richard Sander  
 Richard Sander, Secretary-Treasurer

**ACKNOWLEDGEMENT**

STATE OF FLORIDA  
 COUNTY OF PALM BEACH

BEFORE ME personally appeared Lewis Daniello and Richard Sander, to me well known and known to me to be the individuals described in and who executed the foregoing instrument as President and Secretary-Treasurer of the Brady Park, Inc., a corporation, and severally acknowledged to and before me that they executed such instrument as such officers of said corporation, and that the seal affixed to the foregoing instrument is the corporate seal of said corporation and that it was affixed to said instrument by due and regular corporate authority, and that said instrument is the free act and deed of said corporation.

WITNESS my hand and official seal this 2nd day of November, 1977.

William Bryant  
 Notary Public

My Commission Expires: 7-4-81

**MORTGAGEE'S CONSENT**

STATE OF FLORIDA  
 COUNTY OF PALM BEACH

The undersigned hereby certifies that it is the holder of a mortgage, lien, or other encumbrance upon the property described hereon and does hereby join in and consent to the dedication of the land described in said dedication by the owner thereof and agrees that its mortgage, lien or other encumbrance which is recorded in Official Record Book 2759 at Page 1889, of the public records of Palm Beach County, Florida, shall be subordinated to the dedication shown hereon.

IN WITNESS WHEREOF, I, Ruth Lorraine Brady, do hereunto set my hand and seal this 2nd day of November, 1977.

**WITNESSES:**

William Bryant  
Ruth Lorraine Brady  
 Ruth Lorraine Brady  
Ray Ambrose

**ACKNOWLEDGEMENT**

STATE OF FLORIDA  
 COUNTY OF PALM BEACH

BEFORE ME personally appeared Ruth Lorraine Brady to me well known and known to me to be the person described in and who executed the foregoing instrument and acknowledged before me that she executed said instrument for the purposes expressed therein.

WITNESS my hand and official seal this 2nd day of November, 1977.

My Commission Expires: 7-4-81

William Bryant  
 Notary Public

**APPROVALS**

BOARD OF COUNTY COMMISSIONERS  
 PALM BEACH COUNTY, FLORIDA.

This plat is hereby approved for record this 18 day of July, 1978.

By: Peggy B. Elliott  
 Peggy B. Elliott - Chairman

**COUNTY ENGINEER.**

This plat is hereby approved for record this 18 day of July, 1978.

By: Herb Kahler  
 Herb Kahler, County Engineer

ATTEST: JOHN B. DUNKLE, Clerk  
 BOARD OF COUNTY COMMISSIONERS

By: Margie B. Jennings  
 Deputy Clerk

13/42/42

SEALS

**TITLE CERTIFICATION**

STATE OF FLORIDA  
 COUNTY OF PALM BEACH

I, William J. Bosso, Sr., a duly licensed attorney in the State of Florida, do hereby certify that I have examined the title to the hereon described property; that I find the title to the property is vested to Brady Park, Inc.; that the current taxes have been paid, and that the property is encumbered by the mortgages shown hereon; and that I find that all mortgages are shown and are true and correct.

William J. Bosso Sr.  
 William J. Bosso, Sr.  
 Attorney at Law  
 Licensed in Florida  
 Date: November 2, 1977

**SURVEYOR'S CERTIFICATION**

STATE OF FLORIDA  
 COUNTY OF PALM BEACH

This is to certify that the plat shown hereon is a true and correct representation of a survey made under my responsible direction and that said survey is accurate to the best of my knowledge and belief and that (P.R.M.'s) Permanent Reference Monuments have been placed as required by law and furthermore that (P.C.P.'s) Permanent Control Points will be set under the guarantees posted with Palm Beach County for the Required Improvements and further that the survey data complies with all the requirements of Chapter 177 Florida Statutes, as amended, and ordinances of Palm Beach County, Florida.

Craig Wallace  
 Craig Wallace  
 Professional Land Surveyor  
 Fla. Certificate No. 3357

**MORTGAGEE'S CONSENT**

STATE OF FLORIDA  
 COUNTY OF PALM BEACH

The undersigned hereby certifies that it is the holder of a mortgage, lien, or other encumbrance upon the property described hereon and does hereby join in and consent to the dedication of the land described in said dedication by the owner thereof and agrees that its mortgage, lien, or other encumbrance which is recorded in Official Record Book 3235 at page 132 of the public records of Palm Beach County, Florida, shall be subordinated to the dedication shown hereon.

IN WITNESS WHEREOF, the said corporation has caused these presents to be signed by its Assistant Vice President and attested by its Secretary and its corporate seal to be affixed hereto by and with the authority of its Board of Directors this 15th day of June, 1978.

FIRST FEDERAL SAVINGS AND LOAN  
 ASSOCIATION OF LAKE WORTH  
 By: Maynard C. Hamblin  
 Maynard C. Hamblin  
 Assistant Vice President

**ATTEST:**

G. G. Bannerman  
 G. G. Bannerman, Secretary

**ACKNOWLEDGEMENT**

STATE OF FLORIDA  
 COUNTY OF PALM BEACH

BEFORE ME personally appeared Maynard C. Hamblin and G. G. Bannerman, to me well known, and known to me to be the individuals described in and who executed the foregoing instrument as Assistant Vice President and Secretary of the FIRST FEDERAL SAVINGS AND LOAN ASSOCIATION OF LAKE WORTH, a corporation, and severally acknowledged to and before me that they executed such instrument as such officers of said corporation, and that the seal affixed to the foregoing instrument is the corporate seal of said corporation and that it was affixed to said instrument by due and regular corporate authority, and that said instrument is the free act and deed of said corporation.

WITNESS my hand and official seal this 15th day of June, 1978.

My Commission Expires:

May L. Lister  
 Notary Public

1000-103

28

This instrument was prepared by Craig L. Wallace, at the office of William G. Wallace, Inc., 321 Northlake Boulevard, Suite 109, North Palm Beach, Florida 33408

PLAT OF

GARDENS PARK

WILLIAM G. WALLACE, INC.  
 Consulting Engineers & Land Surveyors

321 Northlake Blvd., Suite 113, North Palm Beach, Florida

|        |        |         |           |          |          |
|--------|--------|---------|-----------|----------|----------|
| FIELD  | K.N.   | JOB NO. | J76-779   | FILE NO. | 13-42-42 |
| OFFICE | L.S.C. | DATE    | OCT. 1977 | DWG. NO. | 76-471   |
| CK'D.  | K.S.   | REF.    |           | SHEET    | 1 OF 2   |

