

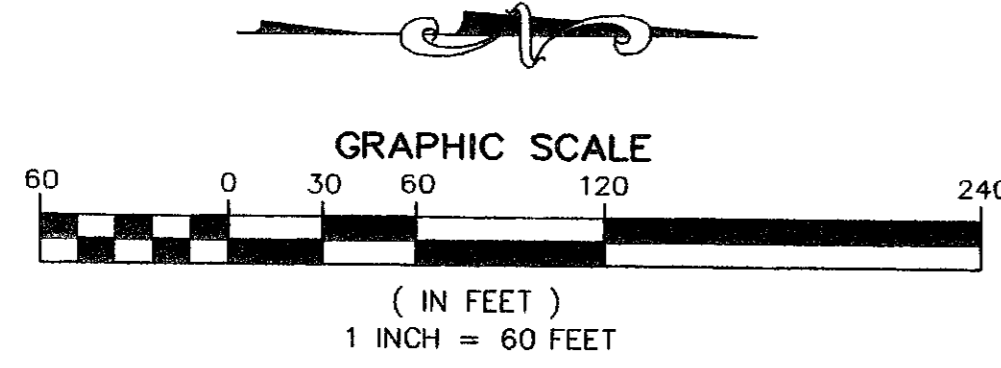

MERRY PLACE

A REPLAT OF A PORTION OF PLEASANT CITY, AS RECORDED IN PLAT BOOK 1, PAGE 1, TOGETHER WITH A REPLAT OF A PORTION OF THE UPDATE ADDITION TO PLEASANT CITY AND CURRIE ADDITION TO PALM BEACH NORTH, AS RECORDED IN PLAT BOOK 3, PAGE 3, TOGETHER WITH A PORTION OF PALM BEACH NORTH RESUBDIVISION OF BLOCKS 7 AND 8, AS RECORDED IN PLAT BOOK 8, PAGE 77, ALL OF THE PUBLIC RECORDS OF PALM BEACH COUNTY, FLORIDA, LYING IN SECTION 16, TOWNSHIP 43 SOUTH, RANGE 43 EAST, CITY OF WEST PALM BEACH, PALM BEACH COUNTY, FLORIDA

PREPARED BY
DONALD L. TODD
OF
ATLANTIC-CARIBBEAN MAPPING, INC.
357 LIANA DRIVE - WEST PALM BEACH, FLORIDA 33415
(561)964-7884
NOVEMBER - 2006

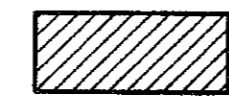

-  DENOTES AREAS OF ADDITIONAL RIGHTS-OF-WAY CREATED BY THIS PLAT
-  DENOTES AREAS THAT RIGHTS-OF-WAY AND UTILITY EASEMENTS WERE VACATED BY THIS PLAT

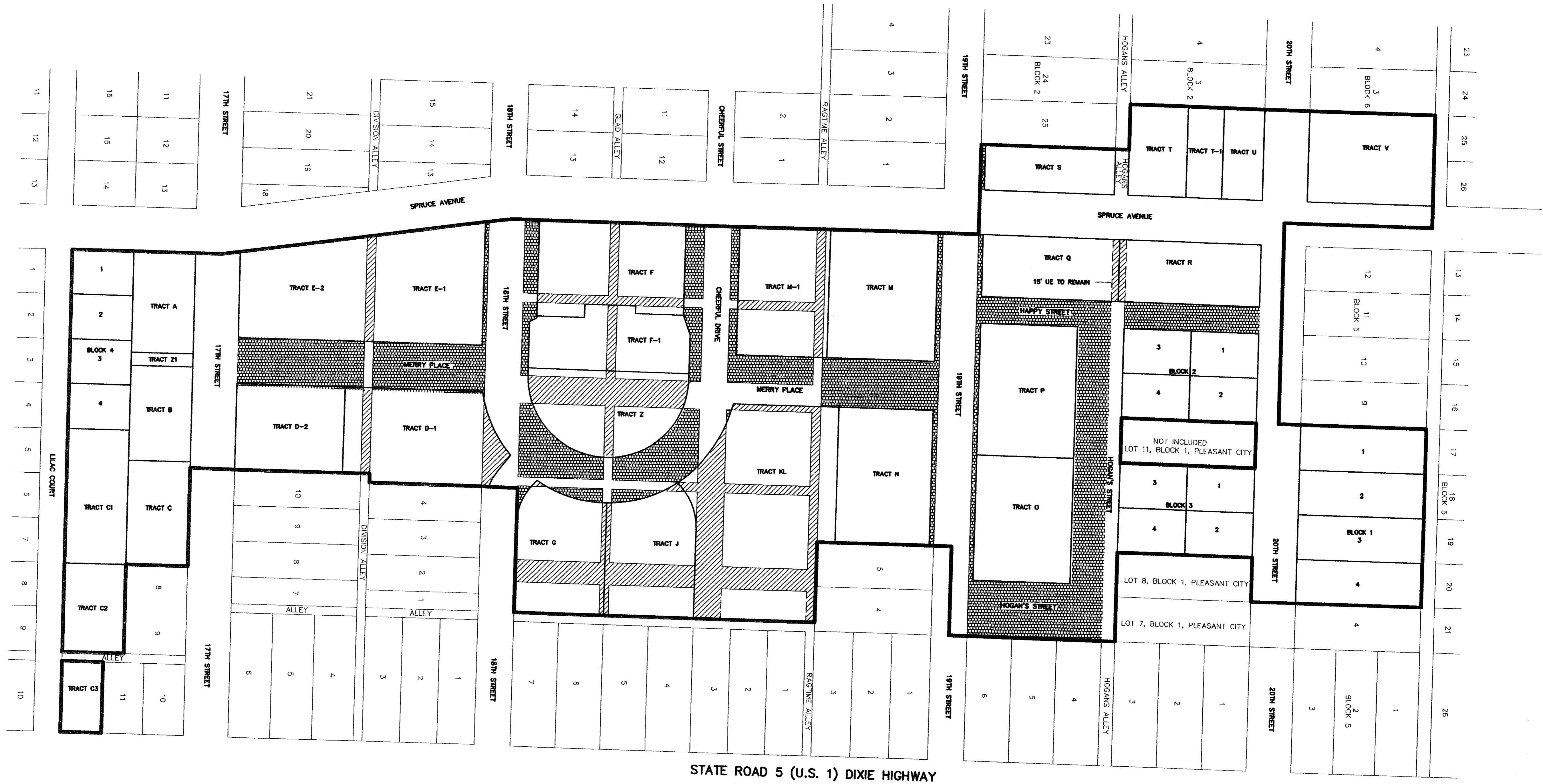

STATE ROAD 5 (U.S. 1) DIXIE HIGHWAY

194

STATE OF FLORIDA
COUNTY OF PALM BEACH
THIS PLAT WAS FILED FOR
RECORD AT _____ M.
THIS _____ DAY OF _____
A.D. 2006 AND DULY RECORDED
IN PLAT BOOK _____ ON
PAGES _____ AND _____

SHARON R. BOCK
CLERK AND COMPTROLLER

BY: _____
DEPUTY CLERK

SHEET 5 OF 5