

STATE OF FLORIDA
 COUNTY OF PALM BEACH
 THIS PLAT WAS FILED FOR
 RECORD AT _____ M.
 THIS _____ DAY OF _____
 A.D. 20____ AND DULY RECORDED
 IN PLAT BOOK _____ ON
 PAGE(S) _____
 SHARON R. BOCK
 CLERK AND COMPTROLLER
 BY: _____
 DEPUTY CLERK

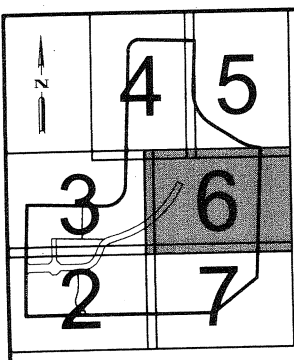

SHEET MAP
 NOT TO SCALE

MATCH LINE (SEE SHEET 5 OF 7)

ABBREVIATIONS:

- A = ARC LENGTH
- CL = CENTERLINE
- CHD. = CHORD
- D = DELTA ANGLE
- ESMT. = EASEMENT
- F.P.L. = FLORIDA LIGHTING AND POWER
- I.R. = IRON ROD
- I.R.C. = IRON ROD WITH CAP
- LB = LICENSED BUSINESS
- P. = PROPERTY LINE
- P.B.C.O.R. = PALM BEACH COUNTY OFFICIAL RECORDS
- P.B. = PLAT BOOK
- PCP = PERMANENT CONTROL POINT
- PG. = PAGE
- PRM = PERMANENT REFERENCE MONUMENT
- PSM = PROFESSIONAL SURVEYOR & MAPPER
- R = RADIUS
- RGE. = RANGE
- R/W = RIGHT OF WAY
- SEC. = SECTION
- TWP. = TOWNSHIP

LEGEND:

- = FOUND MONUMENT AS NOTED
- = SET 5/8" I.R.C STAMPED "ERDMAN ANTHONY LB7334"
- = SET 5/8" I.R.C STAMPED "ERDMAN ANTHONY LB7334 PRM"
- = SET MAG NAIL WITH WASHER STAMPED "EA LB7334"
- = SET MAG NAIL WITH WASHER STAMPED "EA LB7334 PRM"
- = SET MAG NAIL WITH WASHER STAMPED "EA LB7334 PCP"

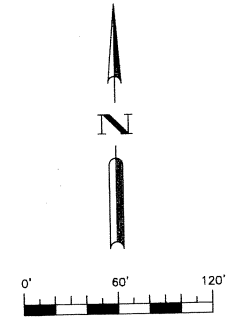

MATCH LINE (SEE SHEET 3 OF 7)



CURVE DATA					
NUMBER	ARC LENGTH	RADIUS	DELTA ANGLE	CHORD BEARING	CHORD LENGTH
C3	1082.23'	1315.00'	47°09'14"	N 49°04'38" E	1051.95'
C12	1115.15'	1355.00'	47°09'14"	N 49°04'38" E	1083.94'
C13	1049.31'	1275.00'	47°09'14"	S 49°04'38" W	1019.95'

MATCH LINE (SEE SHEET 7 OF 7)

ROYAL PALM BEACH COMMONS
 SECTION 26, TOWNSHIP 43 SOUTH, RANGE 41 EAST
 VILLAGE OF ROYAL PALM BEACH
 PALM BEACH COUNTY, FLORIDA

SHEET 6 OF 7

ERDMAN ANTHONY

1402 ROYAL PALM BEACH BOULEVARD
 SUITE 500
 ROYAL PALM BEACH, FL 33411
 TEL: 561-753-9723
 WWW.ERDMANANTHONY.COM
 © 2014 ERDMAN ANTHONY