

TRUMP NATIONAL GOLF CLUB, JUPITER, A P.U.D.

55

BEING A REPLAT OF TRACTS "F", "G", "G-1", "I", "P-1" THROUGH "P-10", INCLUSIVE, "W" THROUGH "W-7", INCLUSIVE, AND A PORTION OF TRACT "G-2", AS SHOWN ON RITZ-CARLTON GOLF CLUB & SPA REPLAT, JUPITER, A P.U.D., RECORDED IN PLAT BOOK 106, PAGES 97 THROUGH 119 AND A REPLAT OF TRACTS "G-3", "W-8A", "W-8B", "W-9" AND "W-10", AS SHOWN ON RITZ-CARLTON GOLF CLUB & SPA REPLAT NO. 3, JUPITER, A P.U.D., RECORDED IN PLAT BOOK 115, PAGES 177 THROUGH 179, ALL IN THE PUBLIC RECORDS OF PALM BEACH COUNTY, FLORIDA. LYING IN SECTION 19, TOWNSHIP 41 SOUTH, RANGE 43 EAST, TOWN OF JUPITER, PALM BEACH COUNTY, FLORIDA

AUGUST 2014

SHEET 2 OF 23

THE EAGLE TREE PROPERTY OWNERS' ASSOCIATION, INC. ACCEPTANCE OF DEDICATIONS:

STATE OF FLORIDA
COUNTY OF PALM BEACH

THE EAGLE TREE PROPERTY OWNERS' ASSOCIATION, INC., A FLORIDA CORPORATION NOT-FOR-PROFIT HEREBY ACCEPTS THE DEDICATIONS TO SAID ASSOCIATION AS STATED AND SHOWN HEREON, DATED THIS 5th DAY OF JUNE, 2015.

EAGLE TREE PROPERTY OWNERS' ASSOCIATION, INC.
A FLORIDA CORPORATION NOT-FOR-PROFIT

WITNESS: [Signature] BY: [Signature]
ANN CULLINANE
PRESIDENT

PRINT NAME: Nancy Salatho DeGuan
WITNESS: [Signature]
PRINT NAME: Lisa Y. Stewart

ACKNOWLEDGEMENT:

STATE OF FLORIDA
COUNTY OF PALM BEACH

BEFORE ME PERSONALLY APPEARED ANN CULLINANE WHO IS PERSONALLY KNOWN TO ME, OR HAS PRODUCED A DRIVER'S LICENSE AS IDENTIFICATION, AND WHO EXECUTED THE FOREGOING INSTRUMENT AS PRESIDENT OF THE EAGLE TREE PROPERTY OWNERS' ASSOCIATION, INC., A FLORIDA CORPORATION NOT-FOR-PROFIT AND SEVERALLY ACKNOWLEDGED TO AND BEFORE ME THAT SHE EXECUTED SUCH INSTRUMENT AS SUCH OFFICER OF SAID CORPORATION, AND THAT THE SEAL AFFIXED TO THE FOREGOING INSTRUMENT IS THE CORPORATE SEAL OF SAID CORPORATION AND THAT IT WAS AFFIXED TO SAID INSTRUMENT BY DUE AND REGULAR CORPORATE AUTHORITY, AND THAT SAID INSTRUMENT IS THE FREE ACT AND DEED OF SAID CORPORATION.

WITNESS MY HAND AND OFFICIAL SEAL THIS 5th DAY OF JUNE, 2015.

MY COMMISSION EXPIRES: 5/13/2017
[Signature]
NOTARY PUBLIC
PRINT NAME: HANNAH A. DOLRES
COMMISSION NO. FF011913

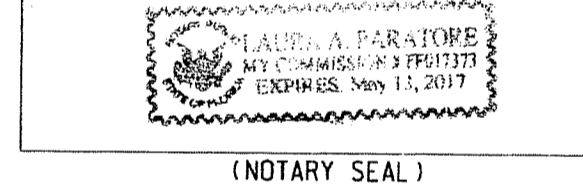

SURVEYOR'S NOTES:

- 1.) BEARINGS SHOWN HEREON ARE GRID AND ARE BASED ON THE SOUTH LINE OF TRACT "G-3A", SAID LINE BEARS NORTH 88°56'49" WEST.
- 2.) LINES, WHICH INTERSECT CURVES, ARE RADIAL UNLESS OTHERWISE NOTED.
- 3.) NOTICE: THIS PLAT, AS RECORDED IN ITS GRAPHIC FORM, IS THE OFFICIAL DEPICTION OF THE SUBDIVIDED LANDS DESCRIBED HEREIN AND WILL IN NO CIRCUMSTANCES BE SUPPLANTED IN AUTHORITY BY ANY OTHER GRAPHIC OR DIGITAL FORM OF THE PLAT. THERE MAY BE ADDITIONAL RESTRICTIONS THAT ARE NOT RECORDED ON THIS PLAT THAT MAY BE FOUND IN THE PUBLIC RECORDS OF THIS COUNTY.
- 4.) IN THOSE CASES WHERE EASEMENTS OF DIFFERENT TYPES CROSS OR OTHERWISE COINCIDE, DRAINAGE EASEMENTS SHALL HAVE THE FIRST PRIORITY, UTILITY EASEMENTS SHALL HAVE SECOND PRIORITY, ACCESS EASEMENTS SHALL HAVE THIRD PRIORITY, AND ALL OTHER EASEMENTS SHALL BE SUBORDINATE TO THESE WITH THEIR PRIORITY BEING DETERMINED BY USE RIGHTS GRANTED.
- 5.) THIS PLAT IS SUBJECT TO A SEWER EASEMENT DEED RECORDED IN OFFICIAL RECORD BOOK 14318, PAGE 926, PUBLIC RECORDS OF PALM BEACH COUNTY, FLORIDA, ACROSS "ALL ROADWAYS, RIGHT-OF-WAY, SEWERAGE, DRAINAGE AND UTILITY EASEMENTS AS INDICATED ON THE PLAT OF: RITZ-CARLTON GOLF CLUB & SPA, JUPITER, A P.U.D., AS RECORDED IN THE PUBLIC RECORDS OF PALM BEACH COUNTY, FLORIDA, PLAT BOOK 93, PAGES 171 THROUGH 192" TO THE EXTENT THAT THE LOCATION OF SAID EASEMENTS HAVE SURVIVED BY THIS REPLAT.
- 6.) THIS INSTRUMENT WAS PREPARED BY ERIC CASASUS, IN AND FOR THE OFFICES OF LIDBERG LAND SURVEYING, INC., 675 WEST INDIANTOWN ROAD, SUITE 200, JUPITER, FLORIDA 33458. TELEPHONE (561) 746-8454.

LOXAHATCHEE RIVER ENVIRONMENTAL CONTROL DISTRICT ACCEPTANCE:

STATE OF FLORIDA
COUNTY OF PALM BEACH

THE LOXAHATCHEE RIVER ENVIRONMENTAL CONTROL DISTRICT HEREBY ACCEPTS THE DEDICATION AS SHOWN HEREON FOR PROPER PURPOSES THIS 29 DAY OF MAY, 2015.

WITNESS: [Signature] BY: [Signature]
PRINT NAME: CURTIS R. YERKES (ALBREY ARINGTON Ph.D.)
EXECUTIVE DIRECTOR

WITNESS: [Signature]
PRINT NAME: DORIS HANNAH

TITLE CERTIFICATION:

STATE OF FLORIDA
COUNTY OF PALM BEACH

WE, FIRST AMERICAN TITLE INSURANCE COMPANY, A TITLE INSURANCE COMPANY, AS DULY LICENSED IN THE STATE OF FLORIDA, DO HEREBY CERTIFY THAT WE HAVE EXAMINED THE TITLE TO THE HERON DESCRIBED PROPERTY; THAT WE FIND THE TITLE TO THE PROPERTY IS VESTED IN JUPITER GOLF CLUB, LLC, A DELAWARE LIMITED LIABILITY COMPANY; THAT THE CURRENT TAXES HAVE BEEN PAID; AND THAT THERE ARE NO MORTGAGES OF RECORD.

FIRST AMERICAN TITLE INSURANCE COMPANY

DATE: May 28, 2015 BY: [Signature]
DOLRES HANNAH
AUTHORIZED SIGNATORY

TOWN OF JUPITER ACCEPTANCE:

STATE OF FLORIDA
COUNTY OF PALM BEACH

THIS PLAT IS HEREBY APPROVED FOR RECORD PURSUANT TO THE ORDINANCES OF THE TOWN OF JUPITER, AND IN ACCORDANCE WITH SECTION 177.071, FLORIDA STATUTES, THIS 15th DAY OF JUNE, 2015, AND HAS BEEN REVIEWED BY A PROFESSIONAL SURVEYOR AND MAPPER UNDER CONTRACT WITH THE TOWN OF JUPITER, IN ACCORDANCE WITH SECTION 177.081 (1), FLORIDA STATUTES.

BY: [Signature]
DOUG P. KOENIGKE, P.E.
TOWN ENGINEER

"TRUMP NATIONAL GOLF CLUB, JUPITER, A P.U.D." IS HEREBY APPROVED FOR RECORD THIS 15th DAY OF JUNE, 2015.

BY: [Signature] ATTEST: [Signature]
KAREN J. BOLOKAY, MAYOR SALLY M.J. BOYLAN, TOWN CLERK

SURVEYOR'S CERTIFICATION:

THIS IS TO CERTIFY THAT THE PLAT SHOWN HEREON IS A TRUE AND CORRECT REPRESENTATION OF A SURVEY MADE UNDER MY RESPONSIBLE DIRECTION AND SUPERVISION; THAT SAID SURVEY IS ACCURATE TO THE BEST OF MY KNOWLEDGE AND BELIEF; THAT PERMANENT REFERENCE MONUMENTS ("P.R.M.'s") HAVE BEEN PLACED AS REQUIRED BY LAW, AND THAT MONUMENTS ACCORDING TO SEC. 177.091(9), F.S., WILL BE SET UNDER THE GUARANTEE POSTED WITH THE TOWN OF JUPITER FOR THE REQUIRED IMPROVEMENTS; AND, FURTHER, THAT THE SURVEY DATA COMPLIES WITH ALL THE REQUIREMENTS OF CHAPTER 177, FLORIDA STATUTES, AS AMENDED, AND THE ORDINANCES OF THE TOWN OF JUPITER, FLORIDA.

DATE: MAY 29, 2015 BY: [Signature]
DAVID E. LIDBERG
PROFESSIONAL SURVEYOR AND MAPPER
STATE OF FLORIDA
LICENSE NO. 3613

AREA TABULATION		
DESCRIPTION	SQUARE FEET	ACREAGE
TRACT "F-A"	486,698	11.17
TRACT "G-A"	174,019	3.99
TRACT "G-1A"	1,670,246	38.34
TRACT "G-2A"	2,377,487	54.58
TRACT "G-3A"	829,300	19.04
TRACT "I-A"	386,338	8.87
TRACT "P-1A"	227,330	5.22
TRACT "P-2A"	113,394	2.60
TRACT "P-3A"	158,422	3.64
TRACT "P-4A"	8,058	0.18
TRACT "P-5A"	45,097	1.04
TRACT "P-6A"	112,700	2.59
TRACT "P-7A"	237,860	5.46
TRACT "P-8A"	34,573	0.79
TRACT "P-9A"	50,540	1.16
TRACT "P-10A"	847,601	19.46
TRACT "P-11A"	185,636	4.26
TRACT "P-12A"	3,135	0.07
TRACT "P-13A"	18,785	0.43
TRACT "W-1A"	111,418	2.56
TRACT "W-2A"	75,381	1.73
TRACT "W-3A"	229,160	5.26
TRACT "W-4A"	334,600	7.68
TRACT "W-5A"	176,575	4.05
TRACT "W-6A"	53,716	1.23
TRACT "W-7A"	25,185	0.58
TRACT "W-8A"	50,549	1.16
TRACT "W-8BA"	61,040	1.40
TRACT "W-9A"	142,229	3.27
TRACT "W-10A"	32,346	0.74
TOTAL	9,259,418	212.57

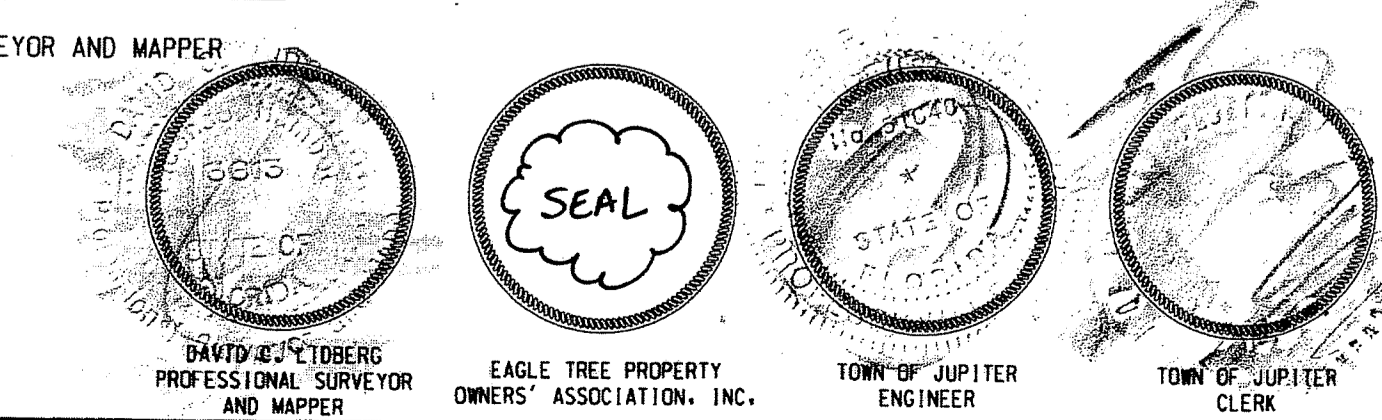
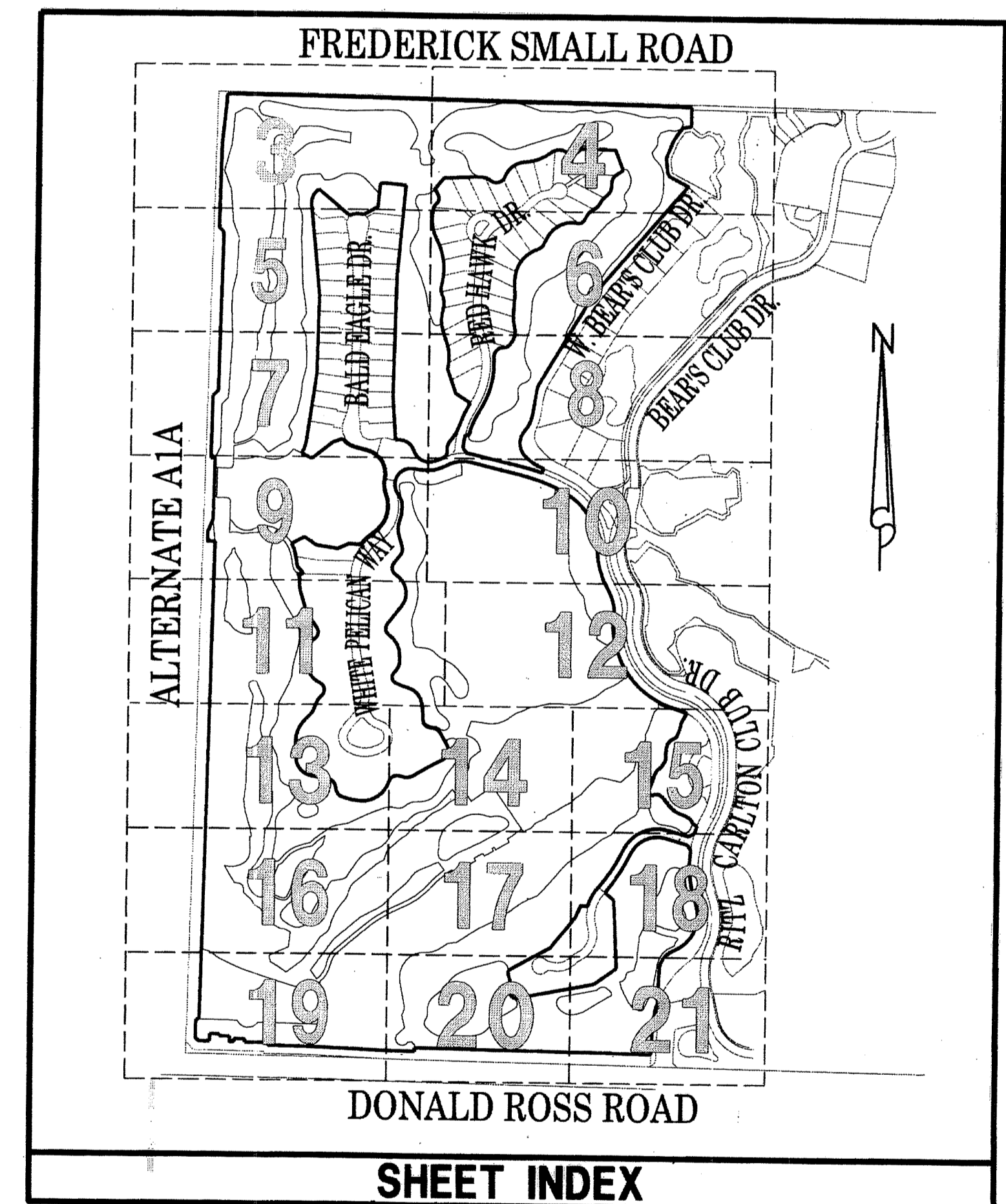

LIDBERG LAND SURVEYING, INC.
LB4431 675 West Indiantown Road, Suite 200, Jupiter, Florida 33458 TEL. 561-746-8454

CAD. K:\JUST \ 194143 \ RITZ \ 03-003C-306 \ 03-003C-306.DGN	REF.	FB.	PG.	JOB	03-003C-306
FLD.				DATE	AUGUST 2014
OFF. CASASUS				DWG.	D03-003PP
CKD. D.C.L.	SHEET	2	OF	23	