

HAMMOCKS OF WESTLAKE

BEING A REPLAT OF TRACT "Q" OF TOWN CENTER PARKWAY NORTH PER PLAT BOOK 123, PAGE 106-118, BEING A PORTION OF SECTION 6, TOWNSHIP 43 SOUTH, RANGE 41 EAST, AND A PORTION OF SECTION 1, TOWNSHIP 43 SOUTH, RANGE 40 EAST, CITY OF WESTLAKE, PALM BEACH COUNTY, FLORIDA

TOWN CENTER PARKWAY NORTH
(P.B. 123, PG. 106-118)

LIMITS OF PLAT

S89°48'53"E 919.94'

N88°36'57"E 1694.77'

1139.58'

80

- LEGEND:**
- ---- Indicates (P.R.M.) Permanent Reference Monument - 4"x4" Concrete Monument LB7768, unless otherwise noted.
 - ⊕ ---- Indicates (P.R.M.) Offset Permanent Reference Monument - 4"x4" Concrete Monument LB7768, unless otherwise noted.
 - ---- Indicates (P.C.P.) Permanent Control Point LB7768
 - P.B.C. ---- Palm Beach County
 - P.B. ---- Plat Book
 - FCM ---- Found Concrete Monument
 - O.R. ---- Official Records Book
 - (TYP) ---- Typical
 - (RB) ---- Radial Bearing
 - (NR) ---- Non-Radial line
 - (PR) ---- Private Road
 - (U.E.) ---- Utility Easement
 - (D.E.) ---- Drainage Easement
 - C ---- Curve
 - L ---- Line
 - B.T. ---- Buffer Tract
 - O.S.T. ---- Open Space Tract
 - W.M.T. ---- Water Management Tract
 - L.M.E. ---- Lake Maintenance Easement
 - L.M.A.E. ---- Lake Maintenance Access Easement
 - L.A.E. ---- Limited Access Easement
 - PG. ---- Page
 - R.T. ---- Recreation Tract
 - S.I.D. ---- Seminole Improvement District
 - NAD ---- North American Datum
 - LB ---- Licensed Business
 - P.S.M. ---- Professional Surveyor and Mapper
 - 1/4 ---- One Quarter
 - R ---- RADIUS
 - L ---- ARC LENGTH
 - D ---- DELTA-CENTRAL ANGLE

CURVE DATA TABLE					
NO.	RADIUS	DELTA	ARC	CHORD	BEARING
C15	600.00'	010°10'27"	106.54'	106.40'	S 34°20'16" W
C31	625.00'	010°10'27"	110.98'	110.84'	S 34°20'16" W
C127	625.00'	001°50'02"	20.01'	20.00'	S 38°30'28" W
C128	625.00'	004°29'42"	49.03'	49.02'	S 34°25'35" W
C170	450.00'	040°56'06"	321.50'	314.71'	N 18°57'26" E
C171	650.00'	008°50'31"	100.31'	100.21'	N 85°09'22" W
C174	750.00'	010°10'27"	133.18'	133.00'	S 34°20'16" W
C176	750.00'	004°38'52"	60.84'	60.82'	S 34°30'10" W
C177	750.00'	001°50'02"	24.01'	24.01'	S 38°30'28" W
C178	250.00'	065°27'55"	285.65'	270.36'	S 27°16'01" E
C179	1100.00'	013°35'39"	260.99'	260.38'	N 88°40'08" E
C180	150.00'	030°14'26"	79.17'	78.25'	N 24°18'16" E
C181	550.00'	065°27'55"	628.42'	594.79'	S 27°16'01" E

CURVE DATA TABLE					
NO.	RADIUS	DELTA	ARC	CHORD	BEARING
C182	1700.00'	005°48'43"	172.44'	172.37'	S 88°28'42" E
C272	1688.00'	003°40'47"	108.41'	108.39'	N 89°32'39" W
C273	48.00'	092°06'52"	77.17'	69.12'	N 41°38'50" W
C274	562.00'	064°24'34"	631.78'	599.03'	N 27°47'41" W
C278	238.00'	065°27'55"	271.94'	257.38'	S 27°16'01" E
C279	36.00'	090°00'00"	56.55'	50.91'	S 50°27'57" W
C280	1112.00'	013°35'39"	263.84'	263.22'	S 88°40'08" W
C281	36.00'	137°33'11"	86.43'	67.12'	N 29°21'07" W
C282	762.00'	007°09'30"	95.20'	95.14'	N 35°50'44" E
C292	462.00'	035°00'39"	282.31'	277.93'	S 21°55'10" W
C293	36.00'	090°29'29"	56.86'	51.13'	S 49°39'35" W
C346	625.00'	000°55'00"	10.00'	10.00'	S 37°07'56" W
C347	750.00'	000°45'50"	10.00'	10.00'	S 37°12'31" W

LINE DATA TABLE		
NO.	BEARING	LENGTH
L9	S 54°26'42" W	15.78'
L11	S 64°25'15" W	28.40'
L13	S 50°34'31" E	12.00'

MATCH LINE
SEE SHEET 7

MATCH LINE
SEE SHEET 7

TRACT "Q-2"
FUTURE DEVELOPMENT
(PRIVATE)

W.M.T. #5
(S.I.D.)

TRACT "Q-2"
FUTURE DEVELOPMENT
(PRIVATE)

W.M.T. #6
(S.I.D.)

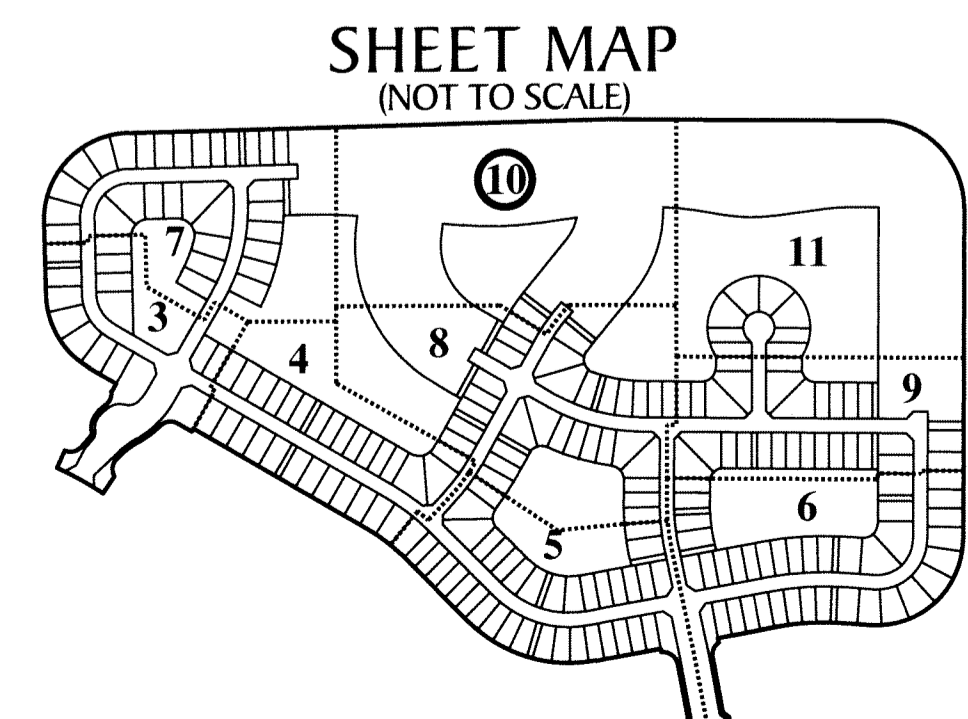

LOT 80
BUTTONBUSH DRIVE
TRACT "A"
(PRIVATE RIGHT-OF-WAY)

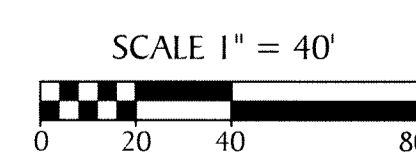

SEE NOTE ON SHEET 2 OF 11
FOR BASIS OF BEARINGS



WEST BOUNDARY LINE OF SECTION 6,
TOWNSHIP 43 SOUTH, RANGE 41
EAST

MATCH LINE
SEE SHEET 11

MATCH LINE
SEE SHEET 11

GeoPoint
Surveying, Inc.

4152 W. Blue Heron Blvd. Phone: (561) 444-2720
Suite 105 www.geopointsurvey.com
Riviera Beach, FL 33404 Licensed Business Number LB 7768

SHEET 10 OF 11 SHEETS