

20180315561

ILEX WAY - PHASE I

BEING A PLAT OF A PORTION OF
SECTION 1, TOWNSHIP 43 SOUTH, RANGE 40 EAST,
CITY OF WESTLAKE, PALM BEACH COUNTY, FLORIDA

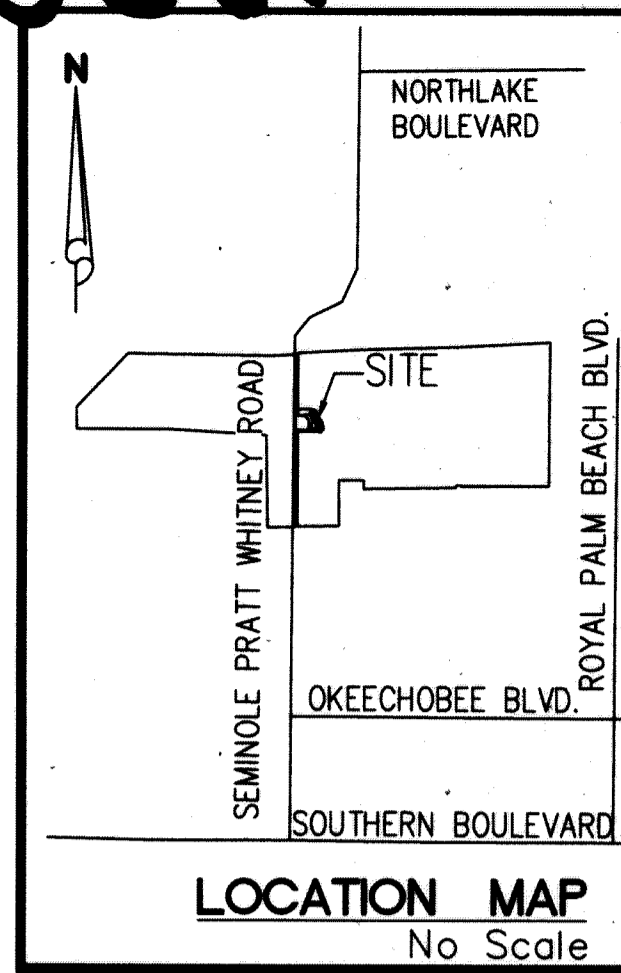

116
STATE OF FLORIDA }
COUNTY OF PALM BEACH } S.S.
THIS INSTRUMENT WAS FILED FOR
RECORD AT 11:28
THIS 15 DAY OF August
2018 AND DULY RECORDED IN
PLAT BOOK NO. 126
ON PAGE 116-117
SHARON R. BOCK,
CLERK AND COMPTROLLER
BY: *[Signature]* D.C.

DEDICATION AND DESCRIPTION

KNOW ALL MEN BY THESE PRESENTS THAT MINTO PBLH, LLC, A FLORIDA LIMITED LIABILITY COMPANY, OWNER OF THE LAND SHOWN AND DESCRIBED HEREON AS ILEX WAY - PHASE I, LYING IN SECTION 1, TOWNSHIP 43 SOUTH, RANGE 40 EAST, CITY OF WESTLAKE, PALM BEACH COUNTY, FLORIDA, BEING MORE PARTICULARLY DESCRIBED AS FOLLOWS:

DESCRIPTION:

A PARCEL OF LAND LYING IN SECTION 1, TOWNSHIP 43 SOUTH, RANGE 40 EAST, PALM BEACH COUNTY, FLORIDA, AND BEING MORE PARTICULARLY DESCRIBED AS FOLLOWS:

COMMENCE AT THE NORTHEAST CORNER OF SECTION 1, TOWNSHIP 43 SOUTH, RANGE 40 EAST; THENCE S.01°33'05"W. ALONG THE EAST LINE OF SAID SECTION 1, A DISTANCE OF 250.33 FEET TO A POINT ON THE NORTH LINE OF THE 80 FOOT M-CANAL EASEMENT AS RECORDED IN DEED BOOK 1156, PAGE 58 OF THE PUBLIC RECORDS OF PALM BEACH COUNTY, FLORIDA AND AS SHOWN IN ROAD PLAT BOOK 6, PAGE 136 OF SAID PUBLIC RECORDS, AND AS MONUMENTED; THENCE S.88°36'57"W. ALONG SAID NORTH LINE OF THE 80 FOOT M-CANAL EASEMENT, A DISTANCE OF 3776.52 FEET TO A POINT ON THE EAST RIGHT-OF-WAY LINE OF SEMINOLE PRATT WHITNEY ROAD AS RECORDED IN OFFICIAL RECORD BOOK 1544, PAGE 378 AND OFFICIAL RECORD BOOK 1640, PAGE 1626 BOTH OF SAID PUBLIC RECORDS; THENCE S.01°42'52"W. ALONG SAID EAST RIGHT-OF-WAY LINE OF SEMINOLE PRATT WHITNEY ROAD, A DISTANCE OF 3143.37 FEET TO THE NORTHERLY CORNER OF THE ADDITIONAL RIGHT-OF-WAY OF SEMINOLE PRATT WHITNEY ROAD AS RECORDED IN OFFICIAL RECORD BOOK 28479, PAGE 822 OF SAID PUBLIC RECORDS; THENCE CONTINUE S.01°42'52"W ALONG THE ORIGINAL EAST RIGHT-OF-WAY LINE OF SEMINOLE PRATT WHITNEY ROAD, A DISTANCE OF 41.82 FEET; THENCE N.90°00'00"E., A DISTANCE OF 49.79 FEET TO A NON-TANGENT INTERSECTION WITH A CURVE CONCAVE TO THE NORTH WITH A RADIUS OF 2842.00 FEET AND A RADIAL BEARING OF N.01°35'32"E. AT SAID INTERSECTION ALSO A POINT ON THE NORTH BOUNDARY OF FIRE-RESCUE STATION #22 & TOWN CENTER PARKWAY SOUTH, ACCORDING TO THE PLAT THEREOF AS RECORDED IN PLAT BOOK 123, PAGES 104 AND 105, OF THE PUBLIC RECORDS OF PALM BEACH COUNTY, FLORIDA; THENCE ALONG THE NORTH AND EAST BOUNDARY OF SAID FIRE-RESCUE STATION #22 & TOWN CENTER PARKWAY SOUTH FOR THE FOLLOWING SEVEN (7) COURSES; 1) EASTERLY ALONG THE ARC OF SAID CURVE THROUGH A CENTRAL ANGLE OF 1°53'32", A DISTANCE OF 78.98 FEET TO THE POINT OF TANGENCY; 2) N.90°00'00"E., A DISTANCE OF 266.66 FEET; 3) S.77°35'32"E., A DISTANCE OF 37.23 FEET; 4) N.90°00'00"E., A DISTANCE OF 363.82 FEET; 5) S.01°12'59"W., A DISTANCE OF 100.02 FEET; 6) S.46°07'34"E., A DISTANCE OF 36.05 FEET TO A NON-TANGENT INTERSECTION WITH A CURVE CONCAVE TO THE NORTHEAST WITH A RADIUS OF 867.00 FEET AND A RADIAL BEARING OF N.86°54'38"E. AT SAID INTERSECTION; 7) SOUTHERLY ALONG THE ARC OF SAID CURVE THROUGH A CENTRAL ANGLE OF 3°47'02", A DISTANCE OF 57.26 FEET TO THE POINT OF BEGINNING; THENCE N.83°07'35"E., A DISTANCE OF 118.00 FEET; TO A NON-TANGENT INTERSECTION TO A CURVE CONCAVE TO THE NORTHEAST WITH A RADIUS OF 749.00 FEET, AND A RADIAL BEARING OF N.83°07'35"E. AT SAID INTERSECTION; THENCE SOUTHEASTERLY ALONG THE ARC OF SAID CURVE THROUGH A CENTRAL ANGLE OF 16°13'16", A DISTANCE OF 161.09 FEET TO A POINT OF COMPOUND CURVATURE WITH A CURVE CONCAVE TO THE SOUTHWEST WITH A RADIUS OF 877.00 FEET; THENCE SOUTHEASTERLY ALONG THE ARC OF SAID CURVE THROUGH A CENTRAL ANGLE OF 25°21'05", A DISTANCE OF 388.04 FEET; THENCE S.45°30'49"E., A DISTANCE OF 6.12 FEET; THENCE S.89°16'35"W., A DISTANCE OF 14.09 FEET TO A POINT ON THE NORTH BOUNDARY OF PERSIMMON BOULEVARD EAST-PLAT 1, ACCORDING TO THE PLAT THEREOF AS RECORDED IN PLAT BOOK 125, PAGES 106 AND 107, OF THE PUBLIC RECORDS OF PALM BEACH COUNTY, FLORIDA; THENCE S.89°16'35"W. ALONG SAID NORTH BOUNDARY LINE A DISTANCE OF 118.15 FEET TO A NON-TANGENT INTERSECTION WITH A CURVE CONCAVE TO THE SOUTHWEST WITH A RADIUS OF 749.00 FEET, AND A RADIAL BEARING OF S.87°00'34"W. AT SAID INTERSECTION; THENCE NORTHWESTERLY ALONG THE ARC OF SAID CURVE THROUGH A CENTRAL ANGLE OF 18°23'02", A DISTANCE OF 240.52 FEET; THENCE N.10°12'11"E., A DISTANCE OF 48.81 FEET TO A NON-TANGENT INTERSECTION WITH A CURVE CONCAVE TO THE SOUTHWEST WITH A RADIUS OF 761.00 FEET, AND A RADIAL BEARING OF S.65°02'00"W. AT SAID INTERSECTION; THENCE NORTHWESTERLY ALONG THE ARC OF SAID CURVE THROUGH A CENTRAL ANGLE OF 3°19'43", A DISTANCE OF 44.21 FEET TO A POINT OF COMPOUND CURVATURE WITH A CURVE CONCAVE TO THE SOUTHWEST WITH A RADIUS OF 453.00 FEET; THENCE NORTHWESTERLY ALONG THE ARC OF SAID CURVE THROUGH A CENTRAL ANGLE OF 16°13'16", A DISTANCE OF 128.25 FEET TO A POINT OF REVERSE CURVATURE WITH A CURVE CONCAVE TO THE NORTHEAST WITH A RADIUS OF 887.00 FEET; THENCE NORTHWESTERLY ALONG THE ARC OF SAID CURVE THROUGH A CENTRAL ANGLE OF 7°10'12", A DISTANCE OF 111.00 FEET; TO A POINT OF COMPOUND CURVATURE WITH A CURVE CONCAVE TO THE NORTHEAST WITH A RADIUS OF 418.00 FEET; THENCE NORTHWESTERLY ALONG THE ARC OF SAID CURVE THROUGH A CENTRAL ANGLE OF 11°51'11", A DISTANCE OF 86.47 FEET TO A POINT OF TANGENCY; THENCE N.25°29'34"W., A DISTANCE OF 96.33 FEET TO A POINT OF CURVATURE OF A CURVE CONCAVE TO THE NORTHEAST WITH A RADIUS OF 877.00 FEET; THENCE NORTHWESTERLY ALONG THE ARC OF SAID CURVE THROUGH A CENTRAL ANGLE OF 6°18'45", A DISTANCE OF 96.62 FEET TO A POINT ON THE EAST BOUNDARY OF PERSIMMON BOULEVARD EAST-PLAT 1, ACCORDING TO THE PLAT THEREOF AS RECORDED IN PLAT BOOK 125, PAGES 106 AND 107, OF THE PUBLIC RECORDS OF PALM BEACH COUNTY, FLORIDA; THENCE ALONG SAID EAST BOUNDARY LINE FOR THE FOLLOWING TWO (2) COURSES; 1) N.01°07'54"E., A DISTANCE OF 30.13 FEET TO A NON-TANGENT INTERSECTION WITH A CURVE CONCAVE TO THE NORTHEAST WITH A RADIUS OF 867.00 FEET, AND A RADIAL BEARING OF N.72°41'16"E. AT SAID INTERSECTION; 2) NORTHWESTERLY ALONG THE ARC OF SAID CURVE THROUGH A CENTRAL ANGLE OF 1°32'08", A DISTANCE OF 23.24 FEET TO A POINT OF COMPOUND CURVATURE WITH A CURVE CONCAVE TO THE NORTHEAST WITH A RADIUS OF 867.00 FEET, SAID POINT BEING THE SOUTHEAST CORNER OF SAID FIRE-RESCUE STATION #22 & TOWN CENTER PARKWAY SOUTH; THENCE NORTHWESTERLY ALONG THE EAST LINE OF SAID FIRE-RESCUE STATION #22 & TOWN CENTER PARKWAY SOUTH AND THE ARC OF SAID CURVE THROUGH A CENTRAL ANGLE OF 8°54'13", A DISTANCE OF 134.73 FEET TO THE POINT OF BEGINNING.

CONTAINING: 2.891 ACRES, MORE OR LESS.

HAS CAUSED THE SAME TO BE SURVEYED AND PLATTED AS SHOWN HEREON AND DO HEREBY DEDICATE AS FOLLOWS:

DEDICATION:

ROAD RIGHT-OF-WAY

ILEX WAY, AS SHOWN HEREON, IS HEREBY DEDICATED TO THE CITY OF WESTLAKE, A FLORIDA MUNICIPAL CORPORATION, ITS SUCCESSORS AND/OR ASSIGNS, FOR ROAD RIGHT-OF-WAY PURPOSES AND SHALL BE THE PERPETUAL MAINTENANCE OBLIGATION OF THE CITY OF WESTLAKE.

THE SEMINOLE IMPROVEMENT DISTRICT, AN INDEPENDENT SPECIAL DISTRICT OF THE STATE OF FLORIDA, ITS SUCCESSORS AND ASSIGNS, IS HEREBY GRANTED AND RESERVED AN EASEMENT OVER THE ROAD RIGHT-OF-WAY FOR ANY AND ALL PURPOSES AUTHORIZED BY CHAPTER 200-131, LAWS OF FLORIDA AND CHAPTERS 189 AND 298, FLORIDA STATUTES, IN SO FAR AS SUCH ARE NOT INCONSISTENT WITH ITS UTILIZATION FOR ROAD RIGHT-OF-WAY PURPOSES, RESPONSIBILITY FOR THE INSTALLATION, MAINTENANCE, OPERATIONS, REPAIR AND/OR REPLACEMENT OF ANY FACILITIES SO INSTALLED SHALL REMAIN THE PERPETUAL OBLIGATION OF THE SEMINOLE IMPROVEMENT DISTRICT, WITHOUT RECOURSE TO THE CITY OF WESTLAKE.

OPEN SPACE TRACTS

TRACTS O.S.T. #1 AND O.S.T. #2, AS SHOWN HEREON, ARE HEREBY RESERVED FOR MINTO PBLH, LLC, A FLORIDA LIMITED LIABILITY COMPANY, ITS SUCCESSORS AND ASSIGNS FOR OPEN SPACE PURPOSES AND ARE THE PERPETUAL MAINTENANCE OBLIGATION OF SAID MINTO PBLH, LLC, A FLORIDA LIMITED LIABILITY COMPANY, ITS SUCCESSORS AND ASSIGNS, WITHOUT RECOURSE TO THE CITY OF WESTLAKE.

UTILITY EASEMENTS

ALL UTILITY EASEMENTS DESCRIBED ON THE PLAT ARE PRIVATE NON-EXCLUSIVE EASEMENTS UNLESS EXPRESSLY STATED OTHERWISE THEREIN. ALL UTILITY RIGHTS AND EASEMENTS ESTABLISHED BY OR RESERVED BY THIS PLAT ARE HEREBY RESERVED TO THE SEMINOLE IMPROVEMENT DISTRICT, A LOCAL UNIT OF SPECIAL PURPOSE GOVERNMENT ESTABLISHED PURSUANT TO CHAPTERS 189 AND 298, FLORIDA STATUTES, AS A PUBLIC UTILITY PROVIDER OF WATER, SEWER AND RECLAIMED WATER, ITS SUCCESSORS AND ASSIGNS, SUBJECT TO THOSE CERTAIN RESTRICTIONS OF RIGHTS, COVENANTS AND DEDICATIONS AS MAY HEREAFTER BE IMPOSED BY GRANTOR, PROVIDED FURTHER SAID GRANTS OR ASSIGNMENTS SHALL NOT BE DEEMED A PUBLIC DEDICATION OF SAID RIGHTS OR EASEMENTS. THE SEMINOLE IMPROVEMENT DISTRICT SHALL HAVE THE RIGHT TO GRANT OTHER UTILITY PROVIDERS THE ABILITY TO USE THE EASEMENT, IN ITS SOLE DISCRETION.

IN WITNESS WHEREOF, MINTO PBLH, LLC, A FLORIDA LIMITED LIABILITY COMPANY HAS CAUSED THESE PRESENTS TO BE SIGNED BY ITS MANAGER AND ITS COMPANY SEAL TO BE AFFIXED HERETO BY AND WITH THE AUTHORITY OF ITS MEMBERS THIS 15th DAY OF July, 2018.

WITNESS: *[Signature]* MINTO PBLH, LLC
A FLORIDA LIMITED LIABILITY COMPANY
BY: *[Signature]*
JOHN F. CARTER, MANAGER

WITNESS: *[Signature]*
PRINT NAME: *Leidani Grevers*
WITNESS: *[Signature]*
PRINT NAME: *Scott Massey*

ACKNOWLEDGEMENT
STATE OF FLORIDA
COUNTY OF PALM BEACH

BEFORE ME PERSONALLY APPEARED JOHN F. CARTER WHO IS PERSONALLY KNOWN TO ME, OR HAS PRODUCED AS IDENTIFICATION, AND WHO EXECUTED THE FOREGOING INSTRUMENT AS MANAGER OF MINTO PBLH, LLC, A FLORIDA LIMITED LIABILITY COMPANY, AND SEVERALLY ACKNOWLEDGED TO AND BEFORE ME THAT HE EXECUTED SUCH INSTRUMENT AS SUCH OFFICER OF SAID COMPANY, AND THAT THE SEAL AFFIXED TO SAID INSTRUMENT IS THE CORPORATE SEAL OF SAID COMPANY AND THAT IT WAS AFFIXED TO SAID INSTRUMENT BY DUE AND REGULAR CORPORATE AUTHORITY, AND THAT SAID INSTRUMENT IS THE FREE ACT AND DEED OF SAID COMPANY.

WITNESS MY HAND AND OFFICIAL SEAL THIS 18 DAY OF July, 2018.
MY COMMISSION EXPIRES: 9/27/18
[Signature]
NOTARY PUBLIC STATE OF FLORIDA

PRINT NAME: *Tonia Abrahamsson*
COMMISSION NO. FF154522

ACCEPTANCE OF DEDICATION
STATE OF FLORIDA
COUNTY OF PALM BEACH

THE CITY OF WESTLAKE, FLORIDA, A MUNICIPAL CORPORATION, HEREBY ACCEPTS THE DEDICATION OF ROAD RIGHT-OF-WAY AS STATED AND SHOWN HEREON, AND HEREBY ACCEPTS ITS MAINTENANCE OBLIGATIONS FOR SAME AS STATED HEREON, DATED THIS 2 DAY OF August, 2018.

CITY OF WESTLAKE
A MUNICIPAL CORPORATION

WITNESS: *[Signature]*
PRINT NAME: *Henrietta G. Cassel*
WITNESS: *[Signature]*
PRINT NAME: *Stephen E. Yabe*
CITY MAYOR, ROGER MANNING

ACKNOWLEDGEMENT
STATE OF FLORIDA
COUNTY OF PALM BEACH

BEFORE ME PERSONALLY APPEARED *Roger Manning* (PRINTED NAME) WHO IS PERSONALLY KNOWN TO ME, OR HAS PRODUCED AS IDENTIFICATION, AND WHO EXECUTED THE FOREGOING INSTRUMENT AS OFFICER OF THE CITY OF WESTLAKE, A MUNICIPAL CORPORATION, AND SEVERALLY ACKNOWLEDGED TO AND BEFORE ME THAT [HE] [SHE] EXECUTED SUCH INSTRUMENT AS SUCH OFFICER OF SAID CORPORATION, AND THAT THE SEAL AFFIXED TO THE FOREGOING INSTRUMENT IS THE CORPORATE SEAL (IF AVAILABLE) OF SAID CORPORATION AND THAT IT WAS AFFIXED TO SAID INSTRUMENT BY DUE AND REGULAR CORPORATE AUTHORITY, AND THAT SAID INSTRUMENT IS THE FREE ACT AND DEED OF SAID CORPORATION.

WITNESS MY HAND AND OFFICIAL SEAL THIS 2nd DAY OF August, 2018.
MY COMMISSION EXPIRES: 6-30-2020
[Signature]
NOTARY PUBLIC STATE OF FLORIDA

PRINT NAME: *Lynn LaBrette*
COMMISSION NO. FF 969599

ACCEPTANCE OF DEDICATIONS & RESERVATIONS
STATE OF FLORIDA
COUNTY OF PALM BEACH

SEMINOLE IMPROVEMENT DISTRICT, AN INDEPENDENT SPECIAL DISTRICT OF THE STATE OF FLORIDA, HEREBY ACCEPTS THE DEDICATIONS AND RESERVATIONS TO SAID DISTRICT AS STATED AND SHOWN HEREON, AND HEREBY ACCEPTS ITS MAINTENANCE OBLIGATIONS FOR SAME AS STATED HEREON, DATED THIS 18 DAY OF July, 2018.

SEMINOLE IMPROVEMENT DISTRICT, AN INDEPENDENT SPECIAL DISTRICT OF THE STATE OF FLORIDA
WITNESS: *[Signature]* BY: *[Signature]*
SCOTT MASSEY, RESIDENT

WITNESS: *[Signature]*
PRINT NAME: *Nelson Bomer*
MINTO PBLH, LLC
CITY OF WESTLAKE ACCEPTANCE

ACKNOWLEDGEMENT
STATE OF FLORIDA
COUNTY OF PALM BEACH

BEFORE ME PERSONALLY APPEARED SCOTT MASSEY WHO IS PERSONALLY KNOWN TO ME, OR HAS PRODUCED AS IDENTIFICATION, AND WHO EXECUTED THE FOREGOING INSTRUMENT AS PRESIDENT OF SEMINOLE IMPROVEMENT DISTRICT, AND SEVERALLY ACKNOWLEDGED TO AND BEFORE ME THAT HE EXECUTED SUCH INSTRUMENT AS SUCH OFFICER OF SAID DISTRICT, AND THAT THE SEAL AFFIXED TO THE FOREGOING INSTRUMENT IS THE DISTRICT SEAL OF SAID DISTRICT AND THAT IT WAS AFFIXED TO SAID INSTRUMENT BY DUE AND REGULAR STATUTORY AUTHORITY, AND THAT SAID INSTRUMENT IS THE FREE ACT AND DEED OF SAID DISTRICT.

WITNESS MY HAND AND OFFICIAL SEAL THIS 18 DAY OF July, 2018.
MY COMMISSION EXPIRES: 9/27/18
[Signature]
NOTARY PUBLIC STATE OF FLORIDA

PRINT NAME: *Tonia Abrahamsson*
COMMISSION NO. FF154522

MORTGAGEE'S JOINDER AND CONSENT
STATE OF FLORIDA
COUNTY OF HILLSBOROUGH

THE UNDERSIGNED HEREBY CERTIFIES THAT IT IS THE HOLDER OF A MORTGAGE, UPON THE PROPERTY DESCRIBED HEREON AND DOES HEREBY JOIN IN AND CONSENT TO THE DEDICATION OF THE LAND DESCRIBED IN SAID DEDICATION BY THE OWNER THEREOF AND AGREES THAT ITS MORTGAGE WHICH IS RECORDED IN OFFICIAL RECORD BOOK 28283 AT PAGE(S) 1060 OF THE PUBLIC RECORDS OF PALM BEACH COUNTY, FLORIDA, SHALL BE SUBORDINATED TO THE DEDICATION SHOWN HEREON.

IN WITNESS WHEREOF, THE SAID CORPORATION HAS CAUSED THESE PRESENTS TO BE SIGNED BY ITS VICE PRESIDENT THIS 17th DAY OF August, 2018.

WELLS FARGO BANK, NATIONAL ASSOCIATION
A NATIONAL BANKING
ASSOCIATION
BY: *[Signature]*
SIGNATURE OF VICE PRESIDENT
Susan S. Beauregard
PRINT NAME

WITNESS: *[Signature]*
PRINT NAME: *Kathryn C. Dateme*

ACKNOWLEDGEMENT
STATE OF FLORIDA
COUNTY OF HILLSBOROUGH

BEFORE ME PERSONALLY APPEARED *Susan S. Beauregard* (PRINTED NAME) WHO IS PERSONALLY KNOWN TO ME, OR HAS PRODUCED AS IDENTIFICATION, AND WHO EXECUTED THE FOREGOING INSTRUMENT AS VICE PRESIDENT OF WELLS FARGO BANK, NATIONAL ASSOCIATION, A NATIONAL BANKING ASSOCIATION, AND ACKNOWLEDGED TO AND BEFORE ME THAT [HE] [SHE] EXECUTED SUCH INSTRUMENT AS SUCH OFFICER OF SAID ASSOCIATION, AND THAT SAID INSTRUMENT IS THE FREE ACT AND DEED OF SAID ASSOCIATION.

WITNESS MY HAND AND OFFICIAL SEAL THIS 9th DAY OF August, 2018.
MY COMMISSION EXPIRES: *[Signature]*
NOTARY PUBLIC STATE OF FLORIDA

PRINT NAME: *Kathryn C. Dateme*
COMMISSION NO. FF 17539

TITLE CERTIFICATION
STATE OF FLORIDA
COUNTY OF Broward

WE, FOUNDERS TITLE, A TITLE INSURANCE COMPANY, AS DULY AUTHORIZED TO DO BUSINESS IN THE STATE OF FLORIDA DO HEREBY CERTIFY THAT WE HAVE EXAMINED THE TITLE TO THE HEREON DESCRIBED PROPERTY; THAT WE FIND THE TITLE TO THE PROPERTY IS VESTED IN MINTO PBLH, LLC; THAT THE CURRENT TAXES HAVE BEEN PAID; AND THAT ALL PALM BEACH COUNTY SPECIAL ASSESSMENT ITEMS, AND ALL OTHER ITEMS HELD AGAINST SAID LANDS HAVE BEEN SATISFIED; THAT ALL MORTGAGES NOT SATISFIED OR RELEASED OF RECORD NOR OTHERWISE TERMINATED BY LAW ARE SHOWN HEREON; AND THAT THE BURDEN OF ENCUMBRANCE OF RECORD BUT THOSE ENCUMBRANCES DO NOT PROHIBIT THE CREATION OF THE SUBDIVISION DEPICTED BY THIS PLAT.

DATED: 7/24/2018
HARRY ANNIE P. RESIDENT
FOUNDERS TITLE

CITY OF WESTLAKE'S APPROVAL
THIS CERTIFIES THAT THIS PLAT HAS BEEN ACCEPTED AND APPROVED BY THE CITY COUNCIL FOR THE CITY OF WESTLAKE BY A RESOLUTION DULY ADOPTED BY THE CITY COUNCIL THIS 18 DAY OF August, 2018, IN ACCORDANCE WITH SEC. 177.071(2), F.S., AND HAS BEEN REVIEWED BY A PROFESSIONAL SURVEYOR & MAPPER EMPLOYED BY THE CITY OF WESTLAKE IN ACCORDANCE WITH SEC. 177.081(1), F.S.

ATTEST: *[Signature]* CITY MANAGER, KEN CASSELL
BY: *[Signature]* CITY MAYOR, ROGER MANNING

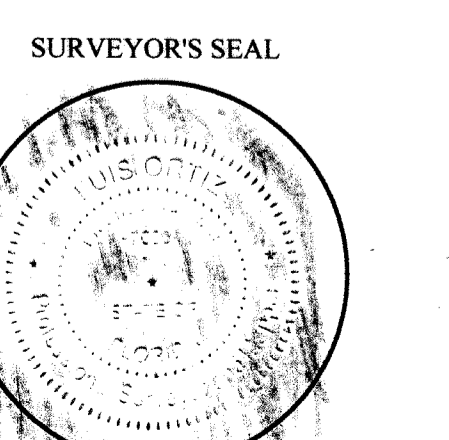
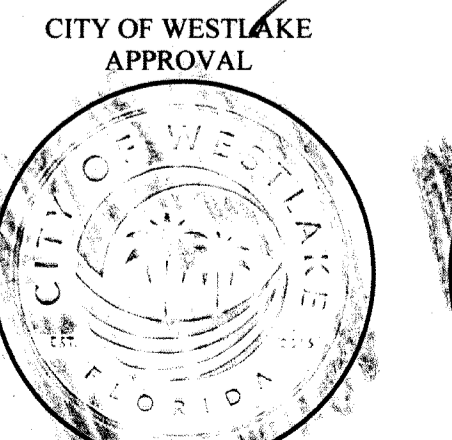
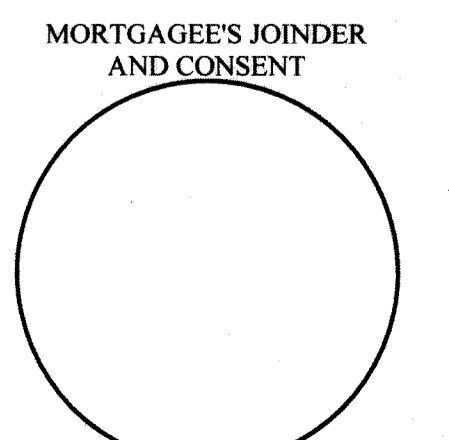
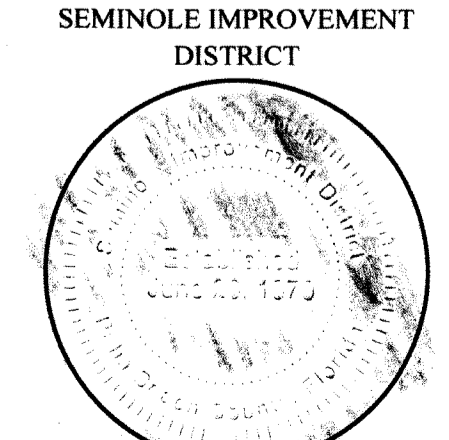
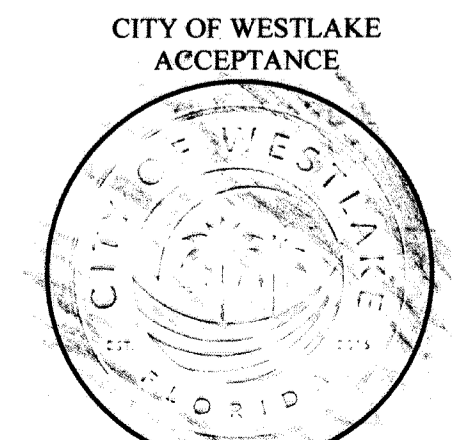
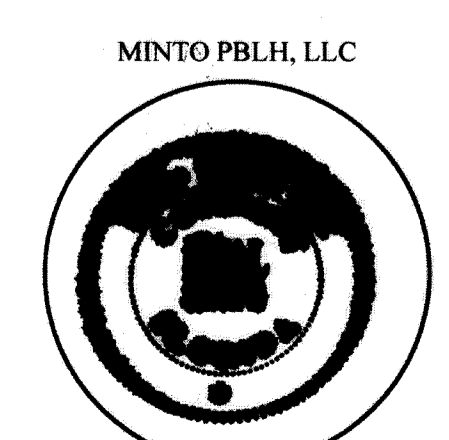

GeoPoint
Surveying, Inc.
4152 W. Blue Heron Blvd. Phone: (561) 444-2720
Suite 105 www.geopointsurvey.com
Riviera Beach, FL 33404 Licensed Business Number LB 7768
Sheet No. 1 of 2 Sheets