

18-81

179361

81

CENTRAL INDUSTRIAL PARK, NORTH

IN THE WEST HALF OF SECTION 19, TOWNSHIP 42 SOUTH, RANGE 43 EAST

PALM BEACH COUNTY, FLORIDA

DEDICATION
STATE OF Connecticut
COUNTY OF Hartford
COUNTY OF PALM BEACH

KNOW ALL MEN BY THESE PRESENTS that The Prospect Company, a Delaware Corp., owners of the land shown hereon as Central Industrial Park, North, a tract of land lying and being in part of Section 19, Township 42 South, Range 43 East, Palm Beach County, Florida, and more particularly described as follows:

The West 1/4 of Southwest 1/4 of the Southwest 1/4 of Section 19, Township 42 South, Range 43 East, LESS the West 150 feet thereof for road right-of-way and also LESS the South 33 feet thereof for drainage canal, and

Commencing at the one-quarter corner in the North line of Section 19, Township 42 South, Range 43 East; thence South 5°09'29" East along the West line of NE 1/4 of said Section 19, a distance of 3010.43 feet to the POINT OF BEGINNING; thence continue southerly along the same course a distance of 955.17 feet; thence North 12°40'01" East along the West right-of-way of South Florida Water Management District Canal C-17, a distance of 999.99 feet; thence South 85°26'22" West, a distance of 306.12 feet, more or less, to the POINT OF BEGINNING, containing 3.36 acres, more or less, situate, lying and being in Palm Beach County, Florida; and

The South 3/4 of the East 1/2 of the Northeast 1/4 of the Southwest 1/4 and the South 1/2 of the Southwest 1/4 less the West 1/2 of the Southwest 1/4 of the Southwest 1/4 and less Canal C-17 in Section 19, Township 42 South, Range 43 East, Palm Beach County, Florida, and

The West 3/4 of the South 3/4 of the North 1/2 of the Southwest 1/4, Section 19, Township 42 South, Range 43 East, Palm Beach County, Florida, LESS, however, the West 150 feet thereof.

1. Streets:

The streets as shown are hereby dedicated to the Board of County Commissioners of Palm Beach County, Florida, for perpetual use of the public for proper purposes.

2. Alleys:

The alleys as shown are hereby dedicated to the Board of County Commissioners of Palm Beach County, Florida, for perpetual use of the public for proper purposes.

3. Easements:

Utility and Drainage Easements - The utility easements and drainage easements as shown are hereby dedicated in perpetuity for the construction and maintenance of utilities and drainage.

4. Water Management Tract.

The Water Management Tract is hereby dedicated to the Central Industrial Park North Association, Inc. (Corporation not for profit), and is the perpetual maintenance obligation of said association.

IN WITNESS WHEREOF, the above-named corporation has caused these presents to be signed by its Vice President and attested by its Secretary and its corporate seal to be affixed hereto by and with the authority of its Board of Directors, this 9th day of February, 1979.

The Prospect Company, a corporation of the State of Delaware

ATTEST: J. G. Page
(J. G. Page) Secretary

By: James A. Stewart
(James A. Stewart) Vice President

ACKNOWLEDGEMENT
STATE OF Connecticut
COUNTY OF Hartford

BEFORE ME personally appeared James A. Stewart and J. G. Page, to me well known, and known to me to be the individuals described in and who executed the foregoing instrument as Vice President and Secretary of the Prospect Company, a corporation, and severally acknowledged to and before me that they executed such instrument as such officers of said corporation, and that the seal affixed to the foregoing instrument is the corporate seal of said corporation and that it was affixed to said instrument by due and regular corporate authority, and that said instrument is the free act and deed of said corporation.

WITNESS my hand and official seal this 2nd day of February, 1979.

My commission expires: March 14, 1983
Anna A. Petritto
Notary Public (Anna A. Petritto)

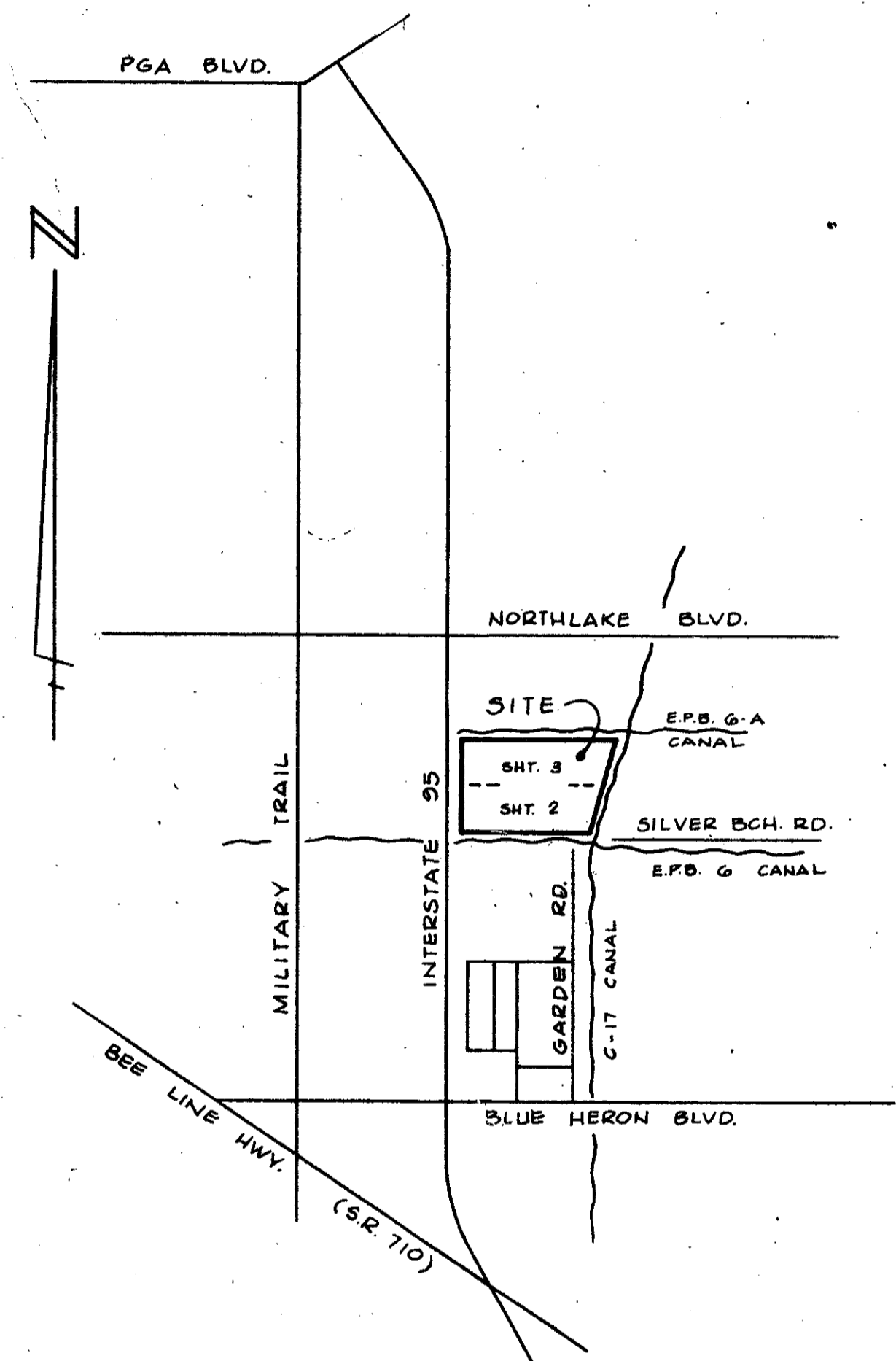
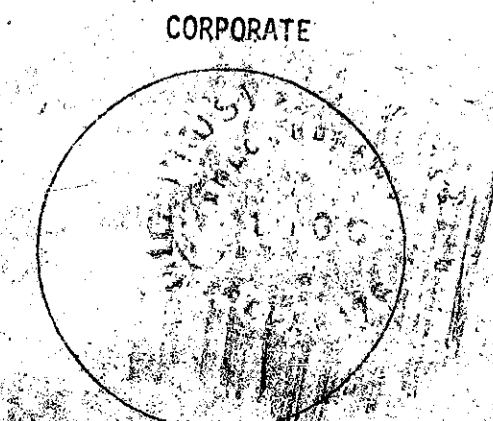
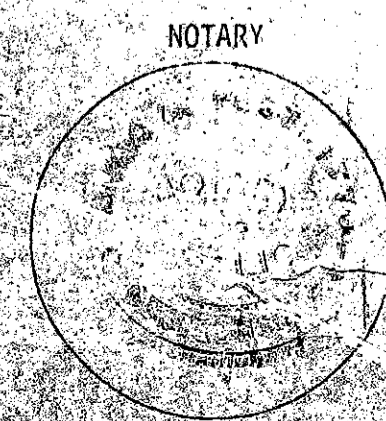

LOCATION MAP
N.T.S.

- NOTE:
- BUILDING SETBACK LINES SHALL BE AS REQUIRED BY PALM BEACH COUNTY ZONING REGULATIONS.
 - THERE SHALL BE NO BUILDINGS OR OTHER STRUCTURES PLACED ON UTILITY EASEMENTS.
 - THERE SHALL BE NO BUILDINGS OR ANY KIND OF CONSTRUCTION, OR TREES OR SHRUBS PLACED ON DRAINAGE EASEMENT.
- DENOTES PERMANENT CONTROL POINT. (P.C.P.)
DENOTES PERMANENT REFERENCE MONUMENT. (P.R.M.)
- THE SOUTH LINE OF SECTION 19 IS ASSUMED TO BEAR NORTH 85°51'28" EAST AND ALL OTHER BEARINGS ARE RELATIVE THERETO.

FLOOD ZONE B

TITLE CERTIFICATION

STATE OF FLORIDA : SS
COUNTY OF PALM BEACH:

I, THOMAS F. TOMPKINS, duly licensed attorney in the State of Florida, do hereby certify that I have examined the title to the hereon described property; that I find the title to the property is vested to THE PROSPECT COMPANY, that the current taxes have been paid and the property is free of encumbrances.

Date: APRIL 11, 1979 By: Thomas F. Tompkins
Attorney at Law

SURVEYOR'S CERTIFICATE

This is to certify that the plat shown hereon is a true and correct representation of a survey made under my responsible direction and supervision and that said survey is accurate to the best of my knowledge and belief and that (P.R.M.'s) Permanent Reference Monuments have been placed as required by law and that (P.C.P.'s) will be set under the guarantees posted with the Board of County Commissioners for the Required Improvements and further that the survey data complies with all the requirements of Chapter 177 Florida Statutes, as amended, and ordinances of Palm Beach County, Florida.

James L. Kramer
Registered Surveyor No. 2688
State of Florida

BOARD OF COUNTY COMMISSIONERS PALM BEACH COUNTY, FLORIDA

This plat is hereby approved for record this 9 day of October, 1979.

By: Bill Bailey
Bill Bailey, Chairman

PALM BEACH COUNTY ENGINEER

This plat is hereby approved for record this 9 day of October, 1979.

By: Herbert Kahert
Herbert Kahert, County Engineer

ATTEST: JOHN B. DUNKLE, Clerk BOARD OF COUNTY COMMISSIONERS

By: Manoria D. James
Deputy Clerk

This instrument was prepared by:
James L. Kramer, PLS.
Adair & Brady, Inc.
1958 S. Congress Avenue
West Palm Beach, Florida

ADAIR & BRADY, INC.		CONSULTING ENGINEERS AND SURVEYORS		CENTRAL INDUSTRIAL PARK, NORTH	
1958 S. Congress Avenue		West Palm Beach, Florida		RECORD PLAT	
MB	T-12	ONE		FP 1089	1
J.K.	1-50	JAN 1979			
		6-7510			