

46/5

H.I.D. PLAZA

A PARCEL OF LAND LYING IN SECTION 36, TOWNSHIP 47 SOUTH, RANGE 41 EAST
COUNTY OF PALM BEACH
STATE OF FLORIDA

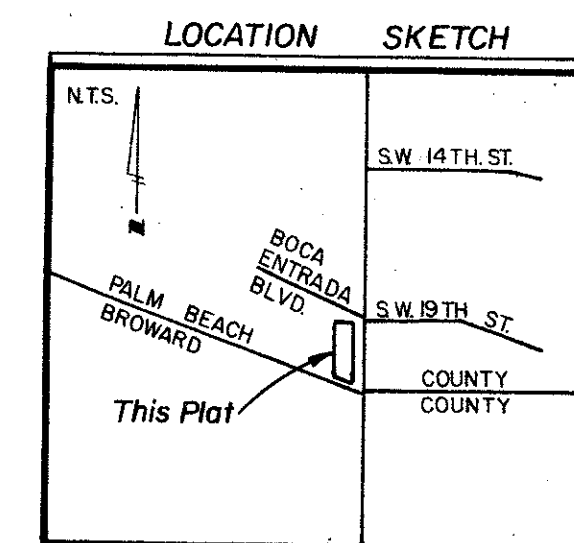

STATE OF FLORIDA
COUNTY OF PALM BEACH
THIS PLAT WAS FILED FOR
RECORD AT 10:05 AM
THIS DAY OF June
A.D. 1983 AND DULY RECORDED
IN PLAT BOOK 46 ON PAGES
5 AND 6

JOHN B. DUNKLE, CLERK
CIRCUIT COURT
BY: *[Signature]*

DEDICATION

KNOW ALL MEN BY THESE PRESENTS THAT CHARLES M. INFANTE INDIVIDUALLY & TRUSTEE ROBERT W. DePUY AND LEE W. DePUY, HIS WIFE, AND NORWOOD T. HOECKER, AS TENANTS IN COMMON, OWNERS OF THE LAND SHOWN HEREON, BEING IN SECTION 36, TOWNSHIP 47 SOUTH, RANGE 41 EAST, PALM BEACH COUNTY, FLORIDA, SHOWN HEREON AS H.I.D. PLAZA, BEING MORE PARTICULARLY DESCRIBED AS FOLLOWS:

A parcel of land lying in the Northeast one-quarter (NE 1/4) of Section 36, Township 47 South, Range 41 East, Palm Beach County, Florida, and being more particularly described as follows:

Commence at the Northeast corner of said Section 36, as established per the Palm Beach Engineering Department; Thence South 01°16'04" East along the Easterly line of said Section 36 a distance of 1459.77 feet; Thence South 88°37'28" West a distance of 146.38 feet to a point lying on the existing Westerly right-of-way line, as of this date (July 1982), of U.S. 441 (S.R. 7), said point also being the POINT OF BEGINNING; Thence South 01°22'32" East along said existing Westerly right-of-way line a distance of 820.00 feet to a point lying on the Northerly right-of-way line of the Hillsboro Canal; Thence South 89°33'33" West along said Northerly Canal right-of-way line a distance of 281.23 feet to a point of curvature of a circular curve to the right; Thence along the arc of said curve to the right, and continuing along said Northerly Canal right-of-way line, having a central angle of 11°26'30", a radius of 600.00 feet, for a distance of 119.82 feet to a point lying on a line 400.00 feet West (as measured at right angles) and parallel with said existing Westerly right-of-way line of U.S. 441; Thence North 01°22'32" West along said parallel line a distance of 801.55 feet; Thence North 88°37'28" East a distance of 400.00 feet to the POINT OF BEGINNING.

Said land containing 7.4892 acres, more or less.

HAVE CAUSED THE SAME TO BE SURVEYED AND PLATTED AS SHOWN HEREON AND DO HEREBY DEDICATE AS FOLLOWS;

1. THE UTILITY EASEMENTS AND DRAINAGE EASEMENTS AS SHOWN ARE HEREBY DEDICATED IN PERPETUITY FOR THE CONSTRUCTION AND MAINTENANCE OF UTILITIES AND DRAINAGE.
2. THE ADDITIONAL CANAL RIGHT-OF-WAY DEDICATION, AS SHOWN HEREON, ARE HEREBY DEDICATED TO THE SOUTH FLORIDA WATER MANAGEMENT DISTRICT FOR THE CONSTRUCTION AND MAINTENANCE OF DRAINAGE.
3. THE ADDITIONAL RIGHT-OF-WAY, LIMITED ACCESS EASEMENTS AS SHOWN, ARE HEREBY DEDICATED TO THE BOARD OF COUNTY COMMISSIONERS OF PALM BEACH COUNTY, FLORIDA, FOR THE PURPOSE OF CONTROL AND JURISDICTION OVER ACCESS RIGHTS & ROAD RIGHT-OF-WAY.
4. THE MARGINAL ACCESS ROAD EASEMENT AS SHOWN HEREON IS HEREBY DEDICATED FOR PRIVATE ROAD, TO THE H.I.D. PLAZA ASSOCIATION INC., A FLORIDA CORPORATION, ITS SUCCESSORS OR ASSIGNS, AND ARE THE PERPETUAL MAINTENANCE OBLIGATION OF SAID ASSOCIATION, ITS SUCCESSORS OR ASSIGNS, WITHOUT RECOURSE TO PALM BEACH COUNTY.

IN WITNESS WHEREOF, CHARLES M. INFANTE, ROBERT W. DePUY AND LEE W. DePUY HIS WIFE, AND NORWOOD T. HOECKER, DO HEREUNTO SET THERE HANDS AND SEAL PRESENTS TO BE SIGNED.

THIS 14th DAY OF March 1983

BY: *[Signature]*
CHARLES M. INFANTE, INDIVIDUAL & TRUSTEE

BY: *[Signature]*
ROBERT W. DEPUY

BY: *[Signature]*
LEE W. DEPUY

BY: *[Signature]*
NORWOOD T. HOECKER

WITNESS: *[Signature]*
TO ALL

WITNESS: *[Signature]*
TO ALL

WITNESS: *[Signature]*
TO ALL

WITNESS: *[Signature]*
TO ALL

ACKNOWLEDGEMENT

STATE OF FLORIDA - COUNTY OF PALM BEACH

BEFORE ME PERSONALLY APPEARED CHARLES M. INFANTE, INDIVIDUALLY & TRUSTEE, ROBERT W. DePUY AND LEE W. DePUY, HIS WIFE, AND NORWOOD T. HOECKER, AS TENANTS IN COMMONS; TO ME WELL KNOWN AND KNOWN TO ME TO BE THE PERSONS DESCRIBED IN AND WHO EXECUTED THE FOREGOING INSTRUMENT AND ACKNOWLEDGED TO AND BEFORE ME THAT THEY HAVE EXECUTED SAID INSTRUMENT FOR THE PURPOSES EXPRESSED THEREIN.

WITNESS MY HAND AND OFFICIAL SEAL 14th DAY OF March 1983.

MY COMMISSION EXPIRES:

[Signature]
NOTARY PUBLIC

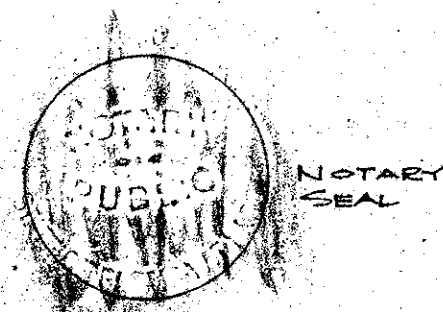

APPROVALS

PALM BEACH COUNTY BOARD OF COUNTY COMMISSIONERS
PALM BEACH COUNTY, FLORIDA

THIS PLAT IS HEREBY APPROVED FOR RECORD THIS 21 DAY OF JUNE 1983.

BY: *[Signature]*
PEGGY B. EVATT, CHAIRMAN

COUNTY ENGINEER

THIS PLAT IS HEREBY APPROVED FOR RECORD THIS 21 DAY OF JUNE 1983.

BY: *[Signature]*
HERBERT E. KANLERT, COUNTY ENGINEER, ASST.
G. HARVEY FRANKS, JR.

ATTEST:
JOHN B. DUNKLE, CLERK
BOARD OF COUNTY COMMISSIONERS

BY: *[Signature]*
DEPUTY CLERK

SURVEYOR'S CERTIFICATE

THIS IS TO CERTIFY THAT THE PLAT SHOWN HEREON IS A TRUE AND CORRECT REPRESENTATION OF A SURVEY MADE UNDER MY RESPONSIBLE DIRECTION AND SUPERVISION AND THAT SAID SURVEY IS ACCURATE TO THE BEST OF MY KNOWLEDGE AND BELIEF AND THAT PERMANENT REFERENCE MONUMENTS (PRM's) AND PERMANENT CONTROL POINTS (PC.P's) HAVE BEEN SET UNDER THE GARANTEES POSTED WITH THE PALM BEACH COUNTY BOARD OF COMMISSIONERS FOR THE REQUIRED IMPROVEMENTS AND FURTHER THAT THE SURVEY DATA COMPLIES WITH ALL THE REQUIREMENTS OF CHAPTER 177 FLORIDA STATUTES, AS AMENDED, AND ORDINANCES OF PALM BEACH COUNTY, FLORIDA.

20th DAY APRIL, 1983.

[Signature]
ARNOLD RAMOS
REGISTERED LAND SURVEYOR NO. 1975
STATE OF FLORIDA

TITLE OF CERTIFICATION

STATE OF FLORIDA - COUNTY OF PALM BEACH

I HENRY RANSBURGH, (A DULY LICENSED ATTORNEY IN THE STATE OF FLORIDA) DO HEREBY CERTIFY THAT I HAVE EXAMINED THE TITLE TO THE HEREON DESCRIBED PROPERTY; THAT I FIND THE TITLE TO THE PROPERTY IS VESTED IN CHARLES M. INFANTE, INDIVIDUAL AND TRUSTEE, ROBERT W. DePUY, AND LEE W. DePUY, HIS WIFE, AND NORWOOD T. HOECKER AS TENANTS IN COMMON; THAT THE CURRENT TAXES HAVE BEEN PAID; AND THAT I FIND THAT THE PROPERTY IS FREE OF ENCUMBRANCES.

DATE: _____

[Signature]
ATTORNEY-AT-LAW LICENSED IN FLORIDA

INSTRUMENT PREPARED BY:
MID SOUTH ENGINEERING COMPANY
CONSULTING ENGINEERS PLANNERS SURVEYORS
2901-A Northwest 62nd STREET
FORT LAUDERDALE, FLORIDA 33309

0359-000

46/5

[Signature]
CG

H.I.D. PLAZA 46/5