

# PARCEL E-4 AT BOCA WEST

A PART OF BOCA WEST, PLANNED UNIT DEVELOPMENT

THIS INSTRUMENT WAS PREPARED BY WM. R. VAN CAMPEN, IN THE OFFICES OF BENCH MARK LAND SURVEYING AND MAPPING, INC., 2833 EXCHANGE COURT, WEST PALM BEACH, FLORIDA 33409. TELEPHONE: (305) 689-2111

101

51

STATE OF FLORIDA  
COUNTY OF PALM BEACH

THIS PLAT WAS FILED FOR RECORD  
AT THIS DAY  
OF A.D. AND  
DULY RECORDED IN PLAT BOOK  
ON PAGES AND

JOHN B. DUNKLE  
CLERK, CIRCUIT COURT

BY: \_\_\_\_\_

UNPLATTED

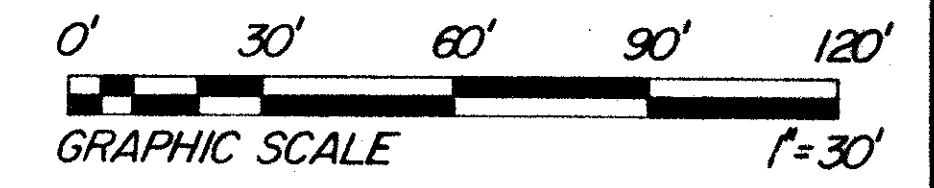
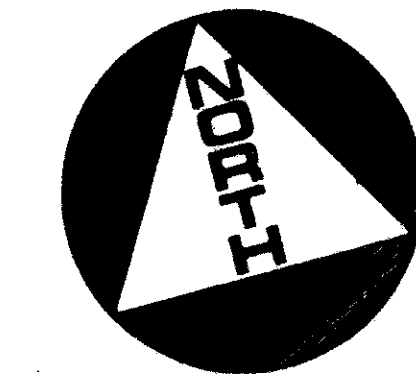

UNPLATTED

0214-314

51/101

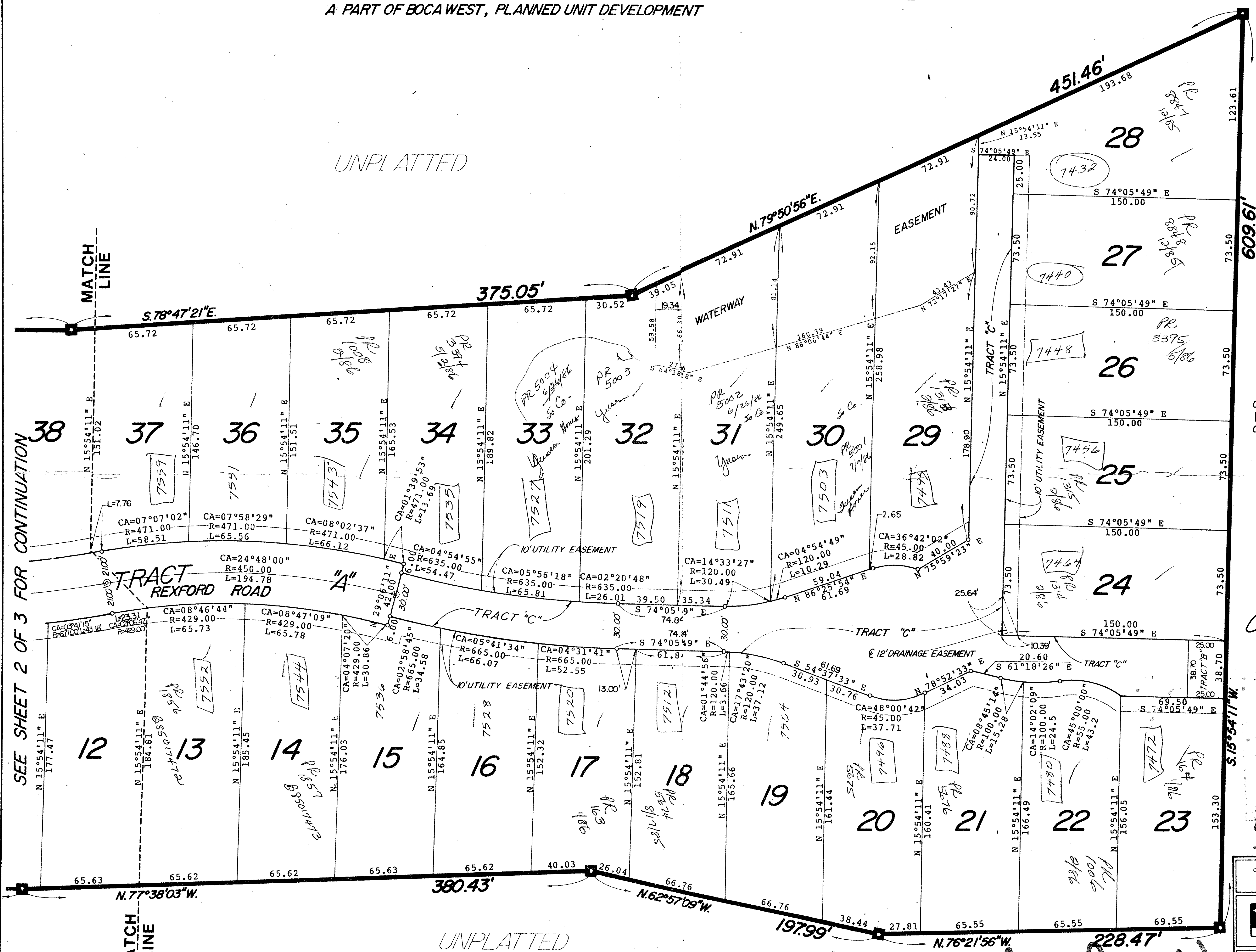

SEE SHEET 2 OF 3 FOR CONTINUATION

⊙ - INDICATES A PERMANENT CONTROL POINT (PCP)  
⊠ - INDICATES A PERMANENT REFERENCE MONUMENT (PRM)

PARCEL E-4 AT BOCA WEST

CONRAD W. SCHAEFER CONSULTING ENGINEERS, INC.  
PALM BEACH COUNTY FLORIDA

**BENCH MARK**  
land surveying and mapping, inc.  
WEST PALM BEACH, FLORIDA

DESIGNED CWS	DRAWN PB	CHECKED WVC	DATE P9005	DRAWING NO.
APPROVED	SCALE 1"=30'	APPROVED	FILE NO.	SHEET OF 3 3

DRAWING NUMBER  
51/101

DRAWING NUMBER

DRAWING NUMBER

DRAWING NUMBER

PLAN HOLD CORPORATION • IRVINE, CALIFORNIA  
RECORDED BY NUMBER 07348