

DRAWING NUMBER
52/20

DRAWING NUMBER

DRAWING NUMBER

DRAWING NUMBER

P.U.D. DENSITY TABULATION

PLAT	AREA ACRES	NO. OF UNITS	PLAT DENSITY D.U./ACRE	AGGREGATE		TOTALS
				AGGR. ACRES	NO. OF UNITS	OVERALL DENSITY D.U./ACRE
PLAT NO. 1	33.89	106	3.12	33.89	106	3.12
PLAT NO. 2	31.37	160	5.10	65.26	266	4.07
PLAT NO. 3	5.13	0	0.00	70.39	266	3.77
PLAT NO. 4-A	20.81	0	0.00	91.20	266	2.92
PLAT NO. 4-B	30.04	300	9.98	121.24	566	4.67

A PORTION OF A P.U.D.
LAKESIDE GREEN-PLAT NO. 4-B
 SECTION 12, TOWNSHIP 43 SOUTH, RANGE 42 EAST
 PALM BEACH COUNTY, FLORIDA
 IN 3 SHEETS SHEET NO. 1
 SEPTEMBER, 1985

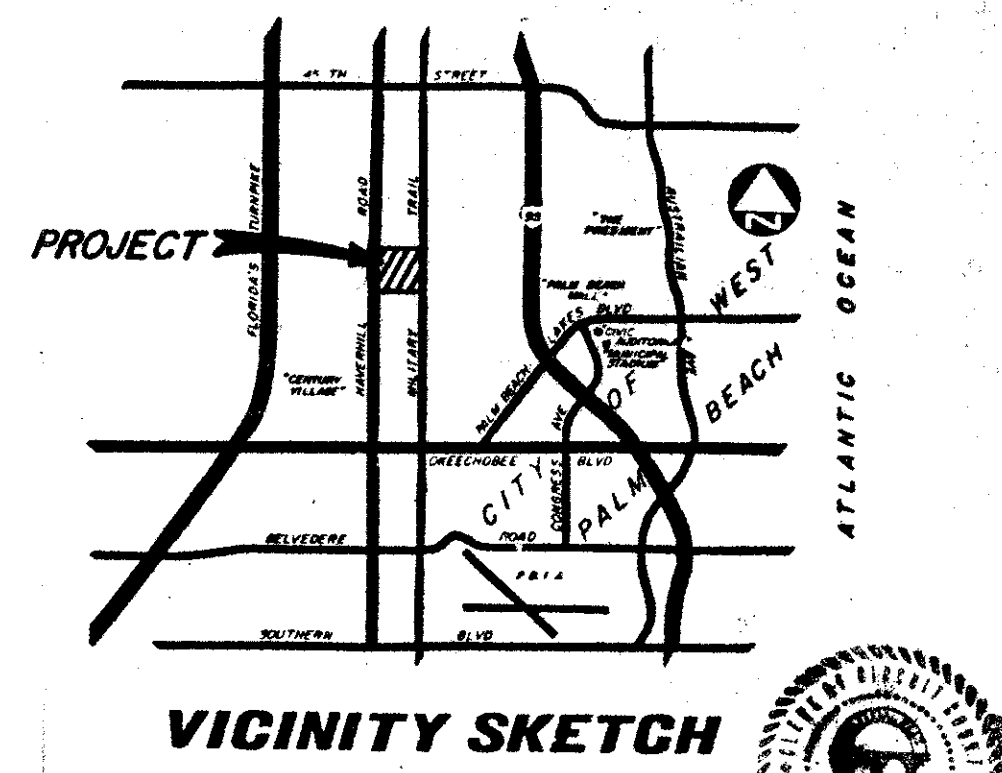

STATE OF FLORIDA }
 COUNTY OF PALM BEACH }
 This Plat was filed for record at 10:14 AM
 this 24th day of September
 1985, and duly recorded in Plat Book No.
 52 on pages 20, 21 & 22
 JOHN B. DUNKLE, Clerk Circuit Court
 by Jacqueline P. Slaton, D.C.

20

Dedication

STATE OF FLORIDA SS
 COUNTY OF PALM BEACH

KNOW ALL MEN BY THESE PRESENTS THAT THE ENGLE GROUP, INC., A FLORIDA CORPORATION, OWNER OF THE LAND SHOWN HEREON, BEING IN SECTION 12, TOWNSHIP 43 SOUTH, RANGE 42 EAST, PALM BEACH COUNTY, FLORIDA, SHOWN HEREON AS LAKESIDE GREEN - PLAT NO. 4-B, BEING MORE PARTICULARLY DESCRIBED AS FOLLOWS:

Description
 A PARCEL OF LAND LYING IN SECTION 12, TOWNSHIP 43 SOUTH, RANGE 42 EAST, PALM BEACH COUNTY, FLORIDA, BEING MORE PARTICULARLY DESCRIBED AS FOLLOWS:
 COMMENCING AT THE SOUTHWEST CORNER OF SECTION 12; THENCE WITH A BEARING 1° 28' 52" EAST, ALONG THE WEST LINE OF SECTION 12, AND THE CENTERLINE OF HAVERHILL ROAD A DISTANCE OF 2662.42 FEET TO THE WEST QUARTER CORNER OF SECTION 12; THENCE WITH A BEARING OF NORTH 1° 29' 06" EAST, A DISTANCE OF 665.20 FEET TO A POINT; THENCE WITH A BEARING OF SOUTH 88° 13' 45" EAST, A DISTANCE OF 50.00 FEET TO A POINT; SAID POINT BEING THE POINT OF BEGINNING; THENCE CONTINUE WITH A BEARING OF SOUTH 88° 13' 45" EAST, A DISTANCE OF 1619.00 FEET TO A POINT; THENCE WITH A BEARING OF SOUTH 1° 29' 06" WEST, A DISTANCE OF 665.00 FEET; THENCE WITH A BEARING OF NORTH 88° 13' 45" WEST, A DISTANCE OF 795.00 FEET TO A POINT; THENCE WITH A CURVE TO THE LEFT HAVING A RADIUS OF 265.00 FEET, A CENTRAL ANGLE OF 57° 56' 28", AND AN ARC LENGTH OF 267.98 FEET TO A POINT; THENCE WITH A BEARING OF SOUTH 33° 49' 47" WEST, A DISTANCE OF 215.18 FEET TO A POINT; THENCE WITH A CURVE TO THE RIGHT HAVING A RADIUS OF 260.00 FEET, A CENTRAL ANGLE OF 57° 39' 19", AND AN ARC LENGTH OF 261.63 FEET TO A POINT; THENCE WITH A BEARING OF NORTH 88° 30' 54" WEST, A DISTANCE OF 234.97 FEET TO A POINT; THENCE WITH A BEARING OF NORTH 43° 31' 01" WEST, A DISTANCE OF 35.35 FEET TO A POINT; THENCE WITH A BEARING OF NORTH 88° 31' 08" WEST, A DISTANCE OF 4.00 FEET TO A POINT ON THE RIGHT OF WAY LINE OF HAVERHILL ROAD; THENCE WITH A BEARING OF NORTH 1° 28' 52" EAST, ALONG THE EAST RIGHT OF WAY LINE OF HAVERHILL ROAD, SAID LINE LYING 50.00 FEET EAST OF AND PARALLEL TO THE WEST LINE OF SECTION 12, A DISTANCE OF 404.85 FEET TO A POINT; THENCE WITH A BEARING OF NORTH 1° 29' 06" EAST, A DISTANCE OF 665.17 FEET MORE OR LESS TO THE POINT OF BEGINNING

CONTAINING 30.04 ACRES MORE OR LESS AND SUBJECT TO EASEMENTS AND RIGHTS OF WAY OF RECORD.

- HAS CAUSED THE SAME TO BE SURVEYED AND PLATTED AS SHOWN HEREON AND DOES HEREBY DEDICATE AS FOLLOWS:
- THE FOUR (4) FOOT ADDITIONAL RIGHT-OF-WAY FOR HAVERHILL ROAD AS SHOWN HEREON IS HEREBY DEDICATED TO THE BOARD OF COUNTY COMMISSIONERS OF PALM BEACH COUNTY, FLORIDA, FOR THE PERPETUAL USE OF THE PUBLIC FOR ROAD RIGHT-OF-WAY PURPOSES.
 - THE HOUSING TRACTS SHOWN HEREON AS TRACTS "A", "B" "C" AND "D" ARE HEREBY DEDICATED TO THE ENGLE GROUP, INC., ITS SUCCESSORS OR ASSIGNS FOR FUTURE RESIDENTIAL DWELLING UNITS WITHOUT RECOURSE TO PALM BEACH COUNTY.
 - THE RECREATION AREAS SHOWN HEREON AS TRACTS "E" AND "F" ARE HEREBY DEDICATED TO THE ENGLE GROUP, INC., ITS SUCCESSORS OR ASSIGNS FOR RECREATIONAL PURPOSES AND ARE THE PERPETUAL MAINTENANCE OBLIGATION OF SAID ASSOCIATION, ITS SUCCESSORS OR ASSIGNS, WITHOUT RECOURSE TO PALM BEACH COUNTY.
 - TRACTS "G", "H", "I", "J" AND "K" AS SHOWN HEREON ARE HEREBY DEDICATED TO THE LAKESIDE GREEN PROPERTY OWNERS ASSOC., INC., ITS SUCCESSORS OR ASSIGNS AS COMMON AREAS FOR PARKING, ACCESS, LANDSCAPING, BUFFER AND RECREATIONAL PURPOSES WITHOUT RECOURSE TO PALM BEACH COUNTY.
 - THE LAKES SHOWN HEREON AS WATER MANAGEMENT TRACTS "L", "M", "N" AND "O" ARE HEREBY DEDICATED TO THE LAKESIDE GREEN PROPERTY OWNERS ASSOC., INC., ITS SUCCESSORS AND ASSIGNS, FOR LAKE AND WATER RETENTION PURPOSES AND ARE THE PERPETUAL MAINTENANCE OBLIGATION OF SAID ASSOCIATION, ITS SUCCESSORS OR ASSIGNS, WITHOUT RECOURSE TO PALM BEACH COUNTY AND WITHOUT RECOURSE TO THE NORTHERN PALM BEACH COUNTY WATER CONTROL DISTRICT. TRACTS "L", "M", "N" AND "O" ARE ALSO DRAINAGE EASEMENTS.
 - EASEMENTS:
 - UTILITY AND DRAINAGE EASEMENTS - THE UTILITY EASEMENTS AND DRAINAGE EASEMENTS AS SHOWN ARE HEREBY DEDICATED IN PERPETUITY FOR THE CONSTRUCTION AND MAINTENANCE OF UTILITIES AND DRAINAGE, WITHOUT RECOURSE TO THE NORTHERN PALM BEACH COUNTY WATER CONTROL DISTRICT.
 - LIMITED ACCESS EASEMENTS - THE LIMITED ACCESS EASEMENTS AS SHOWN ARE DEDICATED TO THE BOARD OF COUNTY COMMISSIONERS OF PALM BEACH COUNTY, FLORIDA, FOR THE PURPOSES OF CONTROL AND JURISDICTION OVER ACCESS RIGHTS.
 - LIFT STATION EASEMENT, AS SHOWN HEREON, IS HEREBY DEDICATED IN PERPETUITY TO PALM BEACH COUNTY, ITS SUCCESSORS AND ASSIGNS FOR LIFT STATION AND RELATED PURPOSES.
 - THE TWENTY-FIVE (25) FOOT BUFFER AREA, SHOWN HEREON AS TRACT "P" IS HEREBY DEDICATED TO THE LAKESIDE GREEN PROPERTY OWNERS ASSOC., INC., ITS SUCCESSORS OR ASSIGNS, FOR LANDSCAPING AND BUFFER PURPOSES AND IS THE PERPETUAL MAINTENANCE OBLIGATION OF SAID ASSOCIATION ITS SUCCESSORS OR ASSIGNS, WITHOUT RECOURSE TO PALM BEACH COUNTY.
 - THE TWENTY-FIVE (25) FOOT ACCESS TRACTS AS SHOWN HEREON ARE HEREBY DEDICATED TO THE LAKESIDE GREEN PROPERTY OWNERS ASSOC., INC., ITS SUCCESSORS OR ASSIGNS, FOR INGRESS, EGRESS, DRAINAGE AND UTILITY EASEMENT PURPOSES, AND ARE THE PERPETUAL MAINTENANCE OBLIGATION OF SAID CORPORATION, ITS SUCCESSORS OR ASSIGNS, WITHOUT RECOURSE TO PALM BEACH COUNTY.
 - TRACT "R" AS SHOWN HEREON IS HEREBY DEDICATED FOR PRIVATE ROAD PURPOSES TO THE LAKESIDE GREEN PROPERTY OWNERS ASSOC., INC., ITS SUCCESSORS OR ASSIGNS AND IS THE PERPETUAL MAINTENANCE OBLIGATION OF SAID CORPORATION, ITS SUCCESSORS OR ASSIGNS, WITHOUT RECOURSE TO PALM BEACH COUNTY.
 - PALM BEACH COUNTY SHALL HAVE THE RIGHT, BUT NOT THE OBLIGATION TO MAINTAIN THAT PORTION OF THE DRAINAGE SYSTEM WHICH IS ASSOCIATED WITH COUNTY ROADS.
 - THE EXCLUSIVE SOUTHERN BELL EASEMENT AS SHOWN HEREON, IS HEREBY DEDICATED IN PERPETUITY TO SOUTHERN BELL TELEPHONE AND TELEGRAPH COMPANY ITS SUCCESSORS AND ASSIGNS FOR TELECOMMUNICATION PURPOSES AND RELATED PURPOSES.

ACKNOWLEDGEMENT
 STATE OF FLORIDA SS
 COUNTY OF PALM BEACH

BEFORE ME PERSONALLY APPEARED ALEC ENGLESTEIN AND HARRY ENGLESTEIN TO BE WELL KNOWN AND KNOWN TO ME TO BE THE INDIVIDUALS DESCRIBED IN AND WHO EXECUTED THE FOREGOING INSTRUMENT AS PRESIDENT AND VICE PRESIDENT OF THE ENGLE GROUP, INC., A FLORIDA CORPORATION, AND SEVERALLY ACKNOWLEDGED TO AND BEFORE ME THAT THEY EXECUTED SUCH INSTRUMENT AS SUCH OFFICERS OF SAID CORPORATION, AND THAT THE SEAL AFFIXED TO THE FOREGOING INSTRUMENT IS THE CORPORATE SEAL OF SAID CORPORATION AND THAT IT WAS AFFIXED TO SAID INSTRUMENT BY DUE AND REGULAR CORPORATE AUTHORITY, AND THAT SAID INSTRUMENT IS THE FREE ACT AND DEED OF SAID CORPORATION.

WITNESS MY HAND AND OFFICIAL SEAL THIS 8th DAY OF March 1985.

Clara J. Arnold
 NOTARY PUBLIC

MY COMMISSION EXPIRES June 3, 1989

MORTGAGEE'S CONSENT
 STATE OF FLORIDA SS
 COUNTY OF PALM BEACH

THE UNDERSIGNED HEREBY CERTIFIES THAT IT IS THE HOLDER OF A MORTGAGE UPON THE PROPERTY DESCRIBED HEREON AND DOES HEREBY JOIN IN AND CONSENT TO THE DEDICATION OF THE LAND DESCRIBED IN SAID DEDICATION BY THE OWNER THEREOF AND AGREES THAT ITS MORTGAGE WHICH IS RECORDED IN OFFICIAL RECORD BOOK 4185 AT PAGE 370 OF THE PUBLIC RECORDS OF PALM BEACH COUNTY, FLORIDA SHALL BE SUBORDINATED TO THE DEDICATION SHOWN HEREON.

IN WITNESS WHEREOF, THE SAID CORPORATION HAS CAUSED THESE PRESENTS TO BE SIGNED BY ITS Vice President AND ATTESTED TO BY ITS Vice President AND ITS CORPORATE SEAL TO BE AFFIXED HEREON BY AND WITH THE AUTHORITY OF ITS BOARD OF DIRECTORS THIS 8th DAY OF March A.D. 1985.

ATTEST: John H. Fullmer, Vice President
 Barbara H. Vincent, Vice President

ACKNOWLEDGEMENT
 STATE OF FLORIDA SS
 COUNTY OF PALM BEACH

BEFORE ME PERSONALLY APPEARED Barbara H. Vincent AND John H. Fullmer TO BE WELL KNOWN, AND KNOWN TO ME TO BE THE INDIVIDUALS DESCRIBED IN AND WHO EXECUTED THE FOREGOING INSTRUMENT AS Vice President AND Vice President OF THE ABOVE NAMED American Bank and Trust AND SEVERALLY ACKNOWLEDGED TO AND BEFORE ME THAT THEY EXECUTED SUCH INSTRUMENT AS Vice Pres. AND Vice Pres. RESPECTIVELY, OF SAID CORPORATION, AND THAT THE SEAL AFFIXED TO THE FOREGOING INSTRUMENT IS THE CORPORATE SEAL OF SAID CORPORATION AND THAT IT WAS AFFIXED TO SAID INSTRUMENT BY DUE AND REGULAR CORPORATE AUTHORITY AND THAT SAID INSTRUMENT IS THE FREE ACT AND DEED OF SAID CORPORATION.

ATTEST: John H. Fullmer, Vice President
 Barbara H. Vincent, Vice President

ACKNOWLEDGEMENT
 STATE OF FLORIDA SS
 COUNTY OF PALM BEACH

BEFORE ME PERSONALLY APPEARED Barbara H. Vincent AND John H. Fullmer TO BE WELL KNOWN, AND KNOWN TO ME TO BE THE INDIVIDUALS DESCRIBED IN AND WHO EXECUTED THE FOREGOING INSTRUMENT AS Vice Pres. AND Vice Pres. OF THE ABOVE NAMED American Bank and Trust AND SEVERALLY ACKNOWLEDGED TO AND BEFORE ME THAT THEY EXECUTED SUCH INSTRUMENT AS Vice Pres. AND Vice Pres. RESPECTIVELY, OF SAID CORPORATION, AND THAT THE SEAL AFFIXED TO THE FOREGOING INSTRUMENT IS THE CORPORATE SEAL OF SAID CORPORATION AND THAT IT WAS AFFIXED TO SAID INSTRUMENT BY DUE AND REGULAR CORPORATE AUTHORITY AND THAT SAID INSTRUMENT IS THE FREE ACT AND DEED OF SAID CORPORATION.

WITNESS MY HAND AND OFFICIAL SEAL THIS 8th DAY OF March A.D. 1985.

MY COMMISSION EXPIRES: 6/9/86
 Notary Public

TITLE CERTIFICATION
 STATE OF FLORIDA
 COUNTY OF PALM BEACH

I, JOEL P. KOEPEL, A DULY LICENSED ATTORNEY IN THE STATE OF FLORIDA, DO HEREBY CERTIFY THAT I HAVE EXAMINED THE TITLE TO THE HEREON DESCRIBED PROPERTY, THAT I FIND THE TITLE TO THE PROPERTY IS VESTED TO THE ENGLE GROUP, INC., THAT THE CURRENT TAXES HAVE BEEN PAID; AND THAT THE PROPERTY IS ENCUMBERED BY THE MORTGAGES SHOWN HEREON; AND THAT I FIND THAT ALL MORTGAGES ARE SHOWN AND ARE TRUE AND CORRECT.

AUGUST 23, 1985
 Attorney at Law, Licensed in Florida

COUNTY APPROVALS
 BOARD OF COUNTY COMMISSIONERS OF PALM BEACH COUNTY, FLORIDA:

THIS PLAT IS HEREBY APPROVED FOR RECORD THIS 24 DAY OF September A.D., 1985.

BY: Kenneth M. Adams, Chairman
 ATTEST: John B. Dunkle, Clerk
 Ruth B. Compton, Deputy Clerk

COUNTY ENGINEER

THIS PLAT IS HEREBY APPROVED FOR RECORD THIS 24 DAY OF September A.D., 1985.

BY: H. F. Kahler, County Engineer

- NOTES:**
- PERMANENT REFERENCE MONUMENTS ARE DESIGNATED THUSLY: [Symbol]
 - PERMANENT CONTROL POINTS ARE DESIGNATED THUSLY: [Symbol]
 - BUILDING SETBACK LINES SHALL BE AS REQUIRED BY ORDINANCES OF PALM BEACH COUNTY, FLORIDA.
 - A. NO BUILDINGS OR ANY KIND OF CONSTRUCTION SHALL BE PLACED ON UTILITY OR DRAINAGE EASEMENTS.
 B. NO STRUCTURES, TREES OR SHRUBS SHALL BE PLACED ON DRAINAGE EASEMENTS.
 C. APPROVAL OF LANDSCAPING ON UTILITY EASEMENTS SHALL BE ONLY WITH THE APPROVAL OF ALL UTILITIES OCCUPYING SAME.
 - IN INSTANCES WHERE DRAINAGE AND UTILITY EASEMENTS INTERSECT, THE AREA OF INTERSECTION ARE DRAINAGE AND UTILITY EASEMENTS. CONSTRUCTION, OPERATION AND MAINTENANCE OF UTILITIES IN THESE AREAS OF INTERSECTION SHALL NOT INTERFERE WITH THE CONSTRUCTION, OPERATION AND MAINTENANCE OF DRAINAGE FACILITIES LOCATED THEREIN.
 - BEARINGS CITED HEREIN ARE IN THE MERIDIAN OF THE FLORIDA STATE PLANE COORDINATE SYSTEM.

0265-304

SURVEYOR'S CERTIFICATION
 STATE OF FLORIDA SS
 COUNTY OF PALM BEACH

I HEREBY CERTIFY THAT THE PLAT SHOWN HEREON IS A TRUE AND CORRECT REPRESENTATION OF A SURVEY, MADE UNDER MY RESPONSIBLE DIRECTION AND SUPERVISION, AND THAT SAID SURVEY IS ACCURATE TO THE BEST OF MY KNOWLEDGE AND BELIEF AND THAT (P.R.M.'S) PERMANENT REFERENCE MONUMENTS HAVE BEEN SET AND THAT (P.C.P.'S) PERMANENT CONTROL POINTS WILL BE SET UNDER THE GUARANTEES POSTED WITH PALM BEACH COUNTY FOR THE REQUIRED IMPROVEMENTS; AND FURTHER THAT THE SURVEY DATA COMPLIES WITH ALL THE REQUIREMENTS OF CHAPTER 177, FLORIDA STATUTES, AS AMENDED, AND ORDINANCES OF PALM BEACH COUNTY, FLORIDA.

DATE: March 19, 1985
 Joseph M. Tucker
 SURVEYOR
 FLORIDA CERTIFICATE NO. 3285

IN WITNESS WHEREOF, THE ENGLE GROUP, INC., HAS CAUSED THESE PRESENTS TO BE SIGNED BY ITS PRESIDENT AND ATTESTED BY ITS VICE-PRESIDENT AND ITS CORPORATE SEAL TO BE AFFIXED HERETO BY AND WITH THE AUTHORITY OF ITS BOARD OF DIRECTORS THIS 8th DAY OF March A.D., 1985.

ATTEST: Madison F. Pacetti, Secretary
 Donald C. Walker, President
 BOARD OF SUPERVISORS

STATE OF FLORIDA
 COUNTY OF PALM BEACH

THE NORTHERN PALM BEACH COUNTY WATER CONTROL DISTRICT HAS REVIEWED THIS PLAT AND ACKNOWLEDGES THERE ARE NO DEDICATIONS TO THE NORTHERN PALM BEACH COUNTY WATER CONTROL DISTRICT AND THAT SAID DISTRICT HAS NO MAINTENANCE RESPONSIBILITIES WITHIN THIS PLAT

DATE: March 19, 1985
 NORTHERN PALM BEACH COUNTY WATER CONTROL DISTRICT

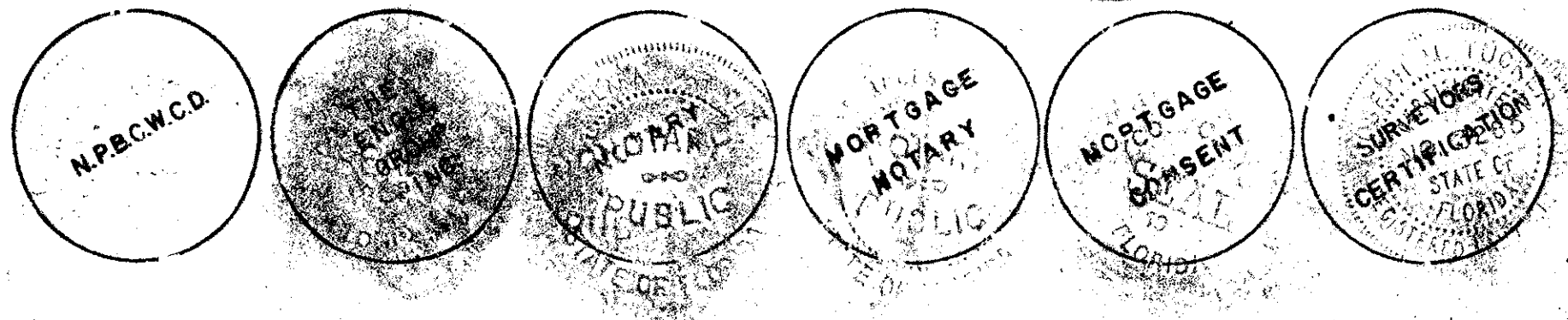
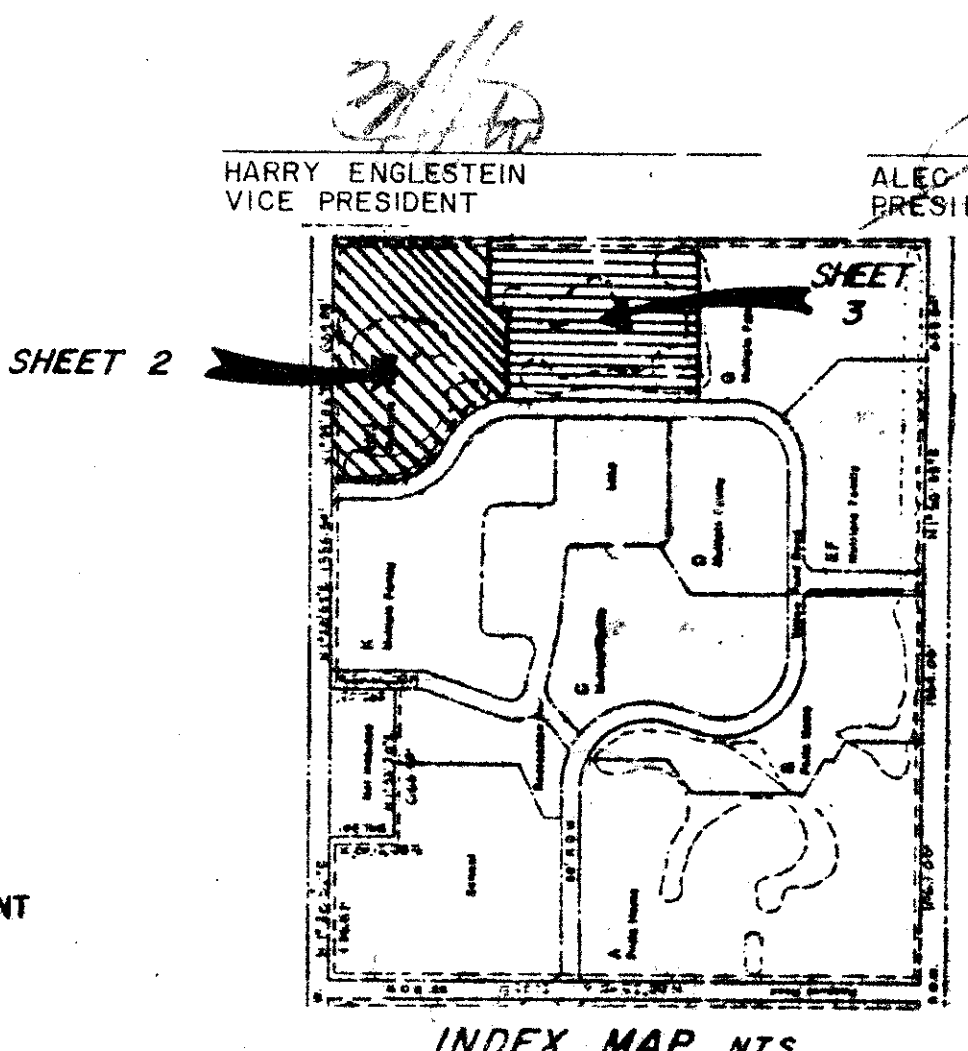

ROSSI AND MALAVASI ENGINEERS, INC.
 WEST PALM BEACH, FLORIDA

A PORTION OF A P.U.D.
LAKESIDE GREEN PLAT 4-B
 IN 3 SHEETS SHEET NO. 1

Date: SEPTEMBER, 1985
 Drawn: D. FREDERICK
 Checked: [Signature]
 Scale: 1" = 100'
 Job No.: 3374
 File No.: S-1304-00
 Sheet: 1 of 3