

DRAWING NUMBER
52/172

PLAT NO. 2 OF RIVER WALK

IN SECTION 3, TOWNSHIP 41 SOUTH, RANGE 42 EAST
AND REPLAT OF LOTS 46, 47 80 & 81 OF CINQUEZ PARK (P.B. 20 PAGE 81)
PALM BEACH COUNTY, FLORIDA

SHEET 3 OF 3

AUGUST 1985

172

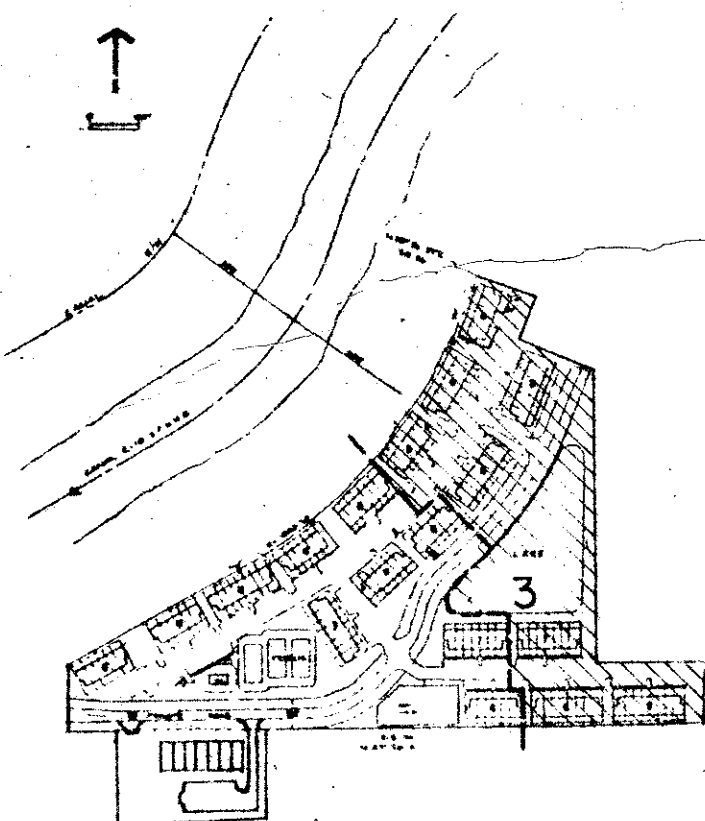

KEY MAP
SCALE: 1" = 400'

COUNTY OF PALM BEACH
STATE OF FLORIDA
This Plat was filed for record at
this day of
19....., and duly recorded in Plat Book No.
..... on page
JOHN D. DUNKLE, Clerk, Circuit Court
By..... D.C.

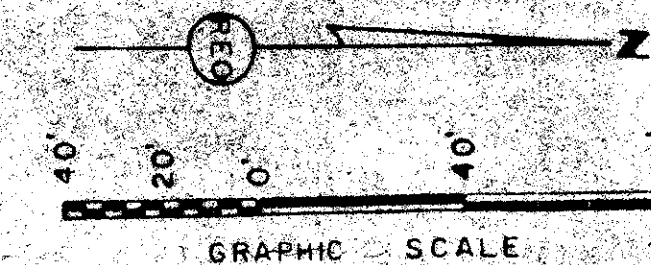

DRAWING NUMBER

DRAWING NUMBER

DRAWING NUMBER

