

55/127

DRAWING NUMBER

DRAWING NUMBER

DRAWING NUMBER

VICINITY MAP n.s.

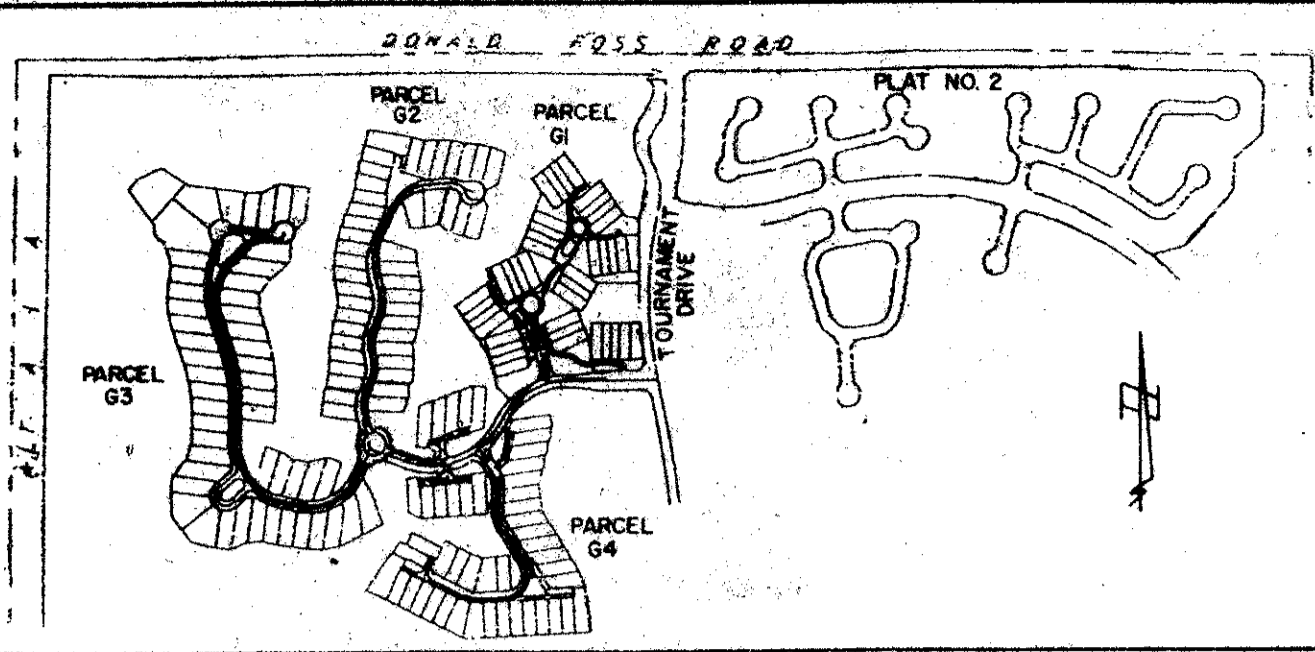

# A PLAT OF PARCEL G3 FRENCHMAN'S CREEK, A P.U.D.

## BEING A REPLAT OF A PORTION OF TRACT "A" PLAT NO. 6 FRENCHMAN'S CREEK, A P.U.D. RECORDED IN PLAT BOOK 44, PAGES 133 THROUGH 137 LYING IN SECTION 30, TOWNSHIP 41 SOUTH, RANGE 43 EAST PALM BEACH COUNTY, FLORIDA

JULY, 1986

SHEET 2 OF 4

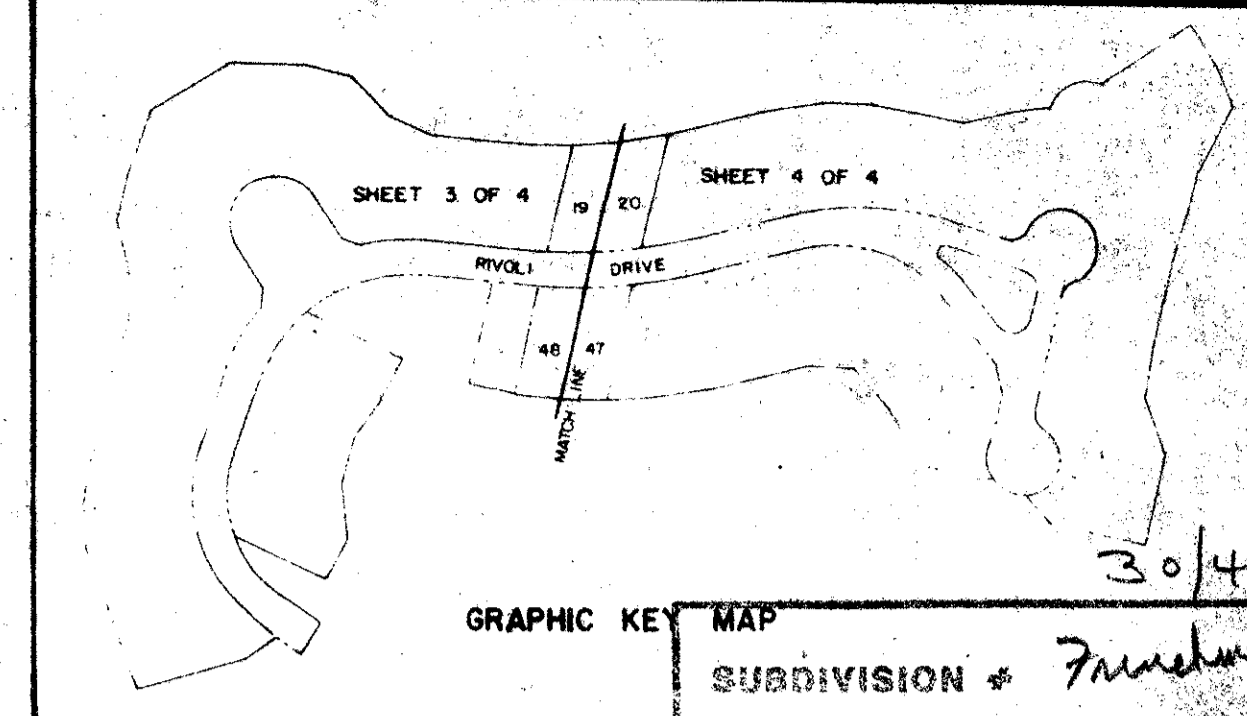

127

GRAPHIC KEY MAP	
SUBDIVISION # Frenchman's Creek	
BOOK 55	PAGE 127
FLOOD ZONE B	FLOOD MAP # 209
GRID # 12	ZONE
EE	ZIP CODE 33410
POD NAME	Parcel G3

### MORTGAGEE'S CONSENT

COUNTY OF Broward  
STATE OF FLORIDA

S.S.  
THE UNDERSIGNED HEREBY CERTIFIES THAT IT IS THE HOLDER OF A MORTGAGE UPON THE HEREON DESCRIBED PROPERTY AND DOES HEREBY JOIN IN AND CONSENT TO THE DEDICATION OF THE LANDS DESCRIBED IN THE DEDICATION HERETO, BY THE OWNERS THEREOF AND AGREES THAT ITS MORTGAGE WHICH IS RECORDED IN OFFICIAL RECORD BOOK 4987, PAGE 1743, OF THE PUBLIC RECORDS OF PALM BEACH COUNTY, FLORIDA, SHALL BE SUBORDINATED TO THE DEDICATION SHOWN HEREOF.

IN WITNESS WHEREOF, THE SAID CORPORATION HAS CAUSED THESE PRESENTS TO BE SIGNED BY ITS Vice President AND ATTESTED TO BY ITS Assistant Secretary AND ITS CORPORATE SEAL TO BE AFFIXED HEREOF BY AND WITH THE AUTHORITY OF ITS BOARD OF DIRECTORS, THIS 13th DAY OF November, A.D., 1986.

ATLANTIC FEDERAL SAVINGS AND LOAN ASSOCIATION OF PORT LAUDERDALE, A CORPORATION EXISTING UNDER THE LAWS OF THE UNITED STATES OF AMERICA

ATTEST: Mary U. Tracey

### ACKNOWLEDGEMENT

COUNTY OF Broward  
STATE OF FLORIDA

BEFORE ME, PERSONALLY APPEARED John W. Thomas AND Mary U. Tracey, TO ME WELL KNOWN, AND KNOWN TO ME TO BE THE INDIVIDUALS DESCRIBED IN AND WHO EXECUTED THE FOREGOING CONSENT OF MORTGAGE HOLDER, AS Vice President AND Assistant Secretary, OF THE ABOVE NAMED ATLANTIC FEDERAL SAVINGS AND LOAN ASSOCIATION OF PORT LAUDERDALE, AND SEVERALLY ACKNOWLEDGED TO AND BEFORE ME THAT THEY EXECUTED SUCH INSTRUMENT AS SUCH Vice President AND Assistant Secretary RESPECTIVELY OF SAID CORPORATION, AND THAT THE SEAL AFFIXED TO THE FOREGOING CONSENT OF MORTGAGE HOLDER IS THE CORPORATE SEAL OF SAID CORPORATION AND THAT IT WAS AFFIXED TO SAID INSTRUMENT BY DUE AND REGULAR CORPORATE AUTHORITY, AND THAT SAID CONSENT OF MORTGAGE HOLDER IS THE FREE ACT AND DEED OF SAID CORPORATION.

WITNESS MY HAND AND OFFICIAL SEAL THIS 13th DAY OF November, A.D., 1986.

MY COMMISSION EXPIRES: Barlene M. Bernard  
NOTARY PUBLIC

### MORTGAGEE'S CONSENT

COUNTY OF Dade  
STATE OF FLORIDA

S.S.  
THE UNDERSIGNED HEREBY CERTIFIES THAT IT IS THE HOLDER OF A MORTGAGE UPON THE HEREON DESCRIBED PROPERTY AND DOES HEREBY JOIN IN AND CONSENT TO THE DEDICATION OF THE LANDS DESCRIBED IN THE DEDICATION HERETO, BY THE OWNERS THEREOF AND AGREES THAT ITS MORTGAGE WHICH IS RECORDED IN OFFICIAL RECORD BOOK 5070, PAGE 912, 917, 918, 1002, 1009, 1014, 1023 OF THE PUBLIC RECORDS OF PALM BEACH COUNTY, FLORIDA, SHALL BE SUBORDINATED TO THE DEDICATION SHOWN HEREOF.

IN WITNESS WHEREOF, THE SAID CORPORATION HAS CAUSED THESE PRESENTS TO BE SIGNED BY ITS Senior Vice President AND ATTESTED TO BY ITS Chief Secretary AND ITS CORPORATE SEAL TO BE AFFIXED HEREOF BY AND WITH THE AUTHORITY OF ITS BOARD OF DIRECTORS, THIS 14th DAY OF November, A.D., 1986.

CORAL GABLES SAVINGS AND LOAN ASSOCIATION

ATTEST: Rosemary McClellan BY: Archie L. Stancoff

### ACKNOWLEDGEMENT

COUNTY OF Dade  
STATE OF FLORIDA

S.S.  
BEFORE ME, PERSONALLY APPEARED Archie L. Stancoff AND Rosemary McClellan, TO ME WELL KNOWN, AND KNOWN TO ME TO BE THE INDIVIDUALS DESCRIBED IN AND WHO EXECUTED THE FOREGOING CONSENT OF MORTGAGE HOLDER, AS Senior Vice President AND Chief Secretary, OF THE ABOVE NAMED CORAL GABLES SAVINGS AND LOAN ASSOCIATION, AND SEVERALLY ACKNOWLEDGED TO AND BEFORE ME THAT THEY EXECUTED SUCH INSTRUMENT AS SUCH Senior Vice President AND Chief Secretary RESPECTIVELY OF SAID CORPORATION, AND THAT THE SEAL AFFIXED TO THE FOREGOING CONSENT OF MORTGAGE HOLDER IS THE CORPORATE SEAL OF SAID CORPORATION AND THAT IT WAS AFFIXED TO SAID INSTRUMENT BY DUE AND REGULAR CORPORATE AUTHORITY, AND THAT SAID CONSENT OF MORTGAGE HOLDER IS THE FREE ACT AND DEED OF SAID CORPORATION.

WITNESS MY HAND AND OFFICIAL SEAL THIS 14th DAY OF November, A.D., 1986.

MY COMMISSION EXPIRES: 8-26-88  
Don S. Orsich  
NOTARY PUBLIC

ATLANTIC FEDERAL S & L

### DISTRICT ACKNOWLEDGEMENT

THE NORTHERN PALM BEACH COUNTY WATER CONTROL DISTRICT HEREBY ACKNOWLEDGES IT IS RECEIVING NO TRACTS AND NO EASEMENTS AND IS INCURRING NO MAINTENANCE RESPONSIBILITIES BY THE RECORDING OF THIS PLAT.

NORTHERN PALM BEACH COUNTY WATER CONTROL DISTRICT

ATTEST: Donald C. Walker  
DONALD C. WALKER, PRESIDENT  
BOARD OF SUPERVISORS

### MORTGAGEE'S CONSENT

COUNTY OF Monroe  
STATE OF NEW YORK

S.S.  
THE UNDERSIGNED HEREBY CERTIFIES THAT IT IS THE HOLDER OF A MORTGAGE UPON THE HEREON DESCRIBED PROPERTY AND DOES HEREBY JOIN IN AND CONSENT TO THE DEDICATION OF THE LANDS DESCRIBED IN THE DEDICATION HERETO, BY THE OWNERS THEREOF AND AGREES THAT ITS MORTGAGE WHICH IS RECORDED IN OFFICIAL RECORD BOOK 473, PAGE 161 OF THE PUBLIC RECORDS OF PALM BEACH COUNTY, FLORIDA, SHALL BE SUBORDINATED TO THE DEDICATION SHOWN HEREOF.

IN WITNESS WHEREOF, THE SAID CORPORATION HAS CAUSED THESE PRESENTS TO BE SIGNED BY ITS Vice President AND ATTESTED TO BY ITS Assistant Secretary AND ITS CORPORATE SEAL TO BE AFFIXED HEREOF BY AND WITH THE AUTHORITY OF ITS BOARD OF DIRECTORS, THIS 13th DAY OF November, A.D., 1986.

ROCHESTER COMMUNITY SAVINGS BANK, A CORPORATION OF THE STATE OF NEW YORK

ATTEST: John P. Colan BY: Christy L. Hanna

### ACKNOWLEDGEMENT

COUNTY OF Monroe  
STATE OF NEW YORK

S.S.  
BEFORE ME, PERSONALLY APPEARED Christy L. Hanna AND John P. Colan, TO ME WELL KNOWN, AND KNOWN TO ME TO BE THE INDIVIDUALS DESCRIBED IN AND WHO EXECUTED THE FOREGOING CONSENT OF MORTGAGE HOLDER, AS Assistant Secretary AND Senior Vice President, OF THE ABOVE NAMED ROCHESTER COMMUNITY SAVINGS BANK, A NEW YORK CORPORATION, AND SEVERALLY ACKNOWLEDGED TO AND BEFORE ME THAT THEY EXECUTED SUCH INSTRUMENT AS SUCH Assistant Secretary AND Senior Vice President RESPECTIVELY OF SAID CORPORATION, AND THAT THE SEAL AFFIXED TO THE FOREGOING CONSENT OF MORTGAGE HOLDER IS THE CORPORATE SEAL OF SAID CORPORATION AND THAT IT WAS AFFIXED TO SAID INSTRUMENT BY DUE AND REGULAR CORPORATE AUTHORITY, AND THAT SAID CONSENT OF MORTGAGE HOLDER IS THE FREE ACT AND DEED OF SAID CORPORATION.

WITNESS MY HAND AND OFFICIAL SEAL THIS 13th DAY OF November, A.D., 1986.

MY COMMISSION EXPIRES: 3/30/87  
John G. Frank  
NOTARY PUBLIC

### TITLE CERTIFICATION

STATE OF FLORIDA

WE, ROOSP, CASEY, CIKLIN, LUBITZ, MARTENS, MCBANE AND O'CONNELL, DULY LICENSED ATTORNEYS IN THE STATE OF FLORIDA, HEREBY CERTIFY THAT WE HAVE CAUSED THE TITLE TO THE HEREON DESCRIBED PROPERTY TO BE EXAMINED, THAT WE FIND THE TITLE TO THE PROPERTY IS VESTED IN HAFT-GAINES ASSOCIATES, A FLORIDA GENERAL PARTNERSHIP, THAT THE CURRENT TAXES HAVE BEEN PAID, AND THAT THE PROPERTY IS ENCUMBERED BY THE MORTGAGES SHOWN HEREOF, AND THAT WE FIND THAT ALL MORTGAGES ARE SHOWN TRUE AND CORRECT.

WITNESS MY HAND AND OFFICIAL SEAL THIS November 25, 1986 DATE BY: Robert L. Chan  
ATTORNEY AT LAW  
LICENSED IN THE STATE OF FLORIDA

### SURVEYOR'S CERTIFICATION

STATE OF FLORIDA

S.S.  
KNOW ALL MEN BY THESE PRESENTS, THAT THE UNDERSIGNED DOES HEREBY CERTIFY THAT ON 8-28-86, 1986, THEY COMPLETED THE SURVEY OF LANDS AS SHOWN ON THE FOREGOING PLAT; THAT SAID PLAT IS A CORRECT REPRESENTATION OF THE LANDS THEREIN DESCRIBED AND PLATTED; THAT PERMANENT REFERENCE MONUMENTS HAVE BEEN PLACED AS REQUIRED BY LAW, AND THAT PERMANENT CONTROL POINTS WILL BE SET UNDER THE GUARANTEES POSTED WITH THE BOARD OF COUNTY COMMISSIONERS OF PALM BEACH COUNTY, FLORIDA, FOR THE REQUIRED IMPROVEMENTS; AND THAT THE SURVEY DATA COMPLIES WITH ALL REQUIREMENTS OF CHAPTER 177, PART 1, FLORIDA STATUTES, AS AMENDED, AND ORDINANCES OF PALM BEACH COUNTY, FLORIDA.

WILLIAM G. WALLACE, INC.  
William G. Wallace  
WILLIAM G. WALLACE  
REGISTERED LAND SURVEYOR NO. 3357  
STATE OF FLORIDA

### SURVEYOR'S CERTIFICATION

STATE OF FLORIDA

S.S.  
I HEREBY CERTIFY THAT THIS PLAT WAS PREPARED AND DELINEATED UNDER MY DIRECTION AND SUPERVISION AND IS A CORRECT REPRESENTATION OF THE LANDS HEREOF DESCRIBED AS SURVEYED BY WILLIAM G. WALLACE, INC. AND THAT THE SURVEY DATA COMPLIES WITH ALL THE REQUIREMENTS OF CHAPTER 177, FLORIDA STATUTES, AS AMENDED, AND ORDINANCES OF PALM BEACH COUNTY, FLORIDA.

LINDAHL, BROWNING, FERRARI & HELLSTROM, INC.  
Linda M. Hellstrom  
LINDAHL, BROWNING, FERRARI & HELLSTROM, INC.  
REGISTERED LAND SURVEYOR NO. 3956  
STATE OF FLORIDA

### APPROVAL

COUNTY OF PALM BEACH  
STATE OF FLORIDA  
BOARD OF COUNTY COMMISSIONERS

S.S.  
THIS PLAT IS HEREBY APPROVED FOR RECORD THIS 13 DAY OF JAN, A.D., 1987.

BY: Carol A. Dunkle  
CAROL A. DUNKLE  
CLERK

ATTEST: John B. Dunkle, CLERK

BY: Kathleen B. Miller  
DEPUTY CLERK

THIS PLAT IS HEREBY APPROVED FOR RECORD THIS 13 DAY OF Jan, A.D., 1987.

BY: H.P. Kahlert  
COUNTY ENGINEER, H.P. KAHLERT, P.E.

NOTARY	NPBC WCD	ROCHESTER COMMUNITY SAVINGS
NOTARY	CORAL GABLES S & L	
LINDAHL, BROWNING, FERRARI & HELLSTROM Surveying Engineers, Planners & Surveyors		
PARCEL G3, FRENCHMAN'S CREEK 55/127 2 4		

0248-009