

OLD MARSH GOLF CLUB

APRIL, 1987 SHEET 14 OF 14

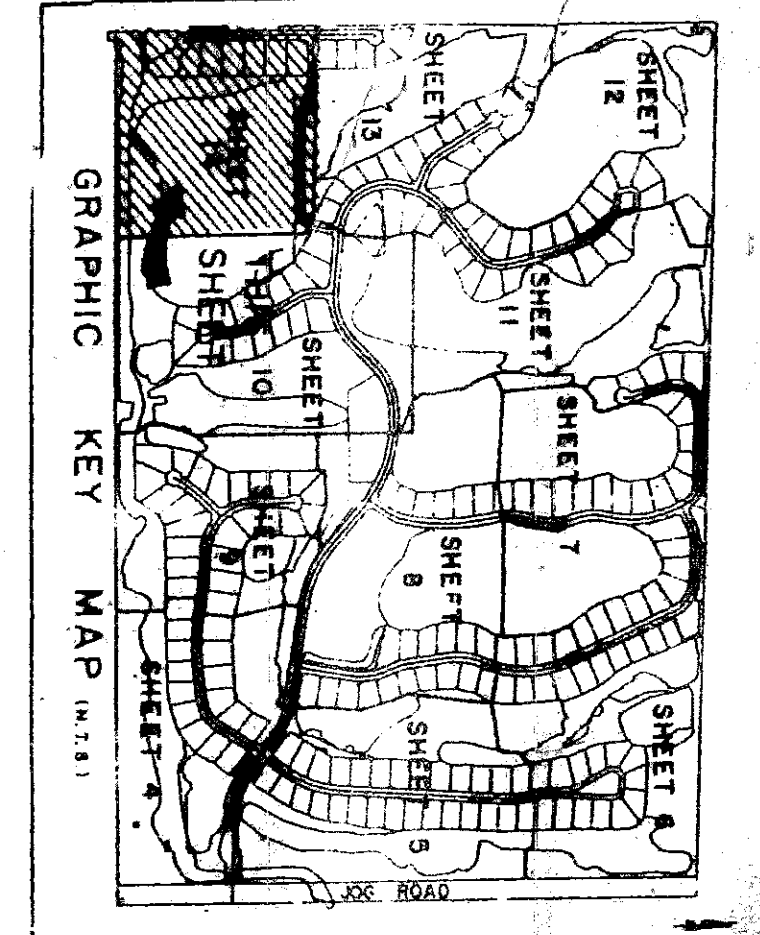
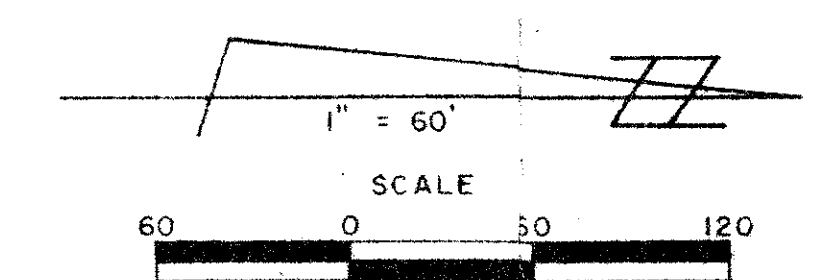

SEE SHT. 13 OF 14

SEE SHT. 10 OF 14

ADD. BY [Signature]
CHECKED BY [Signature]

- NOTES:
- SET PERMANENT CORNER MARKERS AT ALL CORNERS.
 - PERMANENT CORNER MARKERS AT ALL CORNERS.
- BEARING BASE:
THE EAST LINE OF SECTION 14, T. 28 N., R. 15 E., AND ALL OTHER BEARINGS ARE RELATIVE THEREIN.
- THE EXISTING SETBACKS FROM THE HAMP MOCK CROSSING SHALL BE MAINTAINED.
- NO CONSTRUCTION OR ANY OTHER CONSTRUCTION SHALL BE PLACED IN THE 25' BUFFER EASEMENT AREAS.
- ALL PLANTINGS, TREES OR SHRUBS SHALL BE PLACED ON DRAINAGE EASEMENTS.
- APPROVAL OF LANDSCAPING OR OTHER EASEMENTS OTHER THAN WATER OR SEWER SHALL BE ONLY WITH APPROVAL OF ALL UTILITIES AFFECTING SAME.
- WHEN DRAINAGE AND UTILITY EASEMENTS CROSS, DRAINAGE EASEMENTS SHALL TAKE PRECEDENCE THERE SHALL BE NO BUILDINGS, STRUCTURES OR RIMS OF CONSTRUCTION, TREES OR SHRUBS PLACED ON ANY LANDS OWNED BY THE HAMP MOCK BEACH COUNTY WATER CONTROL DISTRICT, ON WATER MANAGEMENT EASEMENTS OR ON WATER MANAGEMENT MAINTENANCE EASEMENTS, UNLESS APPROVED, IN PERMIT FORM, BY THE S.D.I. DISTRICT.
- UTILITIES EASEMENTS:
- DRAINAGE EASEMENT
 - UTILITY EASEMENT
 - LIMITED ACCESS EASEMENT
 - RAILROAD EASEMENT
 - GOLF COURSE
 - WATER MANAGEMENT TRAIL
 - WATER MANAGEMENT EASEMENT
 - WATER MANAGEMENT MAINTENANCE EASEMENT
 - WETLAND PRESERVATION AREA

Subdivision - Old Marsh G.C.
Book 58
Page 75
Flood Zone B
Flood Map #115B
Zoning RE
Zip Code 33418
PUD
PUD NAME
TAZ 797

14
14
14