

FLAT C
BRIARWOOD AT INDIAN SPRING
 A PORTION OF A P.U.D.
 SECTIONS 34 & 35, TOWNSHIP 45 SOUTH, RANGE 42 EAST
 APRIL, 1987

P.U.
 DIVISION
 RANGE
 TOWNSHIP
 COUNTY

STATE OF FLORIDA
 COUNTY OF PALM BEACH
 This plat was filed for record at 2:19 P.M.
 this 25 day of NOVEMBER
 1987, and duly recorded in Plat Book No.
 58 on page 114-115.
 JOHN B. DUNKLE, Clerk, Circuit Court
 By *Christina G. ...*, D.C.

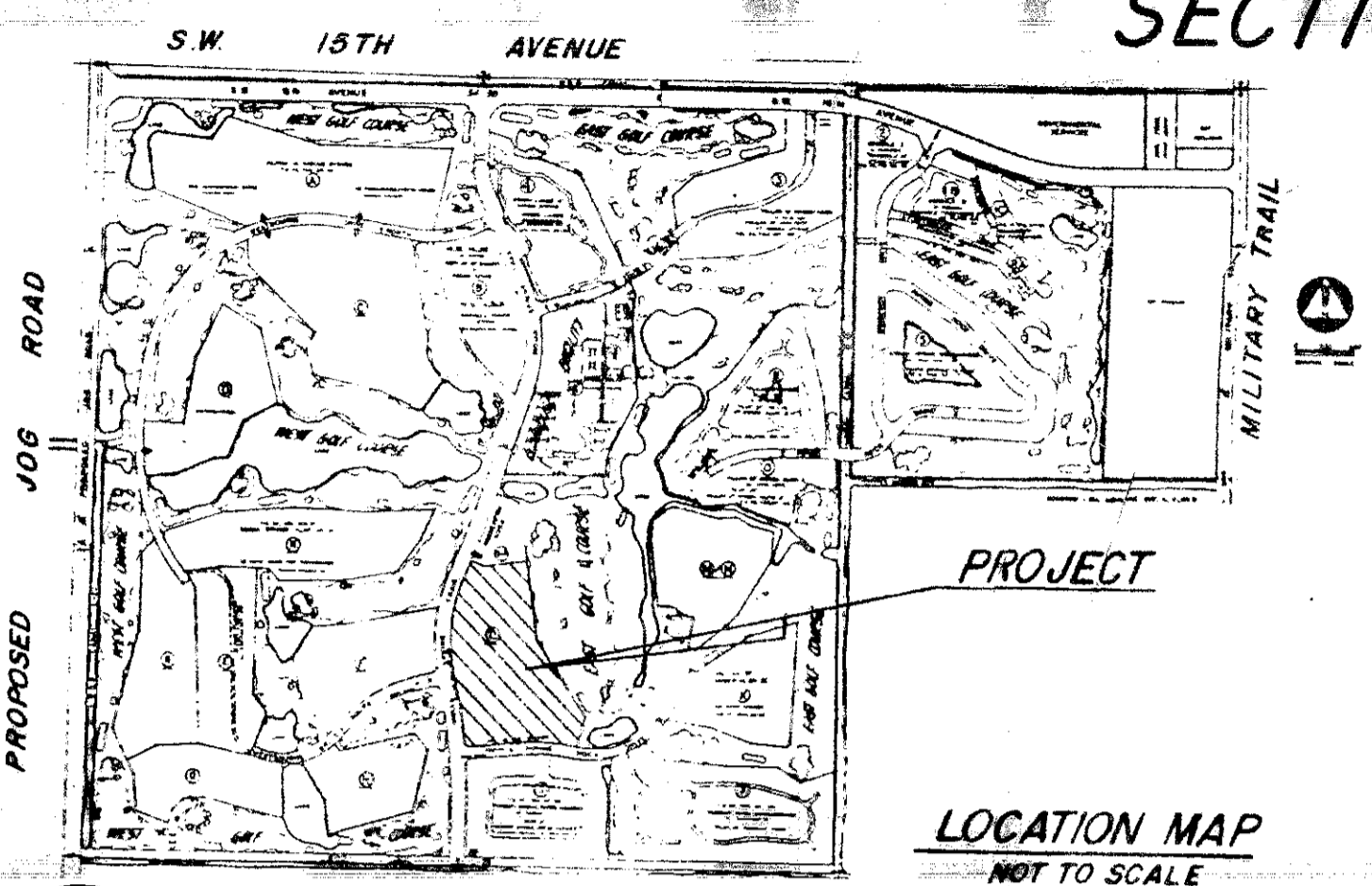

INDIAN SPRING
 master site plan

DEDICATION
 KNOW ALL MEN BY THESE PRESENTS, THAT THE RESORT AT INDIAN SPRING, INC., A FLORIDA CORPORATION, OWNER OF THE LAND SHOWN HEREON AS PLAT OF BRIARWOOD AT INDIAN SPRING, SAID LAND LYING IN SECTIONS 34 AND 35, TOWNSHIP 45 SOUTH, RANGE 42 EAST, PALM BEACH COUNTY, FLORIDA, SAID LAND BEING MORE PARTICULARLY DESCRIBED AS FOLLOWS:

DESCRIPTION
 A PARCEL OF LAND IN SECTIONS 34 AND 35, TOWNSHIP 45 SOUTH, RANGE 42 EAST, PALM BEACH COUNTY, FLORIDA, SAID PARCEL OF LAND BEING MORE PARTICULARLY DESCRIBED AS FOLLOWS:

BEGINNING AT PRM NUMBER 17 ON THE NORTHERLY RIGHT OF WAY LINE OF PIPING ROCK DRIVE ACCORDING TO THE PLAT OF INDIAN SPRING TRAIL AND PIPING ROCK DRIVE, AS RECORDED IN PLAT BOOK 36, PAGES 184-186, INCLUSIVE, PUBLIC RECORDS PALM BEACH COUNTY, FLORIDA; THENCE NORTH 83° 47' 22" EAST, ALONG SAID LINE, A DISTANCE OF 367.70 FEET TO THE POINT OF CURVATURE OF A CURVE CONCAVE SOUTHERLY HAVING A RADIUS OF 1,276.04 FEET; THENCE EASTERLY ALONG SAID CURVE, THROUGH A CENTRAL ANGLE OF 14° 42' 19", A DISTANCE OF 276.17 FEET TO THE POINT OF TANGENCY; THENCE SOUTH 81° 30' 1" EAST, ALONG SAID LINE, A DISTANCE OF 144.00 FEET; THENCE NORTH 13° 08' 19" EAST, A DISTANCE OF 212.92 FEET; THENCE NORTH 32° 50' 31" WEST, A DISTANCE OF 640.69 FEET; THENCE NORTH 09° 27' 54" WEST, A DISTANCE OF 406.27 FEET; THENCE NORTH 09° 56' 10" WEST, A DISTANCE OF 134.46 FEET; THENCE SOUTH 81° 04' 42" WEST, A DISTANCE OF 288.36 FEET; THENCE NORTH 67° 49' 54" WEST, A DISTANCE OF 103.44 FEET TO A POINT ON A CURVE CONCAVE WESTERLY, HAVING A RADIUS OF 844.00 FEET, AND WHOSE RADIUS POINT BEARS NORTH 67° 49' 54" WEST; SAID POINT ALSO BEING ON THE EASTERLY RIGHT OF WAY LINE OF INDIAN SPRING TRAIL AS SHOWN ON SAID PLAT; THENCE SOUTHERLY ALONG SAID CURVE AND LINE, THROUGH A CENTRAL ANGLE OF 0° 10' 10" A DISTANCE OF 23.80 FEET TO THE POINT OF TANGENCY; THENCE SOUTH 22° 20' 15" WEST, ALONG SAID LINE, A DISTANCE OF 140.00 FEET TO THE POINT OF CURVATURE OF A CURVE CONCAVE EASTERLY, HAVING A RADIUS OF 946.00 FEET; THENCE SOUTHERLY ALONG SAID CURVE AND LINE, THROUGH A CENTRAL ANGLE OF 35° 21' 15", A DISTANCE OF 583.73 FEET TO THE POINT OF TANGENCY; THENCE SOUTH 13° 01' 00" EAST, ALONG SAID LINE, A DISTANCE OF 100.00 FEET TO THE POINT OF CURVATURE OF A CURVE CONCAVE WESTERLY, HAVING A RADIUS OF 4054.00 FEET; THENCE SOUTHERLY ALONG SAID CURVE AND LINE, THROUGH A CENTRAL ANGLE OF 05° 53' 35", A DISTANCE OF 416.97 FEET TO THE END OF SAID CURVE; THENCE SOUTH 51° 40' 01" EAST, ALONG SAID LINE, A DISTANCE OF 35.07 FEET TO THE POINT OF BEGINNING.

CONTAINING 18.088 ACRES, MORE OR LESS.
 SUBJECT TO EASEMENTS, RESERVATIONS, RESTRICTIONS, AND RIGHTS OF WAY OF RECORD.

HAS CAUSED THE SAME TO BE SURVEYED AND PLATTED AS SHOWN HEREON, AND DOES HEREBY MAKE THE FOLLOWING DEDICATIONS AND RESERVATIONS:

- TRACT "A" AS SHOWN HEREON, IS HEREBY DEDICATED TO THE BRIARWOOD AT INDIAN SPRING ASSOCIATION, INC., A FLORIDA CORPORATION NOT FOR PROFIT, FOR PRIVATE ROAD RIGHT OF WAY PURPOSES AND IS THE PERPETUAL MAINTENANCE OBLIGATION OF SAID ASSOCIATION, ITS SUCCESSORS AND ASSIGNS, WITHOUT RECOURSE TO PALM BEACH COUNTY.
- TRACT "B" AS SHOWN HEREON, IS HEREBY DEDICATED TO THE BRIARWOOD AT INDIAN SPRING ASSOCIATION, INC., A FLORIDA CORPORATION NOT FOR PROFIT, FOR INGRESS, EGRESS, UTILITY AND DRAINAGE AND ALL OTHER LAWFUL PURPOSES AND IS THE PERPETUAL MAINTENANCE OBLIGATION OF SAID ASSOCIATION, ITS SUCCESSORS AND ASSIGNS, WITHOUT RECOURSE TO PALM BEACH COUNTY.
- TRACTS "C" AND "D" AS SHOWN HEREON ARE HEREBY DEDICATED TO THE BRIARWOOD AT INDIAN SPRING ASSOCIATION, INC., A FLORIDA CORPORATION NOT FOR PROFIT, THEIR SUCCESSORS, OR ASSIGNS, FOR THE PURPOSES OF RESIDENTIAL DWELLING UNITS AND ALL OTHER LAWFUL PURPOSES, AND IS THE PERPETUAL MAINTENANCE OBLIGATION OF SAID CORPORATION, ITS SUCCESSORS AND ASSIGNS, WITHOUT RECOURSE TO PALM BEACH COUNTY.
- TRACTS "E" AND "F" SHOWN HEREON AS WATER MANAGEMENT TRACTS ARE HEREBY DEDICATED TO THE BRIARWOOD AT INDIAN SPRING ASSOCIATION, INC., A FLORIDA CORPORATION NOT FOR PROFIT, FOR THE PROPER PURPOSES AND ARE THE PERPETUAL MAINTENANCE OBLIGATION OF SAID ASSOCIATION, ITS SUCCESSORS OR ASSIGNS, WITHOUT RECOURSE TO PALM BEACH COUNTY.
- TRACT "G", AS SHOWN HEREON, IS HEREBY DEDICATED TO THE BRIARWOOD AT INDIAN SPRING ASSOCIATION, INC., A FLORIDA CORPORATION NOT FOR PROFIT, FOR THE PURPOSES OF RECREATIONAL FACILITIES, AND ALL OTHER LAWFUL PURPOSES, AND IS THE PERPETUAL MAINTENANCE OBLIGATION OF SAID ASSOCIATION, ITS SUCCESSORS OR ASSIGNS, WITHOUT RECOURSE TO PALM BEACH COUNTY.
- THE 20' LAKE MAINTENANCE EASEMENT AS SHOWN HEREON IS HEREBY DEDICATED TO THE BRIARWOOD AT INDIAN SPRING ASSOCIATION, INC., A FLORIDA CORPORATION NOT FOR PROFIT, FOR ACCESS TO AND MAINTENANCE OF SAID WATER MANAGEMENT TRACT "E", AND SHALL BE THE PERPETUAL MAINTENANCE OBLIGATION OF SAID ASSOCIATION, ITS SUCCESSORS OR ASSIGNS, WITHOUT RECOURSE TO PALM BEACH COUNTY.
- THE 25' ACCESS EASEMENT AS SHOWN HEREON IS HEREBY DEDICATED TO THE BRIARWOOD AT INDIAN SPRING ASSOCIATION, INC., A FLORIDA CORPORATION NOT FOR PROFIT, FOR INGRESS, EGRESS, UTILITIES AND DRAINAGE AND ALL OTHER LAWFUL PURPOSES AND IS THE PERPETUAL MAINTENANCE OBLIGATION OF SAID ASSOCIATION, ITS SUCCESSORS OR ASSIGNS, WITHOUT RECOURSE TO PALM BEACH COUNTY.
- THE UTILITY EASEMENTS, AS SHOWN HEREON, ARE HEREBY DEDICATED IN PERPETUITY FOR THE PURPOSES OF CONSTRUCTION AND MAINTENANCE OF UTILITY FACILITIES.
- THE DRAINAGE EASEMENTS, AS SHOWN HEREON, ARE HEREBY DEDICATED TO THE BRIARWOOD AT INDIAN SPRING ASSOCIATION, INC., A FLORIDA CORPORATION NOT FOR PROFIT, FOR DRAINAGE AND ALL OTHER LAWFUL PURPOSES, AND ARE THE PERPETUAL MAINTENANCE OBLIGATION OF SAID ASSOCIATION, ITS SUCCESSORS AND ASSIGNS, WITHOUT RECOURSE TO PALM BEACH COUNTY.
- THE 5 FOOT LIMITED ACCESS EASEMENT, AS SHOWN HEREON, IS HEREBY DEDICATED TO THE BOARD OF COUNTY COMMISSIONERS OF PALM BEACH COUNTY, FLORIDA, FOR THE PURPOSES OF CONTROL AND JURISDICTION OVER ACCESS RIGHTS.
- PALM BEACH COUNTY RESERVES THE RIGHT, BUT NOT THE OBLIGATION, TO MAINTAIN THOSE PORTIONS OF THE DRAINAGE SYSTEM ASSOCIATED WITH COUNTY ROADS.

IN WITNESS WHEREOF, THE RESORT AT INDIAN SPRING, INC., A FLORIDA CORPORATION, HAS CAUSED THESE PRESENTS TO BE SIGNED BY ITS PRESIDENT AND ATTESTED BY ITS VICE-PRESIDENT, AND ITS CORPORATE SEAL TO BE AFFIXED HERETO BY AND WITH THE AUTHORITY OF ITS BOARD OF DIRECTORS, THIS 12th DAY OF August, 1987.

ATTEST: *Alvin Kaplan* ALVIN KAPLAN, VICE-PRESIDENT
 BY: *Leonard E. Greenberg* LEONARD E. GREENBERG, PRESIDENT

ACKNOWLEDGEMENT
 STATE OF FLORIDA
 COUNTY OF PALM BEACH
 BEFORE ME PERSONALLY APPEARED LEONARD E. GREENBERG AND ALVIN KAPLAN, TO ME WELL KNOWN, AND KNOWN TO BE THE INDIVIDUALS DESCRIBED IN AND WHO EXECUTED THE FOREGOING INSTRUMENT AS PRESIDENT AND VICE-PRESIDENT OF THE ABOVE NAMED RESORT AT INDIAN SPRING, INC., AND SEVERALLY ACKNOWLEDGED TO AND BEFORE ME THAT THEY EXECUTED SUCH INSTRUMENT AS PRESIDENT AND VICE-PRESIDENT RESPECTIVELY, OF SAID CORPORATION, AND THAT THE SEAL AFFIXED TO THE FOREGOING INSTRUMENT IS THE CORPORATE SEAL OF THE SAID CORPORATION AND THAT IT WAS AFFIXED TO SAID INSTRUMENT BY DUE AND REGULAR CORPORATE AUTHORITY AND THAT SAID INSTRUMENT IS THE FREE ACT AND DEED OF SAID CORPORATION.

WITNESS MY HAND AND OFFICIAL SEAL THIS 12th DAY OF August, 1987, A.D.
 MY COMMISSION EXPIRES: _____

MORTGAGEE'S CONSENT
 STATE OF FLORIDA
 COUNTY OF PALM BEACH SS

THE UNDERSIGNED HEREBY CERTIFIES THAT IT IS THE HOLDER OF A MORTGAGE UPON THE PROPERTY DESCRIBED HEREON AND DOES HEREBY JOIN IN AND CONSENT TO THE DEDICATION OF THE LAND DESCRIBED IN SAID DEDICATION BY THE OWNER THEREOF AND AGREES THAT ITS MORTGAGE WHICH IS RECORDED IN OFFICIAL RECORDS BOOK 4843 AT PAGE 579, OFFICIAL RECORDS BOOK 4933 AT PAGE 1784 AND OFFICIAL RECORDS BOOK 5255 AT PAGE 1699 OF THE PUBLIC RECORDS OF PALM BEACH COUNTY, FLORIDA, SHALL BE SUBORDINATED TO THE DEDICATION SHOWN HEREON.

IN WITNESS WHEREOF, THE SAID CORPORATION HAS CAUSED THESE PRESENTS TO BE SIGNED BY ITS VICE-PRESIDENT AND ATTESTED TO BY ITS ASST. CASHIER, AND ITS CORPORATE SEAL TO BE AFFIXED HERETO BY AND WITH THE AUTHORITY OF THE BOARD OF DIRECTORS THIS 15th DAY OF August, A.D., 1987.

ATTEST: *Carol Roberts* BY: *Carol Roberts*
 CAROL A. ROBERTS, CHAIR

ACKNOWLEDGEMENT
 STATE OF FLORIDA
 COUNTY OF PALM BEACH SS
 BEFORE ME PERSONALLY APPEARED *Baker ...* AND *...* TO ME WELL KNOWN, AND KNOWN TO BE THE INDIVIDUALS DESCRIBED IN AND WHO EXECUTED THE FOREGOING INSTRUMENT AS *...* AND *...* OF THE ABOVE NAMED FLORIDA NATIONAL BANK, AND SEVERALLY ACKNOWLEDGED TO AND BEFORE ME THAT THEY EXECUTED SUCH INSTRUMENT AS *...* AND *...* RESPECTIVELY, OF SAID CORPORATION, AND THAT THE SEAL AFFIXED TO THE FOREGOING INSTRUMENT IS THE CORPORATE SEAL OF THE SAID CORPORATION AND THAT IT WAS AFFIXED TO SAID INSTRUMENT BY DUE AND REGULAR CORPORATE AUTHORITY AND THAT SAID INSTRUMENT IS THE FREE ACT AND DEED OF SAID CORPORATION.

WITNESS MY HAND AND OFFICIAL SEAL THIS 12th DAY OF August, A.D. 1987.
 MY COMMISSION EXPIRES: _____

TITLE CERTIFICATION:
 STATE OF FLORIDA
 COUNTY OF PALM BEACH SS

I, ALBERT N. PROUJANSKY A DULY LICENSED ATTORNEY IN THE STATE OF FLORIDA, DO HEREBY CERTIFY THAT I HAVE EXAMINED THE TITLE TO THE HEREOF DESCRIBED PROPERTY; THAT I FIND THE TITLE TO THE PROPERTY IS VESTED TO THE RESORT AT INDIAN SPRING, INC., A FLORIDA CORPORATION; THAT THE CURRENT TAXES HAVE BEEN PAID; THAT THE PROPERTY IS ENCUMBERED BY THE MORTGAGE SHOWN HEREON; THAT ALL MORTGAGES ARE SHOWN AND ARE TRUE AND CORRECT.

DATE: August 13, 1987
 BY: *Albert N. Proujansky* ALBERT N. PROUJANSKY

COUNTY APPROVALS
 BOARD OF COUNTY COMMISSIONERS
 OF PALM BEACH COUNTY, FLORIDA:

THIS PLAT IS HEREBY APPROVED FOR RECORD THIS 24th DAY OF NOVEMBER, A.D., 1987.
 BY: *Carol Roberts*
 CAROL A. ROBERTS, CHAIR
 ATTEST: JOHN B. DUNKLE, CLERK
 BY: *Rick S. ...*
 RICK S. ... DEPUTY CLERK

COUNTY ENGINEER
 THIS PLAT IS HEREBY APPROVED FOR RECORD THIS 24th DAY OF NOVEMBER, A.D., 1987.
 BY: *M. F. ...*
 M. F. ... COUNTY ENGINEER

- NOTES:**
- PERMANENT REFERENCE MONUMENTS ARE DESIGNATED THUSLY: ■
 - PERMANENT CONTROL POINTS ARE DESIGNATED THUSLY: ⊕
 - BUILDING SETBACK LINES SHALL BE AS REQUIRED BY ORDINANCES OF PALM BEACH COUNTY, FLORIDA.
 - A. NO BUILDINGS OR ANY KIND OF CONSTRUCTION SHALL BE PLACED ON UTILITY OR DRAINAGE EASEMENTS.
 B. NO STRUCTURES, TREES OR SHRUBS SHALL BE PLACED ON DRAINAGE EASEMENTS.
 C. APPROVAL OF LANDSCAPING ON UTILITY EASEMENTS SHALL BE ONLY WITH THE APPROVAL OF ALL UTILITIES OCCUPYING SAME.
 - IN INSTANCES WHERE DRAINAGE AND UTILITY EASEMENTS INTERSECT, THE AREAS OF INTERSECTION ARE DRAINAGE AND UTILITY EASEMENTS. CONSTRUCTION, OPERATION AND MAINTENANCE OF UTILITIES IN THESE AREAS OF INTERSECTION SHALL NOT INTERFERE WITH THE CONSTRUCTION, OPERATION AND MAINTENANCE OF DRAINAGE FACILITIES LOCATED THEREIN.
 - BEARINGS CITED HEREIN ARE IN THE MERIDIAN OF THE FLORIDA STATE PLANE COORDINATE SYSTEM.
 - THERE MAY BE ADDITIONAL RESTRICTIONS THAT ARE NOT RECORDED ON THIS PLAT THAT MAY BE FOUND IN THE PUBLIC RECORDS OF THIS COUNTY.

SURVEYOR'S CERTIFICATION:
 STATE OF FLORIDA
 COUNTY OF PALM BEACH SS

I HEREBY CERTIFY THAT THE PLAT SHOWN HEREON IS A TRUE AND CORRECT REPRESENTATION OF A SURVEY, MADE UNDER MY RESPONSIBLE DIRECTION AND SUPERVISION, AND THAT SAID SURVEY IS ACCURATE TO THE BEST OF MY KNOWLEDGE AND BELIEF AND THAT THE (P.R.M.'S) PERMANENT REFERENCE MONUMENTS HAVE BEEN SET AND THAT THE (P.C.P.'S) PERMANENT REFERENCE POINTS WILL BE SET UNDER THE GUARANTEES POSTED WITH PALM BEACH COUNTY FOR THE REQUIRED IMPROVEMENTS; AND FURTHER THAT THE SURVEY DATA COMPLIES WITH THE REQUIREMENTS OF CHAPTER 177, FLORIDA STATUTES, AS AMENDED, AND ORDINANCES OF PALM BEACH COUNTY, FLORIDA.

DATE: Sept. 29, 1987
 BY: *Joseph M. Tucker* JOSEPH M. TUCKER

THIS INSTRUMENT WAS PREPARED BY JOSEPH M. TUCKER IN THE OFFICES OF ROSSI AND MALAVASI ENGINEERS, INC., 1675 PALM BEACH LAKES BOULEVARD, WEST PALM BEACH, FLORIDA 33401. TELEPHONE: 737-8844

58 - Briarwood at Indian Spring
 114
 994 F 34
 2058 F 35
 ES
 38467
 PUD
 TAZ 453

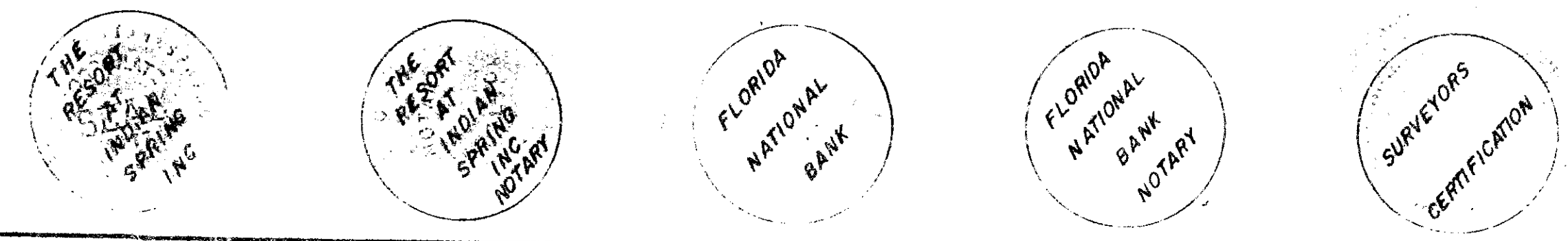

ROSSI AND MALAVASI ENGINEERS, INC.
 WEST PALM BEACH, FLORIDA

PLAT OF
BRIARWOOD AT INDIAN SPRING
 IN 2 SHEETS SHEET NO. 1

Date	APRIL, 1987	Designed	R. ANDERSON	Checked	NONE
Approved		Drawn	D. FREDERICK	Job No.	
		Checked		File No.	