

BOCA WINDS - PARCEL F

LYING IN SECTION 27, TOWNSHIP 47 SOUTH, RANGE 41 EAST
BEING A REPLAT OF A PORTION OF TRACTS 12, 13, 14, 15 and 16 OF FLORIDA FRUITLANDS COMPANY'S SUBDIVISION NO. 2, P.B. 1, PG. 102, OF THE PUBLIC RECORDS OF THE COUNTY OF PALM BEACH, STATE OF FLORIDA

APRIL 1987

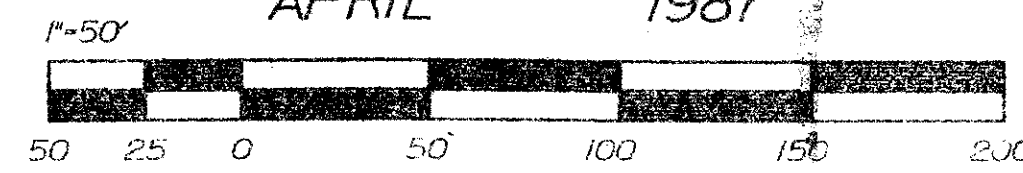

SHEET 3 OF 4

STATE OF FLORIDA
COUNTY OF PALM BEACH
THIS PLAT WAS FILED FOR RECORD
AT THIS DAY
OF A.D. 1987, AND
DULY RECORDED IN PLAT BOOK
ON PAGE(S) THRU
BY: JOHN B. DUNKLE,
CLERK OF THE CIRCUIT COURT
G.C.

FLORIDA FRUITLANDS COMPANY'S
SUBDIVISION NO. 2
(P.B. 1, PG. 102)

MATCH LINE
(SEE SHEET 2 OF 4)

MATCH LINE
(SEE SHEET 4 OF 4)



NOTES:
- BUILDING SETBACK REQUIREMENTS ARE AS PER PALM BEACH COUNTY ZONING REGULATIONS.
- THERE MAY BE ADDITIONAL RESTRICTIONS THAT ARE NOT RECORDED ON THIS PLAT THAT MAY BE FOUND IN THE PUBLIC RECORDS OF THIS COUNTY.
- NO LANDSCAPING OR ABOVE GRADE ENCROACHMENTS ARE PERMITTED WITHIN DRAINAGE MAINTENANCE EASEMENTS.

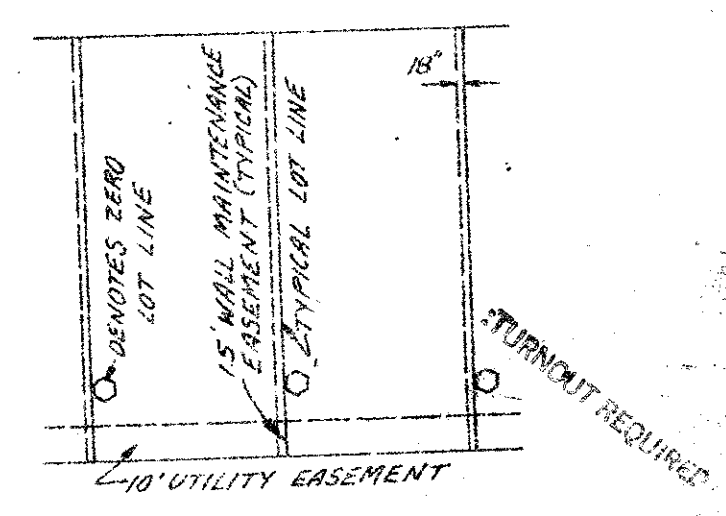
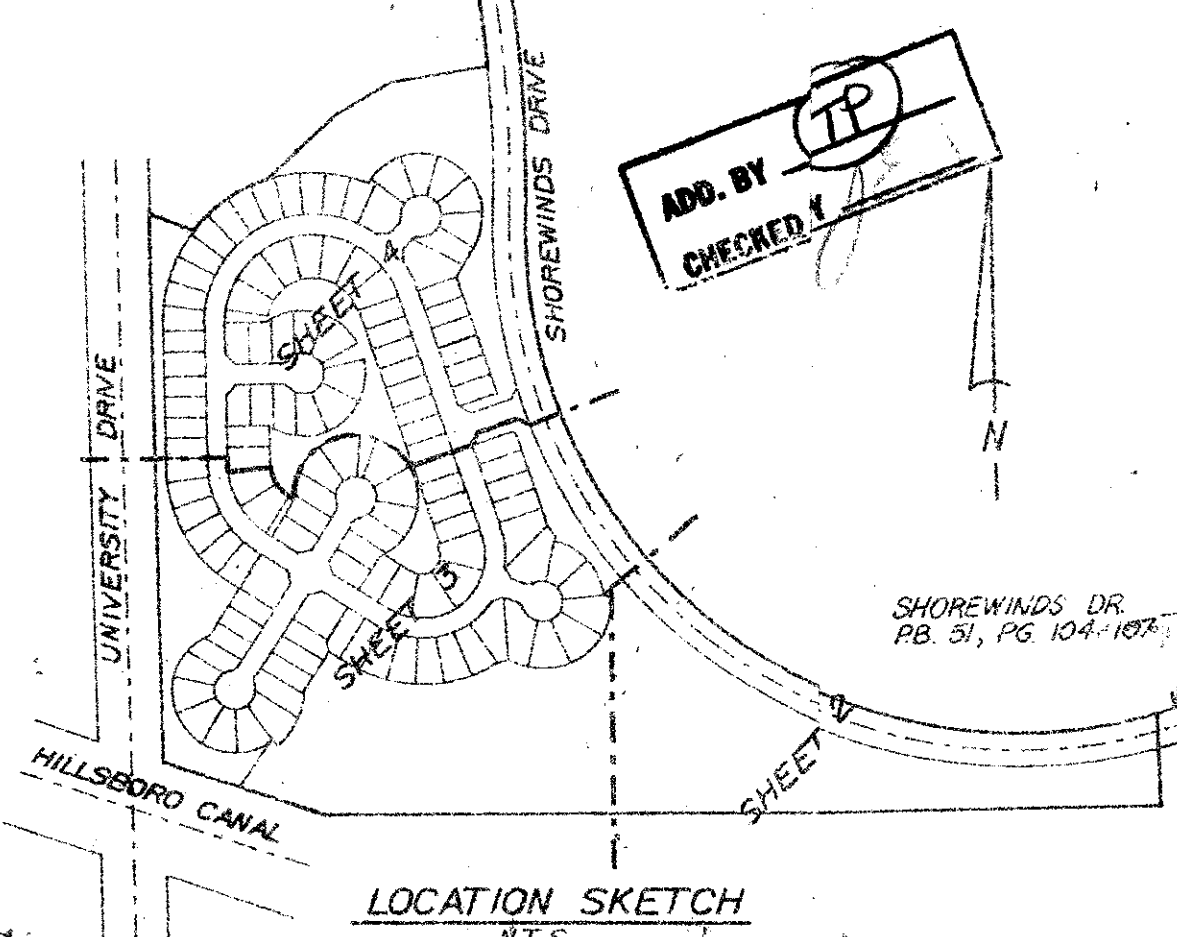

TYPICAL WALL MAINTENANCE EASEMENT
0201-007

THIS INSTRUMENT WAS PREPARED BY STEPHEN G. VRABEL, P.L.S. IN AND FOR THE OFFICES OF CONSULTTECH ENGINEERING, INC. 3661 W. OAKLAND PARK BLVD., SUITE 308 FORT LAUDERDALE, FLORIDA 33311

CONSULTTECH ENGINEERING, INC.
CONSULTING ENGINEERS • PLANNERS • LAND SURVEYORS
1000 BANK BUILDING
OAK BLVD., SUITE 308
FORT LAUDERDALE, FLORIDA 33311

PRAT # 167
BOOK 102
PAGE 102
SECTION 27
TOWNSHIP 47
RANGE 41
ZIP CODE 33404
SE
PUD NAME
Parcel F

TRACT "L-1"
WATER MANAGEMENT TRACT & DRAINAGE EASEMENT TO BE MAINTAINED BY THE B.W. HOMEOWNERS ASSOCIATION, INC. A FLORIDA NOT FOR PROFIT CORPORATION, ITS SUCCESSORS AND ASSIGNS, WITHOUT RECOURSE TO PALM BEACH COUNTY, FLORIDA.

30' ROAD R/W AS PER PLAT BOOK 1, PG. 102

FLORIDA FRUITLANDS COMPANY'S SUBDIVISION NO. 2
PLAT BOOK 1, PAGE 102

BOCA WINDS - PARCEL F 167