

# TRACT 43 OF WELLINGTON P.U.D.

BEING A REPLAT OF A PART OF TRACT 43 OF WELLINGTON P.U.D. AS RECORDED IN PLAT BOOK 44, PAGE 61, INCLUSIVE, OF THE PUBLIC RECORDS OF PALM BEACH COUNTY, FLORIDA AND OTHER LANDS.

## IN PART OF SECTIONS 10 AND 15, TOWNSHIP 44 SOUTH, RANGE 41 EAST PALM BEACH COUNTY, FLORIDA IN FOUR SHEETS SHEET NO. 2

GEE & JENSON  
ENGINEERS - ARCHITECTS - PLANNERS, INC.  
WEST PALM BEACH, FLORIDA  
JULY 1987



PLAT LIMITS

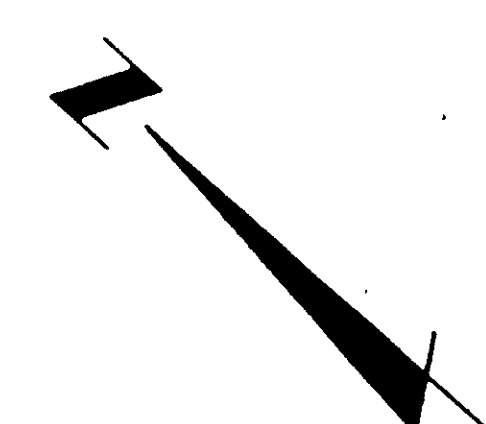

STATE OF FLORIDA  
COUNTY OF PALM BEACH  
This plat was filed for  
record at \_\_\_\_\_ M. this \_\_\_\_\_ day  
of \_\_\_\_\_ 1988, and duly  
recorded in Plat Book No. \_\_\_\_\_  
on Pages \_\_\_\_\_ thru \_\_\_\_\_  
JOHN B. DUNKLE  
Clerk Circuit Court  
By: \_\_\_\_\_ D.C.



AR  
TIA 708  
PUD 86-32

COMPUTED \_\_\_\_\_  
DRAWN \_\_\_\_\_  
CHECKED \_\_\_\_\_  
COMMENTS \_\_\_\_\_  
APPROVED \_\_\_\_\_  
REVISION \_\_\_\_\_

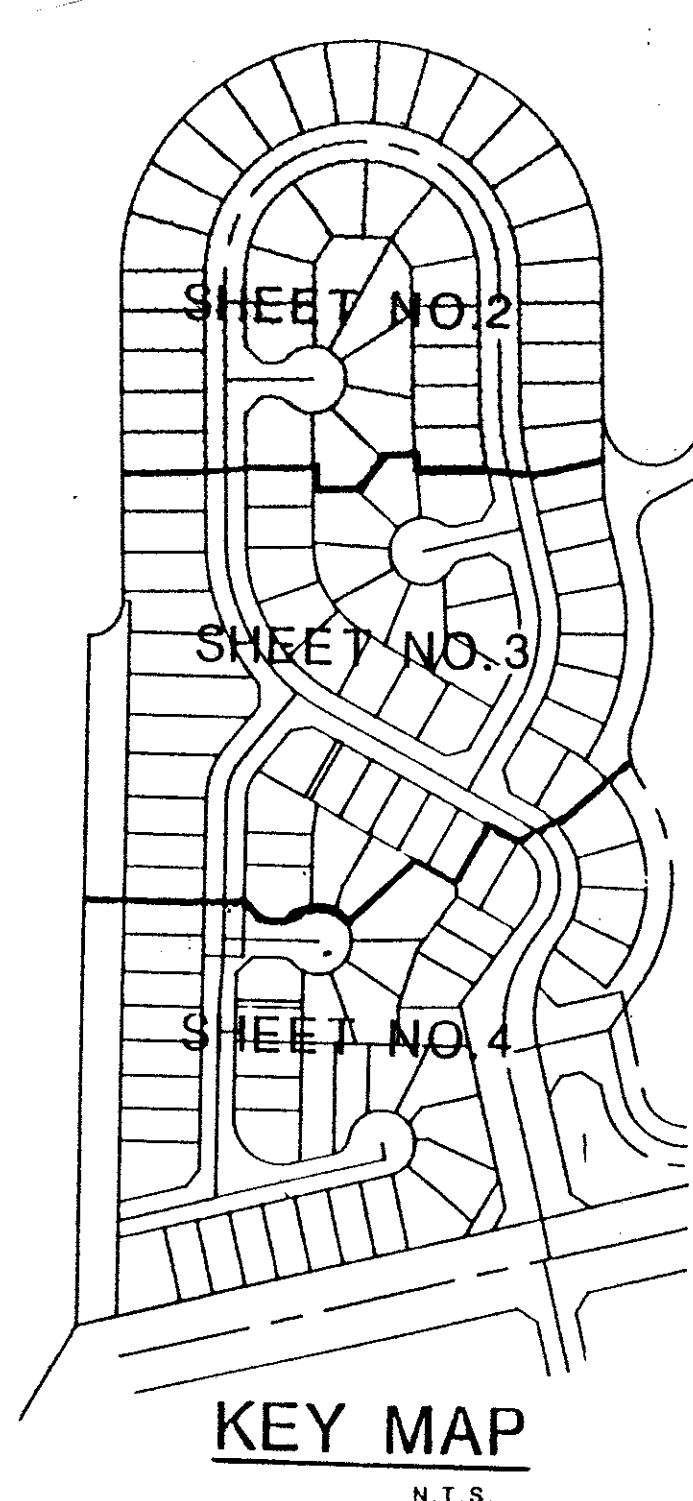

LAKE WELLINGTON  
O.R.B.2452 PGS. 250-266  
INCLUSIVE

MATCH LINE SEE SHEET NO. 3

TRACT 43 OF WELLINGTON P.U.D. 59/69