

PART OF BOCA DEL MAR NO. 4 P.U.D.

BOCA PARK

A PLAT OF A PORTION OF SECTION 22, TOWNSHIP 47 SOUTH, RANGE 42 EAST, PALM BEACH COUNTY, FLORIDA, BEING A REPLAT OF A PORTION OF TRACT 35, BOCA DEL MAR NO. 4, AS RECORDED IN PLAT BOOK 30, PAGES 85 & 86 OF THE PUBLIC RECORDS OF PALM BEACH COUNTY, FLORIDA TOGETHER WITH A REPLAT OF A PORTION OF LAKES OF WOODHAVEN - PHASE 1, AS RECORDED IN PLAT BOOK 44, PAGES 167 - 169 OF THE PUBLIC RECORDS OF PALM BEACH COUNTY, FLORIDA
PALM BEACH COUNTY, FLORIDA

WALTER A. CORNNELL, INC. CONSULTING ENGINEERS & LAND SURVEYORS SHEET 2 OF 3

TITLE CERTIFICATE STATE OF FLORIDA, COUNTY OF PALM BEACH

We, ALPHA TITLE COMPANY, a title insurance company, duly licensed in the State of Florida, do hereby certify that we have examined the title to the hereon described property; that we find the title to the property is vested to Ariel Homes Corporation of Boca Park; that the current taxes have been paid; and that we find the property is encumbered by the mortgage shown hereon; that there are no other encumbrances of record; and that we find that all mortgages are shown and are true and correct.

Edward F. Joyce Vice-President February 7th, 1988
EDWARD F. JOYCE, VICE-PRESIDENT

SURVEYOR'S CERTIFICATE

This is to certify that the Plat shown hereon is a true and correct representation of a survey made under my responsible direction and supervision, that the survey is accurate to the best of my knowledge and belief and that Permanent Reference Monuments (P.R.M.'s) have been placed as required by law and that Permanent Control Points (P.C.P.'s) will be set under guarantees posted with the Board of County Commissioners at Palm Beach County, Florida for the required improvements and further that the survey data complies with all the requirements of Chapter 177 Florida Statutes, as amended, and ordinances of Palm Beach County.

Walter A. Cornnell
Walter A. Cornnell
Florida Reg. Land Surveyor #1757

MORTGAGEE'S CONSENT STATE OF FLORIDA, COUNTY OF DADE

The undersigned hereby certifies that it is the holder of a mortgage upon the property described hereon and does hereby join in and consent to the dedication of the land described in said dedication by the owner thereof and agrees that its mortgage which is recorded in Official Record Book 5619 at pages 1105 of the public records of Palm Beach County, Florida, shall be subordinated to the dedication shown hereon.

IN WITNESS WHEREOF, the said corporation has caused these presents to be signed by its Vice-President, Ralph Gilbert and attested to by its Vice-President, Charles Torres and its corporate seal to be affixed hereon by and with the authority of its Board of Directors this 29th day of September, 1988.

BY: Ralph Gilbert Vice-President
RALPH GILBERT, VICE-PRESIDENT
ATTEST: Charles Torres VICE PRESIDENT
CHARLES TORRES VICE-PRESIDENT

ACKNOWLEDGEMENT STATE OF FLORIDA, COUNTY OF DADE

Before me personally appeared RALPH GILBERT and CHARLES TORRES to me well known and known to be the individuals described in and who executed the foregoing instrument as VICE PRESIDENT and VICE PRESIDENT of the CITY NATIONAL BANK OF FLORIDA Corporation, and severally acknowledged to and before me that they executed such instrument as such officers of said Corporation and that the seal affixed to the foregoing instrument is a Corporate seal of said Corporation and that it was affixed to said instrument by due and regular corporate authority, and that said instrument is the free act and deed of said Corporation. Witness my hand and official seal this 29 day of SEPTEMBER, 1988.

My commission expires: Bridget P. Johnston
Notary Public

This instrument was prepared by Kevin M. Cornnell in the offices of Walter A. Cornnell, Inc., 22 S.E. 4th Street, Boca Raton, Florida.

Notice: There may be additional restrictions that are not recorded on this plat that may be found in the Public Records of this county.

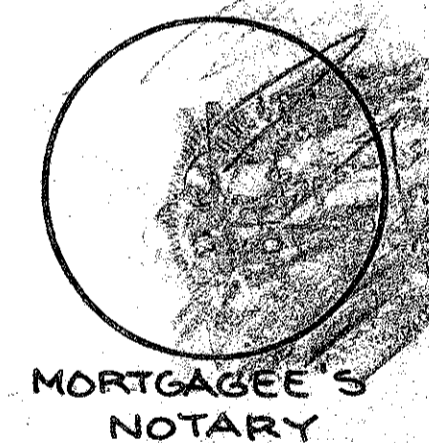
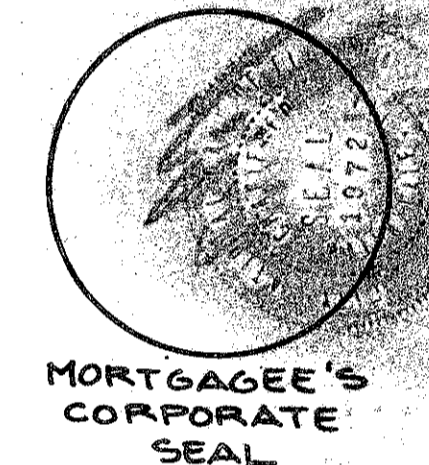
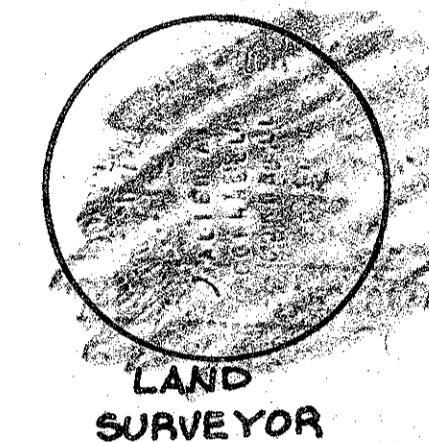

Pt. 84-152

0205-046

Boca Park 6/2/81

Handwritten notes on the left margin: Boca Park, 62, 39, 84-152, 20933, 702-691