

THE RICHARD AND CAROLE SIEMENS JEWISH CAMPUS

PART OF RAINBERRY PARK P.U.D.

SITUATE IN SECTION 19, TOWNSHIP 47 SOUTH, RANGE 42 EAST, PALM BEACH COUNTY, FLORIDA, BEING A REPLAT OF A PORTION OF BLOCK 78, OF THE PALM BEACH FARMS COMPANY PLAT NO. 3 (PB. 2, PGS. 45-54)

SHEET 3 OF 3

138

STATE OF FLORIDA
COUNTY OF PALM BEACH

THIS PLAT WAS FILED FOR RECORD
THIS _____ DAY OF _____
AD, 1989 AND DULY RECORDED
IN PLAT BOOK _____ ON PAGES
AND _____

JOHN B. DUNKLE, CLERK
BY: _____, D.C.

CIRCUIT COURT SEAL

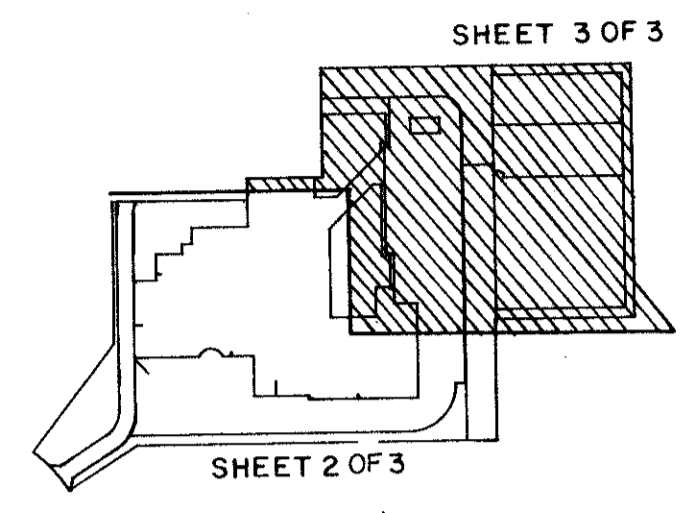

SHEET INDEX

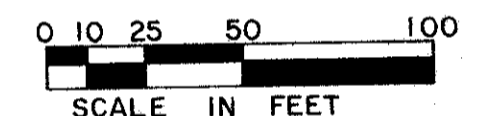
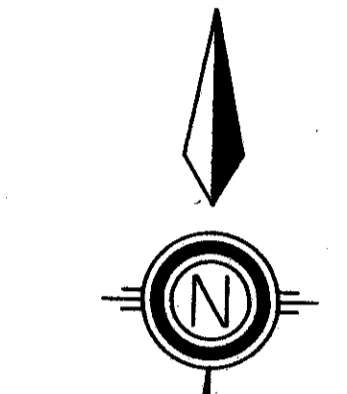

DETAIL "C"
N.T.S.

REPLAT OF BOCA LAGO
PB. 31, PGS. 62-71

DETAIL "F"
N.T.S.

Pet. 84-139

0560-003

STANLEY CONSULTANTS
OF FLORIDA, INC.
ENGINEERS • PLANNERS • SURVEYORS
2000 LOWHARD STREET, WEST PALM BEACH, FL 33407 (407) 842-7444

DRAWN	R. J. W.	DATE	JAN. 1989
CHECKED	R. B. P.	SCALE	1" = 50'
DRAWING NO.	09469PL		

THE RICHARD AND CAROLE SIEMENS JEWISH CAMPUS
RAINBERRY WEST, P.U.D.

64/138

Richard & Carol Siemens Jewish Campus
SUBDIVISION # of Rainberry Park
BOOK 64 PAGE 138
FLOOD ZONE A01 FLOOD MAP 2300
QUAD # 03 ZONING R.M.
SE 84-139 ZIP CODE 33434
PUD NAME Rainberry Park (PUD)
12/19/82

TAZ 783

