

BOCA CHASE 9A

A PORTION OF BOCA CHASE RIVIERA P. U. D.
BEING A PORTION OF THE NORTHEAST 1/4 OF SECTION 2,
TOWNSHIP 47 SOUTH, RANGE 41 EAST, PALM BEACH COUNTY, FLORIDA

PREPARED BY:
CARLTON / ROBAYNA INC.
ENGINEERS PLANNERS SURVEYORS
MARCH 1989 GRAPHIC SCALE SHEET 6 OF 6

SCALE: 1" = 40'

SHEET 4 of 6

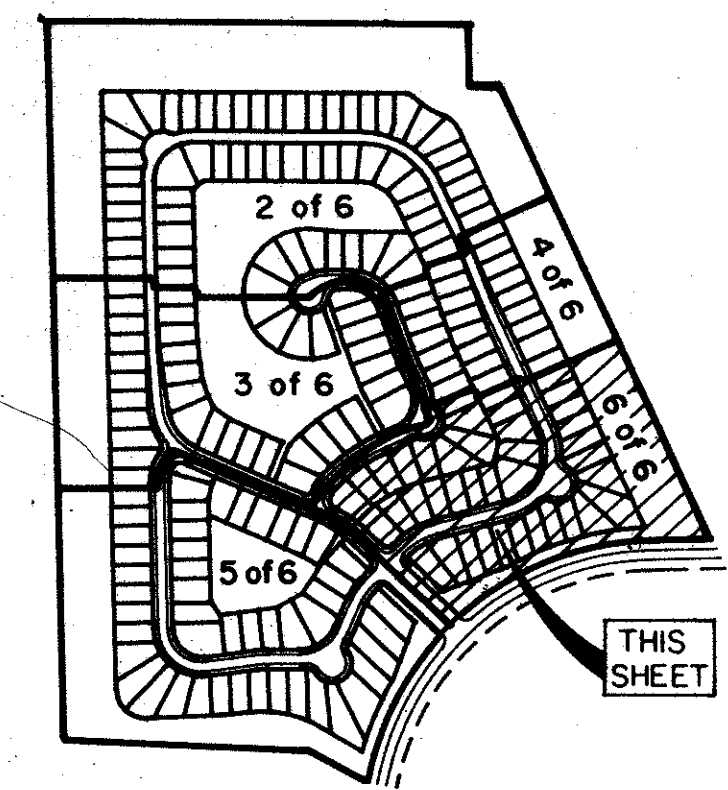

STATE OF FLORIDA
COUNTY OF PALM BEACH
THIS PLAT WAS FILED FOR
RECORD AT _____
THIS _____ DAY OF _____
A.D. 1990 AND DULY RECORDED
IN PLAT BOOK _____ ON PAGES
_____ AND _____
JOHN B. DUNKLE,
BY: _____ DC

