

THIS INSTRUMENT WAS PREPARED BY:
LONDON M. CROSS OF
CARNAHAN-PROCTOR AND ASSOCIATES, INC.
CONSULTING ENGINEERS
 SURVEYORS ENGINEERS PLANNERS
 6191 WEST ATLANTIC BLVD., MARGATE, FLORIDA 33063
 MARCH 1993 891202D JSH

(BABCOCK P.U.D.)
WATERWAYS AT DELRAY - PHASE IV

BEING A REPLAT OF A PORTION OF TRACTS 34, 35, 62, 63, AND 64 OF
 "PALM BEACH FARMS COMPANY PLAT NO. 1" (PLAT BOOK 2, PAGES 26-28,
 P.B.C.R.), LYING IN SECTION 20, TOWNSHIP 46 SOUTH, RANGE 42 EAST.

PALM BEACH COUNTY, FLORIDA

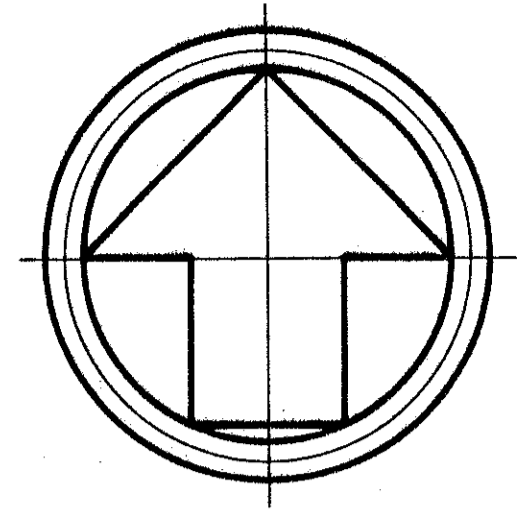

NORTHEAST CORNER
 SECTION 20-46-42

STATE OF FLORIDA
 COUNTY OF PALM BEACH
 THIS PLAT WAS FILED FOR
 RECORD AT _____ DAY OF _____
 A.D., 199____ AND DULY RECORDED
 IN PLAT BOOK _____ ON PAGES
 _____ THRU _____
 DOROTHY H. WILKEN, CLERK
 BY: _____ DC

LEGEND:

- DENOTES PERMANENT CONTROL POINT (P.C.P.)
- DENOTES PERMANENT REFERENCE MONUMENT P.L.S. NO 3348
- DENOTES ARC LENGTH
- DENOTES CENTER LINE
- DENOTES CENTRAL ANGLE (DELTA)
- DENOTES DRAINAGE EASEMENT
- DENOTES NON-RADIAL
- DENOTES OFFICIAL RECORD BOOK
- DENOTES PLAT BOOK
- DENOTES PALM BEACH COUNTY RECORDS
- DENOTES FOUND PERMANENT REFERENCE MONUMENT P.L.S. NO. 3348
- DENOTES POINT OF BEGINNING
- DENOTES PLANNED UNIT DEVELOPMENT
- DENOTES RADIUS
- DENOTES SQUARE FEET
- DENOTES UTILITY EASEMENT

