

THIS INSTRUMENT WAS PREPARED BY:
RICKIE C. WEINBERG OF
CARNAHAN-PROCTOR AND ASSOCIATES, INC.
CONSULTING ENGINEERS
 SURVEYORS ENGINEERS PLANNERS
 6191 WEST ATLANTIC BLVD., MARGATE, FLORIDA 33063
 AUGUST 1993 930601 JSH

WINDWARD PALM BEACH P.U.D.

PRINCETON PLACE AT GABLES END

A REPLAT OF ALL OF TRACTS "A", "L-1A", AND "W-3" OF THE PLAT ENTITLED "WINDWARD PALM BEACH PLAT FOUR" AS RECORDED IN PLAT BOOK 63 AT PAGES 172 THROUGH 174 OF THE PUBLIC RECORDS OF PALM BEACH COUNTY, FLORIDA.
PALM BEACH COUNTY, FLORIDA

0340-006

65

STATE OF FLORIDA
 COUNTY OF PALM BEACH
 THIS PLAT WAS FILED FOR
 RECORD AT
 THIS DAY OF
 A.D., 199 AND DULY RECORDED
 IN PLAT BOOK ON PAGES
 THROUGH
 DOROTHY H. WILKEN, CLERK
 BY: _____ DC

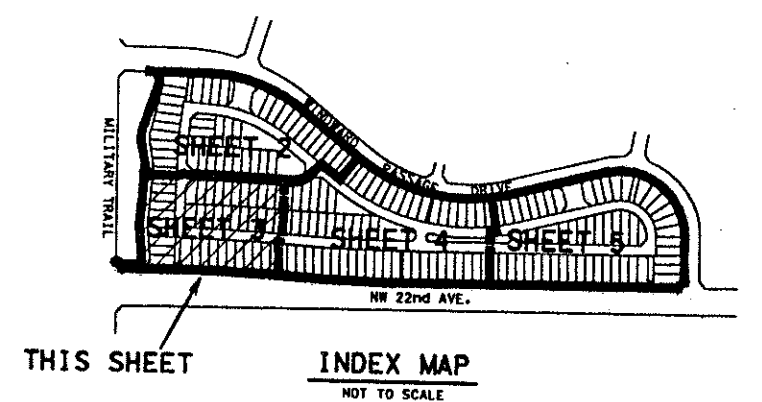

SHEET 3 OF 5 SHEETS

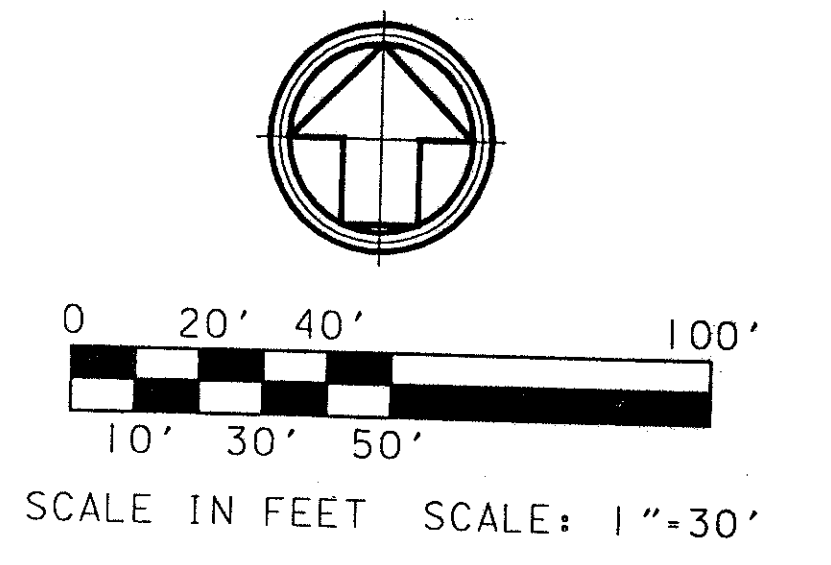

*PET. 78-225B
 ALLOC. #0001*

- LEGEND:**
- DENOTES SET PERMANENT REFERENCE MONUMENT P.L.S. NO. 5273 (UNLESS OTHERWISE INDICATED)
 - DENOTES PERMANENT CONTROL POINT
 - DENOTES CENTERLINE
 - DENOTES ARC LENGTH
 - DENOTES DELTA (CENTRAL ANGLE)
 - DENOTES DRAINAGE EASEMENT
 - DENOTES LIMITED ACCESS EASEMENT
 - DENOTES LAKE MAINTENANCE
 - DENOTES OFFICIAL RECORDS BOOK
 - DENOTES PALM BEACH COUNTY RECORDS
 - DENOTES PLAT BOOK
 - DENOTES PLANNED UNIT DEVELOPMENT
 - DENOTES RADIUS
 - DENOTES RADIAL
 - DENOTES ROOF ENCROACHMENT EASEMENT
 - DENOTES ROAD PLAT BOOK
 - DENOTES SQUARE FEET
 - DENOTES TYPICAL
 - DENOTES UTILITY EASEMENT



PRINCETON PLACE AT GABLES END
 PAGE 65
 FLOOD MAP #1993
 ZONING RS
 QUAD # 34
 78-225
 ZIP CODE 33476
 PUD NAME WINDWARD PALM BEACH

0340-006 72/05
PRINCETON PLACE AT GABLES END