

WINSTON TRAILS PARCEL 9 A

0587-010 SHEET 3 OF 4

184

LEGEND

- D.E. - DRAINAGE EASEMENT
- K/S - KEITH AND SCHNARS
- L - ARC LENGTH
- L.A.E. - LIMITED ACCESS EASEMENT
- L.M.A.E. - LAKE MAINTENANCE ACCESS EASEMENT
- L.M.E. - LAKE MAINTENANCE EASEMENT
- N.T.S. - NOT TO SCALE
- N.R. - NOT RADIAL
- O.R.B. - OFFICIAL RECORD BOOK
- P.M.E. - PRIVATE MAINTENANCE EASEMENT
- P.B. - PLAT BOOK
- P.B.C.R. - PALM BEACH COUNTY RECORDS
- P.C.P. - PERMANENT CONTROL POINT
- PG. - PAGE
- P.O.B. - POINT OF BEGINNING
- P.O.C. - POINT OF COMMENCEMENT
- P.L.S. - PROFESSIONAL LAND SURVEYOR
- R - RADIUS
- R/W - RIGHT-OF-WAY
- RGE. - RANGE
- SEC. - SECTION
- S.F. - SQUARE FEET
- TWP. - TOWNSHIP
- TYP. - TYPICAL
- U.E. - UTILITY EASEMENT
- A - CENTRAL ANGLE
- O.E. - OVERHANG EASEMENT

PART OF A P.U.D.
 BEING A REPLAT OF A PORTION OF 'WINSTON TRAILS PARCEL NINE' (P.B. 71, PG. 141-145, P.B.C.R.)
 LYING IN SECTION 3, TOWNSHIP 45 SOUTH, RANGE 42 EAST,
 PALM BEACH COUNTY, FLORIDA.

PREPARED BY:
 JON P. WEBER IN THE OFFICES OF
 KEITH AND SCHNARS, P.A.
 ENGINEERS - PLANNERS - SURVEYORS
 6500 NORTH ANDREWS AVENUE
 FORT LAUDERDALE, FLORIDA 33309
 (305) 776-1616
 OCTOBER 1993
 DWG. NO P2997U:4162UPL7.DGN

STATE OF FLORIDA
 COUNTY OF PALM BEACH
 THIS PLAT WAS FILED FOR RECORD
 AT M, THIS DAY
 OF 1993, AND DULY
 RECORDED IN PLAT BOOK NO.
 ON PAGES THRU
 DOROTHY H. WILKEN
 CLERK OF THE CIRCUIT COURT
 BY: D.C.

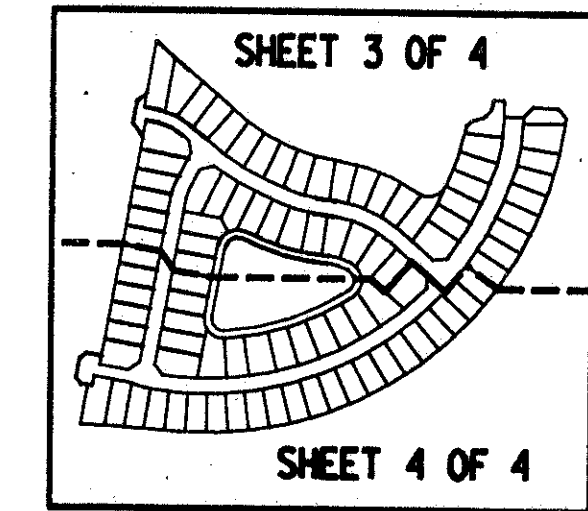
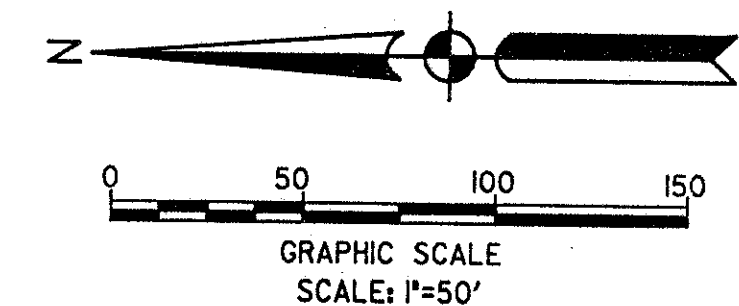

NOTICE

THERE MAY BE ADDITIONAL RESTRICTIONS THAT ARE NOT RECORDED ON THIS PLAT THAT MAY BE FOUND IN THE PUBLIC RECORDS OF THIS COUNTY.



*PET. 87-112C
 ALLOC. #0001
 5/2/2/I*

NOT SUBDIVIDED

0587-010

SUBDIVISION * Winston Trails Parcel 9A
 BOOK 73 PAGE 184
 FLOOD MAP # 170A
 QUAD # 34 ZONING RT3
 SE 87-112 ZIP CODE 33463.
 PUD NAME FORM
 TAZ-437

SEE SHEET 4 OF 4

WINSTON TRAILS PARCEL 9A 73/184