



IBIS GOLF AND COUNTRY CLUB PLAT NO. 14

A PLANNED UNIT DEVELOPMENT
LYING IN SECTIONS 13, 24 AND 25, TOWNSHIP 42 SOUTH, RANGE 41 EAST
CITY OF WEST PALM BEACH, PALM BEACH COUNTY, FLORIDA

107

LEGAL DESCRIPTION

A PARCEL OF LAND LYING IN SECTIONS 13, 24 AND 25, TOWNSHIP 42 SOUTH, RANGE 41 EAST, PALM BEACH COUNTY, FLORIDA AND BEING MORE PARTICULARLY DESCRIBED AS FOLLOWS:

ALL OF SECTION 24, TOWNSHIP 42 SOUTH, RANGE 41 EAST, LESS THE EAST 320.00 FEET THEREOF AND LESS THAT PORTION LYING WEST OF THE EAST LINE OF A BOUNDARY LINE AGREEMENT AS RECORDED IN OFFICIAL RECORDS BOOK 7208, PAGES 1740-1757, PUBLIC RECORDS OF PALM BEACH COUNTY, FLORIDA.

TOGETHER WITH THAT PORTION OF SECTION 13, TOWNSHIP 42 SOUTH, RANGE 41 EAST, LYING SOUTH OF THE SOUTH RIGHT-OF-WAY LINE OF NORTHLAKE BOULEVARD (LAKE PARK ROAD WEST) LESS THE EAST 320.00 FEET THEREOF, AND LESS THE ADDITIONAL RIGHT-OF-WAYS FOR NORTHLAKE BOULEVARD AS RECORDED IN OFFICIAL RECORD BOOK 6927, PAGES 379-383 AND OFFICIAL RECORD BOOK 5912, PAGE 122, PUBLIC RECORDS OF PALM BEACH COUNTY, FLORIDA, AND LESS THE WEST 40 FEET THEREOF FOR RIGHT-OF-WAY PURPOSES RECORDED IN OFFICIAL RECORD BOOK 1241, PAGE 200 AND LESS THE WEST 40 FEET OF THE WEST 120 FEET AS DESCRIBED IN OFFICIAL RECORD BOOK 5949, PAGES 1979-1985.

TOGETHER WITH THE FOLLOWING DESCRIBED PARCELS LYING IN SECTION 25, TOWNSHIP 42 SOUTH, RANGE 41 EAST, PALM BEACH COUNTY, FLORIDA:

COMMENCING AT THE NORTHEAST CORNER OF SAID SECTION 25; THENCE SOUTH 89°51'11" WEST ALONG THE NORTH LINE OF SAID SECTION 25; THENCE SOUTH 01°44'11" WEST, A DISTANCE OF 320.02 FEET TO THE POINT OF BEGINNING; THENCE SOUTH 01°44'11" WEST, A DISTANCE OF 58.15 FEET TO THE NORTH LINE OF IBIS GOLF & COUNTRY CLUB, PLAT NO. 7 AS RECORDED IN PLAT BOOK 67, PAGES 152-168; THENCE NORTH 88°15'48" WEST, A DISTANCE OF 49.99 FEET TO A POINT ON THE EAST LINE OF SANDHILL WAY EAST AS SHOWN ON IBIS GOLF & COUNTRY CLUB, PLAT NO. 1; THENCE NORTH 01°44'12" EAST ALONG SAID RIGHT-OF-WAY LINE, A DISTANCE OF 468.15 FEET TO A POINT ON THE NORTH LINE OF SAID SECTION 25 AND AT REFERENCE POINT "A"; THENCE NORTH 89°51'11" EAST, A DISTANCE OF 50.00 FEET TO THE POINT OF BEGINNING.

TOGETHER WITH:

COMMENCE AT REFERENCE POINT "A"; THENCE NORTH 89°51'11" EAST ALONG THE NORTH LINE OF SAID SECTION 25, A DISTANCE OF 487.34 TO A POINT ON THE WESTERLY LINE OF TRACT B, AS SHOWN ON SAID IBIS GOLF & COUNTRY CLUB, PLAT NO. 1 AND THE POINT OF BEGINNING; THENCE SOUTH 29°40'04" WEST ALONG SAID LINE, A DISTANCE OF 14.97; THENCE CONTINUE ALONG SAID LINE NORTH 88°32'44" WEST, A DISTANCE OF 247.52 FEET; THENCE NORTH 01°07'40" EAST, A DISTANCE OF 11.74 FEET TO THE NORTH LINE OF SAID SECTION 25; THENCE NORTH 89°51'11" EAST ALONG SAID NORTH LINE, A DISTANCE OF 254.67 FEET TO THE POINT OF BEGINNING.
ALSO, LESS AND EXCEPT THE FOLLOWING DESCRIBED PLATS LYING WITHIN SAID SECTIONS 13, 24 AND 25:

IBIS GOLF & COUNTRY CLUB PLAT NO. 1, AS RECORDED IN PLAT BOOK 66, PAGES 58-68; AND

IBIS GOLF & COUNTRY CLUB PLAT NO. 2, AS RECORDED IN PLAT BOOK 66, PAGES 72-79; AND

IBIS GOLF & COUNTRY CLUB PLAT NO. 3, AS RECORDED IN PLAT BOOK 66, PAGES 100-102; AND

IBIS GOLF & COUNTRY CLUB PLAT NO. 4, AS RECORDED IN PLAT BOOK 66, PAGES 80-82; AND

IBIS GOLF & COUNTRY CLUB PLAT NO. 5, AS RECORDED IN PLAT BOOK 66, PAGES 145-147; AND

IBIS GOLF & COUNTRY CLUB PLAT NO. 6, AS RECORDED IN PLAT BOOK 66, PAGES 142-144; AND

IBIS GOLF & COUNTRY CLUB PLAT NO. 10, AS RECORDED IN PLAT BOOK 72, PAGES 8-9; AND

IBIS GOLF & COUNTRY CLUB PLAT NO. 12, AS RECORDED IN PLAT BOOK 73, PAGES 170-171; AND

IBIS GOLF & COUNTRY CLUB PLAT NO. 15, AS RECORDED IN PLAT BOOK 73, PAGES 70-72; AND

ALSO, LESS AND EXCEPT THE FOLLOWING DESCRIBED PARCEL OF LAND:

COMMENCING AT THE NORTHEAST CORNER OF SAID SECTION 24; THENCE NORTH 88°43'31" WEST ALONG THE NORTH LINE OF SAID SECTION, A DISTANCE OF 320.01 FEET TO THE POINT OF BEGINNING AND A POINT ON A LINE 320 FEET WEST OF (AS MEASURED AT RIGHT ANGLES TO) AND PARALLEL WITH THE EAST LINE OF SAID SECTION 24; THENCE SOUTH 01°44'12" WEST ALONG SAID PARALLEL LINE, A DISTANCE OF 2402.98 FEET TO A POINT OF CURVE WITH A CURVE CONCAVE TO THE SOUTHWEST HAVING A RADIUS OF 1739.99 FEET; THENCE NORTHERLY ALONG THE ARC OF SAID CURVE THROUGH A CENTRAL ANGLE OF 33°37'43", A DISTANCE OF 1021.25 FEET; THENCE NORTH 31°53'31" WEST, A DISTANCE OF 1006.66 FEET TO THE POINT OF CURVATURE OF A CURVE CONCAVE TO THE NORTHEAST HAVING A RADIUS OF 1860.00 FEET; THENCE NORTHERLY ALONG THE ARC OF SAID CURVE THROUGH A CENTRAL ANGLE OF 22°25'00", A DISTANCE OF 727.71 FEET TO THE POINT OF TANGENCY; THENCE NORTH 09°28'31" WEST, A DISTANCE OF 508.63 TO A POINT ON THE SOUTH LINE OF ADDITIONAL RIGHT-OF-WAY LINE FOR NORTHLAKE BOULEVARD AS RECORDED IN OFFICIAL RECORD BOOK 5912, PAGE 122; THENCE SOUTH 88°43'31" EAST ALONG SAID LINE, A DISTANCE OF 1224.11 FEET TO A POINT ON A LINE 320.00 FEET WEST OF (AS MEASURED AT RIGHT ANGLES TO) AND PARALLEL WITH THE EAST LINE OF SAID SECTION 13; THENCE SOUTH 01°48'24" WEST, ALONG SAID PARALLEL LINE, A DISTANCE OF 574.99 FEET TO THE POINT OF BEGINNING.
CONTAINING 445.122 ACRES, MORE OR LESS.

DEDICATIONS AND RESERVATIONS

CITY OF WEST PALM BEACH
COUNTY OF PALM BEACH
STATE OF FLORIDA

KNOW ALL MEN BY THESE PRESENTS THAT, IBIS LANDING VENTURE, LTD., A FLORIDA LIMITED PARTNERSHIP, BY EASTERN HOLDING COMPANY, A FLORIDA CORPORATION, ITS MANAGING GENERAL PARTNER AND THE NORTHERN PALM BEACH COUNTY WATER CONTROL DISTRICT, A POLITICAL SUBDIVISION IN THE STATE OF FLORIDA, OWNERS OF THE LAND SHOWN HEREON AS:

IBIS GOLF AND COUNTRY CLUB PLAT NO. 14

HAVE CAUSED THE SAME TO BE SURVEYED AND PLATTED AS SHOWN HEREON AND DO HEREBY MAKE THE FOLLOWING DEDICATIONS AND RESERVATIONS:

1. COMMON AREAS, TRACTS "C", "D" AND "E"

THE COMMON AREAS, TRACTS "C", "D" AND "E", AS SHOWN HEREON ARE HEREBY DEDICATED TO THE IBIS PROPERTY OWNERS ASSOCIATION, INC., FOR OPEN SPACE, LANDSCAPING, AND FOR THE CONSTRUCTION AND MAINTENANCE OF UNDERGROUND UTILITIES AND DRAINAGE FACILITIES, AND ARE THE PERPETUAL MAINTENANCE OBLIGATION OF SAID ASSOCIATION, WITHOUT RECOURSE TO THE CITY OF WEST PALM BEACH AND WITHOUT RECOURSE TO THE NORTHERN PALM BEACH COUNTY WATER CONTROL DISTRICT.

2. TRACTS "A", "B", "CC", "F", "J", "JJ", "KK", AND "MM", AS SHOWN HEREON ARE HEREBY DEDICATED AND RESERVED FOR THE PURPOSE OF FUTURE DEVELOPMENT.

3. A WATER MANAGEMENT EASEMENT OVER ALL OF TRACTS A, B, C, D, E AS SHOWN HEREON, IS HEREBY DEDICATED TO THE NORTHERN PALM BEACH COUNTY WATER CONTROL DISTRICT FOR INGRESS AND EGRESS, CONSTRUCTION, OPERATION AND MAINTENANCE OF SAID DISTRICT'S WATER MANAGEMENT FACILITIES. THE LAND LYING UNDER SAID WATER MANAGEMENT EASEMENT BEING THE PERPETUAL MAINTENANCE RESPONSIBILITY OF THE OWNER OR OWNERS OF SAID TRACTS, THEIR SUCCESSORS AND/OR ASSIGNS WITHOUT RECOURSE TO SAID DISTRICT.

IN WITNESS WHEREOF, EASTERN HOLDING COMPANY, A FLORIDA CORPORATION, AS MANAGING GENERAL PARTNER OF IBIS LANDING VENTURE, LTD., A FLORIDA LIMITED PARTNERSHIP, HAS CAUSED THESE PRESENTS TO BE SIGNED BY ITS CHAIRMAN AND ATTESTED TO BY ITS SECRETARY AND ITS CORPORATION SEAL TO BE AFFIXED HERETO WITH AUTHORITY OF ITS BOARD OF DIRECTORS THIS 30th DAY OF JUNE, 1995.

IBIS LANDING VENTURE, LTD., A FLORIDA LIMITED PARTNERSHIP
BY: EASTERN HOLDING COMPANY, A FLORIDA CORPORATION
ITS MANAGING GENERAL PARTNER

BY: E. Llywd Ecclestone, Jr. ATTEST: Helena Leyendecker
E. LLYWD ECCLESTONE, JR., CHAIRMAN HELENA LEYENDECKER, SECRETARY

IN WITNESS WHEREOF, NORTHERN PALM BEACH COUNTY WATER CONTROL DISTRICT, HAS CAUSED THESE PRESENTS TO BE SIGNED BY ITS PRESIDENT AND ATTESTED TO BY ITS SECRETARY AND ITS DISTRICT SEAL TO BE AFFIXED HERETO WITH THE AUTHORITY OF ITS BOARD OF SUPERVISORS THIS 30th DAY OF JUNE, 1995.

BY: NORTHERN PALM BEACH COUNTY WATER CONTROL DISTRICT
A POLITICAL SUBDIVISION IN THE STATE OF FLORIDA

BY: William L. Kerslake ATTEST: O'Neal Bardin, Jr.
WILLIAM L. KERSLAKE, PRESIDENT O'NEAL BARDIN, JR., ASST. SECRETARY

ACKNOWLEDGEMENT

STATE OF FLORIDA
COUNTY OF PALM BEACH

BEFORE ME PERSONALLY APPEARED E. LLYWD ECCLESTONE, JR., AND HELENA LEYENDECKER, TO ME PERSONALLY KNOWN AND KNOWN TO ME TO BE THE INDIVIDUALS DESCRIBED IN AND WHO EXECUTED THE FOREGOING INSTRUMENT AS CHAIRMAN AND SECRETARY, RESPECTIVELY OF THE ABOVE NAMED EASTERN HOLDING COMPANY, A FLORIDA CORPORATION, AS MANAGING GENERAL PARTNER OF IBIS LANDING VENTURE, LTD.; THEY DID NOT TAKE AN OATH; AND THEY SEVERALLY ACKNOWLEDGED TO AND BEFORE ME THAT THEY EXECUTED SAID INSTRUMENT AS SUCH OFFICERS OF SAID CORPORATION AND THAT THE SEAL AFFIXED TO THE FOREGOING INSTRUMENT IS THE CORPORATE SEAL OF SAID CORPORATION AND THAT IT WAS AFFIXED TO SAID INSTRUMENT BY DUE AND REGULAR CORPORATE AUTHORITY AND THAT SAID INSTRUMENT IS THE FREE ACT AND DEED OF SAID CORPORATION ON BEHALF OF THE LIMITED PARTNERSHIP.

I WITNESS MY HAND AND OFFICIAL SEAL THIS 14th DAY OF JUNE, 1995.

COMMISSION NUMBER: CC326734
NOTARY PUBLIC
FRANK S. PALEN
PRINT NAME

JUNE, 1995

ACKNOWLEDGEMENT

STATE OF FLORIDA
COUNTY OF PALM BEACH

BEFORE ME PERSONALLY APPEARED WILLIAM L. KERSLAKE, AND O'NEAL BARDIN, JR. TO ME PERSONALLY KNOWN AND KNOWN TO ME TO BE THE INDIVIDUALS DESCRIBED IN AND WHO EXECUTED THE FOREGOING INSTRUMENT AS PRESIDENT AND ASST. SECRETARY RESPECTIVELY OF THE ABOVE NAMED BOARD OF SUPERVISORS OF THE NORTHERN PALM BEACH COUNTY WATER CONTROL DISTRICT; THEY DID NOT TAKE AN OATH; AND THEY SEPARATELY ACKNOWLEDGED TO AND BEFORE ME THAT THEY EXECUTED SAID INSTRUMENT AS SUCH OFFICERS OF SAID DISTRICT AND THAT THE SEAL AFFIXED TO THE FOREGOING INSTRUMENT IS THE SEAL OF SAID DISTRICT AND THAT IT WAS AFFIXED TO SAID INSTRUMENT BY DUE AND REGULAR AUTHORITY OF ITS BOARD OF SUPERVISORS AND THAT SAID INSTRUMENT IS THE FREE ACT AND DEED OF SAID DISTRICT.

WITNESS MY HAND AND OFFICIAL SEAL THIS 30th DAY OF JUNE, 1995.

COMMISSION NUMBER: _____
PRINT NAME: Roberta Anne MacLeod
ROBERTA ANNE MACLEOD
My Comm. Exp. 6/22/99
Bonded By Service Inc.
No. CC459762
Notary Public - State of Florida

MORTGAGEE'S CONSENT

STATE OF MICHIGAN
COUNTY OF OAKLAND

THE UNDERSIGNED HEREBY CERTIFIES THAT IT IS THE HOLDER OF A MORTGAGE UPON THE PROPERTY DESCRIBED HEREON; THAT IT DOES HEREBY JOIN IN AND CONSENT TO THE DEDICATION OF THE LANDS DESCRIBED HEREON, BY THE OWNER THEREOF, AND AGREES THAT ITS MORTGAGE, WHICH IS RECORDED IN THE OFFICIAL RECORD BOOK 5943, AT PAGE 1693, AS AMENDED, AND OFFICIAL RECORD BOOK 6143, PAGE 1874, AS AMENDED, OF THE PUBLIC RECORDS OF PALM BEACH COUNTY, FLORIDA SHALL BE SUBORDINATED TO THE DEDICATIONS SHOWN HEREON.

MICHIGAN NATIONAL BANK, A NATIONAL BANKING ASSOCIATION.

BY: Jerome Henson ATTEST: Irvin Kebler
JEROME HENSON, VICE PRESIDENT IRVIN KEBLER, VICE-PRESIDENT

ACKNOWLEDGEMENT

STATE OF MICHIGAN
COUNTY OF OAKLAND

BEFORE ME PERSONALLY APPEARED JEROME HENSON AND IRVIN KEBLER TO ME PERSONALLY KNOWN AND KNOWN TO ME TO BE THE INDIVIDUALS DESCRIBED IN AND WHO EXECUTED THE FOREGOING INSTRUMENT AS VICE PRESIDENT AND VICE PRESIDENT, RESPECTIVELY, OF MICHIGAN NATIONAL BANK, A NATIONAL BANKING ASSOCIATION; THEY DID NOT TAKE AN OATH; AND THAT THE SEAL AFFIXED TO THE FOREGOING INSTRUMENT IS THE CORPORATE SEAL OF SAID ASSOCIATION AND THAT IT WAS AFFIXED TO SAID INSTRUMENT BY DUE AND REGULAR CORPORATE AUTHORITY, AND THAT SAID INSTRUMENT IS THE FREE ACT AND DEED OF SAID ASSOCIATION.

WITNESS MY HAND AND OFFICIAL SEAL THIS 29th DAY OF JUNE, 1995.

COMMISSION NUMBER: _____
PRINT NAME: Tonya McCreary
TONYA MCCREARY
Notary Public - Oklahoma County, OK
My Comm. Expires July 24, 1998

TITLE CERTIFICATION

STATE OF FLORIDA
COUNTY OF PALM BEACH

WE, STEWART TITLE OF PALM BEACH COUNTY, A TITLE INSURANCE COMPANY, DULY LICENSED IN THE STATE OF FLORIDA DO HEREBY CERTIFY THAT WE HAVE EXAMINED THE TITLE TO THE HEREON DESCRIBED PROPERTY; THAT WE FIND THE TITLE TO THE PROPERTY IS VESTED IN IBIS LANDING VENTURE, A FLORIDA LIMITED PARTNERSHIP AND IN THE NORTHERN PALM BEACH COUNTY WATER CONTROL DISTRICT, A POLITICAL SUBDIVISION IN THE STATE OF FLORIDA; THAT THE CURRENT TAXES HAVE BEEN PAID THROUGH 1994; THAT ALL MORTGAGES NOT SATISFIED OR RELEASED OF RECORD NOR OTHERWISE TERMINATED BY LAW ARE SHOWN HEREON; AND THAT THERE ARE ENCUMBRANCES OF RECORD, BUT THOSE ENCUMBRANCES DO NOT PROHIBIT THE CREATION OF THE SUBDIVISION DEPICTED BY THIS PLAT.

STEWART TITLE OF PALM BEACH COUNTY
BY: Kenneth L. Townsend
KENNETH L. TOWNSEND
PRESIDENT
STEWART TITLE OF PALM BEACH COUNTY
1555 PALM BEACH LAKES BLVD.
SUITE 100
WEST PALM BEACH, FLORIDA 33401

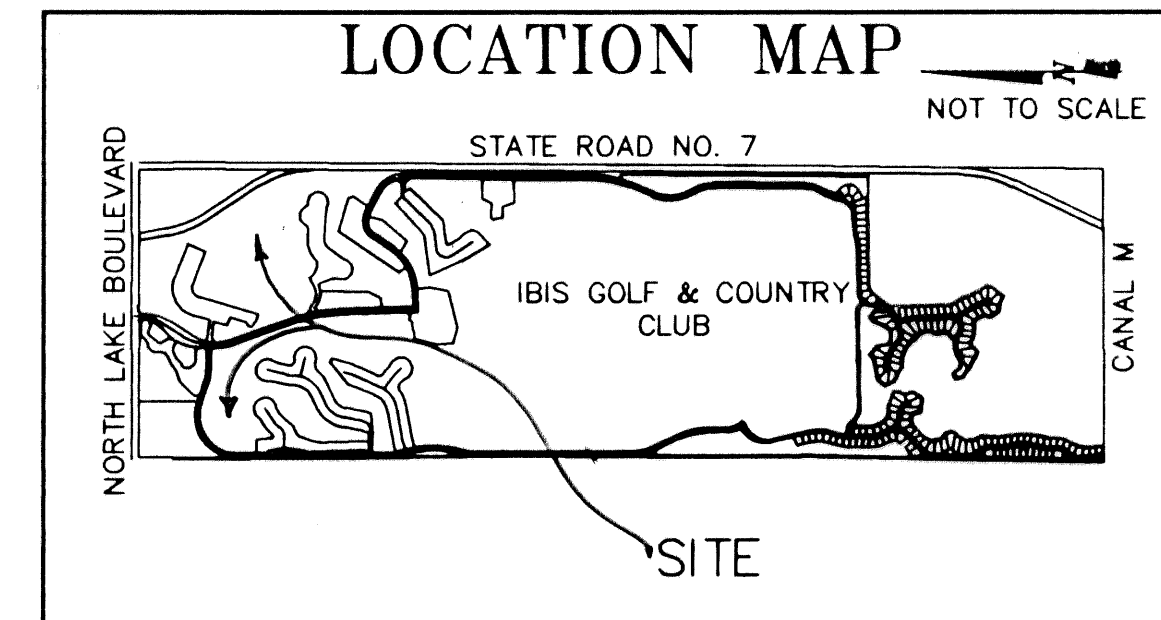

COUNTY OF PALM BEACH) ss
STATE OF FLORIDA)
This Plat was filed for record at 9:54 A.M.
this 21st day of July 1995
and duly recorded in Plat Book No. 75
on page 107-117
DOROTHY H. WILKEN, Clerk of Circuit Court
by Roberta Anne MacLeod D.C.

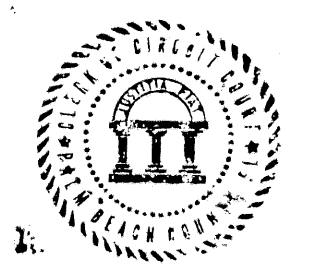

NORTHERN PALM BEACH COUNTY WATER CONTROL DISTRICT ACCEPTANCE

STATE OF FLORIDA
COUNTY OF PALM BEACH

THE NORTHERN PALM BEACH COUNTY WATER CONTROL DISTRICT HEREBY ACKNOWLEDGES THE PERPETUAL MAINTENANCE OBLIGATION OF THE EXISTING WATER MANAGEMENT EASEMENTS AND LAKES SHOWN HEREON AND RECORDED IN OFFICIAL RECORD BOOK 7641 AT PAGES 470 THROUGH 740, INCLUSIVE, OF SAID PUBLIC RECORDS, AND HEREBY ACCEPTS THE INGRESS AND EGRESS, CONSTRUCTION, OPERATION AND MAINTENANCE OF SAID DISTRICT'S WATER MANAGEMENT FACILITIES WITHIN TRACTS A, B, C, D AND E, AND HEREBY ACKNOWLEDGES SAID DISTRICT HAS NO MAINTENANCE OBLIGATIONS ON OR UNDER THE LANDS INCLUDED IN SAID TRACTS A, B, C, D AND E.

NORTHERN PALM BEACH COUNTY WATER CONTROL DISTRICT
DATE: 6/30/95 BY: William L. Kerslake
WILLIAM L. KERSLAKE, PRESIDENT
BOARD OF SUPERVISORS

ATTEST:
O'Neal Bardin, Jr.
O'NEAL BARDIN, JR., ASST. SECRETARY
BOARD OF SUPERVISORS
(AS OF JUNE 20, 1995 NORTHERN PALM BEACH COUNTY WATER CONTROL DISTRICT IS KNOWN AS NORTHERN PALM BEACH COUNTY IMPROVEMENT DISTRICT.)

SURVEYOR'S CERTIFICATE

STATE OF FLORIDA
COUNTY OF PALM BEACH

I HEREBY CERTIFY THAT THE PLAT SHOWN HEREON IS A TRUE AND CORRECT REPRESENTATION OF A SURVEY MADE UNDER MY RESPONSIBLE DIRECTION AND SUPERVISION AND THAT SAID SURVEY IS ACCURATE TO THE BEST OF MY KNOWLEDGE AND BELIEF; THAT PERMANENT REFERENCE MONUMENTS (P.R.M.'S) HAVE BEEN PLACED AS REQUIRED BY LAW AND FURTHER THAT THE SURVEY DATA COMPLIES WITH ALL THE REQUIREMENTS OF CHAPTER 177 FLORIDA STATUTES, AS AMENDED, AND ORDINANCES OF THE CITY OF WEST PALM BEACH, FLORIDA.

Thomas C. Vokoun
THOMAS C. VOKOUN
REGISTERED SURVEYOR NO. 4382
STATE OF FLORIDA

APPROVALS

CITY OF WEST PALM BEACH
COUNTY OF PALM BEACH
STATE OF FLORIDA

THE PLAT, AS SHOWN HEREON, HAS BEEN APPROVED BY THE CITY COMMISSION OF THE CITY OF WEST PALM BEACH, FLORIDA, AND THE CITY DOES HEREBY FORMALLY ACCEPT THE OFFERS TO DEDICATE, CONTAINED ON THIS PLAT THIS 19th DAY OF JUNE, 1995.

BY: Nancy M. Graham
NANCY M. GRAHAM, MAYOR

APPROVED: 7/18/95 1995
CITY PLANNING BOARD

BY: William M. Moss
WILLIAM M. MOSS, CHAIRMAN

NOTES:
1.) THERE MAY BE ADDITIONAL RESTRICTIONS THAT ARE NOT RECORDED ON THIS PLAT THAT MAY BE FOUND IN THE PUBLIC RECORDS OF PALM BEACH COUNTY.
2.) THERE SHALL BE NO BUILDINGS, STRUCTURES, CONSTRUCTION OF ANY KIND, TREES OR SHRUBS PLACED ON WATER MANAGEMENT EASEMENTS DEDICATED AND/OR SHOWN HEREON, UNLESS APPROVED IN WRITTEN PERMIT FORM, BY THE NORTHERN PALM BEACH COUNTY WATER CONTROL DISTRICT.

SUBDIVISION: IBIS Golf and Country Club Plat 14
BOOK: 75
PAGE: 107
FLOOD MAP: _____
ZONING: _____
ZIP CODE: _____
SE: _____
PUD NAME: West Palm Beach (1985/14/14)

THIS PLAT PREPARED BY:
THOMAS C. VOKOUN, P.L.S.
FOR:
LINDAHL, BROWNING, FERRARI & HELLSTROM, INC.

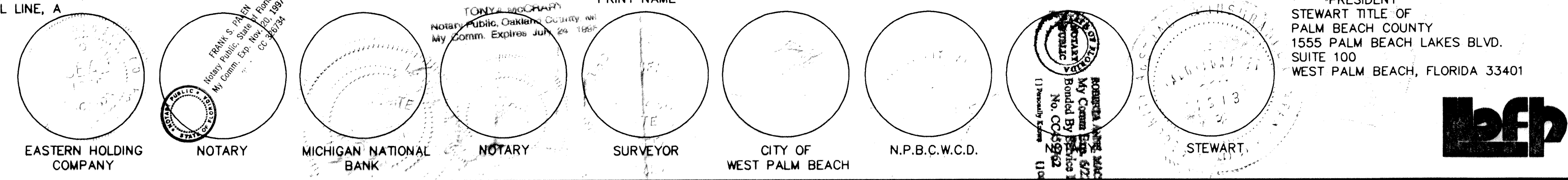

LINDAHL, BROWNING, FERRARI, & HELLSTROM, INC.
CONSULTING ENGINEERS, PLANNERS & SURVEYORS
210 JUPITER LAKES BLVD. SUITE 200 FT. PIERCE, FL. 34996 407-746-9248
2400 SE. MONTEREY ROAD SUITE 200 FT. PIERCE, FL. 34996 407-286-3883
2222 COLONIAL ROAD SUITE 702 WEST PALM BEACH, FL. 33409 407-461-2450
2000 PALM BEACH LAKES BLVD. SUITE 702 WEST PALM BEACH, FL. 33409 407-684-3375