

PINE CREST BOCA RATON CAMPUS IN PART OF SECTION 14, TOWNSHIP 47 SOUTH, RANGE 42 EAST CITY OF BOCA RATON, PALM BEACH COUNTY, FLORIDA

SHEET NO. 1 OF 2

PREPARED BY: MICHAEL G. PURMORT, P.L.S.
MICHAEL G. PURMORT & ASSOCIATES, INC.
843 S.E. 8TH AVENUE
DEERFIELD BEACH, FLORIDA 33441
AUGUST 1995

STATE OF FLORIDA
COUNTY OF PALM
THIS PLAT WAS FILED FOR
RECORD AT 11:21 AM THIS 13TH DAY
OF SEP 1995, AND DULY
RECORDED IN PLAT BOOK 75
ON PAGES 167 THRU 168
DOROTHY H. WILKEN
CLERK CIRCUIT COURT
BY Dawn Amato D.C.

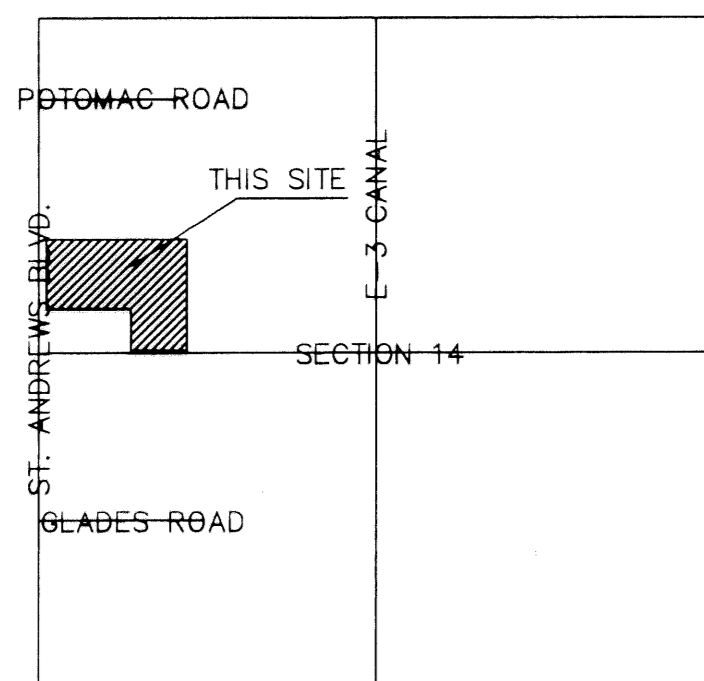

NOT TO SCALE

DESCRIPTION

PARCEL ONE
A PARCEL OF LAND IN THE SOUTHWEST QUARTER (S.W. 1/4) OF THE NORTHWEST QUARTER (N.W. 1/4) OF SECTION 14, TOWNSHIP 47 SOUTH, RANGE 42 EAST, DESCRIBED AS FOLLOWS:
COMMENCING AT THE WEST QUARTER CORNER OF SECTION 14 IN TOWNSHIP 47 SOUTH, RANGE 42 EAST, THENCE N. 00°53'00" E., ON THE WEST SECTION LINE, A DISTANCE OF 20.00 FEET TO A POINT; THENCE S. 89°20'04" E., A DISTANCE OF 60.00 FEET TO A POINT WHICH IS THE INTERSECTION OF THE EAST RIGHT-OF-WAY LINE OF MERIDIAN TRAIL (AKA ST. ANDREWS BLVD.) AND THE NORTH RIGHT-OF-WAY LINE OF LATERAL CANAL L-45, THENCE N. 00°53'00" E., A DISTANCE OF 330.00 FEET TO A POINT, SAID POINT BEING THE POINT OF BEGINNING; THENCE CONTINUE ALONG THE AFOREMENTIONED COURSE A DISTANCE OF 660.00 FEET TO A POINT; THENCE S. 89°20'04" E., A DISTANCE OF 660.00 FEET TO A POINT; THENCE S. 00°53'00" W., A DISTANCE OF 660.00 FEET TO A POINT; THENCE N. 89°20'04" W., A DISTANCE OF 660.00 FEET, MORE OR LESS TO THE POINT OF BEGINNING.

TOGETHER WITH:

PARCEL TWO
A PARCEL OF LAND IN THE SOUTHWEST QUARTER (S.W. 1/4) OF THE NORTHWEST QUARTER (N.W. 1/4) OF SECTION 14, TOWNSHIP 47 SOUTH, RANGE 42 EAST, BEING THE EAST 440.00 FEET OF THE WEST 1160.00 FEET OF THE NORTH 990.00 FEET OF THE SOUTH 1010.00 FEET OF THE NORTHWEST QUARTER (N.W. 1/4) OF SECTION 14, TOWNSHIP 47 SOUTH, RANGE 42 EAST, OF PALM BEACH COUNTY, FLORIDA.

CONTAINING 20.00 ACRES MORE OR LESS AND SUBJECT TO EASEMENTS, RESERVATIONS AND RIGHTS-OF-WAY OF RECORD.

DEDICATION

KNOW ALL MEN BY THESE PRESENTS, THAT PINE CREST PREPARATORY SCHOOL, INC., A FLORIDA CORPORATION, THE OWNERS OF THE LAND SHOWN HEREON, DESCRIBED UNDER DESCRIPTION, TO BE KNOWN AS PINE CREST BOCA RATON CAMPUS, BEING A PORTION OF SECTION 14, TOWNSHIP 47 SOUTH, RANGE 42 EAST, CITY OF BOCA RATON, PALM BEACH COUNTY, FLORIDA, HAS CAUSED THE SAME TO BE SURVEYED AND PLATTED AS SHOWN AND DO HEREBY DEDICATE AS FOLLOWS:

1. PARCEL A, AS SHOWN, IS HEREBY RESERVED TO PINE CREST PREPARATORY SCHOOL, INC., FOR EDUCATIONAL PURPOSES.
2. THE UTILITY EASEMENTS, AS SHOWN, ARE HEREBY DEDICATED IN PERPETUITY FOR THE CONSTRUCTION, INSTALLATION, MAINTENANCE AND OPERATION OF UTILITY FACILITIES, INCLUDING CABLE TELEVISION SYSTEMS. THE INSTALLATION OF CABLE TELEVISION SYSTEMS SHALL NOT INTERFERE WITH THE CONSTRUCTION, INSTALLATION, MAINTENANCE AND OPERATION OF OTHER UTILITIES. SUCH CONSTRUCTION, INSTALLATION, MAINTENANCE AND OPERATION SHALL COMPLY WITH THE NATIONAL ELECTRICAL SAFETY CODE AS ADOPTED BY THE FLORIDA PUBLIC SERVICE COMMISSION.
3. THE NON-ACCESS LINE, AS SHOWN, IS HEREBY DEDICATED TO THE CITY OF BOCA RATON, FLORIDA FOR THE PURPOSE OF CONTROL AND JURISDICTION OVER ACCESS RIGHTS.

IN WITNESS WHEREOF, THE SAID CORPORATION HAS CAUSED THESE PRESENTS TO BE SIGNED BY ITS PRESIDENT AND SENIOR VICE PRESIDENT THIS 17TH DAY OF AUGUST 1995.

PINE CREST PREPARATORY SCHOOL, INC.

WITNESS: Nancy H. Groh AS TO BOTH BY: William J. McMillan
PRINT: NANCY H. GROH WILLIAM J. McMILLAN, PRESIDENT
WITNESS: Sonia Conradi AS TO BOTH BY: Kenneth M. Kone
PRINT: Sonia Conradi KENNETH M. KONE, SENIOR VICE PRESIDENT

ACKNOWLEDGEMENT

STATE OF FLORIDA }
COUNTY OF BROWARD }SS

BEFORE ME PERSONALLY APPEARED WILLIAM J. McMILLAN AND KENNETH M. KONE, WHO ARE PERSONALLY KNOWN TO ME, OR HAVE PRODUCED _____ AS IDENTIFICATION, AND WHO EXECUTED THE FOREGOING INSTRUMENT AS PRESIDENT AND SENIOR VICE PRESIDENT OF PINE CREST PREPARATORY SCHOOL, INC. A FLORIDA CORPORATION, AND SEVERALLY ACKNOWLEDGED TO AND BEFORE ME THAT THEY EXECUTED SUCH INSTRUMENT AS SUCH OFFICERS OF SAID CORPORATION, AND THAT THE SEAL AFFIXED TO THE FOREGOING INSTRUMENT IS THE CORPORATE SEAL OF SAID CORPORATION AND THAT IT WAS AFFIXED TO SAID INSTRUMENT BY DUE AND REGULAR CORPORATE AUTHORITY, AND THAT SAID INSTRUMENT IS THE FREE ACT AND DEED OF SAID CORPORATION.

WITNESS MY HAND AND OFFICIAL SEAL THIS 17TH DAY OF August, 1995

MY COMMISSION EXPIRES: April 28, 1997 Betty Jane Hanrahan
NOTARY PUBLIC
PRINT: BETTY JANE HANRAHAN

LAND USE

EDUCATIONAL PARCEL (A)-----20.00 ACRES

NOTES

- PERMANENT REFERENCE MONUMENT (#2720)
- PERMANENT CONTROL POINT (P.C.P.)
- P.O.B. --- POINT OF BEGINNING
- P.O.C. --- POINT OF COMMENCEMENT
- C/L --- CENTERLINE
- P.B. --- PLAT BOOK
- O.R.B. --- OFFICIAL RECORD BOOK
- PG. --- PAGE
- S.F. --- SQUARE FEET
- NON ACCESS LINE

ALL BEARINGS SHOWN HEREON ARE RELATIVE TO THE WEST LINE OF THE N.W. 1/4 OF SECTION 14 WHICH IS ASSUMED TO BEAR N. 00°53'00" E.

BUILDING SETBACK LINES SHALL BE AS REQUIRED BY CITY OF BOCA RATON ZONING REGULATIONS.

NO BUILDINGS OR ANY KIND OF CONSTRUCTION SHALL BE PLACED ON UTILITY, DRAINAGE, OR WATER AND SEWER EASEMENTS WITHOUT CITY OF BOCA RATON APPROVAL. "BUILDING CONSTRUCTION" DOES NOT INCLUDE ENTRY DRIVES, PARKING AREAS, AND VEHICULAR AND PEDESTRIAN CIRCULATION AREAS.

LANDSCAPING ON UTILITY EASEMENTS SHALL ONLY BE WITH THE APPROVAL OF ALL UTILITIES HAVING THE RIGHT TO OCCUPY THE SAME.

EASEMENTS ARE FOR PUBLIC UTILITIES, UNLESS OTHERWISE NOTED. (SEE NOTE 2 IN DEDICATION)

WHERE UTILITY AND DRAINAGE EASEMENTS CROSS, DRAINAGE EASEMENTS TAKE PRECEDENCE.

DIMENSIONS SHOWN HEREON ARE IN FEET AND DECIMAL PARTS THEREOF AND ARE BASED ON THE DEFINITION OF A FOOT AS ADOPTED BY THE UNITED STATES BUREAU OF STANDARDS AND REFER TO THE HORIZONTAL PLANE.

NOTICE: THERE MAY BE ADDITIONAL RESTRICTIONS THAT ARE NOT RECORDED ON THIS PLAT THAT MAY BE FOUND IN THE PUBLIC RECORDS OF THIS COUNTY.

APPROVALS

THIS IS TO CERTIFY THAT THIS PLAT HAS BEEN ACCEPTED AND APPROVED FOR RECORD BY THE CITY COUNCIL OF THE CITY OF BOCA RATON, FLORIDA, IN AND BY RESOLUTION DULY ADOPTED BY SAID CITY COUNCIL, ON 22ND DAY OF AUGUST, 1995.

BY: Carol G. Hanson
CAROL G. HANSON, MAYOR
BY: Sandra M. McGinn
SANDRA M. MCGINN, DIRECTOR OF DEVELOPMENT SERVICES
BY: Candace Bridgewater
CANDACE BRIDGWATER, CITY CLERK
BY: James M. Chansler
JAMES M. CHANSLER, P.E., ACTING CITY CIVIL ENGINEER

TITLE CERTIFICATION

STATE OF FLORIDA }
COUNTY OF BROWARD }SS

THE UNDERSIGNED ATTORNEY DULY LICENSED IN THE STATE OF FLORIDA DOES HEREBY CERTIFY THAT WE HAVE EXAMINED THE TITLE TO THE HEREON DESCRIBED PROPERTY; THAT WE FIND THE TITLE TO THE PROPERTY IS VESTED TO PINE CREST PREPARATORY SCHOOL, INC. A FLORIDA CORPORATION; THAT THE CURRENT TAXES HAVE BEEN PAID AND THAT THERE ARE NO ENCUMBRANCES OF RECORD OTHER THAN STATED HEREIN.

PROSKAUER ROSE GOETZ & MENDELSON LLP
Christopher C. Wheeler
CHRISTOPHER C. WHEELER

August 17, 1995
DATE

SURVEYOR'S CERTIFICATION

THIS IS TO CERTIFY THAT THE PLAT SHOWN HEREON IS A TRUE AND CORRECT REPRESENTATION OF A SURVEY MADE UNDER MY RESPONSIBLE DIRECTION AND SUPERVISION; THAT SAID SURVEY IS ACCURATE TO THE BEST OF MY KNOWLEDGE AND BELIEF; THAT PERMANENT REFERENCE MONUMENTS (P.R.M.S) HAVE BEEN PLACED AS REQUIRED BY LAW AND THAT PERMANENT CONTROL POINTS (P.C.P.S) WILL BE SET UNDER THE GUARANTEES POSTED WITH THE CITY OF BOCA RATON, FLORIDA FOR THE REQUIRED IMPROVEMENTS, AND, FURTHER, THAT THE SURVEY DATA COMPLIES WITH THE REQUIREMENTS OF CHAPTER 177 PART I, FLORIDA STATUTES, AS AMENDED, AND THE ORDINANCES OF THE CITY OF BOCA RATON, FLORIDA.

STATE OF FLORIDA }
Michael G. Purmort
MICHAEL G. PURMORT, P.L.S.
LICENSE NO. 2720

SUBDIVISION *Pine Crest Boca Raton
Campus
BOOK 75 PAGE 167
FLOOD MAP *
QUAD * ZONING
SE ZIP CODE
PUD NAME C/Boca Raton 4/47/42

