

JONES - PARCEL "A"

BEING A REPLAT OF PARCEL "A", JONES P.U.D. AS RECORDED IN PLAT BOOK 78, PAGES 71 THROUGH 78 OF THE PUBLIC RECORDS OF PALM BEACH COUNTY, FLORIDA SITUATE IN SECTIONS 33 AND 34, TOWNSHIP 45 SOUTH, RANGE 42 EAST, PALM BEACH COUNTY, FLORIDA

SHEET 6 OF 7

AUGUST, 1997

0683-006

25

*Pct. 95-19
AWAC #0001
NO SCHOOLS-
RESTRICTIVE
COVENANT
5/3/3/K*

STATE OF FLORIDA
COUNTY OF PALM BEACH } SS
THIS PLAT WAS FILED FOR
RECORD AT _____ DAY OF
_____, 1997 AND
DULY RECORDED IN PLAT BOOK
_____, ON PAGES ____ AND

DOROTHY H. WILKEN, CLERK
CIRCUIT COURT
BY: _____ DC

TRACT "B"
WATER MANAGEMENT TRACT
TO BE MAINTAINED BY CASCADES RESIDENTS'
ASSOCIATION, INC.

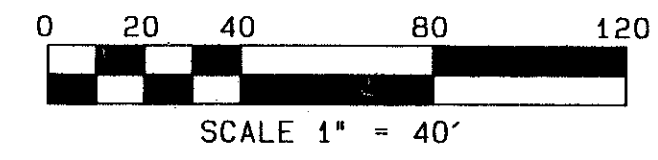
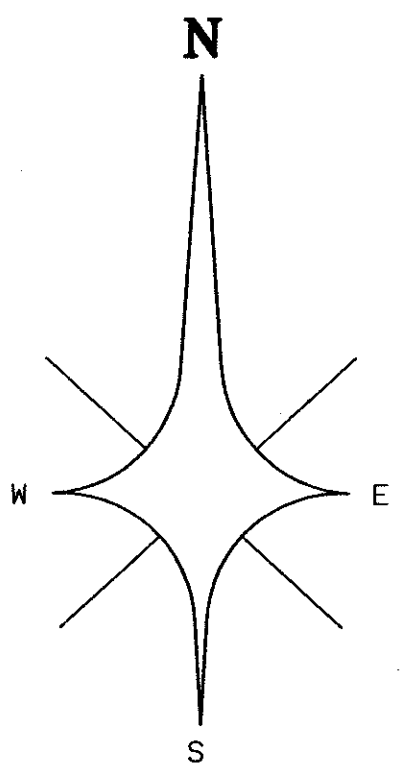

MATCH LINE SEE SHEET 7 OF 7

MATCH LINE SEE SHEET 5 OF 7

MATCH LINE SEE SHEET 5 OF 7

MATCH LINE SEE SHEET 5 OF 7

SUBDIVISION * Jones Parcel A
BOOK 81 PAGE 25
FLOOD ZONE A Hb FLOOD MAP # 2004
QUAD # 50/35 ZONING PDD
SE - ZIP CODE 33437
PUD NAME Jones Parcel A

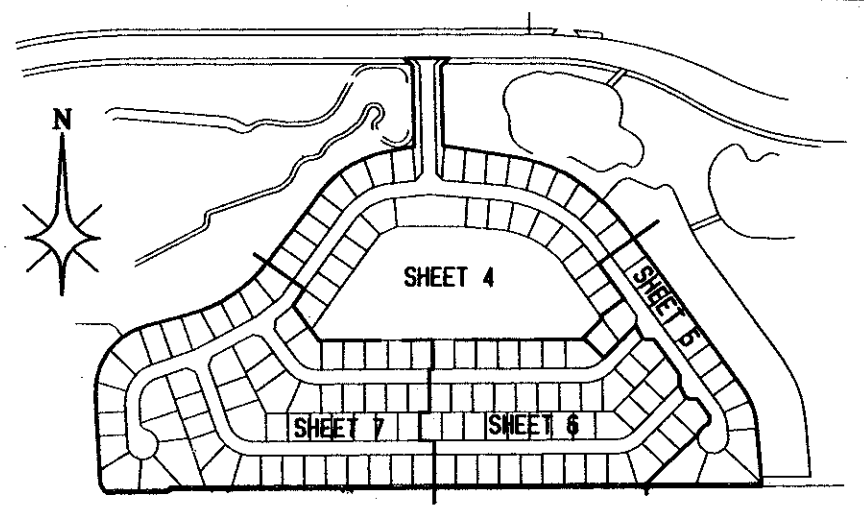

KEY MAP
NOT TO SCALE

0683-006

8/1/25

PROFESSIONAL
SURVEYORS
AND MAPPERS
ATLANTIC - CARIBBEAN MAPPING, INC.
3062 JOG ROAD - GREENACRES, FLORIDA 33467
(561) 964-7884; FAX (561) 964-1969