

0587-024

184

WINSTON TRAILS PARCEL ELEVEN PHASE II

PART OF WINSTON TRAILS P.U.D.
SITUATE IN SECTION 2, TOWNSHIP 45 SOUTH, RANGE 42 EAST
PALM BEACH COUNTY, FLORIDA
NOVEMBER, 1997 SHEET 1 OF 6

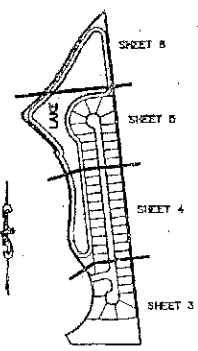

SHEET INDEX MAP
NOT TO SCALE

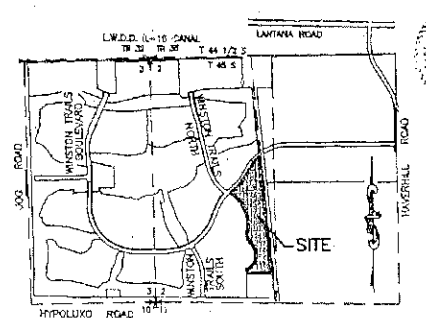

LOCATION MAP
NOT TO SCALE



STATE OF FLORIDA
COUNTY OF PALM BEACH
THIS PLAT HAS FILED FOR
RECORD IN PLAT BOOK 87, PAGE 184
AS 1998 AND FULLY RECORDED
IN PLAT BOOK 87, PAGE 184
DOROTHY H. WILKER, CLERK
By: *[Signature]* D.C.

CIRCUIT COURT SEAL

DEDICATION

KNOW ALL MEN BY THESE PRESENTS THAT JAMES J. O'BRIEN, AS TRUSTEE, UNDER LAND TRUST AGREEMENT DATED MARCH 8, 1989, OWNER OF THE LAND SHOWN HEREON AS WINSTON TRAILS PARCEL ELEVEN PHASE II, PART OF WINSTON TRAILS P.U.D., SITUATE IN SECTION 2, TOWNSHIP 45 SOUTH, RANGE 42 EAST, PALM BEACH COUNTY, FLORIDA, BEING MORE PARTICULARLY DESCRIBED AS FOLLOWS:

A PARCEL OF LAND SITUATE IN SECTION 2, TOWNSHIP 45 SOUTH, RANGE 42 EAST, PALM BEACH COUNTY, FLORIDA, BEING MORE PARTICULARLY DESCRIBED AS FOLLOWS:

BEGINNING AT THE NORTHEAST CORNER OF WINSTON TRAILS PARCEL ELEVEN, ACCORDING TO THE PLAT THEREOF, AS RECORDED IN PLAT BOOK 80, PAGES 18 THROUGH 23, INCLUSIVE, OF THE PUBLIC RECORDS OF PALM BEACH COUNTY, FLORIDA; THENCE NORTH 48°18'02" EAST, A DISTANCE OF 150.00 FEET TO THE POINT OF CURVATURE OF A CURVE CONCAVE NORTHWESTERLY HAVING A RADIUS OF 1040.00 FEET; THENCE NORTHEASTERLY ALONG THE ARC OF SAID CURVE THROUGH A CENTRAL ANGLE OF 18°55'39", AN ARC DISTANCE OF 343.55 FEET TO THE POINT OF TANGENCY; THENCE NORTH 29°22'23" EAST, A DISTANCE OF 150.31 FEET TO THE POINT OF CURVATURE OF A CURVE CONCAVE SOUTHEASTERLY HAVING A RADIUS OF 990.00 FEET; THENCE NORTHEASTERLY ALONG THE ARC OF SAID CURVE THROUGH A CENTRAL ANGLE OF 20°46'43", AN ARC DISTANCE OF 376.31 FEET TO A POINT ON THE WEST LINE OF THE LAKE NORTH DRAINAGE DISTRICT (LW.D.D. E-3 CANAL AS RECORDED IN OFFICIAL RECORD BOOK 8340, PAGE 382; THENCE SOUTH 05°28'48" EAST, ALONG SAID WEST LINE, A DISTANCE OF 2566.36 FEET; THENCE NORTH 89°10'50" WEST, DEPARTING SAID WEST LINE, A DISTANCE OF 524.69 FEET TO A POINT ON THE EAST LINE OF THE AFFOREMENTIONED WINSTON TRAILS PARCEL ELEVEN; THENCE NORTH 29°32'11" WEST, ALONG SAID EAST LINE, A DISTANCE OF 80.07 FEET TO A POINT ON THE ARC OF A NON-TANGENT CURVE CONCAVE WESTERLY HAVING A RADIUS OF 349.00 FEET, A RADIAL LINE FROM SAID POINT BEARS NORTH 23°48'24" WEST; THENCE NORTHERLY ALONG THE ARC OF SAID CURVE THROUGH A CENTRAL ANGLE OF 102°54'01", AN ARC DISTANCE OF 824.75 FEET TO THE POINT OF TANGENCY; THENCE NORTH 39°22'25" WEST, A DISTANCE OF 108.81 FEET TO THE POINT OF CURVATURE OF A CURVE CONCAVE EASTERLY HAVING A RADIUS OF 265.00 FEET; THENCE NORTHWESTERLY ALONG THE ARC OF SAID CURVE THROUGH A CENTRAL ANGLE OF 41°05'42", AN ARC DISTANCE OF 190.07 FEET TO THE POINT OF TANGENCY; THENCE NORTH 04°43'18" EAST, A DISTANCE OF 182.93 FEET TO THE POINT OF CURVATURE OF A CURVE CONCAVE WESTERLY HAVING A RADIUS OF 655.00 FEET; THENCE NORTHWESTERLY ALONG THE ARC OF SAID CURVE THROUGH A CENTRAL ANGLE OF 39°20'18", AN ARC DISTANCE OF 449.71 FEET; THENCE NORTH 55°22'58" EAST, ALONG A LINE RADIAL TO THE LAST AND NEXT DESCRIBED CURVES, A DISTANCE OF 20.00 FEET TO A POINT ON THE ARC OF A NON-TANGENT CURVE CONCAVE SOUTHWESTERLY HAVING A RADIUS OF 675.00 FEET; THENCE NORTHWESTERLY ALONG THE ARC OF SAID CURVE THROUGH A CENTRAL ANGLE OF 11°19'49", A DISTANCE OF 133.48 FEET TO THE POINT OF TANGENCY; THENCE NORTH 45°58'51" WEST, A DISTANCE OF 227.57 FEET; THENCE NORTH 01°13'48" EAST, A DISTANCE OF 23.31 FEET; THENCE NORTH 40°55'44" WEST, ALONG A LINE RADIAL TO THE FOLLOWING DESCRIBED CURVE, A DISTANCE OF 10.13 FEET TO A POINT ON THE ARC OF A NON-TANGENT CURVE CONCAVE SOUTHEASTERLY HAVING A RADIUS OF 980.00 FEET; THENCE SOUTHWESTERLY ALONG THE ARC OF SAID CURVE THROUGH A CENTRAL ANGLE OF 60°46'14", AN ARC DISTANCE OF 12.91 FEET TO THE POINT OF BEGINNING.

CONTAINING 24.297 ACRES, MORE OR LESS.
HAVE CAUSED THE SAME TO BE SURVEYED AND PLATTED AS SHOWN HEREON AND DO HEREBY DEDICATE AS FOLLOWS:

- TRACT A, AS SHOWN HEREON, IS HEREBY RESERVED FOR THE WINSTON TRAILS FOUNDATION, INC., ITS SUCCESSORS AND ASSIGNS, FOR PRIVATE STREET PURPOSES, UTILITIES, DRAINAGE AND OTHER PURPOSES NOT INCONSISTENT WITH THIS RESERVATION AND IS THE PERPETUAL MAINTENANCE OBLIGATION OF SAID ASSOCIATION, ITS SUCCESSORS AND ASSIGNS, WITHOUT RECOURSE TO PALM BEACH COUNTY.
- TRACT B, AS SHOWN HEREON, IS HEREBY RESERVED FOR THE WINSTON TRAILS FOUNDATION, INC., ITS SUCCESSORS AND ASSIGNS, FOR RECREATION PURPOSES AND IS THE PERPETUAL MAINTENANCE OBLIGATION OF SAID FOUNDATION, ITS SUCCESSORS AND ASSIGNS, WITHOUT RECOURSE TO PALM BEACH COUNTY.
- TRACT C, AS SHOWN HEREON, IS HEREBY RESERVED FOR THE LAKE NONA VILLAGE NEIGHBORHOOD ASSOCIATION, INC., ITS SUCCESSORS AND ASSIGNS, FOR OPEN SPACE PURPOSES, AND IS THE PERPETUAL MAINTENANCE OBLIGATION OF SAID ASSOCIATION, ITS SUCCESSORS AND ASSIGNS, WITHOUT RECOURSE TO PALM BEACH COUNTY.
- TRACT LK-1, THE WATER MANAGEMENT TRACT, AS SHOWN HEREON, IS HEREBY RESERVED FOR THE WINSTON TRAILS FOUNDATION, INC., ITS SUCCESSORS AND ASSIGNS, FOR STORMWATER MANAGEMENT AND DRAINAGE PURPOSES AND IS THE PERPETUAL MAINTENANCE OBLIGATION OF SAID FOUNDATION, ITS SUCCESSORS AND ASSIGNS, WITHOUT RECOURSE TO PALM BEACH COUNTY, SUBJECT TO EXISTING LITTORAL ZONE RESTRICTIVE COVENANT AGREEMENT AS RECORDED IN OFFICIAL RECORD BOOK 9833, PAGE 1513 OF THE PUBLIC RECORDS OF PALM BEACH COUNTY, FLORIDA.

5. THE UTILITY EASEMENTS, AS SHOWN HEREON, ARE HEREBY DEDICATED IN PERPETUITY FOR THE CONSTRUCTION AND MAINTENANCE OF UTILITY FACILITIES, INCLUDING CABLE TELEVISION SYSTEMS. THE INSTALLATION OF CABLE TELEVISION SYSTEMS SHALL NOT INTERFERE WITH THE CONSTRUCTION AND MAINTENANCE OF OTHER UTILITIES.

6. THE DRAINAGE EASEMENTS AS SHOWN HEREON ARE HEREBY DEDICATED IN PERPETUITY FOR DRAINAGE PURPOSES. THE MAINTENANCE OF ALL DRAINAGE FACILITIES LOCATED THEREIN SHALL BE THE PERPETUAL MAINTENANCE OBLIGATION OF WINSTON TRAILS FOUNDATION, INC., ITS SUCCESSORS AND ASSIGNS, WITHOUT RECOURSE TO PALM BEACH COUNTY.

7. PALM BEACH COUNTY SHALL HAVE THE RIGHT, BUT NOT THE OBLIGATION, TO MAINTAIN ANY PORTION OF THE DRAINAGE SYSTEM ENCOMPASSED BY THIS PLAT WHICH IS ASSOCIATED WITH THE DRAINAGE OF PUBLIC STREETS, INCLUDING THE RIGHT TO UTILIZE FOR PROPER PURPOSES ANY AND ALL DRAINAGE, LAKE MAINTENANCE, AND LAKE MAINTENANCE ACCESS EASEMENTS AND PRIVATE ROADS ASSOCIATED WITH SAID DRAINAGE SYSTEM.

8. THE LAKE MAINTENANCE AND LAKE MAINTENANCE ACCESS EASEMENTS, AS SHOWN HEREON, ARE HEREBY RESERVED FOR THE WINSTON TRAILS FOUNDATION, INC., ITS SUCCESSORS AND ASSIGNS, FOR ACCESS TO STORMWATER MANAGEMENT AND DRAINAGE FACILITIES LOCATED WITHIN THE ASSOCIATED WATER MANAGEMENT TRACT FOR PURPOSES OF PERFORMING ANY AND ALL MAINTENANCE ACTIVITIES PURSUANT TO THE MAINTENANCE OBLIGATION OF SAID FOUNDATION, ITS SUCCESSORS AND ASSIGNS, WITHOUT RECOURSE TO PALM BEACH COUNTY.

9. THE LIMITED ACCESS EASEMENTS (LAE), AS SHOWN HEREON, ARE HEREBY DEDICATED TO THE BOARD OF COUNTY COMMISSIONERS OF PALM BEACH COUNTY, FLORIDA, FOR THE PURPOSE OF CONTROL AND JURISDICTION OVER ACCESS RIGHTS.

10. THE BUFFER EASEMENTS, AS SHOWN HEREON, ARE HEREBY RESERVED FOR WINSTON TRAILS FOUNDATION, INC., ITS SUCCESSORS AND ASSIGNS, FOR BUFFER AND OTHER PURPOSES AND ARE THE PERPETUAL MAINTENANCE OBLIGATION OF SAID ASSOCIATION, ITS SUCCESSORS AND ASSIGNS, WITHOUT RECOURSE TO PALM BEACH COUNTY.

IN WITNESS WHEREOF, I, JAMES J. O'BRIEN, AS TRUSTEE, UNDER LAND TRUST AGREEMENT, DATED MARCH 8, 1989, DO HEREBY SET MY HAND AND SEAL, THIS 17th DAY OF APRIL, 1998.

WITNESS: *[Signature]*
CHEVEL FAY
WITNESS: *[Signature]*
PAMELA C. PARKER

ACKNOWLEDGEMENT

STATE OF FLORIDA)
COUNTY OF PALM BEACH)

BEFORE ME PERSONALLY APPEARED JAMES J. O'BRIEN, AS TRUSTEE UNDER LAND TRUST AGREEMENT DATED MARCH 8, 1989, WHO IS PERSONALLY KNOWN TO ME OR HAS PRODUCED AS IDENTIFICATION, AND WHO EXECUTED THE FOREGOING INSTRUMENT, AND ACKNOWLEDGED TO AND BEFORE ME THAT HE EXECUTED SAID INSTRUMENT FOR THE PURPOSES EXPRESSED THEREIN.

WITNESS MY HAND AND OFFICIAL SEAL THIS 17th DAY OF APRIL, 1998.
MY COMMISSION EXPIRES: 06-16-2000
DATE

NOTARY PUBLIC
SEAL
(FOR JAMES J. O'BRIEN)

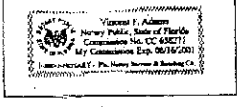

SEAL WINSTON TRAILS FOUNDATION, INC. SEAL LAKE NONA VILLAGE NEIGHBORHOOD ASSOC., INC. SEAL DEPUTY COUNTY ENGINEER



ACCEPTANCE OF RESERVATIONS

STATE OF FLORIDA)
COUNTY OF PALM BEACH)

THE WINSTON TRAILS FOUNDATION, INC., HEREBY ACCEPTS THE DEDICATIONS OR RESERVATIONS TO SAID ASSOCIATION AS STATED AND SHOWN HEREON, AND HEREBY ACCEPTS ITS MAINTENANCE OBLIGATIONS FOR SAME AS STATED HEREON, DATED THIS 17th DAY OF APRIL, 1998.

WITNESS: *[Signature]*
CHEVEL FAY
WITNESS: *[Signature]*
PAMELA C. PARKER

ACKNOWLEDGEMENT

STATE OF FLORIDA)
COUNTY OF PALM BEACH)

BEFORE ME PERSONALLY APPEARED JAMES J. O'BRIEN WHO IS PERSONALLY KNOWN TO ME OR HAS PRODUCED AS IDENTIFICATION, AND WHO EXECUTED THE FOREGOING INSTRUMENT AS PRESIDENT OF WINSTON TRAILS FOUNDATION, INC., A FLORIDA CORPORATION, NOT FOR PROFIT, AND SEVERALLY ACKNOWLEDGED TO AND BEFORE ME THAT HE EXECUTED SUCH INSTRUMENT AS SUCH OFFICER OF SAID CORPORATION, AND THAT THE SEAL AFFIXED TO THE FOREGOING INSTRUMENT IS THE CORPORATE SEAL OF SAID CORPORATION AND THAT IT WAS AFFIXED TO SAID INSTRUMENT BY DUE AND REGULAR CORPORATE AUTHORITY, AND THAT SAID INSTRUMENT IS THE FREE ACT AND DEED OF SAID CORPORATION.

WITNESS MY HAND AND OFFICIAL SEAL THIS 17th DAY OF APRIL, 1998.
MY COMMISSION EXPIRES: 06-16-2000
DATE

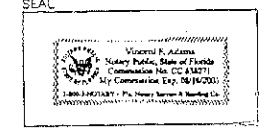

ACCEPTANCE OF RESERVATIONS

STATE OF FLORIDA)
COUNTY OF PALM BEACH)

THE LAKE NONA VILLAGE NEIGHBORHOOD ASSOCIATION, INC., HEREBY ACCEPTS THE DEDICATIONS OR RESERVATIONS TO SAID ASSOCIATION AS STATED AND SHOWN HEREON, AND HEREBY ACCEPTS ITS MAINTENANCE OBLIGATIONS FOR SAME AS STATED HEREON, DATED THIS 20 DAY OF APRIL, 1998.

WITNESS: *[Signature]*
WITNESS: *[Signature]*
James Carr

ACKNOWLEDGEMENT

STATE OF FLORIDA)
COUNTY OF PALM BEACH)

BEFORE ME PERSONALLY APPEARED JAMES CARR, WHO IS PERSONALLY KNOWN TO ME OR HAS PRODUCED AS IDENTIFICATION, AND WHO EXCLUDED THE FOREGOING INSTRUMENT AS PRESIDENT OF THE LAKE NONA VILLAGE NEIGHBORHOOD ASSOCIATION, INC., A FLORIDA CORPORATION NOT-FOR-PROFIT, AND SEVERALLY ACKNOWLEDGED TO AND BEFORE ME THAT HE EXECUTED SUCH INSTRUMENT AS SUCH OFFICER OF SAID CORPORATION, AND THAT THE SEAL AFFIXED TO THE FOREGOING INSTRUMENT IS THE CORPORATE SEAL OF SAID CORPORATION AND THAT IT WAS AFFIXED TO SAID INSTRUMENT BY DUE AND REGULAR CORPORATE AUTHORITY, AND THAT SAID INSTRUMENT IS THE FREE ACT AND DEED OF SAID CORPORATION.

WITNESS MY HAND AND OFFICIAL SEAL THIS 20th DAY OF APRIL, 1998.
MY COMMISSION EXPIRES: 0-19-2000
DATE

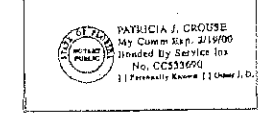

APPROVALS

COUNTY ENGINEER:
THIS PLAT IS HEREBY APPROVED FOR RECORD PURSUANT TO PALM BEACH COUNTY ORDINANCE 98-33, AND IN ACCORDANCE WITH SECTION 177.071(2), F.S., AS OF THIS 14th DAY OF JULY, 1998.
BY: *[Signature]*
EDWIN A. JACK, P.E., DEPT. CO. ENGINEER

P.U.D. TABULAR DATA

WINSTON TRAILS P.U.D. PETITION NO. 87-1120	
AREA	24.297 ACRES
ROADS	2.086 ACRES
RECREATION	2.182 ACRES
OPEN SPACE	1.888 ACRES
WATER MANAGEMENT TRACTS	8.783 ACRES
DENSITY	1.66 DU/AC
NUMBER OF UNITS	47

THIS INSTRUMENT WAS PREPARED BY WARY HANNA CLODFELTER, P.S.M. IN THE OFFICES OF WACK, ROOS & ASSOCIATES, INC., 5720 CORPORATE WAY, WEST PALM BEACH, FLORIDA 33407.

SHEET 1 OF 6

SCALE: N/A
P.A. NO.: 87011.00
DATE: NOVEMBER 1997
DRAWING NO.: 45-42-02-05



WINSTON TRAILS
PARCEL ELEVEN PHASE II
PART OF WINSTON TRAILS P.U.D.
SITUATE IN SECTION 2, TOWNSHIP 45 SOUTH,
RANGE 42 EAST
PALM BEACH COUNTY, FLORIDA

WINTRP20.dwg 4-15-98 5:39:45 pm EST

REVISION: 01-09-98
CAD FILE:
MUSSENY/WINTRP20