

REGIONAL CENTER PARCEL 27.04

SITUATE IN SECTIONS 5 AND 6, TOWNSHIP 42 SOUTH,
RANGE 43 EAST, CITY OF PALM BEACH GARDENS,
PALM BEACH COUNTY, FLORIDA

OCTOBER, 2000 SHEET 1 OF 2

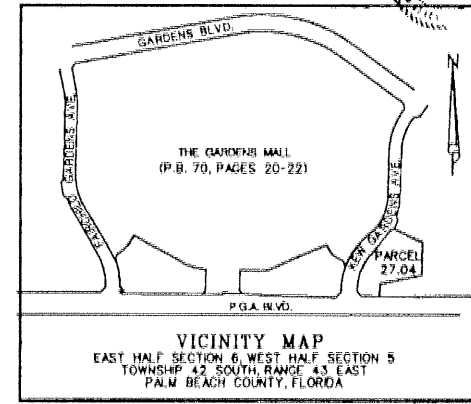

COUNTY OF PALM BEACH)
STATE OF FLORIDA)
This Plat was filed for record at 10:38 A.M.
The Day of March 20 2001
and duly recorded in Plat Book No. 90
on Page 152
DOROTHY H. WILKIN, Clerk of Circuit Court
By: [Signature]

DEDICATION:

STATE OF FLORIDA)
COUNTY OF PALM BEACH)

KNOW ALL MEN BY THESE PRESENTS THAT WALL PROPERTIES, LTD., A FLORIDA LIMITED PARTNERSHIP, LICENSED TO DO BUSINESS IN THE STATE OF FLORIDA, AND NORTHERN PALM BEACH COUNTY IMPROVEMENT DISTRICT, AN INDEPENDENT SPECIAL DISTRICT OF THE STATE OF FLORIDA, OWNERS OF THE LAND SHOWN HEREON AS REGIONAL CENTER PARCEL 27.04, SITUATE IN SECTIONS 5 AND 6, TOWNSHIP 42 SOUTH, RANGE 43 EAST, CITY OF PALM BEACH GARDENS, PALM BEACH COUNTY, FLORIDA, BEING MORE PARTICULARLY DESCRIBED AS FOLLOWS:

A PARCEL OF LAND SITUATE IN SECTIONS 5 AND 6, TOWNSHIP 42 SOUTH, RANGE 43 EAST, WITHIN THE MUNICIPAL LIMITS OF THE CITY OF PALM BEACH GARDENS, PALM BEACH COUNTY, FLORIDA, AND BEING MORE PARTICULARLY DESCRIBED AS FOLLOWS:

COMMENCING AT THE SOUTHEAST CORNER OF THE NORTHEAST QUARTER OF SAID SECTION 6; THENCE NORTH 88°45'08" WEST ALONG THE SOUTH LINE OF THE NORTHEAST QUARTER OF SAID SECTION 6 A DISTANCE OF 431.01 FEET; THENCE DEPARTING SAID SOUTH LINE NORTH 01°14'52" EAST A DISTANCE OF 92.00 FEET TO A POINT ON THE NORTH RIGHT-OF-WAY LINE OF PGA BOULEVARD AS DESCRIBED IN OFFICIAL RECORD BOOK 4442, PAGE 856; PUBLIC RECORDS OF PALM BEACH COUNTY, FLORIDA AND THE POINT OF BEGINNING OF THE HEREIN DESCRIBED PARCEL:

THENCE NORTH 88°45'08" WEST ALONG SAID RIGHT-OF-WAY LINE A DISTANCE OF 155.88 FEET TO A POINT ON THE EAST RIGHT-OF-WAY LINE OF KEW GARDENS AVENUE, AS SHOWN IN ROAD PLAT BOOK 7, PAGES 195 THROUGH 200, PUBLIC RECORDS OF PALM BEACH COUNTY, FLORIDA; THENCE NORTH 43°40'04" WEST ALONG SAID RIGHT-OF-WAY LINE A DISTANCE OF 88.68 FEET; THENCE NORTH 01°25'01" EAST CONTINUING ALONG SAID RIGHT-OF-WAY A DISTANCE OF 13.55 FEET TO THE POINT OF CURVATURE OF A CURVE CONCAVE TO THE EAST, HAVING A RADIUS OF 455.87 FEET AND A CENTRAL ANGLE OF 37°36'44"; THENCE NORTHERLY ALONG THE ARC OF SAID CURVE A DISTANCE OF 299.13 FEET TO THE POINT OF TANGENCY; THENCE NORTH 39°00'45" EAST A DISTANCE OF 195.11 FEET TO THE POINT OF CURVATURE OF A CURVE CONCAVE TO THE NORTHWEST, HAVING A RADIUS OF 570.87 FEET AND A CENTRAL ANGLE OF 08°11'28"; THENCE NORTHERLY ALONG THE ARC OF SAID CURVE A DISTANCE OF 81.61 FEET TO A POINT ON A NON-TANGENT LINE; THENCE NORTH 73°38'42" EAST A DISTANCE OF 33.99 FEET; SAID POINT LYING ON THE SOUTH LINE OF PARCEL 27.02 AS SHOWN ON THE PLAT OF REGIONAL CENTER PARCELS 27.05, 27.06 AND 27.02, AS RECORDED IN PLAT BOOK 88, PAGES 104 AND 105, PUBLIC RECORDS OF PALM BEACH COUNTY, FLORIDA; THENCE DEPARTING SAID RIGHT-OF-WAY LINE SOUTH 63°32'07" EAST ALONG THE SOUTH LINE OF SAID PARCEL 27.02, A DISTANCE OF 192.75 FEET TO THE POINT OF CURVATURE OF A NON-TANGENT CURVE CONCAVE TO THE NORTH, HAVING A RADIUS OF 341.56 FEET, A CENTRAL ANGLE OF 23°55'05" AND A RADIAL BEARING OF NORTH 25°01'12" EAST; THENCE EASTERLY ALONG THE ARC OF SAID CURVE A DISTANCE OF 142.58 FEET; THENCE SOUTH 88°53'53" EAST, A DISTANCE OF 34.72 FEET TO THE NORTHEAST CORNER OF A NORTHERN PALM BEACH COUNTY IMPROVEMENT DISTRICT WATER MANAGEMENT TRACT, AS DESCRIBED IN OFFICIAL RECORD BOOK 8072, PAGE 354, PUBLIC RECORDS OF PALM BEACH COUNTY, FLORIDA; THENCE SOUTH 01°08'32" WEST ALONG THE EAST LINE OF SAID WATER MANAGEMENT TRACT, A DISTANCE OF 469.81 FEET TO THE SOUTHEAST CORNER OF SAID WATER MANAGEMENT TRACT; THENCE NORTH 87°42'31" WEST ALONG THE SOUTH LINE OF SAID TRACT AND THE NORTH RIGHT-OF-WAY LINE OF SAID BOULEVARD, A DISTANCE OF 270.30 FEET; THENCE NORTH 84°49'46" WEST, A DISTANCE OF 175.41 FEET TO THE POINT OF BEGINNING.

CONTAINING IN ALL 288,809 SQUARE FEET OR 6.630 ACRES, MORE OR LESS.

DEDICATIONS:

1) PARCEL 27.04 AS SHOWN HEREON IS HEREBY RESERVED FOR FUTURE DEVELOPMENT.

IN WITNESS WHEREOF, THE ABOVE NAMED LIMITED PARTNERSHIP HAS CAUSED THESE PRESENTS TO BE SIGNED BY ITS GENERAL PARTNER, CATALFUMO MANAGEMENT AND INVESTMENT, INC., A FLORIDA CORPORATION, LICENSED TO DO BUSINESS IN THE STATE OF FLORIDA, THIS DAY 13th of November, 2000.

BY: [Signature] CATALFUMO MANAGEMENT AND INVESTMENT, INC., A FLORIDA CORPORATION, AS GENERAL PARTNER.
WITNESS: [Signature] DANIEL S. CATALFUMO, PRESIDENT.
WITNESS: [Signature] CLAUDIA BENTLE, DANIEL S. CATALFUMO, PRESIDENT.

ACKNOWLEDGEMENT:

STATE OF FLORIDA)
COUNTY OF PALM BEACH)

BEFORE ME PERSONALLY APPEARED DANIEL S. CATALFUMO, WHO IS PERSONALLY KNOWN TO ME, OR HAS PRODUCED A DRIVER'S LICENSE AS IDENTIFICATION, AND WHO EXECUTED THE FOREGOING INSTRUMENT AS PRESIDENT OF CATALFUMO MANAGEMENT AND INVESTMENT, INC., A FLORIDA CORPORATION, AND SEVERALLY ACKNOWLEDGED TO AND BEFORE ME THAT HE EXECUTED SUCH INSTRUMENT AS SUCH OFFICER OF SAID CORPORATION, AND THAT THE SEAL AFFIXED TO THE FOREGOING INSTRUMENT IS THE CORPORATE SEAL OF SAID CORPORATION AND THAT IT WAS AFFIXED TO SAID INSTRUMENT BY DUE AND REGULAR CORPORATE AUTHORITY, AND THAT SAID INSTRUMENT IS THE FREE ACT AND DEED OF SAID CORPORATION.

WITNESS MY HAND AND OFFICIAL SEAL THIS 17th DAY OF November, 2000.

MY COMMISSION EXPIRES: 8/16/02
[Signature] CLAUDIA BENTLE, NOTARY PUBLIC

NOTARY SEAL: [Seal]

IN WITNESS WHEREOF, THE UNDERSIGNED HAS CAUSED THESE PRESENTS TO BE SIGNED BY ITS PRESIDENT, AND ATTESTED BY ITS SECRETARY AND ITS SEAL TO BE AFFIXED HEREON BY AND WITH THE AUTHORITY OF ITS BOARD OF SUPERVISORS THIS 20th DAY OF FEBRUARY, 2001, AND HEREBY ACKNOWLEDGES THAT IT'S WATER MANAGEMENT TRACT AS RECORDED IN OFFICIAL RECORD BOOK 9768, PAGE 88, IS SHOWN HEREON.

ATTEST: [Signature] PETER L. PIMENTEL, SECRETARY BOARD OF SUPERVISORS
[Signature] TESULA N. STEWART, PRESIDENT BOARD OF SUPERVISORS

ACKNOWLEDGEMENT:

STATE OF FLORIDA)
COUNTY OF PALM BEACH)

BEFORE ME PERSONALLY APPEARED TESULA N. STEWART AND PETER L. PIMENTEL, WHO IS PERSONALLY KNOWN TO ME, OR HAS PRODUCED A DRIVER'S LICENSE AS IDENTIFICATION, AND WHO EXECUTED THE FOREGOING INSTRUMENT AS PRESIDENT AND SECRETARY OF NORTHERN PALM BEACH COUNTY IMPROVEMENT DISTRICT, A FLORIDA CORPORATION, AND SEVERALLY ACKNOWLEDGED TO AND BEFORE ME THAT THEY EXECUTED SUCH INSTRUMENT AS SUCH OFFICERS OF SAID CORPORATION, AND THAT THE SEAL AFFIXED TO THE FOREGOING INSTRUMENT IS THE CORPORATE SEAL OF SAID CORPORATION AND THAT IT WAS AFFIXED TO SAID INSTRUMENT BY DUE AND REGULAR CORPORATE AUTHORITY, AND THAT SAID INSTRUMENT IS THE FREE ACT AND DEED OF SAID CORPORATION.

WITNESS MY HAND AND OFFICIAL SEAL THIS DAY 20th of FEBRUARY, 2001.

MY COMMISSION EXPIRES: 6/22/03
[Signature] ROBERTA ANNE MACLEOD, NOTARY PUBLIC

MORTGAGEE'S CONSENT:

STATE OF FLORIDA)
COUNTY OF BROWARD)

THE UNDERSIGNED HEREBY CERTIFIES THAT IT IS THE HOLDER OF A MORTGAGE, UPON THE PROPERTY DESCRIBED HEREON AND DOES HEREBY JOIN IN AND CONSENT TO THE DEDICATION OF THE LAND DESCRIBED IN SAID DEDICATION BY THE OWNERS THEREOF AND AGREES THAT ITS MORTGAGE WHICH IS RECORDED IN OFFICIAL RECORD BOOK 11006, PAGE 935, OF THE PUBLIC RECORDS OF PALM BEACH COUNTY, FLORIDA, SHALL BE SUBORDINATED TO THE DEDICATION SHOWN HEREON.

IN WITNESS WHEREOF, THE SAID CORPORATION HAS CAUSED THESE PRESENTS TO BE SIGNED BY ITS SENIOR VICE PRESIDENT AND ITS CORPORATE SEAL TO BE AFFIXED HEREON BY AND WITH THE AUTHORITY OF ITS BOARD OF DIRECTORS THIS 21st DAY OF OCTOBER, 2000.

WITNESS: [Signature] BANK ATLANTIC A FEDERAL SAVINGS BANK
WITNESS: [Signature] KAREN H. HITTSON, SENIOR VICE PRESIDENT

ACKNOWLEDGEMENT:

STATE OF FLORIDA)
COUNTY OF BROWARD)

BEFORE ME PERSONALLY APPEARED KAREN H. HITTSON, WHO IS PERSONALLY KNOWN TO ME, OR HAS PRODUCED A DRIVER'S LICENSE AS IDENTIFICATION, AND WHO EXECUTED THE FOREGOING INSTRUMENT AS SENIOR VICE PRESIDENT OF BANK ATLANTIC A FEDERAL SAVINGS BANK, AND SEVERALLY ACKNOWLEDGED TO AND BEFORE ME THAT SHE EXECUTED SUCH INSTRUMENT AS SUCH OFFICER OF SAID CORPORATION, AND THAT THE SEAL AFFIXED TO THE FOREGOING INSTRUMENT IS THE CORPORATE SEAL OF SAID CORPORATION AND THAT IT WAS AFFIXED TO SAID INSTRUMENT BY DUE AND REGULAR CORPORATE AUTHORITY, AND THAT SAID INSTRUMENT IS THE FREE ACT AND DEED OF SAID CORPORATION.

WITNESS MY HAND AND OFFICIAL SEAL THIS 21st DAY OF October, 2000.

MY COMMISSION EXPIRES: [Signature] NOTARY PUBLIC

TITLE CERTIFICATION:

STATE OF FLORIDA)
COUNTY OF PALM BEACH)

I, JAMES E. JACOBY, A DULY LICENSED ATTORNEY IN THE STATE OF FLORIDA DO HEREBY CERTIFY THAT I HAVE EXAMINED THE TITLE TO THE HEREON DESCRIBED PROPERTY, THAT I FIND THE TITLE TO THE PROPERTY IS VESTED IN WALL PROPERTIES, LTD., A FLORIDA LIMITED PARTNERSHIP; THAT THE CURRENT TAXES HAVE BEEN PAID; AND THAT ALL MORTGAGES NOT SATISFIED OR RELEASED OF RECORD NOR OTHERWISE TERMINATED BY LAW ARE SHOWN HEREON AND THAT THERE ARE ENCUMBRANCES OF RECORD BUT THOSE ENCUMBRANCES DO NOT PROHIBIT THE CREATION OF THE SUBDIVISION DEPICTED BY THIS PLAT.

DATE: 11/14/02
[Signature] JAMES E. JACOBY, ATTORNEY AT LAW BAR NO. 369578

SURVEYOR'S CERTIFICATION:

STATE OF FLORIDA)
COUNTY OF PALM BEACH)

THIS IS TO CERTIFY THAT THE PLAT SHOWN HEREON WAS PREPARED UNDER MY DIRECTION AND SUPERVISION AND IS A TRUE AND CORRECT REPRESENTATION OF A SURVEY MADE UNDER MY RESPONSIBLE DIRECTION AND SUPERVISION; THAT SAID SURVEY IS ACCURATE TO THE BEST OF MY KNOWLEDGE AND BELIEF; THAT PERMANENT REFERENCE MONUMENTS (P.R.M.'s) HAVE BEEN PLACED AS REQUIRED BY LAW; AND, FURTHER, THAT THE SURVEY DATA COMPLIES WITH ALL THE REQUIREMENTS OF CHAPTER 177, FLORIDA STATUTES, AS AMENDED, AND THE ORDINANCES OF THE CITY OF PALM BEACH GARDENS, FLORIDA.

[Signature] DAVID C. LIDBERG, P.S.M., LICENSE NO. 3613, STATE OF FLORIDA

APPROVALS:

CITY OF PALM BEACH GARDENS)
COUNTY OF PALM BEACH)

THIS PLAT IS HEREBY APPROVED FOR RECORD THIS 20th DAY OF December, 2000.

ATTEST: [Signature] CAROL GULL CITY CLERK
[Signature] JOSEPH H. RUSSO MAYOR

THIS PLAT IS HEREBY ACCEPTED FOR RECORD THIS 12 DAY OF March, 2001.

BY: [Signature] LENNART E. LINDAHL, P.E. - CITY ENGINEER

REVIEWING SURVEYOR:

STATE OF FLORIDA)
COUNTY OF PALM BEACH)

THIS PLAT HAS BEEN REVIEWED FOR CONFORMITY IN ACCORDANCE WITH CHAPTER 177.081 OF THE FLORIDA STATUTES AND THE ORDINANCES OF THE CITY OF PALM BEACH GARDENS. THIS REVIEW DOES NOT INCLUDE THE VERIFICATION OF THE GEOMETRIC DATA OR THE FIELD VERIFICATION OF THE PERMANENT REFERENCE MONUMENTS (P.R.M.), PERMANENT CONTROL POINTS (P.C.P.) AND MONUMENTS AT LOT CORNERS.

[Signature] O. HOWARD DUKES, PROFESSIONAL SURVEYOR AND MAPPER, LICENSE NO. 4533, DATE: March 1, 2001

SURVEYOR'S NOTES:

- BEARINGS SHOWN HEREON ARE BASED ON AND RELATIVE TO THE BEARING OF SOUTH 88°45'08" EAST ALONG THE SOUTH LINE OF THE NORTHEAST QUARTER OF SECTION 6, TOWNSHIP 42 SOUTH, RANGE 43, PALM BEACH COUNTY, FLORIDA.
- DENOTES A SET 4"x4" CONCRETE MONUMENT STAMPED "PRM LB 4431" PERMANENT REFERENCE MONUMENT (P.R.M.), UNLESS OTHERWISE NOTED.
- ⊗ DENOTES A SET PK NAIL & DISK STAMPED "PRM LB 4431", PERMANENT REFERENCE MONUMENT (P.R.M.), UNLESS OTHERWISE NOTED.
- LINES, WHICH INTERSECT CURVES, ARE NON-RADIAL UNLESS OTHERWISE NOTED.
- NOTICE: THIS PLAT, AS RECORDED IN ITS GRAPHIC FORM, IS THE OFFICIAL DEPICTION OF THE SUBDIVIDED LANDS DESCRIBED HEREIN AND WILL IN NO CIRCUMSTANCES BE SUPPLANTED IN AUTHORITY BY ANY OTHER GRAPHIC OR DIGITAL FORM OF THE PLAT. THERE MAY BE ADDITIONAL RESTRICTIONS THAT ARE NOT RECORDED ON THIS PLAT THAT MAY BE FOUND IN THE PUBLIC RECORDS OF THIS COUNTY.
- THIS INSTRUMENT WAS PREPARED BY DAVID C. LIDBERG, IN AND FOR THE OFFICES OF LIDBERG LAND SURVEYING, INC., 675 WEST INDIANTOWN ROAD, SUITE 200, JUPITER, FLORIDA 33458, TELEPHONE (561) 746-8454. BUILDING SETBACKS SHALL CONFORM TO PALM BEACH COUNTY ZONING CODE.

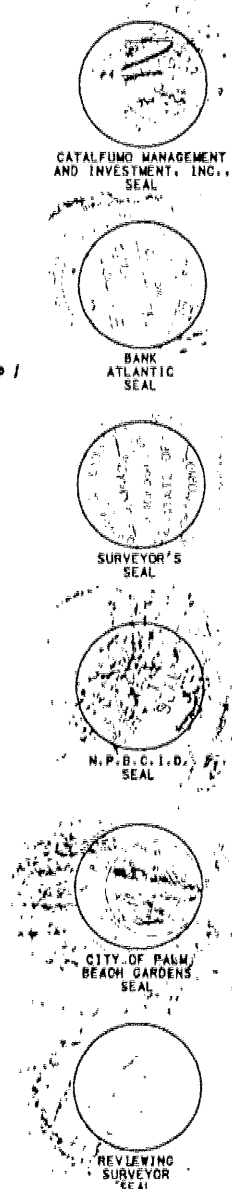

		CAD: K:\USTATION\08-42-43\0759306\0759306.DGN	
REF:		JOB 99-075(306)	
FLD. J.C.	FB. PG.	DATE 08/16/99	
OFF. R.W.	316 13	SHEET 1 OF 2	
CKD: D.C.L.	DWG: 099-075P	675 West Indiantown Road, Suite 200, Jupiter, Florida 33458 TEL: 561-746-8454	