

55

STATE OF FLORIDA )
COUNTY OF PALM BEACH )
THIS PLAT WAS FILED FOR RECORD
AT 2:17pm, THIS 9th DAY
OF October, 2001
AND DULY RECORDED IN PLAT BOOK
NO. 72, ON PAGES 55-58
DOROTHY WILKEN
CLERK OF THE CIRCUIT COURT
OF PALM BEACH COUNTY
FLORIDA
BY: Sharon M. Medina
DEPUTY CLERK

CRESTWOOD SQUARE

A PORTION OF SECTION 34, TOWNSHIP 43 SOUTH, RANGE 41 EAST

VILLAGE OF ROYAL PALM BEACH
PALM BEACH COUNTY, FLORIDA
AUGUST, 2001

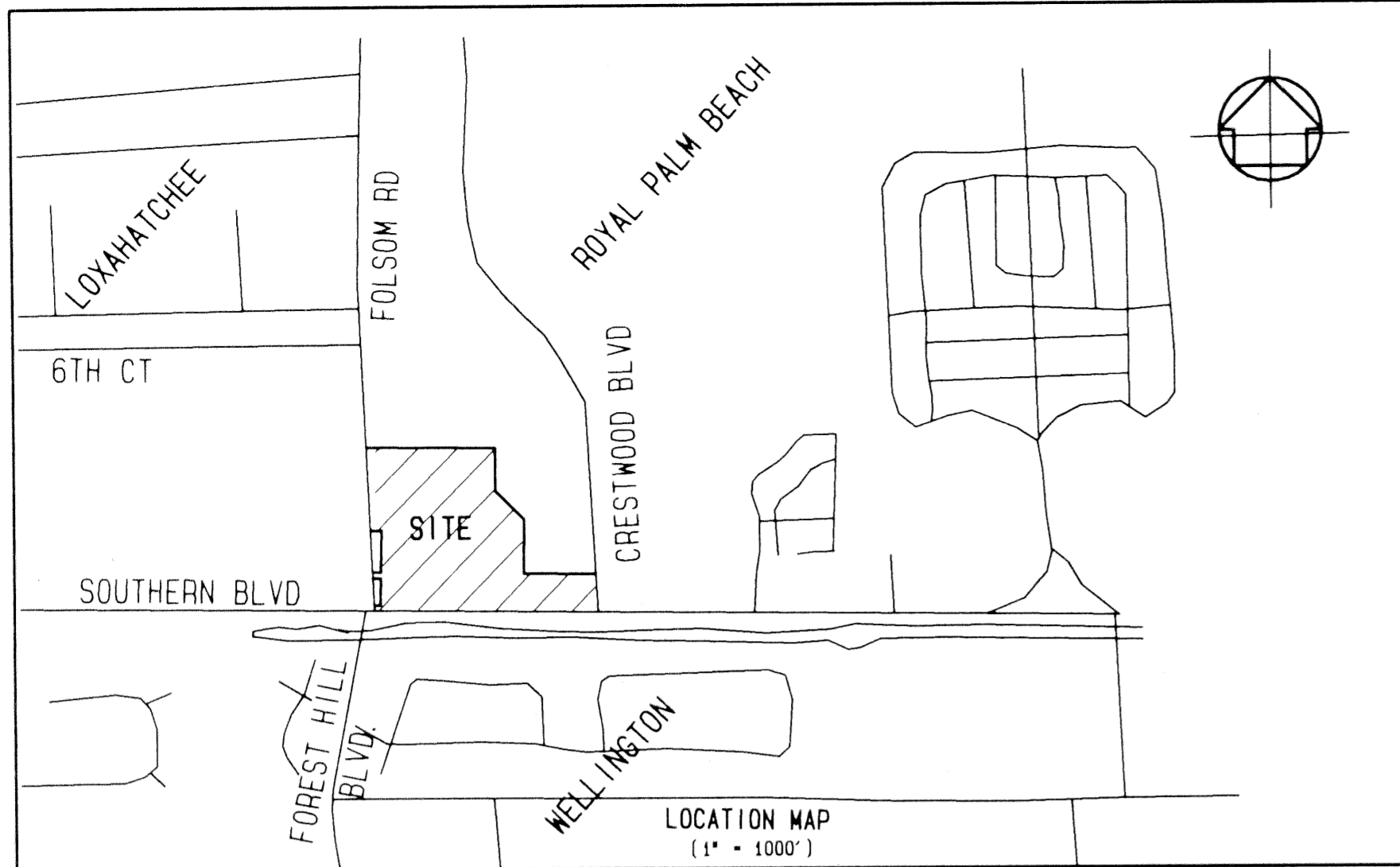

- HAVE CAUSED THE SAME TO BE SURVEYED AND PLATTED AS SHOWN HEREON AND DO HEREBY DEDICATE AND RESERVE AS FOLLOWS:
1. UTILITY EASEMENTS OVER THE ENTIRE PARCEL AND THE LIFT STATION EASEMENT, AS SHOWN HEREON, ARE HEREBY DEDICATED TO THE VILLAGE OF ROYAL PALM BEACH, FLORIDA, FOR THE INSTALLATION AND MAINTENANCE OF SANITARY SEWER AND WATER FACILITIES.
2. DRAINAGE EASEMENT #1, AS SHOWN HEREON, IS RESERVED FOR THE BENEFIT OF ALL OWNERS OF THIS PLAT. ALL PIPES IN SUCH EASEMENT SHALL BE MAINTAINED BY THE OWNER OF THE SHOPPING CENTER PARCEL.
3. DRAINAGE EASEMENT #2, AS SHOWN HEREON, IS RESERVED FOR THE BENEFIT OF ALL OWNERS OF THIS PLAT. MAINTENANCE OF THIS AREA SHALL BE THE RESPONSIBILITY OF THE OWNER OF THE PORTION OF THE PLAT ON WHICH THE MAINTENANCE IS REQUIRED.
4. DRAINAGE EASEMENT #3, AS SHOWN HEREON, IS RESERVED FOR THE BENEFIT OF THE SHOPPING CENTER PARCEL. ALL PIPES IN SUCH EASEMENT SHALL BE MAINTAINED BY THE OWNER OF THE SHOPPING CENTER PARCEL.

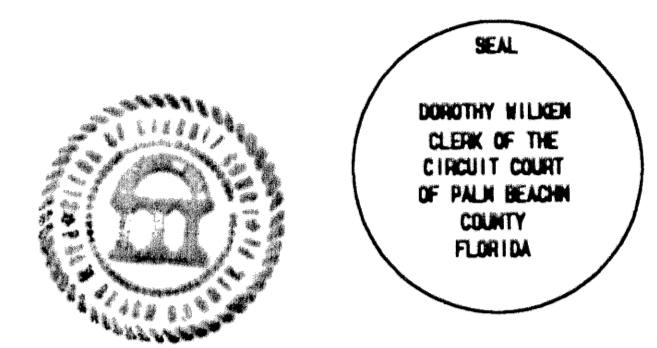

DEDICATION:

STATE OF FLORIDA )
COUNTY OF PALM BEACH ) SS

KNOW ALL MEN BY THESE PRESENTS, THAT CRESTWOOD SQUARE, LTD., A FLORIDA LIMITED PARTNERSHIP, ABC LIQUORS INC., A FLORIDA CORPORATION, EXXON MOBIL CORPORATION, A NEW JERSEY CORPORATION AND ROYAL PALM BEACH COLONY LIMITED PARTNERSHIP OWNERS OF THE PARCEL OF LAND SHOWN HEREON AS "CRESTWOOD SQUARE", A PARCEL OF LAND BEING IN SECTION 34, TOWNSHIP 43 SOUTH, RANGE 41 EAST, VILLAGE OF ROYAL PALM BEACH, PALM BEACH COUNTY, FLORIDA, BEING MORE PARTICULARLY DESCRIBED AS FOLLOWS:

COMMENCING AT THE NORTH ONE-QUARTER CORNER OF SAID SECTION 34;
THENCE NORTH 89° 49' 54" WEST ALONG THE NORTH LINE OF THE NORTHWEST ONE-QUARTER OF SAID SECTION 34, A DISTANCE OF 1319.53 FEET TO THE WEST LINE OF THE EAST ONE-HALF OF SAID SECTION 34;
THENCE SOUTH 01° 14' 28" WEST ALONG SAID WEST LINE OF THE EAST ONE-HALF OF THE WEST ONE-HALF OF SAID SECTION 34, A DISTANCE OF 2532.57 FEET TO THE POINT OF BEGINNING;
THENCE SOUTH 88° 45' 32" EAST, A DISTANCE OF 666.56 FEET;
THENCE SOUTH 01° 11' 27" WEST, A DISTANCE OF 258.39 FEET;
THENCE SOUTH 44° 03' 21" EAST, A DISTANCE OF 241.04 FEET;
THENCE SOUTH 01° 11' 27" WEST, A DISTANCE OF 320.00 FEET;
THENCE SOUTH 88° 48' 33" EAST, A DISTANCE OF 429.58 FEET TO THE WEST RIGHT-OF-WAY LINE OF CRESTWOOD BOULEVARD AS RECORDED IN OFFICIAL RECORDS BOOK 5655, PAGE 425 OF THE PUBLIC RECORDS OF PALM BEACH COUNTY, FLORIDA;
THENCE SOUTH 01° 12' 44" WEST ALONG SAID WEST RIGHT-OF-WAY LINE, A DISTANCE OF 217.14 FEET TO NORTH RIGHT-OF-WAY LINE OF STATE ROAD 80 AS SHOWN ON STATE OF FLORIDA DEPARTMENT OF TRANSPORTATION RIGHT-OF-WAY MAP, SECTION 93120-2538, SHEET 10 OF 13 (SAID NORTH RIGHT-OF-WAY LINE BEING THE NORTH LINE OF A 200.00 FOOT RIGHT-OF-WAY AND THE NORTH LINE OF THAT PARCEL OF LAND DESCRIBED IN OFFICIAL RECORDS BOOK 5463, PAGE 1340, OF THE PUBLIC RECORDS OF PALM BEACH COUNTY, FLORIDA);
THENCE NORTH 88° 48' 51" WEST, ALONG SAID NORTH RIGHT-OF-WAY LINE OF STATE ROAD 80, A DISTANCE OF 243.39 FEET TO THE BEGINNING OF A CURVE CONCAVE TO THE NORTHEAST HAVING A RADIUS OF 85,789.19 FEET AND A CENTRAL ANGLE OF 00° 40' 53";
THENCE NORTHEASTERLY ALONG THE ARC OF SAID CURVE AND SAID NORTH RIGHT-OF-WAY LINE OF STATE ROAD 80, AN ARC DISTANCE OF 1020.25 FEET;
THENCE NORTH 88° 07' 58" WEST, A DISTANCE OF 64.77 FEET TO THE EAST RIGHT-OF-WAY LINE OF FOLSOM ROAD AS SHOWN ON THE PARCEL ACQUISITION MAP FOR CRESTWOOD BOULEVARD AND FOLSOM ROAD, STATE ROAD 80 TO OKEECHOBEE BOULEVARD, PALM BEACH COUNTY PROJECT # 92500, DATED MAY 15, 1996;
THENCE NORTH 02° 16' 53" EAST ALONG SAID EAST RIGHT-OF-WAY LINE OF FOLSOM ROAD, A DISTANCE OF 25.00 FEET;
THENCE SOUTH 88° 07' 58" EAST, A DISTANCE OF 45.00 FEET;
THENCE NORTH 02° 16' 53" EAST, A DISTANCE OF 155.82 FEET;
THENCE NORTH 87° 16' 35" WEST, A DISTANCE OF 45.00 FEET TO THE EAST RIGHT-OF-WAY LINE OF SAID FOLSOM ROAD;
THENCE NORTH 02° 16' 53" EAST ALONG SAID EAST RIGHT-OF-WAY LINE OF FOLSOM ROAD, A DISTANCE OF 36.00 FEET;
THENCE SOUTH 87° 16' 35" EAST, A DISTANCE OF 45.00 FEET;
THENCE NORTH 02° 16' 53" EAST, A DISTANCE OF 248.65 FEET;
THENCE NORTH 88° 48' 33" WEST, A DISTANCE OF 45.01 FEET TO THE EAST RIGHT-OF-WAY LINE OF SAID FOLSOM ROAD;
THENCE NORTH 02° 16' 53" EAST ALONG SAID EAST RIGHT-OF-WAY LINE OF FOLSOM ROAD, A DISTANCE OF 494.37 FEET;
THENCE SOUTH 88° 45' 32" EAST, A DISTANCE OF 42.88 FEET TO THE POINT OF BEGINNING.
SAID LANDS LYING IN THE VILLAGE OF ROYAL PALM BEACH, PALM BEACH COUNTY, FLORIDA, CONTAINING 20.04 ACRES, MORE OR LESS.

IN WITNESS WHEREOF, CRESTWOOD SQUARE, LTD., A FLORIDA LIMITED PARTNERSHIP, HAS CAUSED THESE PRESENTS TO BE SIGNED AND ITS CORPORATE SEAL TO BE AFFIXED HERETO BY AND WITH THE AUTHORITY OF ITS BOARD OF DIRECTORS, THIS DAY OF 2001.

CRESTWOOD SQUARE, LTD. BY: CRESTWOOD SQUARE, INC.
A FLORIDA LIMITED PARTNERSHIP A FLORIDA CORPORATION,
ATTEST:
ACKNOWLEDGMENT BY: GERALD M. HIGIER, PRESIDENT

STATE OF FLORIDA )
COUNTY OF PALM BEACH ) SS
ACKNOWLEDGED BEFORE ME THIS 20th DAY OF Sept 2001, BY GERALD M. HIGIER AS PRESIDENT OF CRESTWOOD SQUARE, INC., A FLORIDA CORPORATION, BY AND ON BEHALF OF SAID CORPORATION AS GENERAL PARTNER OF CRESTWOOD SQUARE, LTD., A FLORIDA LIMITED PARTNERSHIP, BY AND ON BEHALF OF SAID PARTNERSHIP, HE IS PERSONALLY KNOWN TO ME.

WITNESS MY HAND AND OFFICIAL SEAL THIS 20 DAY OF Sept, 2001
MY COMMISSION EXPIRES 12-31-01
LISA L GIL
Notary Public
State of Florida
My Comm. Exp. 12/31/01
Comm# CC704230

IN WITNESS WHEREOF, ABC LIQUORS INC., A FLORIDA CORPORATION, HAS CAUSED THESE PRESENTS TO BE SIGNED AND ITS CORPORATE SEAL TO BE AFFIXED HERETO BY AND WITH THE AUTHORITY OF ITS BOARD OF DIRECTORS, THIS DAY OF 2001.

ABC LIQUORS INC. BY: CHARLES E. BAILES III, CEO
A FLORIDA CORPORATION
ATTEST:
ACKNOWLEDGMENT

STATE OF FLORIDA )
COUNTY OF PALM BEACH ) SS
BEFORE ME PERSONALLY APPEARED CHARLES E. BAILES III WHO IS PERSONALLY KNOWN TO ME AND WHO EXECUTED THE FORGOING INSTRUMENT AS CEO OF SAID CORPORATION AND SEVERALLY ACKNOWLEDGED TO AND BEFORE ME THAT THEY EXECUTED SUCH INSTRUMENT AS SUCH OFFICERS OF SAID CORPORATION, AND THAT THE SEAL AFFIXED TO THE FOREGOING INSTRUMENT IS THE CORPORATE SEAL OF SAID CORPORATION AND THAT IT WAS AFFIXED TO SAID INSTRUMENT BY DUE AND REGULAR CORPORATE AUTHORITY, AND THAT SAID INSTRUMENT IS THE FREE ACT AND DEED OF SAID CORPORATION.

WITNESS MY HAND AND OFFICIAL SEAL THIS 19th DAY OF September 2001.
MY COMMISSION EXPIRES 10-20-04
NOTARY PUBLIC Robin L. Martin

IN WITNESS WHEREOF, EXXON MOBIL CORPORATION, A NEW JERSEY CORPORATION HAS CAUSED THESE PRESENTS TO BE SIGNED AND ITS CORPORATE SEAL TO BE AFFIXED HERETO BY AND WITH THE AUTHORITY OF ITS BOARD OF DIRECTORS, THIS DAY OF 2001.

EXXON MOBIL CORPORATION BY: D. J. FISHER, ALLIANCE COORDINATOR
A NEW JERSEY CORPORATION
ATTEST:
ACKNOWLEDGMENT

STATE OF VIRGINIA )
COUNTY OF PALM BEACH ) SS
BEFORE ME PERSONALLY APPEARED D.J. FISHER WHO IS PERSONALLY KNOWN TO ME AND WHO EXECUTED THE FORGOING INSTRUMENT AS ALLIANCE COORDINATOR OF SAID CORPORATION AND SEVERALLY ACKNOWLEDGED TO AND BEFORE ME THAT THEY EXECUTED SUCH INSTRUMENT AS SUCH OFFICERS OF SAID CORPORATION, AND THAT THE SEAL AFFIXED TO THE FOREGOING INSTRUMENT IS THE CORPORATE SEAL OF SAID CORPORATION AND THAT IT WAS AFFIXED TO SAID INSTRUMENT BY DUE AND REGULAR CORPORATE AUTHORITY, AND THAT SAID INSTRUMENT IS THE FREE ACT AND DEED OF SAID CORPORATION.

WITNESS MY HAND AND OFFICIAL SEAL THIS 17th DAY OF SEPTEMBER, 2001.
MY COMMISSION EXPIRES 12/31/04
Susan Carl-Seavigny
NOTARY PUBLIC



IN WITNESS WHEREOF, ROYAL PALM BEACH COLONY LIMITED PARTNERSHIP, HAS CAUSED THESE PRESENTS TO BE SIGNED AND ITS CORPORATE SEAL TO BE AFFIXED HERETO BY AND WITH THE AUTHORITY OF ITS BOARD OF DIRECTORS, THIS DAY OF 2001.

ROYAL PALM BEACH COLONY BY: STEIN MANAGEMENT COMPANY, INC.
LIMITED PARTNERSHIP ITS MANAGING GENERAL PARTNER
ATTEST:
ACKNOWLEDGMENT BY: RANDY RIEGER, AUTHORIZED AGENT

STATE OF FLORIDA )
COUNTY OF PALM BEACH ) SS
BEFORE ME PERSONALLY APPEARED RANDY RIEGER WHO IS PERSONALLY KNOWN TO ME AND WHO EXECUTED THE FORGOING INSTRUMENT AS AUTHORIZED AGENT OF SAID CORPORATION AND SEVERALLY ACKNOWLEDGED TO AND BEFORE ME THAT THEY EXECUTED SUCH INSTRUMENT AS SUCH OFFICERS OF SAID CORPORATION, AND THAT THE SEAL AFFIXED TO THE FOREGOING INSTRUMENT IS THE CORPORATE SEAL OF SAID CORPORATION AND THAT IT WAS AFFIXED TO SAID INSTRUMENT BY DUE AND REGULAR CORPORATE AUTHORITY, AND THAT SAID INSTRUMENT IS THE FREE ACT AND DEED OF SAID CORPORATION.

WITNESS MY HAND AND OFFICIAL SEAL THIS 21 DAY OF Sept, 2001.
MY COMMISSION EXPIRES
NOTARY PUBLIC

ACCEPTANCE OF RESERVATIONS:
STATE OF FLORIDA )
COUNTY OF PALM BEACH ) SS
CRESTWOOD SQUARE, LTD., A FLORIDA LIMITED PARTNERSHIP HEREBY ACCEPTS THE DEDICATIONS OR RESERVATIONS TO SAID LIMITED PARTNERSHIP AS STATED AND SHOWN HEREON, AND HEREBY ACCEPTS ITS MAINTENANCE OBLIGATIONS FOR SAME AS STATED HEREON, DATED THIS DAY OF 2001.

CRESTWOOD SQUARE, LTD. BY: CRESTWOOD SQUARE, INC.
A FLORIDA LIMITED PARTNERSHIP A FLORIDA CORPORATION,
ATTEST:
ACKNOWLEDGMENT BY: GERALD M. HIGIER, PRESIDENT

STATE OF FLORIDA )
COUNTY OF PALM BEACH ) SS
ACKNOWLEDGED BEFORE ME THIS DAY OF 2001, BY GERALD M. HIGIER AS PRESIDENT OF CRESTWOOD SQUARE, INC., A FLORIDA CORPORATION, BY AND ON BEHALF OF SAID CORPORATION AS GENERAL PARTNER OF CRESTWOOD SQUARE, LTD., A FLORIDA LIMITED PARTNERSHIP, BY AND ON BEHALF OF SAID PARTNERSHIP, HE IS PERSONALLY KNOWN TO ME.

WITNESS MY HAND AND OFFICIAL SEAL THIS Sept. DAY OF 2001.
MY COMMISSION EXPIRES 12-21-01
NOTARY PUBLIC

NOTARY PUBLIC

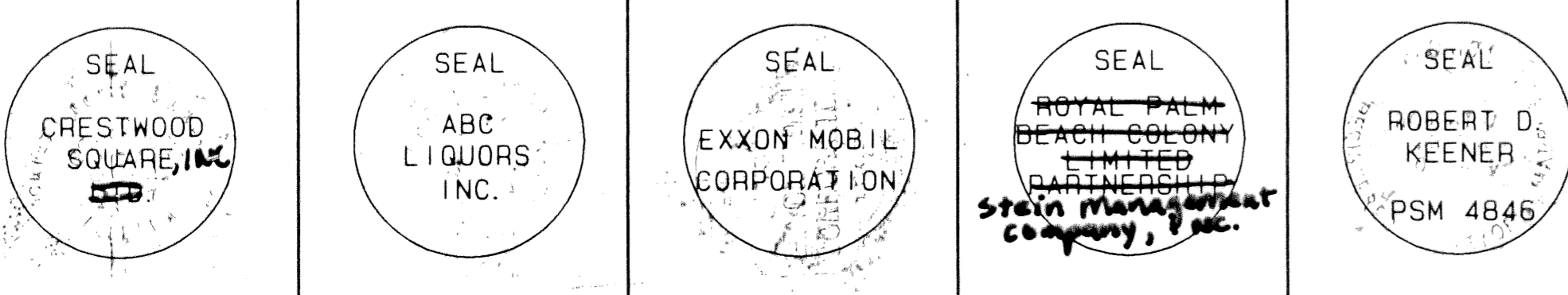

SURVEYOR'S CERTIFICATE
I HEREBY CERTIFY THAT THIS PLAT IS A TRUE AND CORRECT REPRESENTATION OF THE LANDS SURVEYED AND DESCRIBED HEREON; THAT THE SURVEY AND THIS PLAT WERE MADE UNDER MY RESPONSIBLE DIRECTION AND SUPERVISION; THAT PERMANENT REFERENCE MONUMENTS HAVE BEEN PLACED AS REQUIRED BY LAW, AND THAT PERMANENT CONTROL POINTS AND MONUMENTS, ACCORDING TO SECTION 177.091(9), FLORIDA STATUTES, WILL BE SET UNDER THE GUARANTEES POSTED WITH THE VILLAGE OF ROYAL PALM BEACH, FLORIDA FOR THE REQUIRED IMPROVEMENTS, AND FURTHER, THAT THE SURVEY DATA COMPLIES WITH ALL THE REQUIREMENTS OF CHAPTER 177, FLORIDA STATUTES, AS AMENDED, AND ORDINANCES OF THE VILLAGE OF ROYAL PALM BEACH, FLORIDA.
ROBERT D. KEENER
PROFESSIONAL SURVEYOR AND MAPPER
FLORIDA LICENSE NUMBER 4846
DATE 8/8/01

NOTICE:
THIS PLAT AS RECORDED IN ITS GRAPHIC FORM, IS THE OFFICIAL DEPICTION OF THE SUBDIVIDED LANDS DESCRIBED HEREIN AND WILL IN NO CIRCUMSTANCES BE SUPPLANTED IN AUTHORITY BY ANY OTHER GRAPHIC OR DIGITAL FORM OF THE PLAT. THERE MAY BE ADDITIONAL RESTRICTIONS THAT ARE NOT RECORDED ON THIS PLAT THAT MAY BE FOUND IN THE PUBLIC RECORDS OF THIS COUNTY.

THIS INSTRUMENT WAS PREPARED BY ROBERT D. KEENER
FLORIDA LICENSED SURVEYOR AND MAPPER, LICENSE NO. LS-4846
IN AND FOR THE OFFICE OF:
CRAIG A. SMITH & ASSOCIATES
CONSULTING ENGINEERS-PLANNERS-SURVEYORS
242 ROYAL PALM BEACH BOULEVARD
ROYAL PALM BEACH, FLORIDA 33411
(561) 751-9280
CERTIFICATE NO. EB-3190
CRESTWOOD SQUARE
PROJ NO 96-0234 CADD FILE 0234P001 DATE 08/08/01 SHEET 1 OF 4