

CARNAHAN · PROCTOR · CROSS, INC.

CONSULTING ENGINEERS · SURVEYORS · PLANNERS

6101 WEST ATLANTIC BOULEVARD, MARGATE, FLORIDA 33063
PHONE: 954-972-3959 FAX: 954-972-4178

MAY 2002

990901B

JSH

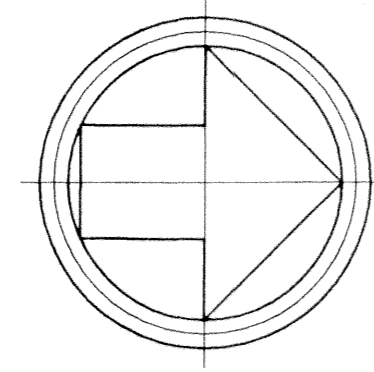

SCALE: 1" = 40'

SEE SHEET 12 OF 26
MATCH LINE

EVERGRENE P.C.D.

EVERGRENE PLAT TWO

A REPLAT OF A PORTION OF TRACT "A", "EVERGRENE" (P.B. 93, PGS. 117-119, P.B.C.R.)
CITY OF PALM BEACH GARDENS, PALM BEACH COUNTY, FLORIDA

WATER MANAGEMENT TRACT WM-3
ALSO A WME IN FAVOR OF NPBCID

TRACT S-10

TRACT C-8

BLOCK A

TRACT C-14

EVERGRENE PARKWAY

TRACT R-2

TRACT S-10

TRACT C-8

TRACT F-6

TRACT B-9

WATER MANAGEMENT TRACT WM-8

TRACT C-8

TRACT F-10

PLAT LIMITS

PLAT LIMITS

FEC RAILROAD
(R.P.B. 4, PG. 222)

LEGEND:

- SET PERMANENT REFERENCE MONUMENT (P.R.M.) LB2936 UNLESS OTHERWISE NOTED
- PERMANENT CONTROL POINT
- ⊕ CENTERLINE
- A ARC LENGTH
- A.E. ANCHOR EASEMENT
- CH CHORD
- CHB CHORD BEARING
- D DELTA (CENTRAL ANGLE)
- D.B. DEED BOOK
- D.E. DRAINAGE EASEMENT
- FPL FLORIDA POWER & LIGHT COMPANY
- IEE INGRESS EGRESS EASEMENT
- LSE LIFT STATION EASEMENT
- N.P.B.C.R. NORTHERN PALM BEACH COUNTY IMPROVEMENT DISTRICT
- N.R. NON-RADIAL
- O.R.B. OFFICIAL RECORDS BOOK
- P.C.D. PLANNED COMMUNITY DEVELOPMENT
- PG. PAGE
- P.B. PLAT BOOK
- P.B.C.R. PALM BEACH COUNTY RECORDS
- R RADIUS
- R.P.B. ROAD PLAT BOOK
- R/W RIGHT-OF-WAY
- SF SQUARE FEET
- SLE SEWER LINE EASEMENT
- SUA SEACOAST UTILITY AUTHORITY
- U.E. UTILITY EASEMENT
- WMAE WATER MANAGEMENT ACCESS EASEMENT
- WME WATER MANAGEMENT EASEMENT
- WLE WATER LINE EASEMENT

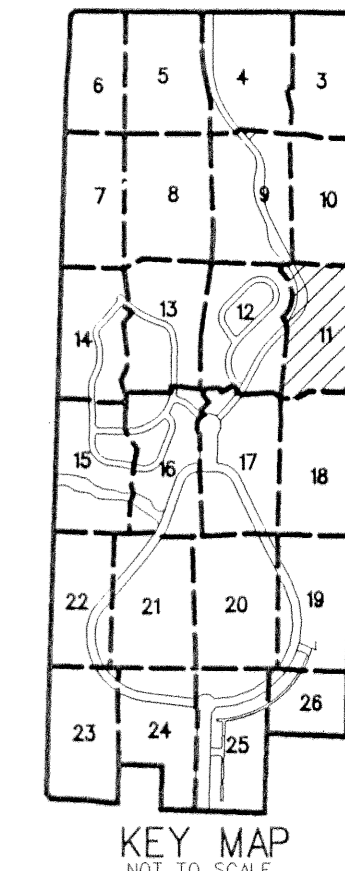

SHEET 11 OF 26

FILE: F:\990901\woodd\g\at2pp11.dgn
DATE: 16-May-02 16:16

EAST LINE SECTION 25-41-42

S01° 24' 54" W 2618.28'

FOUND BRASS DISC IN CONCRETE MONUMENT EAST 1/4 CORNER SECTION 25-41-42

N01° 24' 59" E 2618.32'