

SHEET LOCATION MAP NOT TO SCALE

MIRASOL PARCEL TWENTY-THREE

PART OF GOLF DIGEST P.C.D.
 BEING IN SECTION 03, TOWNSHIP 42 SOUTH, RANGE 42 EAST,
 CITY OF PALM BEACH GARDENS,
 PALM BEACH COUNTY, FLORIDA
 SHEET 1 OF 6

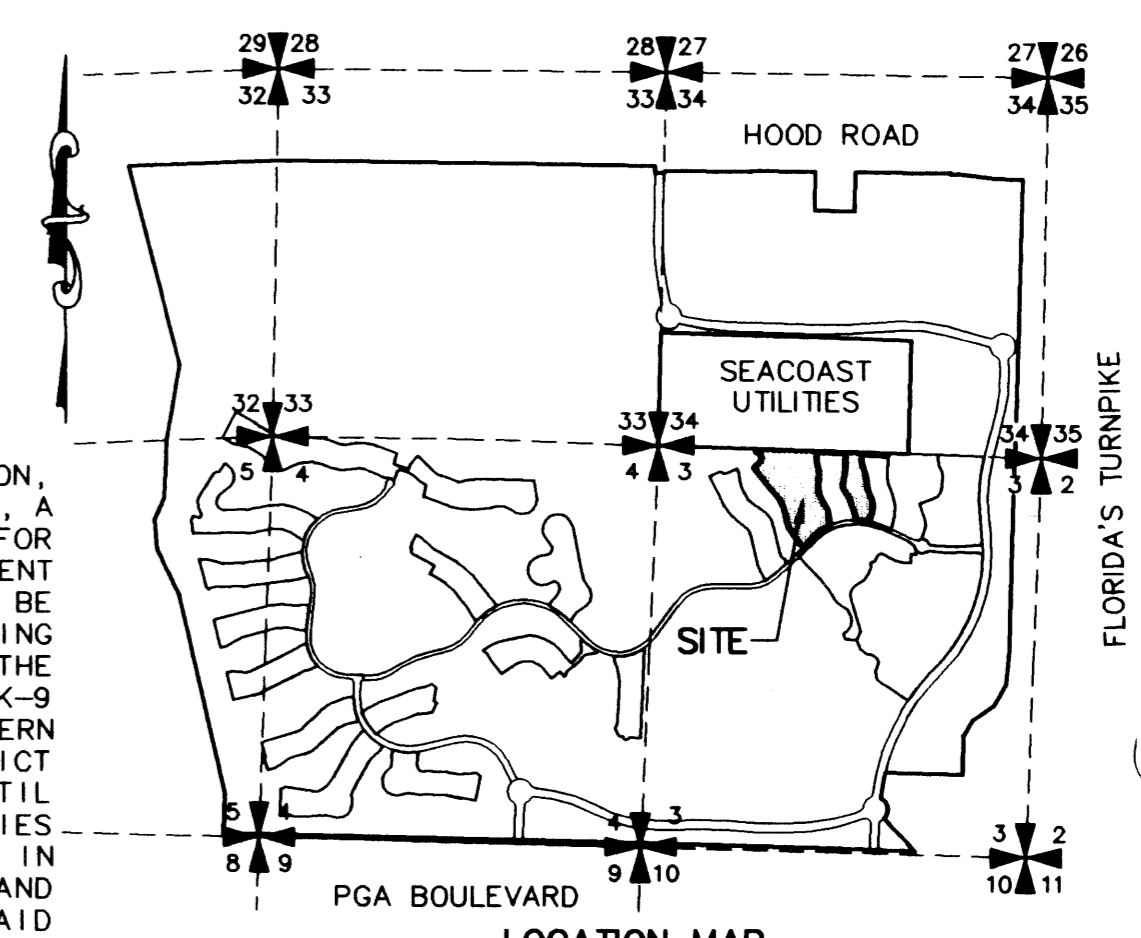

LOCATION MAP (NOT TO SCALE)

STATE OF FLORIDA
 COUNTY OF PALM BEACH

THIS PLAT WAS FILED FOR RECORD 10:43 A.M. THIS 25 DAY OF October AD, 2003 AND DULY RECORDED IN PLAT BOOK 100 ON PAGES 1 THROUGH 6

DOROTHY H. MILKEN, CLERK
 BY: *[Signature]*
 CIRCUIT COURT SEAL

DEDICATION

KNOW ALL MEN BY THESE PRESENTS THAT TAYLOR WOODROW COMMUNITIES AT MIRASOL, LTD., A FLORIDA LIMITED PARTNERSHIP, LICENSED TO DO BUSINESS IN FLORIDA, OWNER OF THE LAND SHOWN HEREON, PART OF GOLF DIGEST P.C.D., BEING IN SECTION 03, TOWNSHIP 42 SOUTH, RANGE 42 EAST, CITY OF PALM BEACH GARDENS, PALM BEACH COUNTY, FLORIDA AND SHOWN HEREON AS "MIRASOL PARCEL TWENTY-THREE", BEING MORE PARTICULARLY DESCRIBED AS FOLLOWS:

A PARCEL OF LAND SITUATE IN SECTION 03, TOWNSHIP 42 SOUTH, RANGE 42 EAST, PALM BEACH COUNTY, FLORIDA, BEING MORE PARTICULARLY DESCRIBED AS FOLLOWS:

BEGINNING AT THE SOUTHEAST CORNER OF MIRASOL PARCEL TWENTY-FOUR, ACCORDING TO THE PLAT THEREOF, AS RECORDED IN PLAT BOOK 98, PAGES 115 THROUGH 119, INCLUSIVE, OF THE PUBLIC RECORDS OF PALM BEACH COUNTY, FLORIDA, SAID POINT BEING ON THE NORTH RIGHT-OF-WAY LINE OF MIRASOL WAY, TRACT A, MIRASOL PLAT FOUR, ACCORDING TO THE PLAT THEREOF, AS RECORDED IN PLAT BOOK 94, PAGES 149 THROUGH 153, INCLUSIVE, OF SAID PUBLIC RECORDS OF PALM BEACH COUNTY, FLORIDA; THENCE DEPARTING SAID NORTH RIGHT-OF-WAY LINE AND ALONG THE EAST LINE OF SAID MIRASOL PARCEL TWENTY-FOUR, NORTH 43°53'14" WEST, A DISTANCE OF 70.00 FEET TO THE POINT OF CURVATURE OF A CURVE CONCAVE TO THE NORTHEAST HAVING A RADIUS OF 242.50 FEET; THENCE NORTHWESTERLY ALONG THE ARC OF SAID CURVE THROUGH A CENTRAL ANGLE OF 12°59'06", AN ARC DISTANCE OF 54.96 FEET TO THE POINT OF REVERSE CURVATURE OF A CURVE CONCAVE TO THE SOUTHWEST HAVING A RADIUS OF 207.50 FEET; THENCE NORTHWESTERLY ALONG THE ARC OF SAID CURVE THROUGH A CENTRAL ANGLE OF 13°14'14", AN ARC DISTANCE OF 47.94 FEET TO THE POINT OF REVERSE CURVATURE OF A CURVE CONCAVE TO THE NORTHEAST HAVING A RADIUS OF 515.00 FEET; THENCE NORTHWESTERLY ALONG THE ARC OF SAID CURVE THROUGH A CENTRAL ANGLE OF 33°51'29", AN ARC DISTANCE OF 304.33 FEET TO THE POINT OF TANGENCY; THENCE NORTH 10°16'54" WEST, A DISTANCE OF 140.87 FEET TO THE POINT OF CURVATURE OF A CURVE CONCAVE TO THE SOUTHWEST HAVING A RADIUS OF 235.00 FEET; THENCE NORTHERLY ALONG THE ARC OF SAID CURVE THROUGH A CENTRAL ANGLE OF 27°37'57", AN ARC DISTANCE OF 113.34 FEET TO THE POINT OF TANGENCY; THENCE NORTH 37°54'51" WEST, A DISTANCE OF 579.47 FEET TO THE POINT OF CURVATURE OF A CURVE CONCAVE TO THE EAST HAVING A RADIUS OF 22.00 FEET; THENCE NORTHEASTERLY ALONG THE ARC OF SAID CURVE THROUGH A CENTRAL ANGLE OF 86°52'14", AN ARC DISTANCE OF 33.36 FEET TO THE POINT OF TANGENCY; THENCE NORTH 48°57'24" EAST, A DISTANCE OF 90.20 FEET TO THE POINT OF CURVATURE OF A CURVE CONCAVE TO THE WEST HAVING A RADIUS OF 78.00 FEET; THENCE NORTHEASTERLY ALONG THE ARC OF SAID CURVE THROUGH A CENTRAL ANGLE OF 137°08'54", AN ARC DISTANCE OF 186.71 FEET; THENCE NORTH 01°48'14" EAST, A DISTANCE OF 49.59 FEET TO A POINT ON THE NORTH LINE OF THE AFOREMENTIONED SECTION 03, TOWNSHIP 42 SOUTH, RANGE 42 EAST; THENCE DEPARTING THE AFOREMENTIONED EAST LINE OF MIRASOL PARCEL TWENTY-FOUR AND ALONG SAID NORTH LINE, SOUTH 88°11'46" EAST, A DISTANCE OF 1295.14 FEET TO THE NORTH QUARTER CORNER OF SAID SECTION 03; THENCE CONTINUING ALONG SAID NORTH LINE, SOUTH 88°10'53" EAST, A DISTANCE OF 526.56 FEET TO THE NORTHWEST CORNER OF MIRASOL PARCEL TWENTY, ACCORDING TO THE PLAT THEREOF, AS RECORDED IN PLAT BOOK 92, PAGES 70 THROUGH 73, INCLUSIVE, OF THE AFOREMENTIONED PUBLIC RECORDS OF PALM BEACH COUNTY, FLORIDA; THENCE DEPARTING SAID NORTH LINE AND ALONG THE WEST LINE OF SAID MIRASOL PARCEL TWENTY, SOUTH 01°48'02" WEST, A DISTANCE OF 25.00 FEET; THENCE DEPARTING SAID WEST LINE, NORTH 88°10'53" WEST, A DISTANCE OF 362.00 FEET; THENCE SOUTH 01°48'02" WEST, A DISTANCE OF 100.35 FEET TO THE POINT OF CURVATURE OF A CURVE CONCAVE TO THE EAST HAVING A RADIUS OF 156.00 FEET; THENCE SOUTHERLY ALONG THE ARC OF SAID CURVE THROUGH A CENTRAL ANGLE OF 33°28'01", AN ARC DISTANCE OF 91.12 FEET TO THE POINT OF REVERSE CURVATURE OF A CURVE CONCAVE TO THE WEST HAVING A RADIUS OF 250.00 FEET; THENCE SOUTHEASTERLY ALONG THE ARC OF SAID CURVE THROUGH A CENTRAL ANGLE OF 31°50'12", AN ARC DISTANCE OF 138.91 FEET TO THE POINT OF REVERSE CURVATURE OF A CURVE CONCAVE TO THE EAST HAVING A RADIUS OF 522.50 FEET; THENCE SOUTHERLY ALONG THE ARC OF SAID CURVE THROUGH A CENTRAL ANGLE OF 18°59'56", AN ARC DISTANCE OF 173.26 FEET TO THE POINT OF TANGENCY; THENCE SOUTH 18°49'43" EAST, A DISTANCE OF 185.87 FEET TO THE POINT OF CURVATURE OF A CURVE CONCAVE TO THE WEST HAVING A RADIUS OF 250.00 FEET; THENCE SOUTHERLY ALONG THE ARC OF SAID CURVE THROUGH A CENTRAL ANGLE OF 47°31'23", AN ARC DISTANCE OF 207.36 FEET TO THE POINT OF TANGENCY; THENCE SOUTH 28°41'40" WEST, A DISTANCE OF 79.00 FEET TO A POINT ON THE ARC OF A NON-TANGENT CURVE CONCAVE TO THE SOUTH HAVING A RADIUS OF 830.00 FEET FROM WHICH A RADIAL LINE BEARS SOUTH 11°25'00" WEST, SAID POINT BEING ON THE AFOREMENTIONED NORTH RIGHT-OF-WAY LINE OF MIRASOL WAY; THENCE WESTERLY ALONG SAID NORTH RIGHT-OF-WAY LINE AND THE ARC OF SAID CURVE THROUGH A CENTRAL ANGLE OF 12°02'28", AN ARC DISTANCE OF 174.43 FEET; THENCE DEPARTING SAID NORTH RIGHT-OF-WAY LINE, NORTH 12°54'08" WEST, A DISTANCE OF 88.98 FEET TO THE POINT OF CURVATURE OF A CURVE CONCAVE TO THE WEST HAVING A RADIUS OF 242.50 FEET; THENCE NORTHERLY ALONG THE ARC OF SAID CURVE THROUGH A CENTRAL ANGLE OF 12°59'16", AN ARC DISTANCE OF 54.97 FEET TO THE POINT OF REVERSE CURVATURE OF A CURVE CONCAVE TO THE EAST HAVING A RADIUS OF 207.50 FEET; THENCE NORTHWESTERLY ALONG THE ARC OF SAID CURVE THROUGH A CENTRAL ANGLE OF 12°40'12", AN ARC DISTANCE OF 45.88 FEET TO THE POINT OF REVERSE CURVATURE OF A CURVE CONCAVE TO THE SOUTHWEST HAVING A RADIUS OF 565.00 FEET; THENCE NORTHERLY ALONG THE ARC OF SAID CURVE THROUGH A CENTRAL ANGLE OF 19°41'26", AN ARC DISTANCE OF 194.17 FEET TO THE POINT OF TANGENCY; THENCE NORTH 32°54'38" WEST, A DISTANCE OF 61.44 FEET TO THE POINT OF CURVATURE OF A CURVE CONCAVE TO THE EAST HAVING A RADIUS OF 135.00 FEET; THENCE NORTHWESTERLY ALONG THE ARC OF SAID CURVE THROUGH A CENTRAL ANGLE OF 45°57'54", AN ARC DISTANCE OF 108.30 FEET TO

THE POINT OF TANGENCY; THENCE NORTH 13°03'16" EAST, A DISTANCE OF 86.46 FEET TO THE POINT OF CURVATURE OF A CURVE CONCAVE TO THE WEST HAVING A RADIUS OF 565.00 FEET; THENCE NORTHERLY ALONG THE ARC OF SAID CURVE THROUGH A CENTRAL ANGLE OF 11°15'14", AN ARC DISTANCE OF 110.98 FEET TO THE POINT OF TANGENCY; THENCE NORTH 01°48'02" EAST, A DISTANCE OF 217.11 FEET; THENCE NORTH 88°11'46" WEST, A DISTANCE OF 397.00 FEET; THENCE SOUTH 01°48'02" WEST, A DISTANCE OF 100.43 FEET TO THE POINT OF CURVATURE OF A CURVE CONCAVE TO THE EAST HAVING A RADIUS OF 198.50 FEET; THENCE SOUTHERLY ALONG THE ARC OF SAID CURVE THROUGH A CENTRAL ANGLE OF 29°09'42", AN ARC DISTANCE OF 101.03 FEET TO THE POINT OF REVERSE CURVATURE OF A CURVE CONCAVE TO THE WEST HAVING A RADIUS OF 207.50 FEET; THENCE SOUTHEASTERLY ALONG THE ARC OF SAID CURVE THROUGH A CENTRAL ANGLE OF 41°12'07", AN ARC DISTANCE OF 149.22 FEET TO THE POINT OF REVERSE CURVATURE OF A CURVE CONCAVE TO THE EAST HAVING A RADIUS OF 465.00 FEET; THENCE SOUTHERLY ALONG THE ARC OF SAID CURVE THROUGH A CENTRAL ANGLE OF 46°45'06", AN ARC DISTANCE OF 379.43 FEET TO THE POINT OF TANGENCY; THENCE SOUTH 32°54'38" EAST, A DISTANCE OF 61.44 FEET TO THE POINT OF CURVATURE OF A CURVE CONCAVE TO THE SOUTHWEST HAVING A RADIUS OF 235.00 FEET; THENCE SOUTHEASTERLY ALONG THE ARC OF SAID CURVE THROUGH A CENTRAL ANGLE OF 13°01'23", AN ARC DISTANCE OF 53.41 FEET TO THE POINT OF COMPOUND CURVATURE OF A CURVE CONCAVE TO THE WEST HAVING A RADIUS OF 207.50 FEET; THENCE SOUTHERLY ALONG THE ARC OF SAID CURVE THROUGH A CENTRAL ANGLE OF 19°51'01", AN ARC DISTANCE OF 71.89 FEET TO THE POINT OF REVERSE CURVATURE OF A CURVE CONCAVE TO THE EAST HAVING A RADIUS OF 242.50 FEET; THENCE SOUTHERLY ALONG THE ARC OF SAID CURVE THROUGH A CENTRAL ANGLE OF 12°51'53", AN ARC DISTANCE OF 54.45 FEET TO THE POINT OF TANGENCY; THENCE SOUTH 12°54'08" EAST, A DISTANCE OF 88.98 FEET TO A POINT ON THE ARC OF A NON-TANGENT CURVE CONCAVE TO THE SOUTHWEST HAVING A RADIUS OF 830.00 FEET FROM WHICH A RADIAL LINE BEARS SOUTH 25°10'48" EAST, SAID POINT BEING ON THE AFOREMENTIONED NORTH RIGHT-OF-WAY LINE OF SAID MIRASOL WAY; THENCE SOUTHWESTERLY ALONG SAID NORTH RIGHT-OF-WAY LINE AND ALONG THE ARC OF SAID CURVE THROUGH A CENTRAL ANGLE OF 18°42'26", AN ARC DISTANCE OF 271.00 FEET TO THE POINT OF TANGENCY; THENCE SOUTH 46°06'46" WEST, A DISTANCE OF 217.87 FEET TO THE POINT OF BEGINNING.

CONTAINING 1,117,036.04 SQUARE FEET OR 25.64 ACRES, MORE OR LESS.

HAVE CAUSED THE SAME TO BE SURVEYED AND PLATTED AS SHOWN HEREON AND DO HEREBY DEDICATE AS FOLLOWS:

- TRACT A, AS SHOWN HEREON, IS HEREBY DEDICATED TO TRANQUILLA AT MIRASOL PROPERTY OWNERS ASSOCIATION, INC., A FLORIDA CORPORATION, NOT FOR PROFIT, ITS SUCCESSORS AND ASSIGNS, FOR PRIVATE STREET, DRAINAGE, UTILITY AND OTHER PURPOSES NOT INCONSISTENT WITH THIS DEDICATION AND IS THE PERPETUAL MAINTENANCE OBLIGATION OF SAID ASSOCIATION, ITS SUCCESSORS AND ASSIGNS, WITHOUT RECOURSE TO THE CITY OF PALM BEACH GARDENS AND WITHOUT RECOURSE TO NORTHERN PALM BEACH COUNTY IMPROVEMENT DISTRICT.
- TRACTS B AND C, AS SHOWN HEREON, ARE HEREBY DEDICATED TO TRANQUILLA AT MIRASOL PROPERTY OWNERS ASSOCIATION, INC., A FLORIDA CORPORATION, NOT FOR PROFIT, ITS SUCCESSORS AND ASSIGNS, FOR OPEN SPACE, LANDSCAPING AND SIGNAGE PURPOSES AND ARE THE PERPETUAL MAINTENANCE OBLIGATION OF SAID ASSOCIATION, ITS SUCCESSORS AND ASSIGNS, WITHOUT RECOURSE TO THE CITY OF PALM BEACH GARDENS.
- TRACTS D AND F, AS SHOWN HEREON, ARE HEREBY DEDICATED TO THE MIRASOL MASTER MAINTENANCE ASSOCIATION, INC., ITS SUCCESSORS AND ASSIGNS, FOR OPEN SPACE AND LANDSCAPE PURPOSES AND ARE THE PERPETUAL MAINTENANCE OBLIGATION OF SAID ASSOCIATION, ITS SUCCESSORS AND ASSIGNS, WITHOUT RECOURSE TO THE CITY OF PALM BEACH GARDENS.
- TRACT E AND THE 25 FEET WIDE BUFFER EASEMENT, AS SHOWN HEREON, ARE HEREBY DEDICATED TO THE MIRASOL MASTER MAINTENANCE ASSOCIATION, INC., ITS SUCCESSORS AND ASSIGNS, FOR OPEN SPACE AND LANDSCAPE PURPOSES AND ARE THE PERPETUAL MAINTENANCE OBLIGATION OF SAID ASSOCIATION, ITS SUCCESSORS AND ASSIGNS, WITHOUT RECOURSE TO THE CITY OF PALM BEACH GARDENS.
- TRACTS G AND H, AS SHOWN HEREON, ARE HEREBY DEDICATED TO THE COUNTRY CLUB AT MIRASOL COMMUNITY ASSOCIATION, INC., ITS SUCCESSORS AND ASSIGNS, FOR OPEN SPACE, PEDESTRIAN ACCESS AND LANDSCAPE PURPOSES AND ARE THE PERPETUAL MAINTENANCE OBLIGATION OF SAID ASSOCIATION, ITS SUCCESSORS AND ASSIGNS, WITHOUT RECOURSE TO THE CITY OF PALM BEACH GARDENS.
- THE UTILITY EASEMENTS (UE), AS SHOWN HEREON, ARE HEREBY DEDICATED PERPETUITY FOR THE CONSTRUCTION AND MAINTENANCE OF PUBLIC UTILITY FACILITIES, INCLUDING CABLE TELEVISION SYSTEMS. THE INSTALLATION OF CABLE TELEVISION SYSTEMS SHALL NOT INTERFERE WITH THE CONSTRUCTION AND MAINTENANCE OF OTHER PUBLIC UTILITIES.
- THE PEDESTRIAN ACCESS EASEMENTS (PAE), AS SHOWN HEREON, ARE HEREBY DEDICATED TO THE COUNTRY CLUB AT MIRASOL COMMUNITY ASSOCIATION, INC., A FLORIDA CORPORATION, NOT FOR PROFIT, ITS SUCCESSORS AND ASSIGNS, FOR PEDESTRIAN ACCESS PURPOSES AND ARE THE PERPETUAL MAINTENANCE OBLIGATION OF SAID ASSOCIATION, ITS SUCCESSORS AND ASSIGNS, WITHOUT RECOURSE TO THE CITY OF PALM BEACH GARDENS.
- A NON-EXCLUSIVE EASEMENT FOR INGRESS AND EGRESS OVER TRACT A IS HEREBY DEDICATED TO SEACOAST UTILITY AUTHORITY, ITS SUCCESSORS AND ASSIGNS, FOR ACCESS PURPOSES ONLY, SAID LAND BEING THE PERPETUAL MAINTENANCE OBLIGATION OF TRANQUILLA AT MIRASOL PROPERTY OWNERS ASSOCIATION, INC., A FLORIDA CORPORATION, NOT FOR PROFIT, ITS SUCCESSORS AND ASSIGNS. A NON-EXCLUSIVE EASEMENT ON, OVER AND UNDER TRACT A IS HEREBY DEDICATED TO SEACOAST UTILITY AUTHORITY, ITS SUCCESSORS AND ASSIGNS, FOR INSTALLATION, OPERATION AND MAINTENANCE OF WATER AND SEWER FACILITIES, AND NO ABOVE GROUND UTILITIES OR APPURTENANCES THERETO ARE TO BE CONSTRUCTED THAT WOULD OBSTRUCT OR PREVENT ACCESS OVER TRACT A.
- AN INGRESS-EGRESS EASEMENT (IEE) OVER ALL OF TRACT A, AS SHOWN HEREON, IS HEREBY DEDICATED IN PERPETUITY ON A NON-EXCLUSIVE BASIS TO THE NORTHERN PALM BEACH COUNTY IMPROVEMENT DISTRICT (NPBCID), INCLUDING ITS STAFF AND AUTHORIZED CONSULTANTS, CONTRACTORS AND AGENTS, FOR PEDESTRIAN, VEHICULAR AND EQUIPMENT INGRESS AND EGRESS TO AND FROM NPBCID WATER MANAGEMENT FACILITIES, LANDS AND EASEMENTS FOR WATER MANAGEMENT PURPOSES, WITHOUT RECOURSE TO THE CITY OF PALM BEACH GARDENS.
- AN INGRESS-EGRESS EASEMENT (IEE) OVER ALL OF TRACT A, AS SHOWN HEREON, IS HEREBY DEDICATED IN PERPETUITY ON A NON-EXCLUSIVE BASIS TO MIRASOL MASTER MAINTENANCE ASSOCIATION, INC., A FLORIDA CORPORATION, NOT FOR PROFIT, ITS SUCCESSORS AND ASSIGNS, FOR PEDESTRIAN, VEHICULAR AND EQUIPMENT INGRESS AND EGRESS WITHOUT RECOURSE TO THE CITY OF PALM BEACH GARDENS.

11. TRACTS LK-8 AND LK-9, THE WATER MANAGEMENT TRACTS AS SHOWN HEREON, ARE HEREBY DEDICATED TO MIRASOL MASTER MAINTENANCE ASSOCIATION, INC., A FLORIDA CORPORATION, NOT FOR PROFIT, ITS SUCCESSORS AND ASSIGNS, FOR WATER MANAGEMENT PURPOSES. IT IS POSSIBLE THAT, AT SOME TIME SUBSEQUENT TO THE RECORDING OF THIS PLAT, SAID TRACTS LK-8 AND LK-9 MAY BE CONVEYED WITHOUT ENCUMBRANCES AND IN FEE SIMPLE ABSOLUTE, INCLUDING SOME OR ALL OF THE IMPROVEMENTS THEN LOCATED THEREON, AS WELL AS THE RIGHT, BUT NOT THE OBLIGATION, TO MAINTAIN SAID TRACTS LK-8 AND LK-9 AND THE WATER BODIES AND SAID IMPROVEMENTS THEREON, TO THE NORTHERN PALM BEACH COUNTY IMPROVEMENT DISTRICT, AN INDEPENDENT SPECIAL DISTRICT CREATED PURSUANT TO THE LAWS OF THE STATE OF FLORIDA. UNLESS AND UNTIL SUCH CONVEYANCE OCCURS, TOGETHER WITH SUCH MAINTENANCE RESPONSIBILITIES AS MAY BE ASSUMED BY SAID DISTRICT AND SAID ACCEPTANCE IS RECORDED IN THE PUBLIC RECORDS OF PALM BEACH COUNTY, FLORIDA, SAID TRACTS LK-8 AND LK-9 SHALL BE THE PERPETUAL MAINTENANCE RESPONSIBILITY OF SAID ASSOCIATION, ITS SUCCESSORS AND ASSIGNS, WITHOUT RECOURSE TO THE DISTRICT AND WITHOUT RECOURSE TO THE CITY OF PALM BEACH GARDENS.

12. A WATER MANAGEMENT EASEMENT (WME) OVER ALL OF TRACTS LK-8 AND LK-9, AS SHOWN HEREON, IS HEREBY DEDICATED TO NORTHERN PALM BEACH COUNTY IMPROVEMENT DISTRICT (NPBCID) FOR THE CONSTRUCTION, OPERATION, INSPECTION AND MAINTENANCE OF WATER MANAGEMENT FACILITIES, THE LANDS THEREIN AND THEREUNDER BEING THE PERPETUAL MAINTENANCE RESPONSIBILITY OF MIRASOL MASTER MAINTENANCE ASSOCIATION, INC., A FLORIDA CORPORATION, NOT FOR PROFIT, ITS SUCCESSORS AND ASSIGNS, WITHOUT RECOURSE TO SAID NPBCID AND WITHOUT RECOURSE TO THE CITY OF PALM BEACH GARDENS. SAID NPBCID SHALL HAVE THE RIGHT, BUT NOT THE OBLIGATION, TO CONSTRUCT, OPERATE, INSPECT AND MAINTAIN WATER MANAGEMENT FACILITIES WITHIN THESE EASEMENTS.

ONCE CONSTRUCTION OF THE APPROPRIATE PHASE OF THE WATER MANAGEMENT SYSTEM IS COMPLETED IN ACCORDANCE WITH NORTHERN PALM BEACH COUNTY IMPROVEMENT DISTRICT'S UNIT OF DEVELOPMENT NO. 43, CERTIFIED BY A PROFESSIONAL ENGINEER AND CONVEYED IN FEE TITLE TO AND ACCEPTED BY NORTHERN PALM BEACH COUNTY IMPROVEMENT DISTRICT, THE NORTHERN PALM BEACH COUNTY IMPROVEMENT DISTRICT SHALL HAVE THE OBLIGATION TO OPERATE, INSPECT AND MAINTAIN THE WATER MANAGEMENT FACILITIES WITHIN TRACTS LK-8 AND LK-9.

13. THE WATER MANAGEMENT MAINTENANCE EASEMENTS (WMAE), AS SHOWN HEREON, ARE HEREBY DEDICATED TO NORTHERN PALM BEACH COUNTY IMPROVEMENT DISTRICT (NPBCID) FOR ACCESS AND MAINTENANCE OF ADJACENT WATER MANAGEMENT FACILITIES, SAID EASEMENTS BEING THE PERPETUAL MAINTENANCE OBLIGATION OF MIRASOL MASTER MAINTENANCE ASSOCIATION, INC., A FLORIDA CORPORATION, NOT FOR PROFIT, ITS SUCCESSORS AND ASSIGNS, WITHOUT RECOURSE TO SAID NORTHERN PALM BEACH COUNTY IMPROVEMENT DISTRICT AND WITHOUT RECOURSE TO THE CITY OF PALM BEACH GARDENS.

14. THE WATER MANAGEMENT ACCESS EASEMENTS (WMAE), AS SHOWN HEREON, ARE HEREBY DEDICATED TO NORTHERN PALM BEACH COUNTY IMPROVEMENT DISTRICT (NPBCID) FOR ACCESS TO AND FROM SAID NPBCID WATER MANAGEMENT FACILITIES, LANDS AND EASEMENTS, THE LANDS LYING UNDER SAID WATER MANAGEMENT ACCESS EASEMENTS BEING THE PERPETUAL MAINTENANCE RESPONSIBILITY OF THE COUNTRY CLUB AT MIRASOL COMMUNITY ASSOCIATION, INC., A FLORIDA CORPORATION, NOT FOR PROFIT, ITS SUCCESSORS AND ASSIGNS, WITHOUT RECOURSE TO SAID NORTHERN PALM BEACH COUNTY IMPROVEMENT DISTRICT AND WITHOUT RECOURSE TO THE CITY OF PALM BEACH GARDENS.

15. THE WATER MANAGEMENT EASEMENTS (WME) WITHIN TRACTS G AND H, AS SHOWN HEREON, ARE HEREBY DEDICATED TO NORTHERN PALM BEACH COUNTY IMPROVEMENT DISTRICT (NPBCID) FOR THE CONSTRUCTION, OPERATION, INSPECTION AND MAINTENANCE OF WATER MANAGEMENT FACILITIES, THE LANDS THEREIN AND THEREUNDER BEING THE PERPETUAL MAINTENANCE RESPONSIBILITY OF THE COUNTRY CLUB AT MIRASOL COMMUNITY ASSOCIATION, INC., A FLORIDA CORPORATION, NOT FOR PROFIT, ITS SUCCESSORS AND ASSIGNS, WITHOUT RECOURSE TO SAID NPBCID AND WITHOUT RECOURSE TO THE CITY OF PALM BEACH GARDENS. SAID NPBCID SHALL HAVE THE RIGHT, BUT NOT THE OBLIGATION, TO CONSTRUCT, OPERATE, INSPECT AND MAINTAIN WATER MANAGEMENT FACILITIES WITHIN THESE EASEMENTS.

16. THE WATER LINE EASEMENT (WLE), AS SHOWN HEREON, IS HEREBY DEDICATED TO SEACOAST UTILITY AUTHORITY, ITS SUCCESSORS AND ASSIGNS, FOR INSTALLATION, OPERATION AND MAINTENANCE OF WATER FACILITIES, SAID LANDS ENCUMBERED BY SAID EASEMENT BEING THE PERPETUAL MAINTENANCE OBLIGATION OF THE OWNER OR OWNERS OF THE FEE SIMPLE INTEREST IN SAID LANDS, THEIR SUCCESSORS AND ASSIGNS.

IN WITNESS WHEREOF, TWC/MIRASOL, INC., A FLORIDA CORPORATION, AS GENERAL PARTNER OF TAYLOR WOODROW COMMUNITIES AT MIRASOL, LTD., A FLORIDA LIMITED PARTNERSHIP, HAS CAUSED THESE PRESENTS TO BE SIGNED BY ITS VICE PRESIDENT AND ITS CORPORATE SEAL TO BE AFFIXED HERETO BY AND WITH THE AUTHORITY OF ITS BOARD OF DIRECTORS, THIS 25th DAY OF JULY, 2003.

TAYLOR WOODROW COMMUNITIES AT MIRASOL, LTD.,
 A FLORIDA LIMITED PARTNERSHIP, f/k/a TWC/GOLF DIGEST, LTD.

BY: TWC/MIRASOL, INC., A FLORIDA CORPORATION,
 f/k/a JCB GOLF VENTURES, INC.,
 AS GENERAL PARTNER OF TAYLOR WOODROW COMMUNITIES AT
 MIRASOL, LTD., A FLORIDA LIMITED PARTNERSHIP

WITNESS: *[Signature]*
 PRINT NAME: Steve N. Valle
 BY: *[Signature]*
 CRAIG A. PERNA
 VICE PRESIDENT

WITNESS: *[Signature]*
 PRINT NAME: Vincent H. Crawford
 BY: *[Signature]*
 DANIEL P. CLARK, P.E., CITY ENGINEER

SEAL
 CITY OF PALM
 BEACH GARDENS

SEAL
 TWC/MIRASOL, INC.



ACKNOWLEDGEMENT

STATE OF FLORIDA)
 COUNTY OF PALM BEACH)

BEFORE ME PERSONALLY APPEARED CRAIG A. PERNA WHO IS PERSONALLY KNOWN TO ME, OR HAS PRODUCED [Signature] AS IDENTIFICATION, AND WHO EXECUTED THE FOREGOING INSTRUMENT AS THE VICE PRESIDENT OF TWC/MIRASOL, INC., A FLORIDA CORPORATION, AS GENERAL PARTNER OF TAYLOR WOODROW COMMUNITIES AT MIRASOL, LTD., A FLORIDA LIMITED PARTNERSHIP, AND SEVERALLY ACKNOWLEDGED TO AND BEFORE ME THAT HE EXECUTED SUCH INSTRUMENT AS SUCH OFFICER OF SAID CORPORATION AND THAT THE SEAL AFFIXED TO THE FOREGOING INSTRUMENT IS THE CORPORATE SEAL OF SAID CORPORATION AND THAT IT WAS AFFIXED TO SAID INSTRUMENT BY DUE AND REGULAR CORPORATE AUTHORITY.

WITNESS MY HAND AND OFFICIAL SEAL THIS 25th DAY OF JULY, 2003.
 MY COMMISSION EXPIRES: April 26, 2005
 DATE

NOTARY PUBLIC: *[Signature]*
 PRINT NAME: Victoria Resic

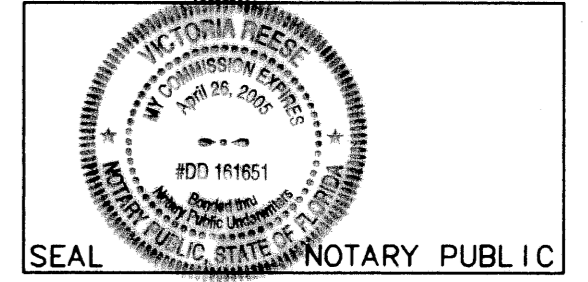

NOTARY LICENSE NO. 8D11651

APPROVALS

CITY OF PALM BEACH GARDENS
 COUNTY OF PALM BEACH, FLORIDA

THIS PLAT IS HEREBY APPROVED FOR RECORD DATED THIS 18th DAY OF September, 2003.

ATTEST: *[Signature]* BY: *[Signature]*
 PATRICIA SNIDER, CITY CLERK ERIC JABLON, MAYOR

CITY ENGINEER:
 THIS PLAT IS HEREBY ACCEPTED FOR RECORD DATED THIS 11th DAY OF September, 2003.

BY: *[Signature]*
 DANIEL P. CLARK, P.E., CITY ENGINEER

REVIEWING SURVEYOR

STATE OF FLORIDA)
 COUNTY OF PALM BEACH)

THIS PLAT HAS BEEN REVIEWED FOR CONFORMITY IN ACCORDANCE WITH CHAPTER 177.081(1) OF THE FLORIDA STATUTES AND THE ORDINANCES OF THE CITY OF PALM BEACH GARDENS. THIS REVIEW DOES NOT INCLUDE THE VERIFICATION OF THE GEOMETRIC DATA, PERMANENT CONTROL POINTS (PCP'S) OR MONUMENTS AT LOT CORNERS.

BY: *[Signature]* DATE: 3 September 2003
 O. HOWARD DUKES
 PROFESSIONAL SURVEYOR AND MAPPER LICENSE NO. LS 4533

SEAL
 REVIEWING
 SURVEYOR AND MAPPER

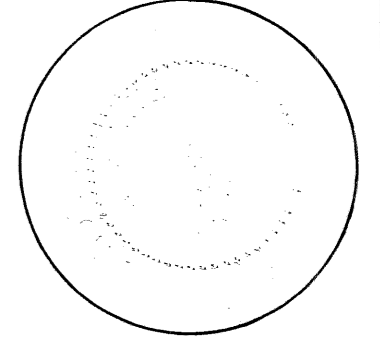

THIS INSTRUMENT WAS PREPARED BY MARY HANNA CLODFELTER, P.S.M. IN THE OFFICES OF MOCK, ROOS & ASSOCIATES, INC., 5720 CORPORATE WAY, WEST PALM BEACH, FLORIDA 33407.

SCALE: N/A	FLORIDA L.B. NO. 48
P.A. NO.: 99376.00	MOCK • ROOS ENGINEERS • SURVEYORS • PLANNERS
DATE: MARCH 2003	
DRAWING NO. 42-42-03-105	5720 Corporate Way, West Palm Beach, Florida 33407 (561) 683-3113, fax 478-7248

MIRASOL PARCEL TWENTY-THREE
 PART OF GOLF DIGEST P.C.D.
 BEING IN SECTION 03,
 TOWNSHIP 42 SOUTH, RANGE 42 EAST,
 CITY OF PALM BEACH GARDENS,
 PALM BEACH COUNTY, FLORIDA