

# DIAMOND "C" RANCH POD A REPLAT

A PLANNED UNIT DEVELOPMENT BEING A PART OF DIAMOND "C" RANCH PUD, BEING A REPLAT OF POD A, DIAMOND "C" RANCH, AS RECORDED IN PLAT BOOK 99, PAGES 173 THROUGH 179 OF THE PUBLIC RECORDS OF PALM BEACH COUNTY, FLORIDA LYING IN SECTION 6 TOWNSHIP 44 SOUTH, RANGE 42 EAST, PALM BEACH COUNTY, FLORIDA

THIS INSTRUMENT PREPARED BY  
DAVID P. LINDLEY  
OF  
CAULFIELD and WHEELER, INC.  
SURVEYORS - ENGINEERS - PLANNERS  
7301-A WEST PALMETTO PARK ROAD, SUITE 100A  
BOCA RATON, FLORIDA 33433 - (561)392-1991  
JUNE 2003  
160' FLORIDA POWER AND LIGHT EASEMENT (O.R.B. 691, PAGE 1)

0786-009

73

STATE OF FLORIDA  
COUNTY OF PALM BEACH  
THIS PLAT WAS FILED FOR  
RECORD AT \_\_\_\_\_ M.  
THIS \_\_\_\_\_ DAY OF \_\_\_\_\_  
A.D. 2003 AND DULY RECORDED  
IN PLAT BOOK \_\_\_\_\_ ON  
PAGES \_\_\_\_\_ AND \_\_\_\_\_  
DOROTHY H. WILKEN  
CLERK CIRCUIT COURT

BY: \_\_\_\_\_  
DEPUTY CLERK

SHEET 3 OF 3



MATCH LINE  
SHEET 2 OF 3

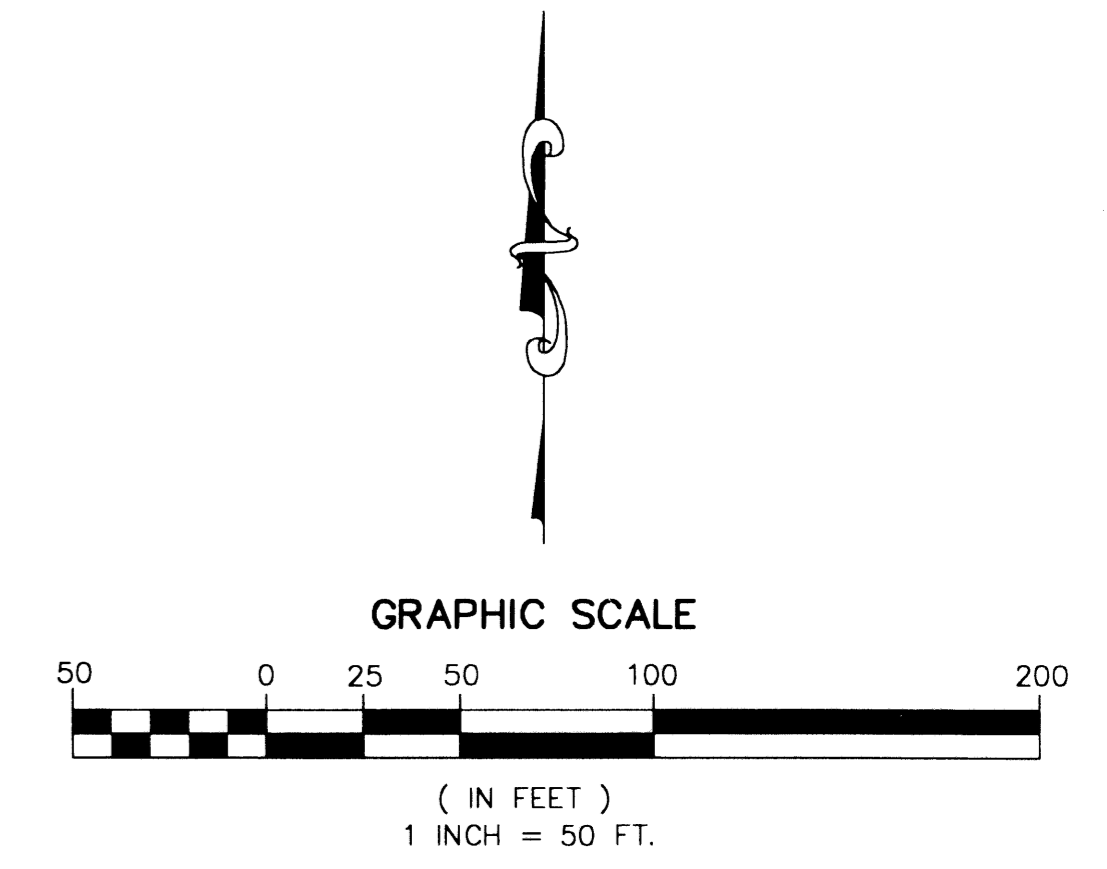

## NOTES COORDINATES, BEARINGS AND DISTANCES

COORDINATES SHOWN ARE GRID  
DATUM = NAD 83 1990 ADJUSTMENT  
ZONE = FLORIDA EAST  
LINEAR UNIT = US SURVEY FEET  
COORDINATE SYSTEM 1983 STATE PLANE  
TRANSVERSE MERCATOR PROJECTION  
ALL DISTANCES ARE GROUND  
SCALE FACTOR = 1.00002175  
GROUND DISTANCE X SCALE FACTOR = GRID DISTANCE  
BEARINGS AS SHOWN HEREON ARE GRID DATUM, NAD 83 1990  
ADJUSTMENT, FLORIDA EAST ZONE.  
N00°54'11"W (PLAT BEARING) 00°04'41" = BEARING ROTATION  
N00°58'52" (GRID BEARING) COUNTER CLOCKWISE (PLAT TO GRID)  
WEST LINE THIS PLAT

CURVE TABLE

CURVE NO.	CHORD BEARING	CHORD DISTANCE
C1	N44°07'33"E	159.81'
C2	N50°39'51"E	156.75'
C3	N10°42'10"E	100.56'

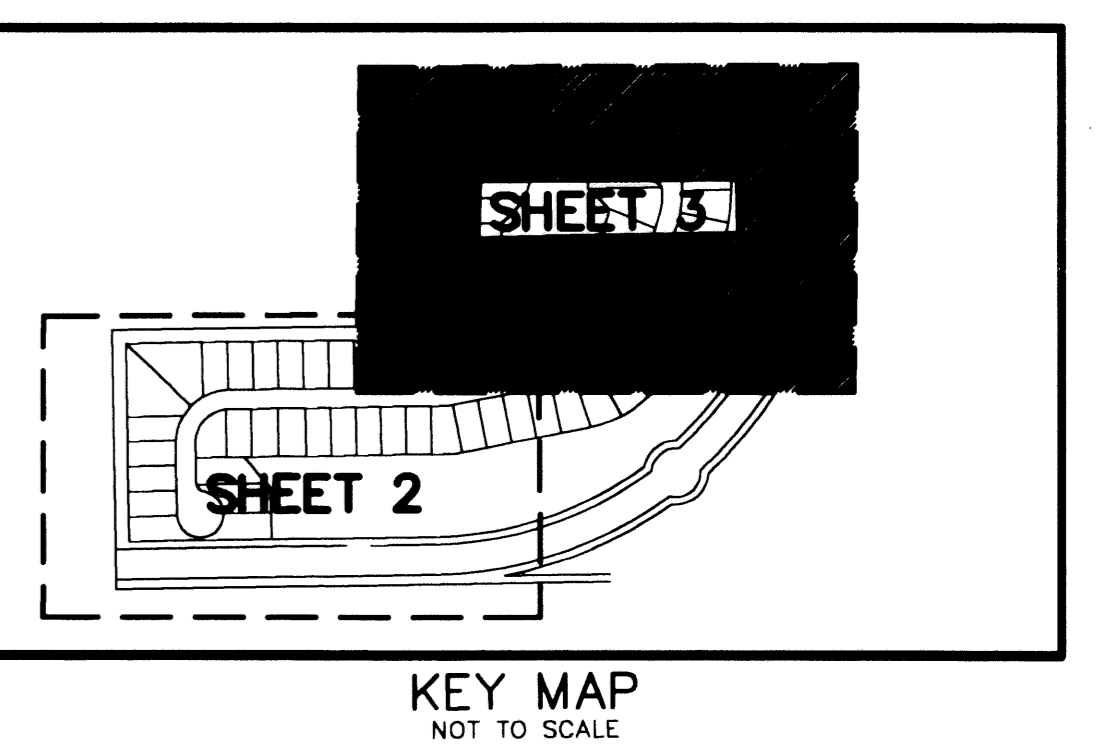

SUBDIVISION DIAMOND "C" RANCH POD A REPLAT  
BOOK 100  
PAGE 73  
FLOOD MAP #  
ZONING PUD  
QUAD # 47  
SE  
TAZ 1004  
PUD NAME DIAMOND "C" RANCH