

# PERIMETER

**SURVEYING & MAPPING**  
 Certificate of Authorization No. LB7264  
 Prepared by: Jeff S. Hodapp, P.S.M.  
 951 Broken Sound Parkway, Suite 108  
 Boca Raton, Florida 33487  
 Tel: (561) 241-9988  
 Fax: (561) 241-5182

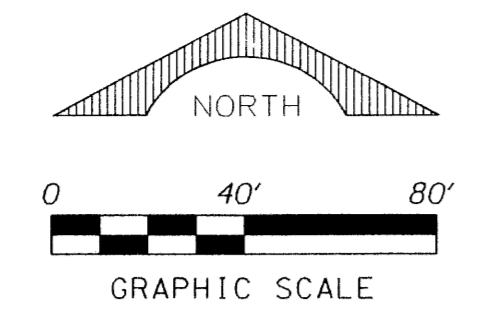

## THOUSAND OAKS

A PORTION OF THE NORTHEAST ONE-QUARTER OF SECTION 30, TOWNSHIP 42 SOUTH, RANGE 43, EAST, CITY OF RIVIERA BEACH, PALM BEACH COUNTY, FLORIDA.

- LEGEND:
- SET P.R.M. (UNLESS OTHERWISE NOTED) - 4" DIAMETER BRASS DISK IN CONC. MON. STAMPED LB7264 P.C.P.
  - CHORD BEARING
  - CHB CONCRETE CORNER
  - D DELTA (CENTRAL ANGLE)
  - D.E. DRAINAGE EASEMENT
  - I.R. IRON ROD AND CAP
  - I.R.C. ARC LENGTH
  - L.B. LICENSED BUSINESS
  - L.S. LICENSED SURVEYOR
  - L.M.A.E. LAKE MAINTENANCE EASEMENT
  - L.W.D.E. LAKE WORTH DRAINAGE DISTRICT
  - MON. MONUMENT
  - O.R.B. OFFICIAL RECORDS BOOK
  - N.R. NON-RADIAL PLAT BOOK
  - P.B. PALM BEACH COUNTY RECORDS
  - P.B.C.R. PAGE
  - P.C.P. PERMANENT CONTROL POINT
  - P.O.B. POINT OF BEGINNING
  - P.O.C. POINT OF COMMENCEMENT
  - P.R.M. PERMANENT REFERENCE MONUMENT
  - P.S.M. PROFESSIONAL SURVEYOR & MAPPER
  - P.U.D. PLANNED UNIT DEVELOPMENT
  - R.E.E. RADIUS
  - R.E.E. ROOF ENCROACHMENT EASEMENT
  - R.W. RIGHT-OF-WAY SECTION
  - SEC. SQUARE FEET
  - S.F.W.M.D. SOUTH FLORIDA WATER MANAGEMENT DISTRICT
  - U.E. UTILITY EASEMENT

SET P.R.M. (UNLESS OTHERWISE NOTED) - 4" DIAMETER BRASS DISK IN CONC. MON. STAMPED LB7264 P.C.P.

CHORD BEARING  
 CONCRETE CORNER  
 DELTA (CENTRAL ANGLE)  
 DRAINAGE EASEMENT  
 IRON ROD AND CAP  
 ARC LENGTH  
 LICENSED BUSINESS  
 LICENSED SURVEYOR  
 LAKE MAINTENANCE EASEMENT  
 LAKE WORTH DRAINAGE DISTRICT  
 MONUMENT  
 OFFICIAL RECORDS BOOK  
 NON-RADIAL PLAT BOOK  
 PALM BEACH COUNTY RECORDS  
 PAGE  
 PERMANENT CONTROL POINT  
 POINT OF BEGINNING  
 POINT OF COMMENCEMENT  
 PERMANENT REFERENCE MONUMENT  
 PROFESSIONAL SURVEYOR & MAPPER  
 PLANNED UNIT DEVELOPMENT  
 RADIUS  
 ROOF ENCROACHMENT EASEMENT  
 RIGHT-OF-WAY SECTION  
 SQUARE FEET  
 SOUTH FLORIDA WATER MANAGEMENT DISTRICT  
 UTILITY EASEMENT

### SOUTH FLORIDA WATER MANAGEMENT DISTRICT C-17 CANAL

(320' R/W, PER R/W MAP C-17-13, 9/11/79)

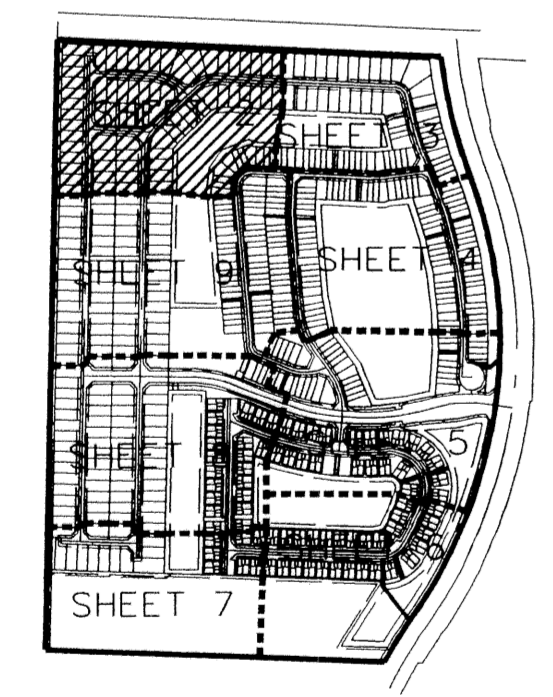

SEE SHEET 3 OF 9