

RESOLUTION NO. 84-11

A RESOLUTION OF THE CITY COUNCIL OF THE CITY OF BOYNTON BEACH, FLORIDA, REQUESTING PERMISSION FROM THE BOARD OF COUNTY COMMISSIONERS PURSUANT TO SECTION 171.062, FLORIDA STATUTES, TO REZONE A CERTAIN PARCEL OF LAND BEING ANNEXED TO THE CITY OF BOYNTON BEACH FROM PALM BEACH COUNTY ZONING CLASSIFICATION CS (SPECIALIZED COMMERCIAL) TO CITY OF BOYNTON BEACH ZONING CLASSIFICATION C-1 (OFFICE AND PROFESSIONAL COMMERCIAL DISTRICT); AND FROM PALM BEACH COUNTY LAND USE DESIGNATION OF MEDIUM TO MEDIUM-HIGH RESIDENTIAL TO CITY OF BOYNTON BEACH LAND USE DESIGNATION OF OFFICE-COMMERCIAL; PROVIDING AN EFFECTIVE DATE; AND FOR OTHER PURPOSES.

WHEREAS, the City of Boynton Beach, Florida, has received a request for annexation from Plaza West, a joint venture, as owners of the following described property, to-wit:

A parcel of land in Tracts 8 and 25, PALM BEACH FARMS COMPANY PLAT No 8, according to the plat thereof recorded in Plat Book 5, Page 73, Public Records of Palm Beach County, Florida, being more particularly described as follows.

Beginning at the point of intersection of the west line of said Tract 8 with the southerly right-of-way line of State Road S-804, as shown on plat recorded April 12, 1960, in Road Plat Book No. 2, Pages 217 through 220, Public Records of Palm Beach County, Florida; thence easterly along said southerly right-of-way line, a distance of 250 feet; thence southerly parallel to the west line of said Tract 8 and 25, a distance of 700 feet; thence westerly parallel to said southerly right-of-way line of State Road S-804, a distance of 250 feet to a point in the west line of said Tract 25; thence northerly along the west line of said Tract 25; thence northerly along the west line of said Tracts 25 and 8, a distance of 700 feet to the point of beginning.

and

WHEREAS, the City Council at the February 21, 1984 regular meeting considered this annexation request, and upon recommendation of the City Planner, the City Planning and Zoning Board and Technical Review Board, determined that the proper zoning for this parcel of land would be the City's Zoning Classification C-1 (Office and Professional Commercial District).

BOOK 342

R 84

404

751

and that the proper Land Use Classification under the City's
Land Use Plan would be Office - Commercial; and

WHEREAS, pursuant to Section 171.062, Florida Statutes,
the City of Boynton Beach requests that the Board of County
Commissioners consent to the City of Boynton Beach rezoning and
Land Use Classification of the above described property upon its
annexation

NOW, THEREFORE, BE IT RESOLVED BY THE CITY COUNCIL OF
THE CITY OF BOYNTON BEACH, FLORIDA, AS FOLLOWS:

Section 1 That the City Council hereby requests
permission to rezone and to change the Land Use Classification,
when annexed, of the property described above as previously
enumerated

Section 2. That a certified copy of this Resolution
be sent to the Board of County Commissioners of Palm Beach County,
Florida, the County Administrator, and the County Director of
Planning, Zoning and Building.

Section 3 That this Resolution shall take effect
immediately upon passage

PASSED and ADOPTED this 6th day of March,
1984.

CITY OF BOYNTON BEACH, FLORIDA

[Signature]
MAYOR

Carl Zimmerman
VICE MAYOR

[Signature]
CITY COUNCIL

[Signature]
CITY COUNCIL

ATTEST:

BOOK 342 405

Betty J. Brown
CITY CLERK

R 84 751

(Seal)

PLAZA WEST. ANNEXATION REQUEST

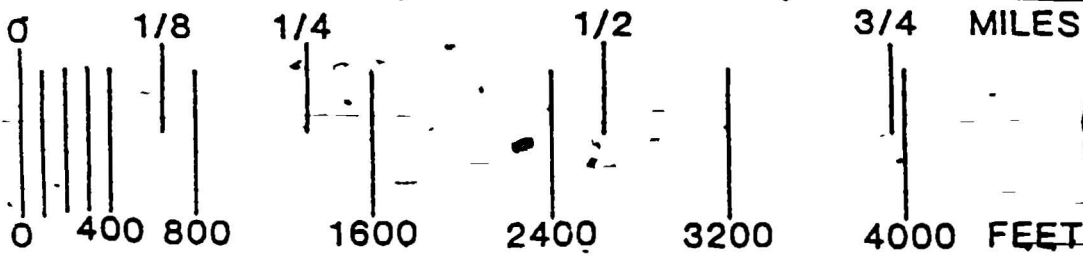
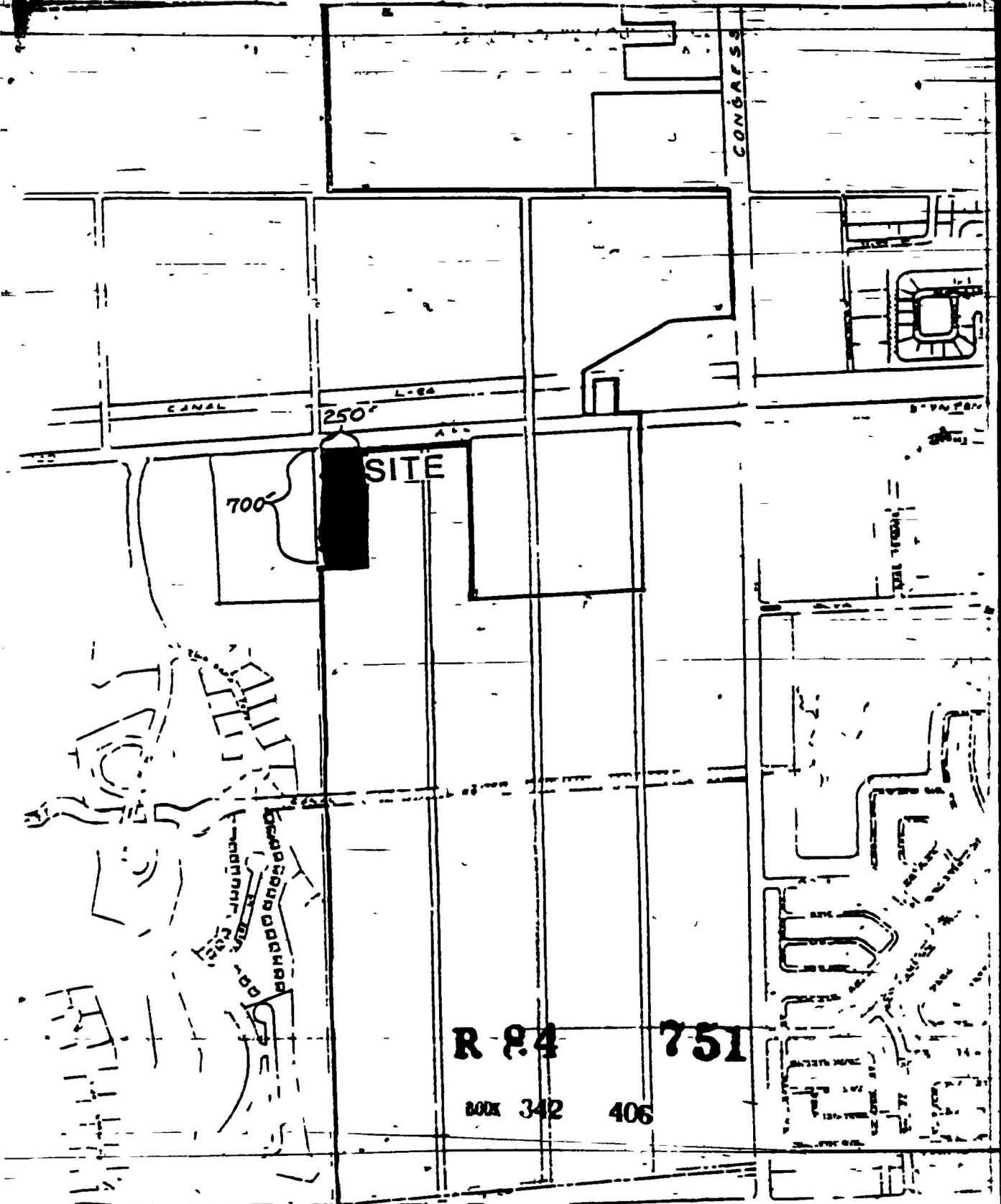

12 27 55
PLANNING DEPT