

RESOLUTION NO. R-2001- 0969

RESOLUTION CORRECTING RESOLUTION NO. R-2001-0433
RESOLUTION APPROVING ZONING PETITION OF
TUTTLE LAND HOLDING CORP
PETITION NO. PDD2000-080

WHEREAS, Tuttle Land Corp. petitioned the Palm Beach County Board of County Commissioners on March 22, 2001 for an Official Zoning Map Amendment (PDD) from Agricultural Residential (AR) to Planned Unit Development (PUD); and

WHEREAS, Resolution No. R-2001-0433 adopted March 22, 2001 confirming the action of the Board of County Commissioners, inadvertently contained an incorrect legal description; and

WHEREAS, the legal description of Resolution No. R-2001-0433 should have read as shown on Exhibit A.

NOW, THEREFORE, BE IT RESOLVED BY THE BOARD OF COUNTY COMMISSIONERS OF PALM BEACH COUNTY, FLORIDA, that:

1. The foregoing recitals are hereby affirmed and ratified.
2. The legal description of Resolution No. R-2001-0433 is hereby corrected.

Commissioner Roberts moved for the approval of the Resolution.

The motion was seconded by Commissioner McCarty, and upon being put to a vote, the vote was as follows:

Warren H. Newell, Chairman	-	Aye
Carol A. Roberts, Vice Chair	-	Aye
Karen T. Marcus		Absent
Mary McCarty		Aye
Burt Aaronson		Aye
Tony Masilotti		Aye
Addie L. Greene		Aye

The Chair thereupon declared the resolution was duly passed and adopted on June 25, 2001.

APPROVED AS TO FORM
AND LEGAL SUFFICIENCY

PALM BEACH COUNTY, FLORIDA
BY ITS BOARD OF COUNTY
COMMISSIONERS

DOROTHY H. WILKEN, CLERK

BY: *Daniel Otter*
COUNTY ATTORNEY

BY: *Joan Wilken*
DEPUTY CLERK

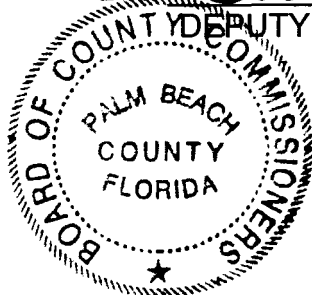

EXHIBIT A

LEGAL DESCRIPTION

LEGAL DESCRIPTION:

LOTS 1,2,3,4,6,7, & 8 BLOCK 35, PALM BEACH FARMS COMPANY PLAT NO. 3, ACCORDING TO THE PLAT THEREOF AS RECORDED IN PLAT BOOK 2, PAGE 45-54, PUBLIC RECORDS OF PALM BEACH COUNTY, FLORIDA; LESS THE NORTH 29.99 FEET OF TRACT 1, THE NORTH 29.70 FEET OF TRACTS 2 & 3, THE NORTH 29.70 FEET AND THE WEST 30.18 FEET OF TRACT 4, BLOCK 35; ALL LYING WEST OF A LINE PARALELL AND 300.00 FOOT WEST OF, AS MEASURED AT RIGHT ANGLES TO, THE WESTERLY RIGHT OF WAY LINE OF STATE ROAD 7 AS SAID RIGHT OF WAY LINE IS DESCRIBED IN ORB 10051-PAGE 1356, ORB 10036- PAGE 1655, AND ORB 10559- PAGE 1373.

PARCEL CONTAINS t OR - 57.49 ACRES.

EXHIBIT B
VICINITY SKETCH

EXHIBIT B

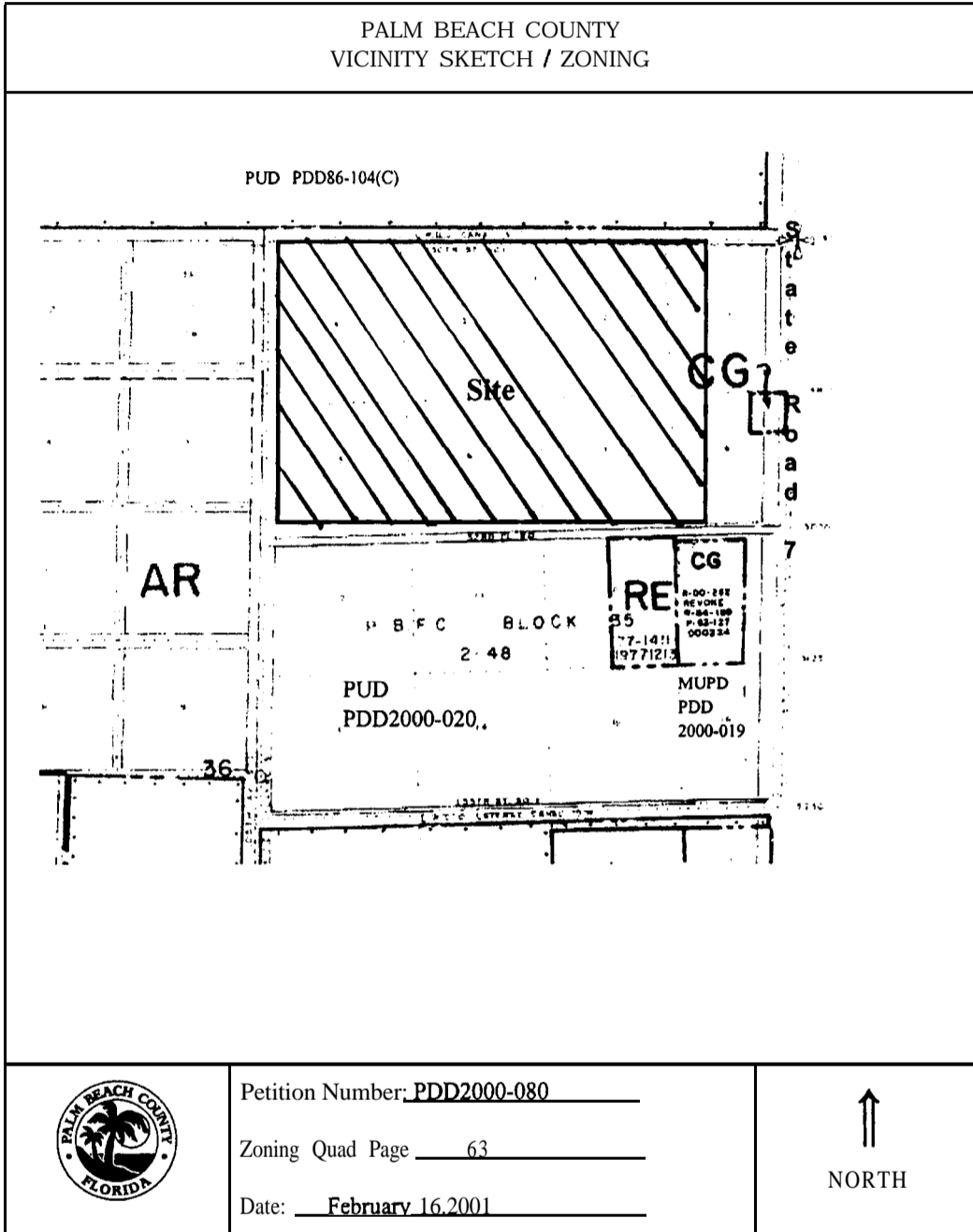

ZONING\Zoning Review\ARCHIVE\ZON-SKET.FRM