

RESOLUTION NO. R-95-858

RESOLUTION AMENDING RESOLUTION NO. R-94-1315
RESOLUTION APPROVING ZONING PETITION OF
WILLIAM GUNDLACH, JR., ABSOLUTE, INC.,
WILLIAM GUNDLACH 111, JON ERIK GUNDLACH, TR.,
PETITION NO. PDD94-24

WHEREAS, William Gundlach, Jr., Absolute, Inc., William Gundlach 111, Jon Erik Gundlach, Tr., petitioned the Palm Beach County Board of County Commissioners on September 29, 1994, for a Rezoning from the Agricultural Residential (AR) Zoning District to the Planned Unit Development (PUD) Zoning District; and

WHEREAS, Resolution No. R-94-1315 adopted September 29, 1994, confirming the action of the Board of County Commissioners, inadvertently contained an incorrect legal description and vicinity sketch; and

WHEREAS, the legal description of Resolution No. R-94-1315 should have read as shown on Exhibit A attached hereto; and

WHEREAS, the vicinity sketch of Resolution No. R-94-1315 should have been depicted as shown on Exhibit B attached hereto.

NOW, THEREFORE, BE IT RESOLVED BY THE BOARD OF COUNTY COMMISSIONERS OF PALM BEACH COUNTY, FLORIDA, that:

1. The foregoing recitals are hereby affirmed and ratified.
2. The legal description of Resolution No. R-93-1315 is hereby amended.
3. The vicinity sketch of Resolution No. R-94-1315 is hereby amended.

Commissioner Newell moved for the approval of the Resolution.

The motion was seconded by Commissioner Marcus, and upon being put to a vote, the vote was as follows:

Ken Foster, Chair	--	Aye
Burt Aaronson	--	Aye
Maude Ford Lee	--	Absent
Karen T. Marcus	--	Aye
Mary McCarty	--	Aye
Warren Newell	--	Aye
Carol A. Roberts	--	Aye

The Chair thereupon declared the resolution was duly passed and adopted this 22nd day of June, 1995.

APPROVED AS TO FORM
AND LEGAL SUFFICIENCY

PALM BEACH COUNTY, FLORIDA
BY ITS BOARD OF COUNTY
COMMISSIONERS

BY: *Barbara Altman*
COUNTY ATTORNEY

DOROTHY H. WILKEN, CLERK

BY: *Jina M. Blair*
DEPUTY CLERK

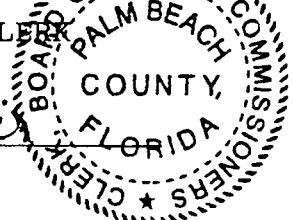

EXHIBIT A

LEGAL DESCRIPTION:

Tracts 49 to 54 inclusive and Tracts 75 to 80 inclusive, Block 49, **PALM BEACH FARMS COMPANY PLAT No. 3**, according to the plat thereof, recorded in Plat Book 2, Pages 45 to 54 of the Public Records of Palm Beach County, Florida.

LESS and **EXCEPT** the North 40 feet and the West 25 feet thereof

TOGETHER with:

A portion of Tracts 81 to 86 inclusive and Tracts 107 to 111 inclusive, Block 49 and a portion of a 30 foot wide platted road right-of-way, as shown on the **PALM BEACH FARMS COMPANY PLAT No. 3**, according to the plat thereof, recorded in Plat Book 2, Pages 45 to 54 of the Public Records of Palm Beach County, Florida, being more particularly described as follows:

BEGINNING at the Southeast corner of Tract 75, Block 49, of said **PALM BEACH FARMS COMPANY PLAT No. 3**; thence S 0°56'17" E along the Southerly prolongation of the East line of said Tract 75 and the East lines of Tracts 86 and 107 a distance of 1255.17 feet to a point on the North right-of-way line of Boynton West Road (S.R 804) according to the Florida Department of Transportation Right-of-way Map Section No. 97930-2301, dated November 29, 1988; thence S 89°03'17" W, along said right-of-way line, 719.55 feet to a tangential curve; thence along the arc of said curve concave to the North having a Radius of 7602.44 feet, a Delta of 1°16'10" and an arc distance of 168.44 feet to a reverse curve; thence along the arc of said reverse curve concave to the South having a Radius of 7676.44 feet, a Delta of 1°16'10" and an arc distance of 170.08 feet; thence S 89°03'17" W, 442.42 feet; thence N 00°56'43" W, 200.00 feet to a tangential curve; thence along the arc of said curve concave to the Southeast having a Radius of 461.33 feet, a Delta of 41°14'34" and an arc distance of 332.08 feet; thence N 40°17'51" E, 388.49 feet; thence S 89°03'17" W, 825.00 feet to a line 25.00 feet East of and parallel with the West line of said Tract 81; thence N 00°56'17" W along said parallel line, 455.29 feet to the North line of said 30 foot wide platted road right-of-way; thence N 89°03'30" E along said North road right-of-way, 1955.00 feet to the **POINT OF BEGINNING**.

Said lands lying and being in the county of Palm Beach County, Florida containing 103.50 acres



Michael D. Aviom, P.L.S.
Florida Registration No. 3268
AVIROM-HALL & ASSOCIATES, II
L.B. No. 3300

EXHIBIT B
LOCATION SKETCH

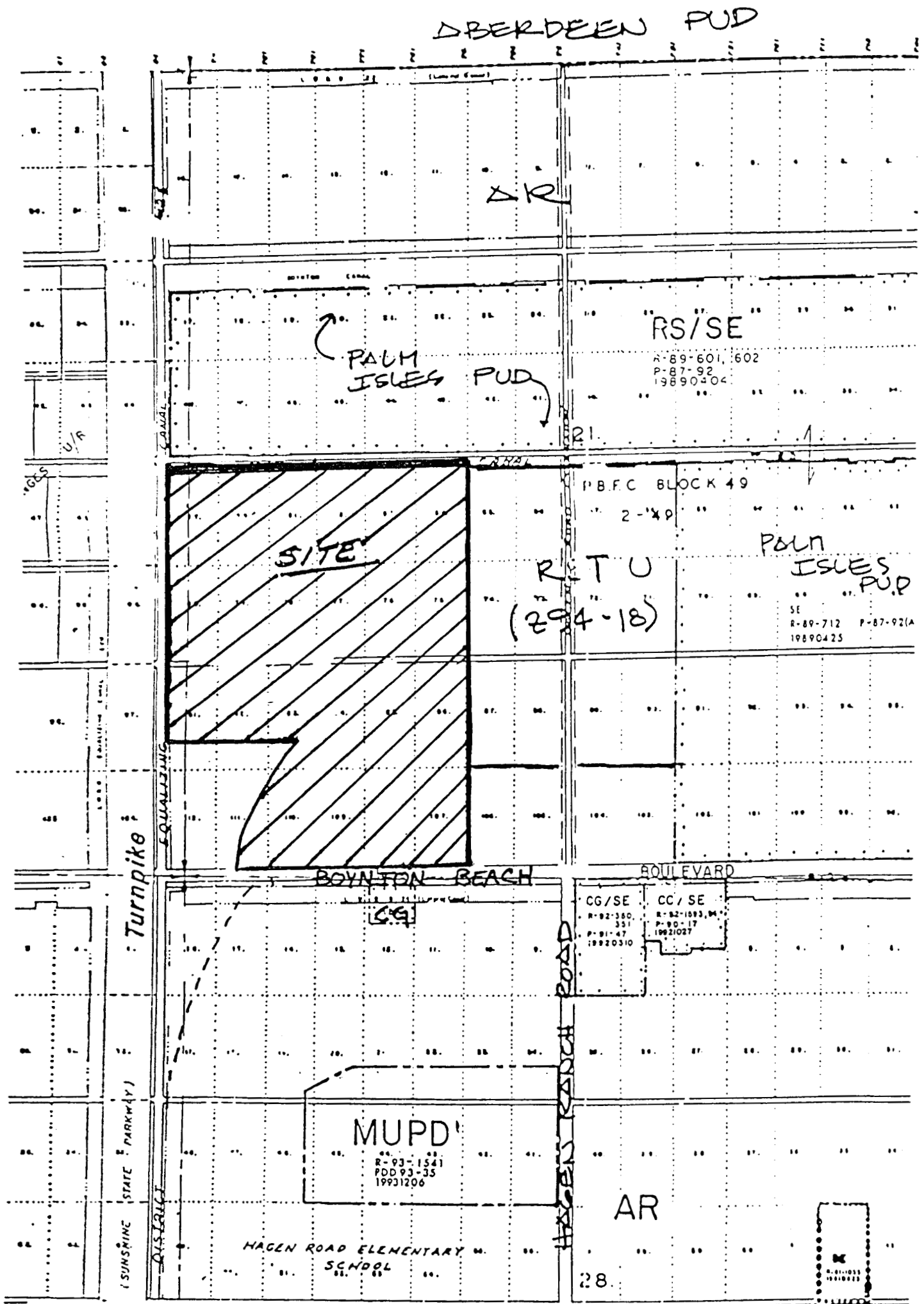

Petition No. PDD94-24