

RESOLUTION NO. R-95- 1470

RESOLUTION APPROVING ZONING PETITION CA95-62  
CLASS A CONDITIONAL USE  
PETITION OF CHARLES S. & HERNA HARRIS  
BY ARTHUR PATTERSON, AGENT

WHEREAS, the Board of County Commissioners, as the governing body of Palm Beach County, Florida, pursuant to the authority vested in Chapter 163 and Chapter 125, Florida Statutes, is authorized and empowered to consider petitions relating to zoning; and

WHEREAS, the Board of County Commissioners, pursuant to Article 5 (Development Review Procedures) of the Palm Beach County Unified Land Development Code (Ordinance 92-20, as amended) is authorized and empowered to consider, approve, approve with conditions or deny Class A Conditional Uses; and

WHEREAS, the notice and hearing requirements, as provided for in Article 5 of the Palm Beach County Unified Land Development Code have been satisfied; and

WHEREAS, Zoning Petition CA95-62 was presented to the Board of County Commissioners at a public hearing conducted on October 26, 1995; and

WHEREAS, the Board of County Commissioners has considered the evidence and testimony presented by the petitioner and other interested parties, the recommendations of the various county review agencies, and the recommendations of the Zoning Commission; and

WHEREAS, this approval is subject to Article 5, Section 5.8 (Compliance with Time Limitations) of the Palm Beach County Unified Land Development Code (ULDC) and other provisions requiring that development commence in a timely manner; and

WHEREAS, the Board of County Commissioners made the following findings of fact:

1. This Class A Conditional Use is consistent with the Palm Beach County Comprehensive Plan.
2. This Class A conditional Use complies with relevant and appropriate portions of Article 6, Supplementary Use Standards of the Palm Beach County Unified Land Development Code.
3. This Class A Conditional Use is consistent with the requirements of the Palm Beach County Unified Land Development Code.
4. This Class A Conditional Use, with conditions as adopted, is compatible as defined in the Palm Beach County Unified Land Development Code and generally consistent with the uses and character of the land surrounding and in the vicinity of the land proposed for development.
5. This Class A Conditional Use, with conditions as adopted, complies with standards imposed on it by all other applicable provisions of the Palm Beach County Unified Land Development Code for use, layout, function, and general development characteristics.
6. This Class A Conditional Use meets applicable local land development regulations.

7. This Class A Conditional Use, with conditions as adopted, minimizes adverse effects, including visual impact and intensity of the proposed use on adjacent lands.
8. This Class A Conditional Use has a concurrency reservation and therefore complies with Art. 11, Adequate Public Facility Standards of the ULDC.
9. This Class A Conditional Use, with conditions as adopted, minimizes environmental impacts, including but not limited to water, air, stormwater management, wildlife, vegetation, wetlands and the natural functioning of the environment.
10. This Class A Conditional Use, with conditions as adopted, will result in logical, timely and orderly development patterns.

WHEREAS, Article 5 of the Palm Beach County Unified Land Development Code requires that the action of the Board of County Commissioners be adopted by resolution.

NOW, THEREFORE, BE IT RESOLVED BY THE BOARD OF COUNTY COMMISSIONERS OF PALM BEACH COUNTY, FLORIDA, that Zoning Petition CA95-62, the petition of Charles S. & Herna Harris, by Arthur Patterson, Agent, for a Class A Conditional Use (CA) to allow a church or place of worship in the Single-Family Residential District (RS) Zoning District, on a parcel of land legally described in EXHIBIT A, attached hereto and made a part hereof, and generally located as shown on a vicinity sketch as indicated in EXHIBIT B, attached hereto and made a part hereof, was approved on October 26, 1995, subject to the conditions of approval described in EXHIBIT C, attached hereto and made a part hereof.

Commissioner Roberts moved for the approval of the Resolution.

The motion was seconded by Commissioner McCarty and, upon being put to a vote, the vote was as follows:

Ken Foster	--	Aye
Burt Aaronson	--	Absent
Maude Ford Lee	--	Aye
Karen T. Marcus	--	Absent
Mary McCarty	--	Aye
Warren Newell	--	Aye
Carol A. Roberts	--	Aye

The Chair thereupon declared that the resolution was duly passed and adopted this 26th day of October, 1995.

APPROVED AS TO FORM  
AND LEGAL SUFFICIENCY

PALM BEACH COUNTY, FLORIDA  
BY ITS BOARD OF COUNTY  
COMMISSIONERS

DOROTHY H. WILKEN, CLERK

BY:

  
COUNTY ATTORNEY

BY:

  
DEPUTY CLERK



LEGAL DESCRIPTION

LOTS 19 AND 20, ACCORDING TO THE PLAT OF CINQUEZ  
PARK 2ND ADDITION, AS RECORDED IN PLAT BOOK 21,  
PAGE 20, OF THE PALM BEACH COUNTY, FLORIDA PUBLIC  
RECORDS.

EXHIBIT B  
VICINITY SKETCH

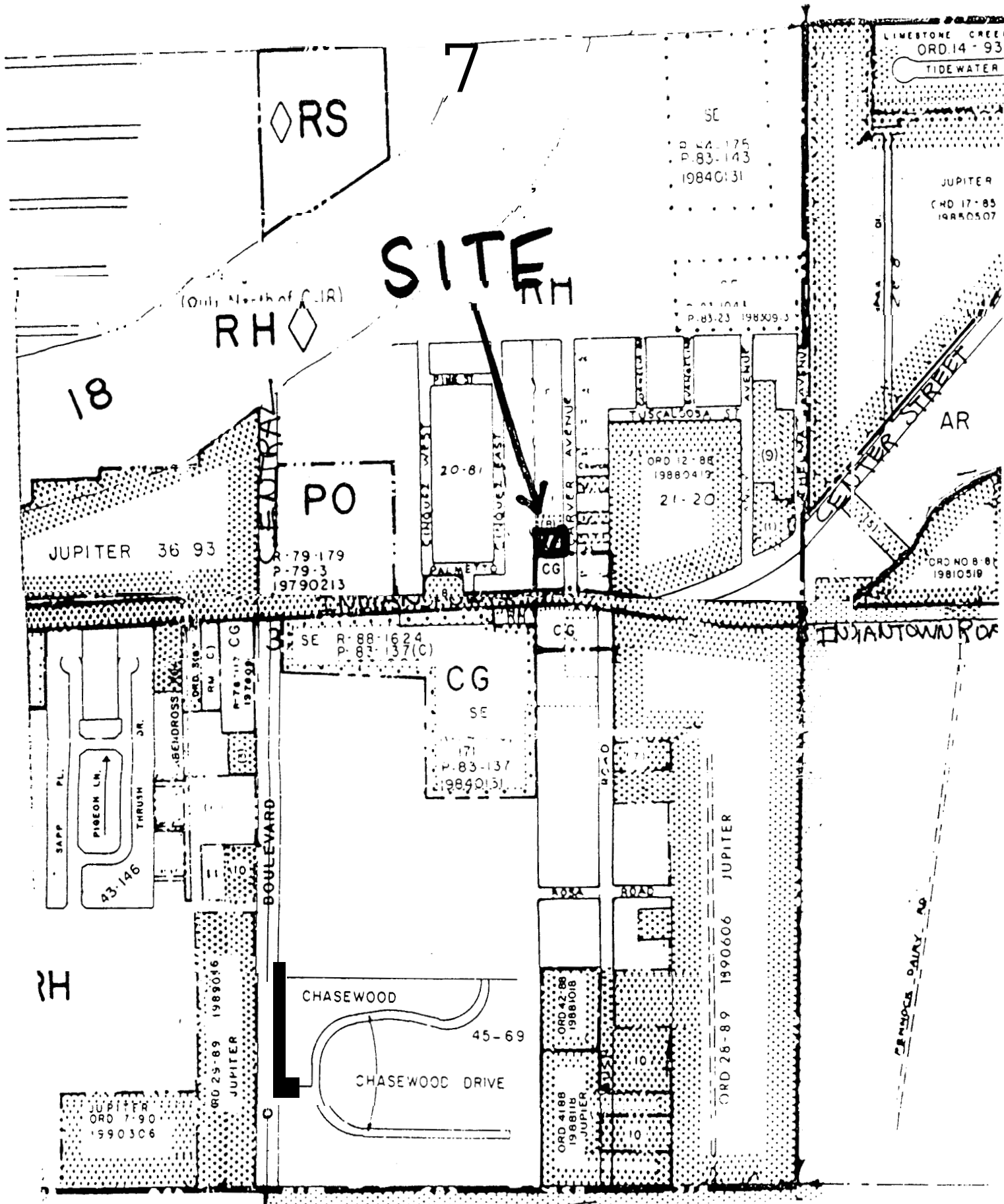

EXHIBIT C

CONDITIONS OF APPROVAL

A. USE LIMITATION

1. Use of the site shall be limited to a place of worship with a total of 36 seats. (BUILDING)

B. HEALTH

1. Application and engineering plans to construct an on site sewage treatment disposal system (OSTDS) in accordance with Chapter 10D-6 FAC and Palm Beach County ECR-I must be submitted to the Palm Beach County Public Health Unit prior to final site plan approval. (HEALTH)
2. No food preparation will be allowed on site where an OSTDS is required. (HEALTH)
3. No activity will take place on the property until an on site sewage treatment and disposal system (OSTDS) is constructed, upon availability of public water, in accordance with Chapter 10D-6 FAC and Palm Beach County ECR-I. (HEALTH)

C. LANDSCAPING

1. A minimum 10 foot wide Alternative 3 landscape buffer with a six (6) foot wall shall be installed along the western property line. (BUILDING - Zoning)
2. A minimum five (5) foot wide Alternative 1 landscape strip with a six (6) foot wall shall be installed along the north and south property lines. (BUILDING - Zoning)

D. LIGHTING

1. All outdoor lighting used to illuminate the subject property and identification signs shall be of low intensity, shielded and directed down and away from adjacent properties and streets. (BUILDING/CODE ENFORCEMENT-Zoning)
2. All outdoor lighting fixtures shall not exceed twenty five (25) feet in height, measured from finished grade to highest point. (BUILDING-Zoning)
3. All outdoor lighting shall be extinguished no later than 10:00 p.m., excluding security lighting only. (CODE ENFORCEMENT)

E. ENGINEERING

1. The Property Owner shall participate in any **street** improvement program by Palm Beach County to pave Carver Avenue. The property owners' share of costs shall be limited to their share based upon the frontage of **their** property. (BUILDING - Engineering)
2. The property owner shall pay a Fair Share Fee in the amount and manner required by the "Fair Share Contribution for Road Improvements Ordinance" as it presently exists or as it may from time to time be amended. The Fair Share Fee for this project, **Zoning** Petition **95-62**, to be paid at the time of issuance **of** the Building Permit presently is **\$1,595.00 (29 trips X \$55.00 per trip)**. (IMPACT FEE COORDINATOR)

G. SIGNS

1. The sign fronting on Carver Avenue shall be limited as follows:
  - a. Maximum sign height, measured from finished grade to highest point - six (6) feet;
  - b. Maximum sign face area per side - 32 square feet;
  - c. Maximum number of signs - one (1);
  - d. Style - monument style only. (BUILDING)

H. COMPLIANCE

1. Failure to comply with any of the conditions of approval for the subject property at any time may result in:
  - a. The issuance of a stop work order; the issuance of a cease and desist order; the denial or revocation of a building permit; the denial or revocation of a Certificate of Occupancy; the denial of any other permit, license or approval to any developer, owner, lessee, or user of the subject property; the revocation of any other permit, license or approval from any developer, owner, lessee, or user of the subject property; and/or
  - b. The revocation of the Official Map Amendment, Conditional Use, Requested Use, Development Order Amendment, and/or any other zoning approval; and/or
  - c. A requirement of the development to conform with the standards of the ULDC at the time of the finding of non-compliance, or the addition or modification of conditions reasonably related to the failure to comply with existing conditions; and/or
  - d. Referral to code enforcement; and/or
  - e. Imposition of entitlement density or intensity,

Appeals of any departmental administrative actions hereunder may be taken to the Palm Beach County Board of Adjustment or as otherwise provided in the Unified Land Development Code (ULDC), as amended. Appeals of any revocation of an Official Zoning Map Amendment, Conditional Use, Requested Use, Development Order Amendment or other actions based on a Board of County Commission decision shall be by petition for writ of certiorari to the Fifteenth Judicial Circuit. (MONITORING)