

RESOLUTION NO. R-2006-0025

RESOLUTION APPROVING ZONING APPLICATION Z2005-152
(CONTROL NO. 2005-059)
OFFICIAL ZONING MAP AMENDMENT (REZONING)
WITH A CONDITIONAL OVERLAY ZONE (COZ)
APPLICATION OF HYPOLUXO/JOG LLC
BY LAND DESIGN SOUTH, INC., AGENT
(OSPREY OAKS PARCEL #3)

WHEREAS, the Board of County Commissioners, as the governing body of Palm Beach County, Florida, pursuant to the authority vested in Chapter 163 and Chapter 125, Florida Statutes, is authorized and empowered to consider petitions relating to zoning; and

WHEREAS, the notice and hearing requirements, as provided for in Article 2 (Development Review Procedures) of the Palm Beach County Unified Land Development Code (Ordinance 2003-067), as amended, have been satisfied; and

WHEREAS, Zoning Application Z2005-152 was presented to the Board of County Commissioners at a public hearing conducted on January 5, 2006; and

WHEREAS, the Board of County Commissioners has considered the evidence and testimony presented by the petitioner and other interested parties, the recommendations of the various county review agencies, and the recommendation of the Zoning Commission; and

WHEREAS, the Board of County Commissioners has considered the findings in the staff report and the following findings of fact:

1. This official zoning map amendment (rezoning) is consistent with the Palm Beach County Comprehensive Plan;
2. This official zoning map amendment (rezoning) is consistent with the requirements of the Palm Beach County Unified Land Development Code;
3. This official zoning map amendment (rezoning) with approved conditions is compatible with surrounding uses and zones, as defined in the Palm Beach County Unified Land Development Code, is generally consistent with existing uses and zones surrounding the subject land, and is the appropriate zoning district for the land;
4. This official zoning map amendment (rezoning) with approved conditions does not result in significantly adverse impacts on the natural environment, including but not limited to water, air, stormwater management, wildlife, vegetation, wetlands, and the natural functioning of the environment;
5. This official zoning map amendment (rezoning) with approved conditions will result in a logical and orderly development pattern;
6. This official zoning map amendment (rezoning) complies with Article 2.F (CONCURRENCY - Adequate Public Facilities) of the Palm Beach County Unified Land Development Code, Ordinance 2003-067; and,
7. This official zoning map amendment (rezoning) is consistent with the requirements of all other applicable local land development regulations.

WHEREAS, Article 2.K.3.b (Action by Board of County Commissioners) of the Palm Beach County Unified Land Development Code requires that the action of the Board of County Commissioners be adopted by resolution.

NOW, THEREFORE, BE IT RESOLVED BY THE BOARD OF COUNTY COMMISSIONERS OF PALM BEACH COUNTY, FLORIDA, that Zoning Application Z2005-152 the application of Hypoluxo /Jog LLC by Land Design South, Inc., agent, for an Official Zoning Map Amendment from the Agricultural Residential Zoning District to the Residential Transitional Zoning District with a Conditional Overlay Zone on a parcel of land legally described in EXHIBIT A, attached hereto and made a part hereof, and generally located as indicated on a vicinity sketch attached as EXHIBIT B, attached hereto and made a part hereof, was approved on January 5, 2006, subject to the conditions of the CONDITIONAL OVERLAY ZONE described in EXHIBIT C, attached hereto and made a part hereof.

Commissioner Aaronson moved for the approval of the Resolution.

The motion was seconded by Commissioner Newell and, upon being put to a vote, the vote was as follows:

Tony Masilotti, Chair	-	Aye
Addie L. Greene, Vice Chairperson	-	Aye
Karen T. Marcus	-	Aye
Jeff Koons	-	Absent
Warren H. Newell	-	Aye
Mary McCarty	-	Aye
Burt Aaronson	-	Aye

The Chairman thereupon declared that the resolution was duly passed and adopted on January 5, 2006.

Filed with the Clerk of the Board of County Commissioners on 5th day of January, 2006.

This resolution is effective when filed with the Clerk of the Board of County Commissioners.

APPROVED AS TO FORM
AND LEGAL SUFFICIENCY

PALM BEACH COUNTY, FLORIDA
BY ITS BOARD OF COUNTY
COMMISSIONERS

SHARON R. BOCK,
CLERK & COMPTROLLER

BY:

COUNTY ATTORNEY

BY:

DEPUTY CLERK



EXHIBIT A
LEGAL DESCRIPTION

Parcel A – 00-42-45-10-01-006-0032

The West half of the East half of the Northwest quarter of the Southeast quarter of the Northwest quarter of Section 11, Township 45 South, Range 42 East, EXCEPT the South 30 feet and the North 25 feet for road and canal purposes. Otherwise described as the West Half of Lot 3, Block 6, Palm Beach Ranches (unrecorded).

Parcel B – 00-42-45-10-01-006-0040

The West $\frac{1}{2}$ of the Northwest $\frac{1}{4}$ of the Southeast $\frac{1}{4}$ of the Northwest $\frac{1}{4}$ of Section 11, Township 45 South, Range 42 East, of Palm Beach County, Florida, EXCEPT the South 30 feet and the North 25 feet for road and canal purposes. Otherwise described as the West Half of Lot 4, Block 6, Palm Beach Ranches (unrecorded).

Said lands situate, lying and being in Palm Beach County, Florida.

Total area comprising of 7.265 acres, more or less.

EXHIBIT B
VICINITY SKETCH

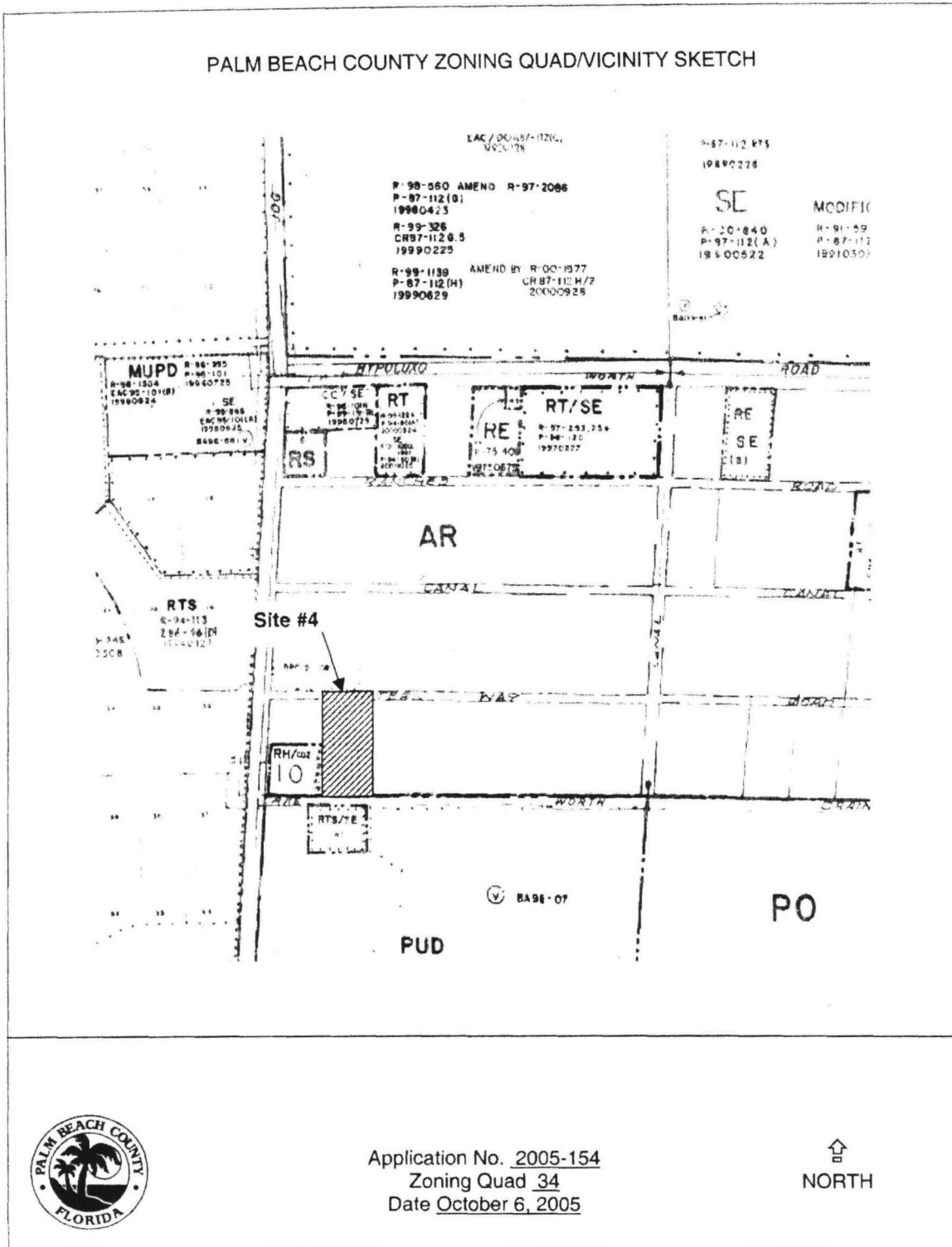

Application No. 2005-154
Zoning Quad 34
Date October 6, 2005



EXHIBIT C

CONDITIONS OF APPROVAL

ENGINEERING

1. TRAFFIC PERFORMANCE STANDARDS PHASING REQUIREMENTS

In order to comply with the mandatory Traffic Performance Standards, the Developer shall be restricted to the following phasing schedule:

No Building Permits for the site may be issued after October 27, 2008. A time extension for this condition may be approved by the County Engineer based upon an approved Traffic Study which complies with Mandatory Traffic Performance Standards in place at the time of the request. This extension request shall be made pursuant to the requirements of Article 2 Section E of the Unified Land Development Code. (DATE: MONITORING-Eng)

2. PLATTING REQUIREMENTS

Any subdivision of this parcel, Osprey Oaks Parcel 3, Zoning Application Z2005-152, shall be combined with the adjacent parcel, Oaks Parcel 2, Application Z2005-149. The combined subdivision plat shall then have only one (1) homeowners association and shall be permitted only one (1) joint access road onto Western Way. (PLAT: ENG - ENG)

3. PUBLIC SEWER CONNECTION

Prior to plat recordation, the property owner shall provide information to the Land Development Division and Palm Beach County Health Department on the availability of public sewer to the site. If public sewer is available within 1/2 mile of this site, then no septic tank permits shall be issued, and the site shall be required to connect to the public sewer. (BLDG. PERMIT: MONITORING-Eng)

ENVIRONMENTAL

1. All existing native vegetation, including understory, depicted on the site plan to remain shall be maintained in perpetuity. Areas where existing native vegetation have been incorporated into the site plan shall be maintained free from invasive, exotic and non-native species. No grade changes, or the toe of proposed grade changes, shall occur within the dripline of existing native vegetation depicted to remain. (ONGOING:ERM-ERM)

PARKS

1. Per U.L.D.C. Article 5.D.2.B.5., in lieu of providing recreational amenities on site this petition is required to contribute \$2,737.59 prior to plat approval for the acquisition and improvement of community or neighborhood parks within a 5 mile radius of this petition. (PLAT:MONITORING-Parks)

SCHOOL BOARD

1. The property owner shall post a notice of annual boundary school assignments for students from this development. A sign 11" X 17" shall be posted in a clear and visible location in all sales offices and models with the following:

"NOTICE TO PARENTS OF SCHOOL AGE CHILDREN"

School age children may not be assigned to the public school closest to their residences. School Board policies regarding levels of service or other boundary policy decisions affect school boundaries. Please contact the Palm Beach County School District Boundary Office at (561) 434-8100 for the most current school assignment(s). (ONGOING: SCHOOL BOARD-School Board)

SITE DESIGN

1. The site shall be limited to a maximum of four (4) residential lots. Each residential lot shall be no less than one (1) acre in size. (PLAT: ZONING - Zoning)

UTILITIES

1. If any relocations/modifications to the County's existing facilities are required that are a direct or indirect result of the development, the developer shall pay for the complete design and construction costs associated with these relocations/modifications. (ONGOING:WUD-WUD)

COMPLIANCE

1. In granting this approval, the Board of County Commissioners relied upon the oral and written representations of the petitioner both on the record and as part of the application process. Deviations from or violation of these representations shall cause the approval to be presented to the Board of County Commissioners for review under the compliance condition of this approval. (ONGOING: MONITORING - Zoning)
2. Failure to comply with any of the conditions of approval for the subject property at any time may result in:
 - a. The issuance of a stop work order; the issuance of a cease and desist order; the denial or revocation of a building permit; the denial or revocation of a Certificate of Occupancy; the denial of any other permit, license or approval to any developer, owner, lessee, or user of the subject property; the revocation of any other permit, license or approval from any developer, owner, lessee, or user of the subject property; revocation of any concurrency; and/or
 - b. The revocation of the Official Map Amendment, Conditional Use, Requested Use, Development Order Amendment, and/or any other zoning approval; and/or
 - c. A requirement of the development to conform with the standards of the ULDC at the time of the finding of non-compliance, or the addition or modification of conditions reasonably related to the failure to comply with existing conditions; and/or
 - d. Referral to code enforcement; and/or
 - e. Imposition of entitlement density or intensity.

Staff may be directed by the Executive Director of PZ&B or a Code Enforcement Special Master to schedule a Status Report before the body which approved the Official Zoning Map Amendment, Conditional Use, Requested Use, Development Order Amendment, and/or other zoning approval, in accordance with the provisions of Article 2.E of the ULDC, in response to any flagrant violation and/or continued violation of any condition of approval.

Appeals of any departmental administrative actions hereunder may be taken to the Palm Beach County Board of Adjustment or as otherwise provided in the Unified Land Development Code (ULDC), as amended. Appeals of any revocation of an Official Zoning Map Amendment, Conditional Use, Requested Use, Development Order Amendment or other actions based on a Board of County Commission decision shall be by petition for writ of certiorari to the Fifteenth Judicial Circuit. (ONGOING: MONITORING - Zoning)