

RESOLUTION NO. R-2006- 0522

RESOLUTION APPROVING ZONING APPLICATION PDD2005-1233
(CONTROL NO. 2005-452)
OFFICIAL ZONING MAP AMENDMENT
TO A PLANNED DEVELOPMENT DISTRICT (PDD)
APPLICATION OF PARAMOUNT HAGAN, LLC,
BY BASEHART CONSULTING, INC., AGENT
(WYNDSONG RANCH)

WHEREAS, the Board of County Commissioners, as the governing body of Palm Beach County, Florida, pursuant to the authority vested in Chapter 163 and Chapter 125, Florida Statutes, is authorized and empowered to consider petitions relating to zoning; and

WHEREAS, the notice and hearing requirements, as provided for in Article 2 (Development Review Procedures) of the Palm Beach County Unified Land Development Code (Ordinance 2003-067), as amended, have been satisfied; and

WHEREAS, Zoning Application PDD2005-1233 was presented to the Board of County Commissioners at a public hearing conducted on March 23, 2006; and,

WHEREAS, the Board of County Commissioners has considered the evidence and testimony presented by the petitioner and other interested parties, the recommendations of the various county review agencies, and the recommendation of the Zoning Commission; and

WHEREAS, the Board of County Commissioners has considered the findings in the staff report and the following findings of fact:

1. This official zoning map amendment (rezoning) is consistent with the Palm Beach County Comprehensive Plan;
2. This official zoning map amendment (rezoning) is consistent with the requirements of the Palm Beach County Unified Land Development Code;
3. This official zoning map amendment (rezoning) with approved conditions is compatible with surrounding uses and zones, as defined in the Palm Beach County Unified Land Development Code, is generally consistent with existing uses and zones surrounding the subject land, and is the appropriate zoning district for the land;
4. This official zoning map amendment (rezoning) with approved conditions does not result in significantly adverse impacts on the natural environment, including but not limited to water, air, stormwater management, wildlife, vegetation, wetlands, and the natural functioning of the environment;
5. This official zoning map amendment (rezoning) with approved conditions will result in a logical and orderly development pattern;
6. This official zoning map amendment (rezoning) complies with Article 2.F, (Adequate Public Facilities) of the Palm Beach County Unified Land Development Code, Ordinance 2003-067; and,
7. This official zoning map amendment (rezoning) with approved conditions is consistent with the requirements of all other applicable local land development regulations.

WHEREAS, Article 2.K.3.b (Action by Board of County Commissioners) of the Palm Beach County Unified Land Development Code requires that the action of the Board of County Commissioners be adopted by resolution.

NOW, THEREFORE, BE IT RESOLVED BY THE BOARD OF COUNTY COMMISSIONERS OF PALM BEACH COUNTY, FLORIDA, that Zoning Application PDD2005-1233, the application of Paramount Hagan, LLC, by Basehart Consulting, Inc., agent, for an Official Zoning Map Amendment to a Planned Development District from the Residential Transitional Suburban Zoning District to the Residential Planned Unit Development District on a parcel of land legally described in EXHIBIT A, attached hereto and made a part hereof, and generally located as indicated on a vicinity sketch attached as EXHIBIT B, attached hereto and made a part hereof, was approved on March 23, 2006, subject to the conditions of approval described in EXHIBIT C, attached hereto and made a part hereof.

Commissioner Aaronson moved for the approval of the Resolution.

The motion was seconded by Commissioner Greene and, upon being put to a vote, the vote was as follows:

Tony Masilotti, Chair	-	Aye
Addie L. Greene, Vice Chairperson	-	Aye
Karen T. Marcus	-	Absent
Jeff Koons	-	Aye
Warren H. Newell	-	Absent
Warren H. Newell	-	Aye
Mary McCarty	-	Aye
Burt Aaronson	-	

The Chairman thereupon declared that the resolution was duly passed and adopted on March 23, 2006.

Filed with the Clerk of the Board of County Commissioners on 10th day of April, 2006

This resolution is effective when filed with the Clerk of the Board of County Commissioners.

APPROVED AS TO FORM
AND LEGAL SUFFICIENCY

PALM BEACH COUNTY, FLORIDA
BY ITS BOARD OF COUNTY
COMMISSIONERS

SHARON R. BOCK,
CLERK & COMPTROLLER

BY: [Signature]
COUNTY ATTORNEY

BY: [Signature]
DEPUTY CLERK

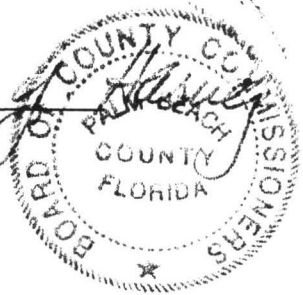

EXHIBIT A
LEGAL DESCRIPTION

ALL OF RARE SPECIES NURSERY, AS RECORDED IN PLAT BOOK 84, PAGE 154,
PUBLIC RECORDS OF PALM BEACH COUNTY, FLORIDA.

TOGETHER WITH:

TRACTS 72, 71 AND THE WEST 30 FEET OF TRACT 70, INCLUSIVE, BLOCK 58, PALM
BEACH FARMS COMPANY PLAT NO. 3, ACCORDING TO THE PLAT THEREOF, AS
RECORDED IN PLAT BOOK 2, PAGES 45 THROUGH 54, OF THE PUBLIC RECORDS
OF PALM BEACH COUNTY, FLORIDA, LESS AND EXCEPT THE NORTH 70 FEET
THEREOF AND THE WEST 30 FEET OF SAID TRACT 72, BLOCK 58.

SAID LANDS SITUATE IN PALM BEACH COUNTY, FLORIDA.
CONTAINING 715,099 SQUARE FEET OR 16.439 ACRES, MORE OR LESS.
SUBJECT TO EASEMENTS, RESTRICTIONS, RESERVATIONS, COVENANTS AND
RIGHTS-OF-WAY OF RECORD.

EXHIBIT B
VICINITY SKETCH

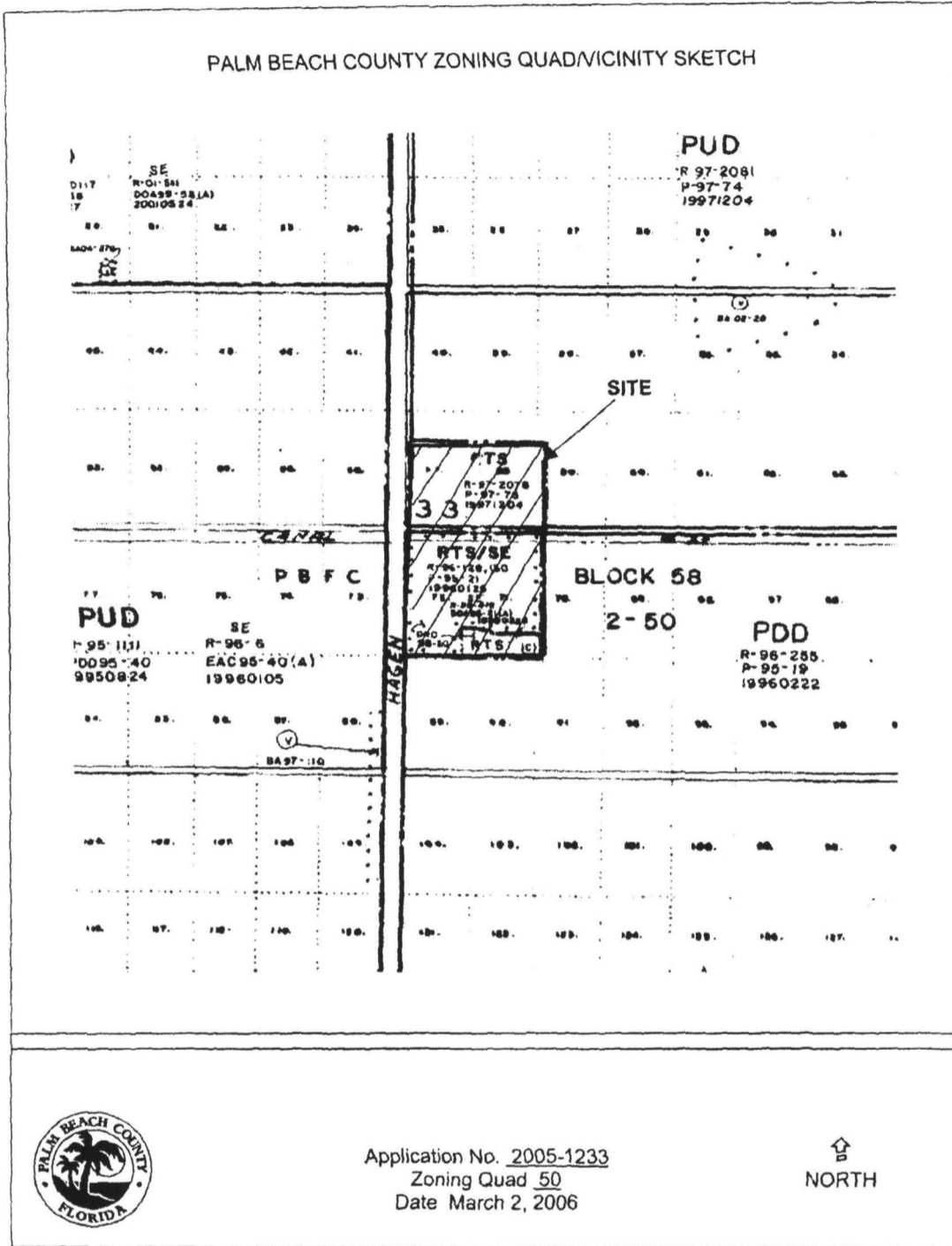

EXHIBIT C

CONDITIONS OF APPROVAL

ALL PETITIONS

1. Development of the site is limited to the site design approved by the Board of County Commissioners. The approved master plan is dated January 13, 2006. All modifications must be approved by the Board of County Commissioners or Zoning Commission unless the proposed changes are required to meet conditions of approval or are in accordance with the ULDC. (DRO: ZONING - Zoning)

ARCHITECTURAL REVIEW

1. Prior to final approval by the Development Review Officer (DRO), architectural elevations for any project signage, gatehouse, school bus shelter, entry feature, and cabana/pool area shall be submitted for review and approval by the Architectural Review Section. All elevations shall be:
 - a. given a similar architectural treatment that is generally consistent with the architectural character of the residential units; and,
 - b. reflected on the Regulating Plan. (DRO: ARCH REVIEW - Zoning)

ENGINEERING

1. In order to comply with the mandatory Traffic Performance Standards, the Property owner shall be restricted to the following phasing schedule:

No Building Permits for the site may be issued after January 1, 2009. A time extension for this condition may be approved by the County Engineer based upon an approved Traffic Study which complies with Mandatory Traffic Performance Standards in place at the time of the request. This extension request shall be made pursuant to the requirements of Article 2, Section E of the Unified Land Development Code. (DATE: MONITORING-Eng)
2. On or before June 1, 2007 the property owner shall convey to Palm Beach County sufficient road drainage easement(s) through the project's internal drainage system, as required by and approved by the County Engineer, to provide legal positive outfall for runoff from those segments of Hagen Ranch Road along the property frontage; and a maximum 800 feet of these adjacent roadway(s). The limits of this additional 800 feet of drainage shall be determined by the County Engineer. Said easements shall be no less than 20 feet in width. Portions of such system not included within roadways or waterways dedicated for drainage purposes will be specifically encumbered by said minimum 20 foot drainage easement from the point of origin, to the point of legal positive outfall. The drainage system within the project shall have sufficient retention/detention, Compensating storage within this projects retention system as required by all permitting agencies, and conveyance capacity to meet the storm water discharge and treatment requirements of Palm Beach County and the applicable Drainage District, as well as the South Florida Water Management District, for the combined runoff from the project to accommodate the ultimate Thoroughfare Plan Road Section(s) of the included segment. If required and approved by the County Engineer the property owner shall construct within the proposed drainage easements a minimum of 24 inch closed piping system and appropriate wingwall or other structures as required by and approved by the County Engineer. Elevation and location of the entire drainage system shall be approved by the County Engineer. Any and all excess fill material from excavation by Palm

Beach County within said easements shall become the property of Palm Beach County which at its discretion may use this fill material. (DATE:MONITORING-Eng)

3. Landscape Within the Median of Hagen Ranch Road

- A. The property owner shall design, install and perpetually maintain the median landscaping within the median of all abutting right of way of Hagen Ranch Road. This landscaping and irrigation shall strictly conform to the specifications and standards for the County's Only Trees, Irrigation, and Sod (OTIS) program. Additional landscaping beyond OTIS requires Board of County Commissioner's approval. Median landscaping installed by property owner shall be perpetually maintained by the property owner, his successors and assigns, without recourse to Palm Beach County, unless property owner provides payment for maintenance as set forth in Paragraph d below.
 - B. The necessary permit(s) for this landscaping and irrigation shall be applied for prior to the issuance of the first building permit. (BLDG PERMIT: MONITORING-Eng)
 - C. All installation of the landscaping and irrigation shall be completed prior to the issuance of the first certificate of occupancy. (CO: MONITORING -Eng)
 - D. At the property owner's option, when and if the County is ready to install OTIS on the surrounding medians of this roadway adjacent to the property owner installed landscaping, payment for the maintenance may be provided to the County. The payment shall be in the amount and manner that complies with the schedule for such payments that exists on the date payment is made. Once payment has been provided, Palm Beach County shall assume the maintenance responsibility for the OTIS landscaping and irrigation that has been installed by the property owner. The property owner shall first be required to correct any deficiencies in the landscaping and irrigation. This option is not available to medians with additional landscaping beyond OTIS standards, unless those medians are first brought into conformance with OTIS standards by the property owner.
 - E. Alternately, at the option of the property owner, and prior to the issuance of a Building Permit, the property owner may make a contribution to the County's Only Trees Irrigation and Sod, OTIS program, unincorporated thoroughfare beatification program. This payment, for the County's installation of landscaping and irrigation on qualifying thoroughfares shall be based on the project's front footage along Hagen Ranch Road. This payment shall be in the amount and manner that complies with the schedule for such payments as it currently exists or as it may from time to time be amended.
4. Prior to technical compliance for the first plat, the property owner shall convey a roadway construction easement to Palm Beach County. This roadway construction easement shall contain an isosceles trapezoid connecting the required corner clips across this property owners road right of way. Construction within this easement shall conform to Palm Beach County Standards. (TC:ENG-Eng)

HEALTH

1. Prior to the issuance of a Building Permit, the property owner shall provide written verification issued by the Florida Department of Environmental Protection affirming that environmental contamination assessment and, if necessary, cleanup of the site are satisfactorily addressed, thus reducing the potential for exposure of construction

workers and future residents to any contaminated soil or polluted water. (BLDG PERMIT: MONITORING- Health)

2. Prior to the issuance of a building permit, the property owner must submit results of an asbestos containing materials (ACM) survey to the Palm Beach County Health Department. (BLDG PERMIT: MONITORING- Health)
3. Prior to the final plan approval by the Development Review Officer, the property owner must submit all Site Assessment Reports and Remedial Action Plan(s) to the Palm Beach County Health Department. All such reports and plans must be signed and sealed by the appropriate registered professional pursuant to Rule 62-770.690, F.A.C. (DRO: HEALTH-Health)

ZONING -LANDSCAPE - STANDARDS

1. Prior to the issuance of a building permit , the property owner shall submit a Landscape Plan to the Landscape Section for review and approval. The Plan shall be prepared in compliance with all landscape related conditions of approval as contained herein. (BLDG PERMIT: LANDSCAPE - Zoning)
2. A minimum of seventy-five (75) percent of canopy trees to be planted in the landscape buffers shall be native and meet the following minimum standards at installation:
 - a. tree height: fourteen (14) feet;
 - b. trunk diameter: three and one-half (3.5) inches measured at four and one-half (4.5) feet above grade;
 - c. canopy diameter: seven (7) feet diameter shall be determined by the average canopy radius measured at three (3) points from the trunk to the outermost branch tip. Each radius shall measure a minimum of three and one-half (3.5) feet in length; and,
 - d. credit may be given for existing or relocated trees provided they meet ULDC requirements. (BLDG PERMIT: LANDSCAPE - Zoning)
3. A group of three (3) or more palms may not supersede the requirement for a canopy tree in that location, unless specified herein. (BLDG PERMIT: LANDSCAPE - Zoning)
4. Field adjustment of berm and plant material locations may be permitted to provide pedestrian sidewalks/bike paths and to accommodate transverse utility or drainage easements crossings and existing vegetation. (BLDG PERMIT: LANDSCAPE - Zoning)

ZONING - LANDSCAPING ALONG THE WEST PROPERTY LINE (ABUTTING HAGAN RANCH ROAD)

1. In addition to code requirements and the proposed landscaping buffer along the west property line shall be upgraded to include:
 - a. a continuous three (3) foot high berm;
 - b. an opaque concrete wall to be located on the plateau of the berm. Both sides of the wall shall be given a finished architectural treatment that is consistent with the color and style of the principal structure. Shop drawings of the wall shall be reviewed and approved by the Arch Review/Landscape Section prior to the issuance of a building permit. (BLDG PERMIT: LANDSCAPE - Zoning)

MASS TRANSIT

1. The location of an easement for a Bus Stop Boarding and Alighting Area, subject to the approval of Palm Tran shall be shown on the Master Plan and/or site plan prior to final approval of the Development Review Officer (DRO). The purpose of this easement is for the future construction of mass transit infrastructure in a manner acceptable to Palm Tran. (DRO: PALM TRAN-Palm Tran)
2. Prior to Plat Recordation or issuance of the first Building Permit, whichever shall first occur, the property owner shall convey and/or dedicate to Palm Beach County an easement for a Bus Stop Boarding and Alighting Area in a form with terms and conditions approved by Palm Tran. Supporting documentation, including but not limited to, a location sketch, legal description, affidavit of ownership, attorney title opinion and other related documents as deemed necessary by Palm Tran. (PLAT: ENGINEERING-Eng)

PLANNING

1. Prior to final approval by the Development Review Officer (DRO), the property owner shall record in the public records of Palm Beach County a restrictive covenant, in a form acceptable to the Palm Beach County Attorney, which includes the following:
 - a. Guarantees the attainability of 30% of the requested TDR units (the number of units calculated shall be rounded up to the nearest dwelling unit) for a period of ten years (ownership) twenty years (rental) to moderate income (>80% - 120% median income) households, with the unit sales prices determined by Palm Beach County's Housing and Community Development Department; and
 - b. Guarantees that these units shall not be further restricted beyond the requirement that the occupants qualify for the income limits.
 - c. The attainable units are not required to be of similar square footage or provide premium features found in market rate units. (DRO: COUNTY ATTY- Planning)
2. The property owner shall include in sales documents as well as written brochures, sales contracts, Master Plans and related Site Plans a disclosure statement identifying and notifying future residents of this development, that the project has a minimum of 30% of the requested TDR units earmarked as attainable housing units and any residents wishing to reside in a unit that has been earmarked as an attainable housing unit shall qualify for eligibility. Every deed of sale for each of the attainable units shall contain a restriction guaranteeing the property is sold and occupied by a qualified income household only, for a period of ten years (ownership) twenty years (rental). The property owner is responsible for disclosure of the location of these attainable units prior to the sale of any units. On an annual basis, beginning April 1, 2007, the property owner/homeowner association shall submit an annual report to the Planning Division documenting compliance with the Attainable Housing declaration of restrictive covenants, the sales document disclosure, and the deed of sale restriction. (DATE: MONITORING - Planning)
3. Prior to final approval by the Development Review Officer (DRO), the property owner shall:
 - a. provide a donation of \$50,000 per attainable unit, as required in Planning Condition 1; or,
 - b. provide the required attainable units as required in an off-site project location acceptable to the DRO. (DRO: PLANNING-Planning)

PLANNED UNIT DEVELOPMENT

1. Prior to recordation of the first plat, all property included in the legal description of the petition shall be subject to a Declaration of Restrictions and Covenants acceptable to the County Attorney's office which shall include the following:
 - a. Formation of a single "master" property owner's association, automatic voting membership in the master association by any party holding title to any portion of the subject property, and assessment of all members of the master association for the cost of maintaining all common areas.
 - b. All recreation parcels shall be deed restricted to recreation for the use of the residents of the development. At the time of turnover of the POA/HOA, the recreation parcel shall be turned over to the association at no cost to the residents.
 - c. The property shall not be subject to the Declaration of Restrictions in phases. Approval of the Declaration must be obtained from the County Attorney's office prior to the recordation of the first plat for any portion of the planned development. This Declaration shall be amended when additional units are added to the PUD. (PLAT: ENG.-Cty Atty)

SCHOOL BOARD

1. Prior to the issuance of the first Certificate of Occupancy (CO), the school bus shelter shall be constructed by the property owner in a location and manner acceptable to the Palm Beach County School Board. Provisions for the bus shelter shall include, at a minimum, a covered area, continuous paved pedestrian and bicycle access from the subject property or use, to the shelter. Maintenance of the bus shelter(s) shall be the responsibility of the residential property owner. (CO: MONITORING- School Board)
2. The property owner shall post a notice of annual boundary school assignments for students from this development. A sign 11" X 17" shall be posted in a clear and visible location in all sales offices and models with the following:

"NOTICE TO PARENTS OF SCHOOL AGE CHILDREN"

School age children may not be assigned to the public school closest to their residences. School Board policies regarding levels of service or other boundary policy decisions affect school boundaries. Please contact the Palm Beach County School District Boundary Office at (561) 434-8100 for the most current school assignment(s). (ONGOING: SCHOOL BOARD- School Board)

UTILITIES

1. If any relocations/modifications to the County's existing facilities are required that are a direct or indirect result of the development, the developer shall pay for the complete design and construction costs associated with these relocations/modifications. (ONGOING: PBCWUD-PBCWUD)

COMPLIANCE

1. In granting this approval, the Board of County Commissioners relied upon the oral and written representations of the property owner both on the record and as part of the application process. Deviations from or violation of these representations shall cause the approval to be presented to the Board of County Commissioners for review under the compliance condition of this approval. (ONGOING: MONITORING - Zoning)

2. Failure to comply with any of the conditions of approval for the subject property at any time may result in:
 - a. The issuance of a stop work order; the issuance of a cease and desist order; the denial or revocation of a building permit; the denial or revocation of a Certificate of Occupancy; the denial of any other permit, license or approval to any developer, owner, lessee, or user of the subject property; the revocation of any other permit, license or approval from any developer, owner, lessee, or user of the subject property; revocation of any concurrency; and/or
 - b. The revocation of the Official Map Amendment, Conditional Use, Requested Use, Development Order Amendment, and/or any other zoning approval; and/or
 - c. A requirement of the development to conform with the standards of the ULDC at the time of the finding of non-compliance, or the addition or modification of conditions reasonably related to the failure to comply with existing conditions; and/or
 - d. Referral to code enforcement; and/or
 - e. Imposition of entitlement density or intensity.

Staff may be directed by the Executive Director of PZ&B or a Code Enforcement Special Master to schedule a Status Report before the body which approved the Official Zoning Map Amendment, Conditional Use, Requested Use, Development Order Amendment, and/or other zoning approval, in accordance with the provisions of Article 2.E of the ULDC, in response to any flagrant violation and/or continued violation of any condition of approval.

Appeals of any departmental administrative actions hereunder may be taken to the Palm Beach County Board of Adjustment or as otherwise provided in the Unified Land Development Code (ULDC), as amended. Appeals of any revocation of an Official Zoning Map Amendment, Conditional Use, Requested Use, Development Order Amendment or other actions based on a Board of County Commission decision shall be by petition for writ of certiorari to the Fifteenth Judicial Circuit. (ONGOING: MONITORING - Zoning)