

RESOLUTION NO. R-2007-1613

RESOLUTION APPROVING ZONING APPLICATION Z2007-524  
(CONTROL NO. 2007-00174)  
OFFICIAL ZONING MAP AMENDMENT (REZONING)  
WITH A CONDITIONAL OVERLAY ZONE (COZ)  
APPLICATION OF JAMES FARIS  
BY LAND RESEARCH MANAGEMENT, INC., AGENT  
(FARIS PROPERTY)

WHEREAS, the Board of County Commissioners, as the governing body of Palm Beach County, Florida, pursuant to the authority vested in Chapter 163 and Chapter 125, Florida Statutes, is authorized and empowered to consider applications relating to zoning; and

WHEREAS, the notice and hearing requirements, as provided for in Article 2 (Development Review Process) of the Palm Beach County Unified Land Development Code (Ordinance 2003-067, as amended) have been satisfied; and

WHEREAS, Zoning Application Z2007-524 was presented to the Board of County Commissioners at a public hearing conducted on September 24, 2007; and

WHEREAS, the Board of County Commissioners has considered the evidence and testimony presented by the applicant and other interested parties, the recommendations of the various county review agencies, and the recommendation of the Zoning Commission; and

WHEREAS, this approval is subject to Article 2.E (Monitoring) of the Palm Beach County Unified Land Development Code (ULDC) and other provisions requiring that development commence in a timely manner; and

WHEREAS, the Board of County Commissioners has considered the findings in the staff report and the following findings of fact:

1. This official zoning map amendment (rezoning) is consistent with the Palm Beach County Comprehensive Plan;
2. This official zoning map amendment (rezoning) is consistent with the stated purpose, intent and requirements of the Palm Beach County Unified Land Development Code. The rezoning request is also consistent with the requirements of all other applicable local land development regulations;
3. This official zoning map amendment (rezoning) is compatible and generally consistent with existing uses and zones surrounding the subject land, and is the appropriate zoning district for the land;
4. The applicant has demonstrated that there are sufficient changed conditions or circumstances that require an amendment;
5. This official zoning map amendment (rezoning) does not result in significantly adverse impacts on the natural environment, including but not limited to water, air, stormwater management, wildlife, vegetation, wetlands, and the natural functioning of the environment;
6. This official zoning map amendment (rezoning) will result in a logical, orderly and timely development pattern; and,
7. This official zoning map amendment is consistent with applicable Neighborhood Plans.

8. This official zoning map amendment (rezoning) complies with Article 2.F (CONCURRENCY - Adequate Public Facility Standards) of the Palm Beach County Unified Land Development Code.

WHEREAS, Article 2.A.1.K.3.b (Action by BCC) of the Palm Beach County Unified Land Development Code requires that the action of the Board of County Commissioners be adopted by resolution.

NOW, THEREFORE, BE IT RESOLVED BY THE BOARD OF COUNTY COMMISSIONERS OF PALM BEACH COUNTY, FLORIDA, that Zoning Application Z2007-524 the application of James Faris by Land Research Management, Inc., agent, for an Official Zoning Map Amendment from the Residential Transitional Zoning District to the Light Industrial Zoning District with a CONDITIONAL OVERLAY ZONE on a parcel of land legally described in EXHIBIT A, attached hereto and made a part hereof, and generally located as indicated on a vicinity sketch attached as EXHIBIT B, attached hereto and made a part hereof, was approved on September 24, 2007, subject to the conditions of the CONDITIONAL OVERLAY ZONE described in EXHIBIT C, attached hereto and made a part hereof.

Commissioner Aaronson moved for the approval of the Resolution.

The motion was seconded by Commissioner McCarty and, upon being put to a vote, the vote was as follows:

Addie L. Greene, Chairperson	- Absent
John F. Koons, Vice Chair	- Absent
Karen T. Marcus	- Aye
Robert J. Kanjian	- Aye
Mary McCarty	- Aye
Burt Aaronson	- Aye
Jess R. Santamaria	- Aye

The Chairperson thereupon declared that the resolution was duly passed and adopted on September 24, 2007.

Filed with the Clerk of the Board of County Commissioners on 24th of September

This resolution is effective when filed with the Clerk of the Board of County Commissioners.

APPROVED AS TO FORM  
AND LEGAL SUFFICIENCY

PALM BEACH COUNTY, FLORIDA  
BY ITS BOARD OF COUNTY  
COMMISSIONERS

SHARON R. BOCK,  
CLERK & COMPTROLLER

BY:   
COUNTY ATTORNEY

BY:   
DEPUTY CLERK



EXHIBIT A  
LEGAL DESCRIPTION

The East 180' of the South 1/2 of the East 1/2 of Tract 52, Block 5, Palm Beach Farms Plat 3, according to the plat thereof as recorded in Plat Book 2, Page(s) 45, of the Public Records of Palm Beach County, Florida.

EXHIBIT B

VICINITY SKETCH

PALM BEACH COUNTY ZONING QUAD/VICINITY SKETCH

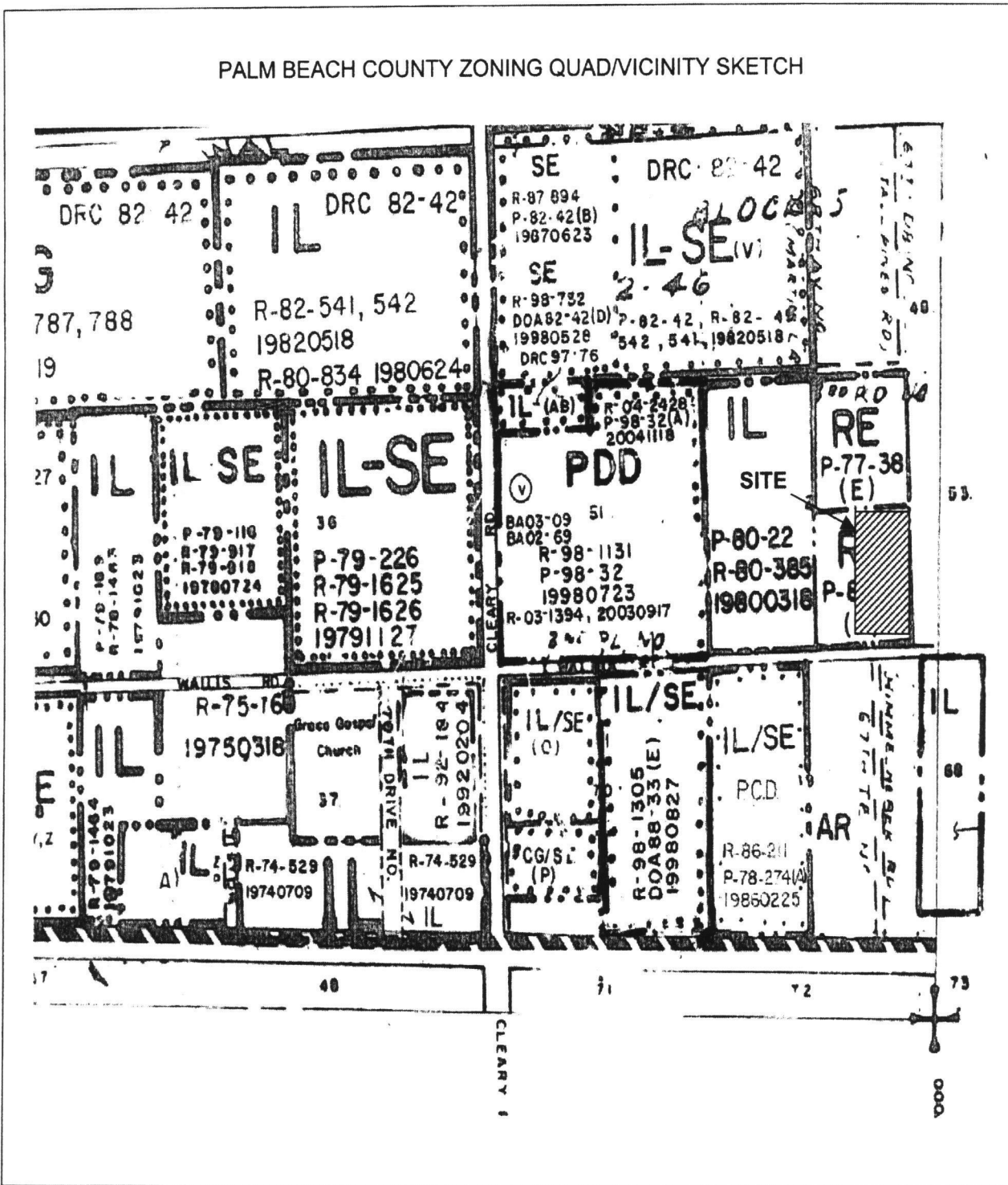

Application No. 2007-524  
Zoning Quad 46  
Date September 6, 2007





## EXHIBIT C

### CONDITIONS OF APPROVAL

#### ENGINEERING

1. In order to comply with the mandatory Traffic Performance Standards, the Property owner shall be restricted to the following phasing schedule:
  - A) No Building Permits for the site may be issued after September 27, 2010. A time extension for this condition may be approved by the County Engineer based upon an approved Traffic Study which complies with Mandatory Traffic Performance Standards in place at the time of the request. This extension request shall be made pursuant to the requirements of Article 2, Section E of the Unified Land Development Code. (DATE: MONITORING-Eng)
2. Prior to issuance of a Building Permit, the Property Owner shall plat the subject property into one legal lot of record in accordance with provisions of Article 11 of the Unified Land Development Code. A recorded plat waiver is also acceptable, provided this property is eligible for a plat waiver in accordance with the provisions of the ULDC as determined by the County Engineer. (BLDG PERMIT: MONITORING-Eng)
3. CORRIDOR CONVEYANCE OF RIGHT OF RIGHT OF WAY The property owner shall provide to the Palm Beach County Land Development Division a road right of way deed and all associated documents as required by the County Engineer for Wallis Road 30 feet from centerline on an alignment approved by the County Engineer. All right of way deed(s) and associated documents shall be provided and approved prior to January 2, 2008 or prior to the issuance of a Building Permit whichever shall first occur. Right of way conveyance shall be along the entire frontage and shall be free of all encroachments and encumbrances. Property owner shall provide Palm Beach County with sufficient documentation acceptable to the Right of Way Acquisition Section to ensure that the property is free of all encumbrances and encroachments. The Grantor further warrants that the property being conveyed to Palm Beach County meets all appropriate and applicable environmental agency requirements. In the event of a determination of contamination which requires remediation or clean up on the property now owned by the Grantor, the Grantor agrees to hold the Grantee harmless and shall be responsible for all costs of such clean up, including but not limited to, all applicable permit fees, Engineering or other expert witness fees including Attorney's fees as well as the actual cost of the clean up. Thoroughfare Plan Road right-of-way conveyances shall be consistent with Palm Beach County's Thoroughfare Right of Way Identification Map and shall include where appropriate provisions for Expanded Intersection Details and "Corner Clips." The Property Owner shall not record these required deeds or related documents. After final acceptance, Palm Beach County shall record all appropriate deeds and documents. (DATE/BLDG. PERMIT: MONITORING-Eng)
4. The Property owner shall construct: Wallis Road from the paved terminus east of Cleary Road, east to the project's entrance road. Construction shall be to collector street standards, 2-12 foot travel lanes plus appropriate drainage. A) This construction shall be concurrent with the paving and drainage improvements for the site. Any and all costs associated with the construction shall be paid by the property owner. These costs shall include, but are not limited to, utility relocations and acquisition of any additional required right-of-way. B) Permits required by Palm Beach County for this construction shall be obtained prior to the issuance of the first Building Permit. (BLDG PERMIT: Monitoring-Eng) C) Construction shall be completed prior to the issuance of the first Certificate of Occupancy. (CO: MONITORING-Eng)

5. Prior to issuance of the first building permit, the property owner shall provide a temporary roadway construction easement along Wallis Road to Palm Beach County. This roadway construction easement shall contain an isosceles trapezoid connecting the required corner clips across this property owners entrance road right of way. Construction within this easement shall conform to Palm Beach County Standards. The Property Owner shall not record these required easements or related documents. After final acceptance of the location, legal sketches and dedication documents, Palm Beach County shall record all appropriate deeds and documents. (BLDG PERMIT:MONITORING-Eng)

#### HEALTH

1. The property owners and operators of facilities generating industrial, hazardous, or toxic waste shall not deposit or cause to be deposited any such waste into the sanitary sewer system unless adequate pretreatment facilities approved by the Florida Department of Environmental Protection, the Palm Beach County Health Department, and the agency responsible for sewage works are provided and used. (ONGOING: CODE ENF-Health)

#### COMPLIANCE

1. In granting this approval, the Board of County Commissioners relied upon the oral and written representations of the petitioner both on the record and as part of the application process. Deviations from or violation of these representations shall cause the approval to be presented to the Board of County Commissioners for review under the compliance condition of this approval. (ONGOING: MONITORING - Zoning)
2. Failure to comply with any of the conditions of approval for the subject property at any time may result in:
  - a. The issuance of a stop work order; the issuance of a cease and desist order; the denial or revocation of a building permit; the denial or revocation of a Certificate of Occupancy; the denial of any other permit, license or approval to any developer, owner, lessee, or user of the subject property; the revocation of any other permit, license or approval from any developer, owner, lessee, or user of the subject property; revocation of any concurrency; and/or
  - b. The revocation of the Official Map Amendment, Conditional Use, Requested Use, Development Order Amendment, and/or any other zoning approval; and/or
  - c. A requirement of the development to conform with the standards of the ULDC at the time of the finding of non-compliance, or the addition or modification of conditions reasonably related to the failure to comply with existing conditions; and/or
  - d. Referral to code enforcement; and/or
  - e. Imposition of entitlement density or intensity.

Staff may be directed by the Executive Director of PZ&B or a Code Enforcement Special Master to schedule a Status Report before the body which approved the Official Zoning Map Amendment, Conditional Use, Requested Use, Development Order Amendment, and/or other zoning approval, in accordance with the provisions of Article 2.E of the ULDC, in response to any flagrant violation and/or continued violation of any condition of approval.

Departmental administrative actions made pursuant to this condition may be appealed as provided in the Unified Land Development Code (ULDC), as amended. Appeals of any revocation of a Conditional Use, Type II Variance, Development Order Amendment or other actions based on a Zoning Commission decision shall be by petition for writ of certiorari to the Circuit Court, Appellate Division, 15th Judicial Circuit of Florida. (ONGOING: MONITORING - Zoning)