

RESOLUTION NO. R-2009-0374

RESOLUTION APPROVING ZONING APPLICATION PDD/R/TDR-2008-00798
(CONTROL NO. 2008-00129)

REQUESTED USE
APPLICATION OF STANDARD PACIFIC OF SOUTH FL GP INC.
BY KILDAY & ASSOCIATES, INC., AGENT
(ANDALUCIA PUD)

WHEREAS, the Board of County Commissioners, as the governing body of Palm Beach County, Florida, pursuant to the authority vested in Chapter 163 and Chapter 125, Florida Statutes, is authorized and empowered to consider applications relating to zoning; and

WHEREAS, the Board of County Commissioners, pursuant to Article 2 (Development Review Process) of the Palm Beach County Unified Land Development Code (Ordinance 2003-067, as amended) is authorized and empowered to consider, approve, approve with conditions or deny Requested Uses; and

WHEREAS, the notice and hearing requirements, as provided for in Article 2 of the Palm Beach County Unified Land Development Code have been satisfied; and

WHEREAS, Zoning Application PDD/R/TDR-2008-00798 was presented to the Board of County Commissioners at a public hearing conducted on February 25, 2009; and

WHEREAS, the Board of County Commissioners has considered the evidence and testimony presented by the applicant and other interested parties, the recommendations of the various county review agencies, and the recommendations of the Zoning Commission; and

WHEREAS, this approval is subject to Article 2.E (Monitoring) of the Palm Beach County Unified Land Development Code (ULDC) and other provisions requiring that development commence in a timely manner; and

WHEREAS, the Board of County Commissioners has considered the findings in the staff report and the following findings of fact:

1. This Requested Use is consistent with the purposes, goals, objectives and policies of the Palm Beach County Comprehensive Plan, including standards for building and structural intensities and densities, and intensities of use.
2. This Requested Use complies with relevant and appropriate portions of Article 4.B, Supplementary Use Standards of the Palm Beach County Unified Land Development Code. This Requested Use also meets applicable local land development regulations.
3. This Requested Use, with conditions as adopted, is compatible as defined in the Palm Beach County Unified Land Development Code and generally consistent with the uses and character of the land surrounding and in the vicinity of the land proposed for development.
4. The proposed design, with conditions as adopted, minimizes adverse effects, including visual impact and intensity of the proposed use on adjacent lands.
5. This Requested Use has a concurrency determination and complies with Article 2.F (Concurrency) of the ULDC.
5. This Requested Use, with conditions as adopted, minimizes environmental impacts, including but not limited to water, air, stormwater management, wildlife, vegetation, wetlands and the natural functioning of the environment.
7. This Requested Use, with conditions as adopted, will result in logical, timely and orderly development patterns.
8. This Requested Use, with conditions as adopted, complies with standards imposed on it by all other applicable provisions of the Palm Beach County Unified Land Development Code for use, layout, function, and general development

characteristics.

- 9. This Requested Use, with conditions as adopted, is consistent with the applicable Neighborhood Plans.
- 10. The applicant has demonstrated sufficient justification that there are changed circumstances, which would require the Requested Use.

WHEREAS, Article 2.A.1.K.3.b (Action by BCC) of the Palm Beach County Unified Land Development Code requires that the action of the Board of County Commissioners be adopted by resolution.

NOW, THEREFORE, BE IT RESOLVED BY THE BOARD OF COUNTY COMMISSIONERS OF PALM BEACH COUNTY, FLORIDA, that Zoning Application R-PDD/R/TDR-2008-00798, the application of Standard Pacific of South FL GP Inc., by Kilday & Associates, Inc., agent, for a Requested Use to allow the Transfer of Development Rights in the PUD Zoning District, on a parcel of land legally described in EXHIBIT A, attached hereto and made a part hereof, and generally located as shown on a vicinity sketch as indicated in EXHIBIT B, attached hereto and made a part hereof, was approved on February 25, 2009, subject to the conditions of approval described in EXHIBIT C, attached hereto and made a part hereof.

Commissioner Aaronson moved for the approval of the Resolution.

The motion was seconded by Commissioner Greene and, upon being put to a vote, the vote was as follows:

Commissioner John F. Koons, Chairman	-	Aye
Commissioner Burt Aaronson, Vice Chairman	-	Aye
Commissioner Karen T. Marcus	-	Absent
Commissioner Shelley Vana	-	Aye
District 4	-	
Commissioner Jess R. Santamaria	-	Naye
Commissioner Addie L. Greene	-	Aye

The Chairperson thereupon declared that the resolution was duly passed and adopted on February 25, 2009.

Filed with the Clerk of the Board of County Commissioners on March 3rd, 2009

This resolution is effective when filed with the Clerk of the Board of County Commissioners.

APPROVED AS TO FORM AND LEGAL SUFFICIENCY

PALM BEACH COUNTY, FLORIDA BY ITS BOARD OF COUNTY COMMISSIONERS

SHARON R. BOCK, CLERK & COMPTROLLER

BY: [Signature]
COUNTY ATTORNEY

BY: [Signature]
DEPUTY CLERK



EXHIBIT A

LEGAL DESCRIPTION

TRACT 38, LESS THE NORTH 35.64 FEET, BLOCK 28, THE PALM BEACH FARMS COMPANY PLAT NO. 3, ACCORDING TO THE PLAT THEREOF RECORDED IN PLAT BOOK 2, PAGE 45, PUBLIC RECORDS OF PALM BEACH COUNTY, FLORIDA.

TOGETHER WITH:

TRACT 41, LESS THE WEST 70 FEET THEREOF AS DESCRIBED IN OFFICIAL RECORD BOOK 4549, PAGE 1311, BLOCK 28, PALM BEACH FARMS COMPANY PLAT NO. 3, ACCORDING TO THE PLAT THEREOF RECORDED IN PLAT BOOK 2, PAGE 45, PUBLIC RECORDS OF PALM BEACH COUNTY, FLORIDA.

TOGETHER WITH:

TRACTS 42 AND 43, BLOCK 28, PALM BEACH FARMS COMPANY PLAT NO. 3, ACCORDING TO THE PLAT THEREOF RECORDED IN PLAT BOOK 2, PAGE 45, PUBLIC RECORDS OF PALM BEACH COUNTY, FLORIDA.

TOGETHER WITH:

TRACTS 53 AND 60, LESS THE SOUTH 35 FEET OF TRACT 60, BLOCK 28, PALM BEACH FARMS COMPANY PLAT NO. 3, ACCORDING TO THE PLAT THEREOF RECORDED IN PLAT BOOK 2, PAGE 45, PUBLIC RECORDS OF PALM BEACH COUNTY, FLORIDA.

TOGETHER WITH:

A PARCEL OF LAND LYING IN TRACT 44, BLOCK 28, PALM BEACH FARMS COMPANY PLAT NO. 3, AS RECORDED IN PLAT BOOK 2, PAGES 45 THROUGH 54, INCLUSIVE, PUBLIC RECORDS OF PALM BEACH COUNTY, FLORIDA, BEING MORE PARTICULARLY DESCRIBED AS FOLLOWS:

BEGINNING AT THE SOUTHWEST CORNER OF SAID TRACT 44; THENCE NORTH 00°00'29" WEST ALONG THE WEST LINE OF SAID TRACT 44, A DISTANCE OF 49.96 FEET TO A POINT ON A CURVE CONCAVE TO THE SOUTHWEST, HAVING A RADIUS OF 540.00 FEET AND WHOSE CHORD BEARS SOUTH 82°06'07" EAST; THENCE SOUTHEASTERLY ALONG THE ARC OF SAID CURVE, THROUGH A CENTRAL ANGLE OF 14°27'05", A DISTANCE OF 136.20 FEET TO A POINT OF TANGENCY; THENCE SOUTH 74°52'34" EAST, A DISTANCE OF 58.77 FEET TO THE POINT OF CURVATURE OF A CURVE CONCAVE TO THE NORTHEAST, HAVING A RADIUS OF 460.00 FEET; THENCE SOUTHEASTERLY ALONG THE ARC OF SAID CURVE, THROUGH A CENTRAL ANGLE OF 14°39'56", A DISTANCE OF 117.74 FEET TO A POINT ON THE SOUTH LINE OF SAID TRACT 44; THENCE SOUTH 89°59'31" WEST ALONG SAID SOUTH LINE OF TRACT 44, A DISTANCE OF 307.61 FEET TO THE AFOREMENTIONED POINT OF BEGINNING.

CONTAINING 58.03 ACRES, MORE OR LESS.

EXHIBIT B
VICINITY SKETCH

**PALM BEACH COUNTY PLANNING DIVISION
SITE LOCATION AND LAND USE**

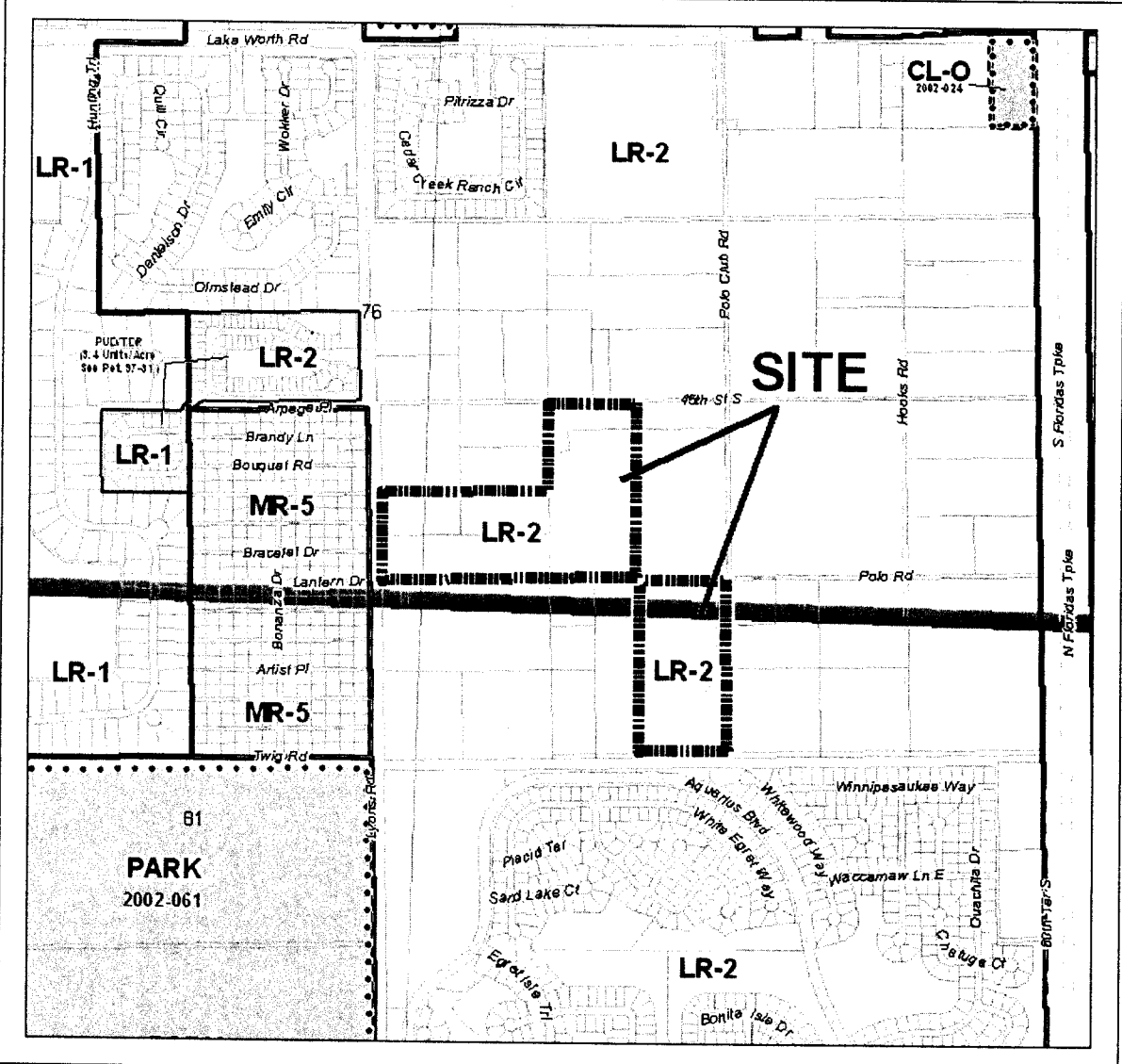

Application Number: PDD/R/TDR-2008-798
 Control Number: 2008-129
 Land Use Atlas Page: 76 & 81
 Date: 10/30/2008



EXHIBIT C

CONDITIONS OF APPROVAL

COMPLIANCE

1. In granting this approval, the Board of County Commissioners relied upon the oral and written representations of the petitioner both on the record and as part of the application process. Deviations from or violation of these representations shall cause the approval to be presented to the Board of County Commissioners for review under the compliance condition of this approval. (ONGOING: MONITORING - Zoning)

2. Failure to comply with any of the conditions of approval for the subject property at any time may result in:

a. The issuance of a stop work order; the issuance of a cease and desist order; the denial or revocation of a building permit; the denial or revocation of a Certificate of Occupancy; the denial of any other permit, license or approval to any developer, owner, lessee, or user of the subject property; the revocation of any other permit, license or approval from any developer, owner, lessee, or user of the subject property; revocation of any concurrency; and/or

b. The revocation of the Official Map Amendment, Conditional Use, Requested Use, Development Order Amendment, and/or any other zoning approval; and/or

c. A requirement of the development to conform with the standards of the ULDC at the time of the finding of non-compliance, or the addition or modification of conditions reasonably related to the failure to comply with existing conditions; and/or

d. Referral to code enforcement; and/or

e. Imposition of entitlement density or intensity.

Staff may be directed by the Executive Director of PZ&B or the Code Enforcement Special Master to schedule a Status Report before the body which approved the Conditional Use, Type II Variance, Development Order Amendment, and/or other zoning approval, in accordance with the provisions of Section 2.E of the ULDC, in response to any flagrant violation and/or continued violation of any condition of approval.

Departmental administrative actions made pursuant to this condition may be appealed as provided in the Unified Land Development Code (ULDC), as amended. Appeals of any revocation of a Conditional Use, Type II Variance, Development Order Amendment or other actions based on a Zoning Commission decision shall be by petition for writ of certiorari to the Circuit Court, Appellate Division, 15th Judicial Circuit of Florida. (ONGOING: MONITORING - Zoning)