

RESOLUTION NO. R-2015- 1081

RESOLUTION APPROVING ZONING APPLICATION Z/CA-2014-02502  
(CONTROL NO. 1987-00150)  
an Official Zoning Map Amendment  
APPLICATION OF Fuller Florence  
BY Cotleur & Hearing, Inc., AGENT  
(Florence Fuller Child Development Center)

WHEREAS, the Board of County Commissioners, as the governing body of Palm Beach County, Florida, pursuant to the authority vested in Chapter 163 and Chapter 125, Florida Statutes, is authorized and empowered to consider applications relating to zoning;

WHEREAS, the notice and public hearing requirements, as provided for in Article 2 (Development Review Procedures) of the Palm Beach County Unified Land Development Code (Ordinance 2003-067, as amended) (ULDC), have been satisfied;

WHEREAS, Zoning Application Z/CA-2014-02502 was presented to the Board of County Commissioners at a public hearing conducted on August 27, 2015;

WHEREAS, the Board of County Commissioners has considered the evidence and testimony presented by the Applicant and other interested parties, the recommendations of the various County Review Agencies, and the recommendation of the Zoning Commission;

WHEREAS, the, Board of County Commissioners pursuant to Article 2 (Development Review Procedures) of the ULDC is authorized and empowered to consider, approve, approve with conditions or deny the request;

WHEREAS, this approval is subject to Article 2.E (Monitoring), of the ULDC and other provisions requiring that development commence in a timely manner;

WHEREAS, the issuance of this Development Permit does not in any way create any rights on the part of the Applicant and/or Property Owner to obtain a permit from a state or federal agency and does not create any liability on the part of the County for issuance of the permit if the Applicant fails to obtain requisite approvals or fulfill the obligations imposed by a state or federal agency or undertakes actions that result in a violation of state or federal law;

WHEREAS, THE BOARD OF COUNTY COMMISSIONERS hereby incorporates by reference the Findings of Fact in the staff report addressing the standards contained in Article 2.B.1.B, Official Zoning Map Amendment; and,

WHEREAS, Article 2.A.1.K.3.b (Action by BCC) of the ULDC requires that the action of the Board of County Commissioners be adopted by resolution.

NOW, THEREFORE, BE IT RESOLVED BY THE BOARD OF COUNTY COMMISSIONERS OF PALM BEACH COUNTY, FLORIDA, that Zoning Application Z/CA-2014-02502, the application of Fuller Florence, by Cotleur & Hearing, Inc., Agent, for an Official Zoning Map Amendment to allow a rezoning from Agriculture Residential (AR) Zoning District to the Residential Transitional (RT) Zoning District on a parcel of land legally described in EXHIBIT A, attached hereto and made a part hereof, and generally located as indicated on a vicinity sketch in EXHIBIT B, attached hereto and made a part hereof, was approved on August 27, 2015 subject to the Conditions of Approval described in EXHIBIT C, attached hereto and made a part hereof.

Commissioner Burdick moved for the approval of the Resolution.

The motion was seconded by Commissioner Valeche and, upon being put to a vote, the vote was as follows:

Commissioner Shelley Vana, Mayor	-	Aye
Commissioner Mary Lou Berger, Vice Mayor	-	Absent
Commissioner Hal R. Valeche	-	Aye
Commissioner Paulette Burdick	-	Aye
Commissioner Steven L. Abrams	-	Aye
Commissioner Melissa McKinlay	-	Absent
Commissioner Priscilla A. Taylor	-	Absent

The Mayor thereupon declared that the resolution was duly passed and adopted on August 27, 2015.

Filed with the Clerk of the Board of County Commissioners on August 27th, 2015.

This resolution is effective when filed with the Clerk of the Board of County Commissioners.

APPROVED AS TO FORM  
AND LEGAL SUFFICIENCY

PALM BEACH COUNTY, FLORIDA  
BY ITS BOARD OF COUNTY  
COMMISSIONERS

SHARON R. BOCK,  
CLERK & COMPTROLLER

BY:   
COUNTY ATTORNEY

BY:   
DEPUTY CLERK



EXHIBIT A

LEGAL DESCRIPTION

ALL OF TRACT 49 OF FLORIDA FRUIT LANDS COMPANY'S SUBDIVISION NO 2, AS RECORDED IN PLAT BOOK 1, PAGE 102, PUBLIC RECORDS OF PALM BEACH COUNTY, FLORIDA, LESS THEREFROM THE EAST 577.67 FEET, SAID LAND LYING IN SECTION 1, TOWNSHIP 47 SOUTH, RANGE 41 EAST, PALM BEACH COUNTY, FLORIDA.

CONTAINING 260627 SQUARE FEET OR 5.983 ACRES, MORE OR LESS.

EXHIBIT B  
VICINITY SKETCH

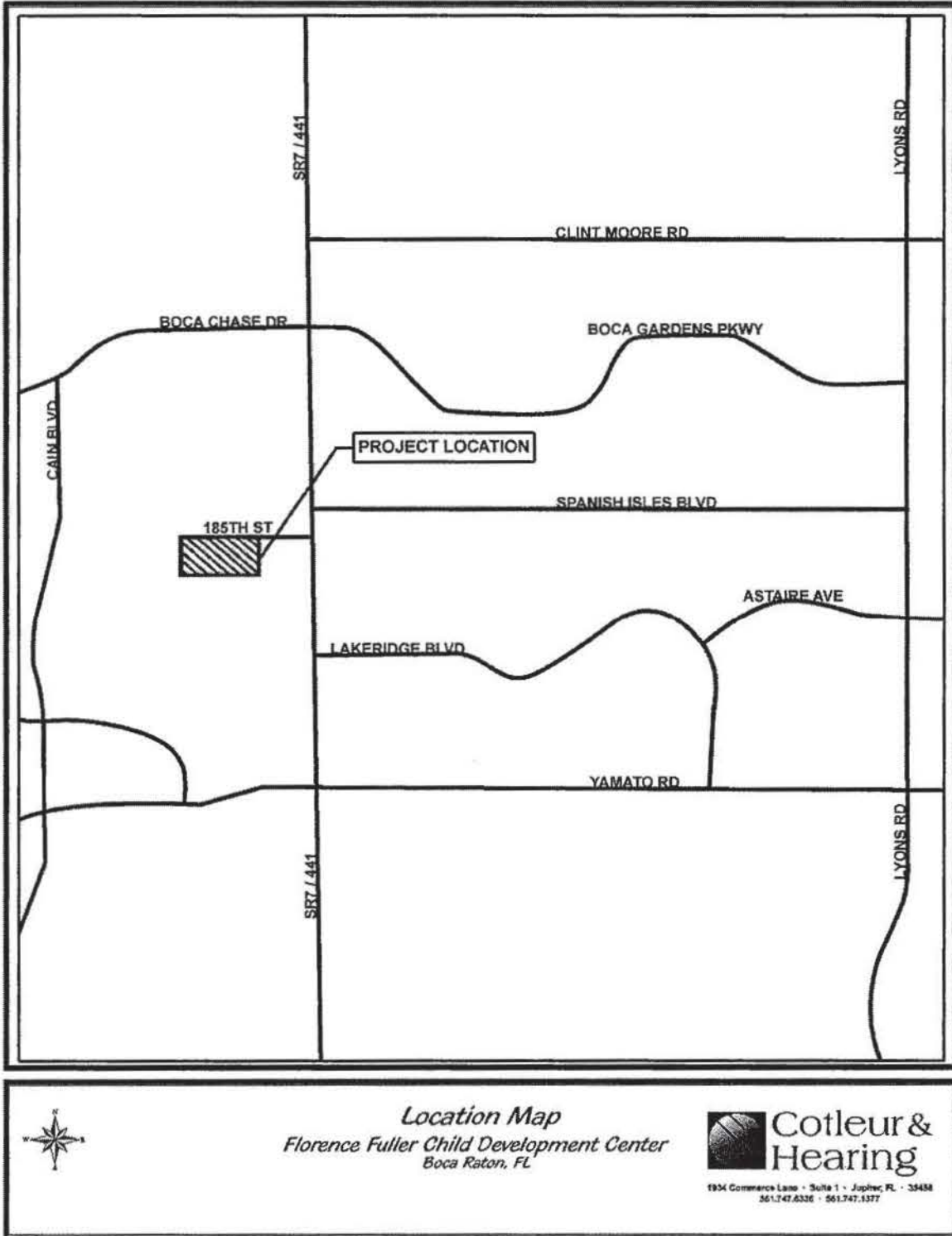

*Location Map*  
*Florence Fuller Child Development Center*  
*Boca Raton, FL*

 **Cotleur & Hearing**  
1954 Commerce Lane • Suite 1 • Jupiter, FL • 33438  
561.747.6326 • 561.747.1377

EXHIBIT C  
CONDITIONS OF APPROVAL

DISCLOSURE

1. All applicable state or federal permits shall be obtained before commencement of the development authorized by this Development Permit.